



*Mingle with Your
Peers at the Pier*



www.midam.org

Mid-America Horticultural Trade Show

January 19-21, 2011 • Navy Pier, Chicago, IL



In-person communication is still the best way to cultivate and strengthen business relationships. And, networking means business at Mid-Am.

Attend Mid-Am to find:

- ❖ Business-building ideas
- ❖ Career-advancing education
- ❖ Relationship-friendly networking
- ❖ Plus hundreds of exhibits



This combination shows contrasting foliage texture, simultaneous blooming, and perennial foliage cover.

5 STEPS TO SUCCESSFUL COMBOS

Here are some spring garden tips from the Cornell team in Ithaca, NY, and the Netherlands Flower Bulb Information Center of Danby, VT:

1. Plant bulbs that are likely to perennialize well in your area. Some combo plantings are more successful than others. Sometimes the

perennials come back, but the bulb flowers don't. Most often, this occurs when the wrong bulbs are chosen for local climate or growing conditions. Other times, you may choose the right bulb type but a less durable variety.

2. Consider each plant's seasonal growth habits. What looks good in the mind's eye

may not look as good in the early spring soil. This can happen when choosing companions based on their mature description without considering their springtime rate of growth and look at that time. In spring, different plants emerge and fill out in different ways, often featuring different coloring than later in the growing season. The goal of companion combos is to select perennials and bulbs that emerge together to work well in spring and early summer as partners. The Cornell project addresses this very subject.

3. Consider mature plant size. Unlike annuals, which normally grow large and flourish in a single season before dying away, perennials may take several seasons to gain maturity. If, for example, you are planning for a perennial to grow to a certain size in relation to your bulb planting, be sure to calculate when the perennial will reach that size. It may be necessary to plan for several bulb companions for your perennials over initial seasons, changing bulb choices as the perennials mature. Rather than a drawback, consider these as opportunities to play with bulbs as seasonal accessorizing.

4. Plant just enough bulbs. This might be considered the "Goldilocks" tip. Plant too few bulbs, and the look is sparse. Plant too many, and face overcrowding. Refer to bulb packaging, catalogs or websites for suggested spacing.

5. Allow for perennial spread. Different perennials have different growth habits. Some are aggressive growers with a tendency to spread. Others are late to leaf out and have a compact growth habit. For the aggressive spreaders, allow space for them to fill in. For more compact perennials, plant bulbs closer together. These considerations pay off when perennials' late spring growth successfully hides bulb die-back after bloom.

How long does a Corona last?

We'll let you know when we find out.

You shouldn't have to buy a tool twice. Get it right the first time with a Corona, built tougher than any on the market.

CORONA
SEASON AFTER SEASON

coronaclipper.com 800-847-7863

Does your insurance company think
“photosynthesis” is the latest
feature on a digital camera?



In a competitive business environment, you can't afford an insurance company that doesn't understand your business. Hortica has over 120 years experience in the horticultural industry. We provide specialized insurance solutions and loss control strategies that other companies don't deliver.

To learn how Hortica can help protect your business visit www.hortica-insurance.com or call 800-851-7740.

hortica
INSURANCE & EMPLOYEE BENEFITS
To guide and provide



King of the mountain

Initially released with the Novalis "Plants that Work" group in 2010, *Carex oshimensis* Everest is available in 2011 nationwide from **Tesselaar**. With its bright-white margins and architectural, linear foliage, the Japanese sedge can work as a container and patio plant or as a filler with bedding and specimen plants. It loves shade, and its low-growing, easily controlled, mounding shape softly edges any border or bed. Its ability to fill in an area while still behaving itself, also makes it useful as a groundcover. Tesselaar.com

Deep purple

Echinacea purpurea PowWow Wild Berry features vivid rose-purple, 3- to 4-in. flowers that retain color longer than other coneflowers. Hardy to Zone 3, **Ball's** first-year-flowering perennial has a basal branching habit, resulting in more flowers per plant. Reaching a height of 20 to 24 in. in the full-sun garden, it blooms continually without deadheading. It's an intermediate day-length flowering variety, with most rapid and uniform flowering at 14 hours. BallLandscape.com



There's business out there. Get more of it. Guaranteed!

Maximize your chances to win that new landscape or renovation project using the most complete landscape design software available. PRO Landscape will help you communicate your designs with stunning photorealistic 3D images, easily create accurate 2D and 3D CAD drawings and automatically generate professional proposals. We guarantee you'll sell, plan and bid better than ever before, or we'll give you your money back.



"I've won every bid when I've used PRO Landscape."
Aron Hoffman, Groundskeepers Landscaping, Inc.



VISUAL DESIGNS THAT SELL

Excite customers with photos of their home with recommended landscaping in place.



PROFESSIONAL PROPOSALS

Show your professionalism with complete, polished proposals prepared in seconds.

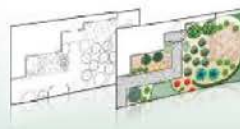

ACCURATE SITE PLANS

Easy-to-use CAD lets you quickly develop detailed, accurate site plans.

drafrix software, inc.

PRO Landscape™

The Standard in Design Software for Landscape Professionals!

prolandscape.com

800-231-8574 or prolandscape@drafrix.com

SELL BETTER • PLAN BETTER • BID BETTER



Sweet potato cutie

Ipomoea Bright Ideas is bred by **Floranova**, and its plants are heat-tolerant and very compact. Distributed in the US by Oro Farms, the series' colors include black, lime and Rusty Red (pictured). Growing 6 in. tall to a spread of 12 in., it works well in combination planters and flowerbeds. OroFarms.com



Performance diva

In early spring, the leaves of *Abelia* Kaleidoscope emerge on bright-red stems with lime-green centers and bright-yellow edges. When summer arrives, the yellow matures to golden and the variegation does not burn or scorch, according to the company. In fall and winter, the foliage color deepens to shades of orange and fiery red. This mounded, tightly branched shrub stays under 3 ft. tall and about as wide. Reported by **PlantHaven** to be the longest-blooming of all the *Abelias*, by late spring Kaleidoscope is covered with soft pink buds that open to white blooms that keep coming well into autumn. AbeliaKaleidoscope.com

LM REPORTS

YOUR GUIDE TO PRODUCT RESEARCH

LAWN CARE: AERATORS



Grasshopper Co.

The power-take-off-driven AERATOR implement relieves compaction and aerates turf without prior irrigation, leaving no cores to clean up. Models are now available with 50% more tines to loosen soil without disrupting the surface. Oscillating, forged steel tines penetrate and fracture hard, dry soils without slicing or cutting, preserving and encouraging root development. Available in 40- and 60-in.

Turfco

The XT5 steerable, *reversible* aerator uses Turfco's patented steerable aerator technology with a new hydrostatic drive system. Operators can boost efficiency and reduce job time on heavily landscaped lawns and hard-to-reach areas. The tine-wheel design and hydrostatic drive make working on hills easier. The XT5 features EasyChange tines, which reduce changeover time. A removable tine cover provides fast, easy access for changes and cleaning. The unit features a low-profile design and rugged unibody steel frame. Instead of belts, the XT5 runs on drive chains covered and located outside of the frame for long-lasting, trouble-free operation. *TurfcoDirect.com*

Agri-Fab

SmartLink is an all-in-one lawn care system that links attachments to one master platform. The system accepts a snap-in plug aerator, tine dethatcher, TurfShark aerator and poly roller, eliminating separate trays for each product. The original line required users to purchase the master platform with a plug aerator. The two products are sold separately — providing a solution for users who want to take advantage of the system, but don't need the plug aerator attachment. *Agri-fab.com*



models, the unit provides effective aeration with minimal surface disruption, so turf is available for use immediately

after treatment. It's compatible with Grasshopper Model 620T and any 700 or 900 Series power units. *GrasshopperMower.com*

Our QuickBooks integration is so smooth

Smooth. Real smooth. One click, and minutes later your entire customer list, employee list and item list is automatically synched with QuickBooks. Any change you make in QuickBooks or QXpress syncs in real-time.

and simple that you'll be scheduling jobs

QXpress looks and feels just like QuickBooks, so you'll feel right at home, and be scheduling your crews and routes in no time.

and creating invoices the very next day...

Scheduled jobs convert into QuickBooks invoices with only a couple clicks! Quick and easy. With no double-entry, you'll save time and prevent costly mistakes.

...just like Jody at Sepulvado Ventures Inc.

"The moment I started using QXpress, all of my apprehensions disappeared. It looked just like QuickBooks and imported my QuickBooks data, so I had a full database from the very start. My staff and I were literally scheduling in QXpress right away. Within no time, our crews' mowing schedules were full and we were even scheduling landscape projects. It was the best transition I could have asked for!"



Discover why lawn & landscaping professionals have rated QXpress the easiest scheduling add-on to setup.

Contact QXpress for a FREE demo today!
<http://www.qxpress.com/LM> 1-888-QXPRESS x1





Jacobsen

Featuring a 9-hp Briggs & Stratton Vanguard engine, the GA-24 is a self-propelled aerator that provides precise aeration and hole quality, which promotes faster turf healing. The unit's maneuverability allows for tight turns on undulated turf without causing undue damage. Four tine sizes are available, creating a 2x2-in. aeration pattern; optional quad tine holders create a 1x1-in. pattern. Features include centralized controls at the operator station, automatic parking brake and operator presence control. Jacobsen.com

SourceOne

From its fingertip speed control knob to its simplified, self-propelled hydrostatic drive system, the PL855 PRO HD hydrostatic drive aerator offers high productivity and low maintenance costs. Like all Plugr reciprocating aerators, heat-treated, high-tensile-strength tines are driven into even hard soils, with cam action engine power instead of bulky weights. It features sleek unibody construction, improved handle ergonomics, easy maintenance access and a built-in quick release receiver hitch for a StepSavr sully. SourceOneOPE.com



NEW RESOURCES & TRAINING

PROFESSIONAL COMMUNITY

REAL-LIFE STORIES



Connecting the Professional Snow & Ice Management Industry

MAINTENANCE: CHAINSAWS



Worx Yard Tools

Electric chainsaws in 14-, 16- and 18-in. bar lengths feature an easy-to-use, tool-free auto-tensioning system and chain replacement. A single, oversized, easy-grip knob secures the bar and tensions the chain. The saws' patented chain-tensioning system prevents overtightening and maintains proper tension during operation. The tensioning system helps extend bar and chain life while reducing the amount of time working. Each model — WG300 (14-in. bar, 14A, 3.0 hp, pictured), WG303 (16-in. bar, 14.5A, 3.5 hp) and WG304 (18-in. bar, 15A, 4 hp) — has class-leading hp ratings for each corresponding bar length. The saws weigh 10.8 lbs., 11 lbs. and 11.2 lbs., respectively. WorxYardTools.com



Stihl

The MS 362 chainsaw, which is engineered to save professional users time and money, delivers as much as 20% greater fuel efficiency and reduces emissions by as much as 70% compared to older models. It features a pre-separation air filtration system that allows for fewer filter changes and longer runtimes. The advanced anti-vibration system allows a user to keep working comfortably. Other standard features include a toolless fuel and oil cap with retainers, side-access chain tensioner and a decompression valve. StihlUSA.com

Husqvarna

The 576XP chainsaw features a redesigned cylinder and crankcase that, at 14.5 lbs. and 5.7 hp, is 0.5 lb. lighter than previous models and offers more horsepower. Like other models in Husqvarna's professional line of chainsaws, it features the X-TORQ engine that provides high power-to-weight ratio, 60% lower emissions and 20% lower fuel consumption. It also features Air Injection for longer air filter life and LowVib anti-vibration technology for improved ergonomics. Husqvarna.com



REDDICK EQUIPMENT COMPANY INC.
Ice Control Sprayers

Lawn & Turf Sprayers

REDDICK EQUIPMENT COMPANY INC.
Reddick Equipment
Sales: 800.334.3388
www.reddickequipment.com



We are actively seeking Landscaping Professionals to sell, install and service our innovative outdoor misting systems that effectively control mosquitoes and other annoying insects.

Great margins and recurring revenues!

Is this how your clients are enjoying their new landscaping?

1-866-485-7255
WWW.MISTAWAY.COM

BECOME A MISTAWAY DEALER TODAY!

CLASSIFIED SHOWCASE

ADVERTISING INFORMATION

Call Kelli Velasquez at
216-706-3767,
Fax: 253-484-3080,
E-mail:
kvelasquez@questex.com



Payment must be received by the classified closing date. We accept Visa, MasterCard, and American Express.

Mail LM Box # replies to:
Landscape Management Classifieds, LM Box # _____
306 W. Michigan St., Suite 200
Duluth, MN 55802
(please include LM Box # in address)

Every month the Classified Showcase offers an up-to-date section of the products and services you're looking for. **Don't miss an issue!**

BUSINESS OPPORTUNITIES

SELL MORE LANDSCAPES & JOBS



Two **NEW** Profit Centers - 50%+
Two **NEW** Revenue Streams
Two **NEW** Customer Bases
A Simple, Easy Add-On Service
Buy Factory Direct - Wholesale
NO PAYMENTS & INTEREST
FOR 90 DAYS
We **FUND** Your Installs
1-800-334-9005
www.allprogreens.com/training

FREE DVD & TRAINING
SYNTHETIC LAWNS

Incorporate
for as little as **\$99**

Visit www.incorporate.com
or call 800-616-0216

THE
COMPANY
CORPORATION®

INCORPORATING WHAT'S RIGHT FOR YOU

SELL MORE LANDSCAPES & JOBS



Two **NEW** Profit Centers - 50%+
Two **NEW** Revenue Streams
Two **NEW** Customer Bases
A Simple, Easy Add-On Service
Buy Factory Direct - Wholesale
NO PAYMENTS & INTEREST
FOR 90 DAYS
We **FUND** Your Installs
1-800-334-9005
www.allprogreens.com/training

FREE DVD & TRAINING
SYNTHETIC GOLF GREENS

WANT TO BUY OR SELL A BUSINESS?

Professional Business Consultants
Merger & Acquisition Specialists

Professional Business Consultants can obtain purchase offers from numerous qualified potential buyers without disclosing your identity. There is no cost for this as Consultant's fee is paid by the buyer. This is a **FREE APPRAISAL** of your business.

If you are looking to grow or diversify through acquisition, we have companies available in **Lawn Care, Grounds Maintenance, Pest Control and Landscape Installation** all over the U.S. and Canada.

182 Homestead Avenue, Rehoboth, MA 02769
708-744-6715 • Fax 508-252-4447
E-mail pbcsmello1@aol.com

EARN BIG
With Landscape Lighting



-Great Add-On Sale
-Enhance Your Projects
-Penetrate Affluent Households

WE CAN TEACH YOU TO DO LANDSCAPE LIGHTING THE RIGHT WAY!

Training ~ Support ~ Products
Call For Information
1.800.687.9551
www.nitetimesdecor.com



Snow, Lot Sweeping, & Landscape Contracts
Join the affiliation that works for YOU.
Contractors needed throughout the US.
Sign up today www.agmgus.com.
EXPERIENCE THE AGMG DIFFERENCE.

Looking to hire?



Reach **thousands** of professionals in your industry by placing a classified ad.

HELP WANTED

FLORASEARCH, INC.
In our third decade of performing confidential key employee searches for the landscape/horticulture industry and allied trades worldwide.
Retained basis only.
Candidate contact welcome, confidential and always FREE.
1740 Lake Markham Road
Sanford, FL 32771
407-320-8177 ♦ Fax: 407-320-8083
E-mail: search@florasearch.com
www.florasearch.com

landscapemanagement.net

CLASSIFIED SHOWCASE

PROPERTY FOR SALE

WESTERN NORTH CAROLINA:

5+ level acres,
located one mile from E/W interstate access;
40 miles from N/S interstate access.

Highway frontage, front & back entrances.
Over 3000 sq. ft. heated office & work or retail
space (security & internet wired) in Morton
building; 1100 sq. ft. heated shop space with
office in block building, open-sided structure
with 6 bays plus storage; small pond; 1000 gal.
gas tank with pump, 2 diesel tanks.

Please call **828-698-0073** or
email **abr3@morrisbb.net**
for more information.

SOFTWARE

TAKE YOUR OFFICE WITH YOU CLIP2Go



GPS Tracking + Bilingual Directions + Start/Stop Times for each Job

* Requires CLIPr, a Windows Mobile device, Garmin mapping software, Microsoft MapPoint and GPS receiver.

To Learn more call **800-635-8485** www.clip.com

AUTOMATE YOUR SUCCESS

with **GroundsKeeper Pro** business software

JUST \$399

SAVE THOUSANDS OVER
SIMILAR PROGRAMS

FREE TRIAL

FEATURES INCLUDE:

Billing Routing Optional credit card processing
Contracts Estimating Income & Expense Reporting
And More Scheduling Time & Materials

ADKAD TECHNOLOGIES / 1.800.586.4683 / WWW.ADKAD.COM/LM.HTM

Keep your business growing.

Advertise in Landscape
Management. Contact
Kelli Velasquez today:
216-706-3767
kvelasquez@questex.com

RESOURCES

AD INDEX

| | |
|---------------------------------------|-----------|
| BASF..... | cv3 |
| Ball Horticultural..... | 28 |
| Corona Clipper..... | 32 |
| Dow AgroSciences..... | 4, 10, 27 |
| Drafrix..... | 34 |
| DuPont..... | 2 |
| The Dwyer Group..... | 24 |
| Empire State Green Industry Show..... | 39 |
| Grasshopper..... | 25, BRC |
| Horizon..... | 29 |
| Hortica Insurance..... | 33 |
| Hustler Turf..... | 1 |
| John Deere Commercial..... | cv4 |
| John Deere Landscapes..... | BB |

| | |
|----------------------------|--------------------|
| LT Rich..... | 30 |
| Mid-Am Trade Show..... | 31 |
| Mistaway Systems..... | 37 |
| PBI/Gordon..... | 8 |
| Pine Hall Brick..... | 8 |
| Progressive Insurance..... | 23 |
| Pro-Tech Mfg..... | 6 |
| QXpress..... | 35 |
| Rain Bird..... | Insert, cv2, 11-22 |
| Reddick Equipment..... | 37 |
| SIMA..... | 36 |
| Subaru..... | 7 |
| U.S. Lawns..... | 3 |
| Walker Mfg..... | 5 |

Indices are provided as an additional service. The publisher does not assume any liability for errors or omissions.

LANDSCAPE MANAGEMENT (ISSN 0894-1254) is published monthly (12 issues per year) by Questex Media Group LLC, 306 W Michigan St, Suite 200, Duluth, MN 55802. **Subscription rates:** one year, \$54, two years \$76 in the United States & Possessions; \$87 for one year, \$127 for two years in Canada and Mexico; all other countries \$165 for one year, \$246 for two years. For airmail delivery, include an additional \$75 per order annually. Single copies (pre-paid only): \$8 in the United States; \$10 in Canada and Mexico; \$15 all other countries. Back issues, if available: \$16 in the U.S.; \$20 in Canada and Mexico; \$30 all other countries. Add \$6.50 per order for shipping and handling. Periodicals postage paid at Duluth, MN 55808 and additional mailing offices. **POSTMASTER:** Please send address changes to Landscape Management P.O. Box 1268, Skokie, IL 60076-8268. Canadian G.S.T. number: 840 033 278 RT0001. Publications Mail Agreement Number 40017597. Printed in the U.S.A.



Copyright 2010 Questex Media Group LLC. All rights reserved. No part of this publication may be reproduced or transmitted in any form or by any means, electronic or mechanical, including by photocopy, recording, or information storage and retrieval system, without permission in writing from the publisher. Authorization to photocopy items for internal or personal use, or the internal or personal use of specific clients, is granted by Questex Media Group LLC for libraries and other users registered with the Copyright Clearance Center, 222 Rosewood Dr., Danvers, MA 01923 phone: 978-750-8400 fax: 978-750-4470; call for copying beyond that permitted by Sections 107 or 108 of the U.S. Copyright Law. For those not registered with the CCC, send permission requests to questexpermissions@theygsgroup.com or phone 800-494-9051 ext. 100.

Landscape Management does not verify any claims or other information appearing in any of the advertisements contained in the publication, and cannot take any responsibility for any losses or other damages incurred by readers in reliance on such content. Landscape Management welcomes unsolicited articles, manuscripts, photographs, illustrations and other materials but cannot be held responsible for their safekeeping or return. Questex Media Group LLC provides certain customer contact data (such as customers' names, addresses, phone numbers and e-mail addresses) to third parties who wish to promote relevant products, services and other opportunities which may be of interest to you. If you do not want Questex Media Group LLC to make your contact information available to third parties for marketing purposes, simply call 866-344-1315; 847-763-9594 if outside the U.S. between the hours of 8:30 am and 5:00 pm CT and a customer service representative will assist you in removing your name from Questex Media Group LLC's lists.



Save the Date

January 11-13, 2011

Rochester Riverside Convention Center

Smart Growth - Learn with the Pros

Key Speaker:

Jennifer Grant, Ph.D. and the
team from Cornell University will
discuss organic lawn care.

Co-sponsored by



To request a brochure or more
information about the Empire State
Green Industry Show contact us at
(800) 873-8873, show@nysta.org or
visit our web site at www.nysta.org.

NYSDEC, PA, PGMS, RI and VT
Recertification Credits

CNLP Credits

EMPIRE STATE GREEN INDUSTRY SHOW

MYBIGGESTMISTAKE

LESSONS LEARNED THE HARD WAY » BY CASEY PAYTON



A big boom in business became too much to manage for Texas' Native Land Design.

WHEN THE ECONOMY was robust and business was booming in 2006/2007, Native Land Design went from a \$4 million business to a \$10 million one in just two years. "People may think, 'How could almost tripling your business hurt you?' and I thought that too," says Ben Collinsworth, CEO of the Cedar Park, TX-based business. "But it can. We have been taught that growth is good, profit is good, and if you're doing those things right, then everything else will take care of

itself. That is a fallacy in business. Growth can be good when you know what you are getting yourself into and when you develop a model to follow through on the needs of the business. Without a plan, the growth can spin you out of control."

And that's just what happened. As Collinsworth started taking on any and every job that came through the door, he began slipping on payments and wasn't staying on top of accounts. He felt like the company was spending all of its time trying to catch up with the impossibly fast pace they'd set instead of having a solid plan to follow.

"I was steering in the dark," he admits. "Clients were paying bills slower

than I was used to ... stretching payments past the 60 and 90 days. Even if we had \$700,000-plus dollars a month in revenue, that didn't mean we were collecting that in cash each month."

With payroll and taxes to pay, Collinsworth's vendors ended up being the ones to take the hit. "And as we slowly paid vendors, because our bank lines weren't large enough to handle the cash flow deficit, they started limiting our ability to buy," he says. "That put us in a crunch. If you can't pay for the cash flow deficit, you can't perform the work. Even though we were showing a profit, the cash wasn't available until it was received in the office."

Though things seemed to be spiraling out of control, Collinsworth made some wise decisions that not only saved his business but made it much more successful in the long run. First, he let go of his Dallas market — what he admits was an emotional decision losing some of the business he had built up. "I had to cut off a piece of the business to make it more manageable," he says. "If I hadn't made that decision, I'm not sure we'd be here. It allowed me to really concentrate on the other markets we had."

Getting involved with peer groups and soliciting feedback from more experienced business owners was the other decision that

helped turn Collinsworth's predicament around. "Business owners need to realize seeking advice isn't a sign of weakness, it's a sign of strength," he says. "The best landscape business owners I know surround themselves with the smartest people who give them hard feedback. Without those sounding boards, you are destined to make bad decisions from a lack of experience. Find a good base of professional people to bounce ideas off of and make sure you are heeding their warnings."

Collinsworth says there are many changes he would have made early on to prevent the company from growing quicker than he could manage. He would have solicited feedback from his CPA, hired a full-time controller and paid closer attention to his balance sheets. Most importantly, Collinsworth says he wouldn't have taken on as many jobs with the mindset that he'd figure things out as he went along.

"I would have had a more detailed and well-thought-out plan from the start," he says.

Today, Collinsworth takes things at a slower pace. "It can take some hard lumps in business to realize that conquering the world too quickly isn't worth the headache," he says. "That is something that we still practice to this day. Setting budgets for slower growth is now standard in our expectations."

The author is a freelance writer with six years of experience covering landscaping.



Ben Collinsworth

COMPANY: Native Land Design
CEO: Ben Collinsworth
HEADQUARTERS: Cedar Park, TX
FOUNDED: 2001
EMPLOYEES: 200-plus
2006/2007 REVENUE: \$4 million
2009/2010 REVENUE: \$10 million-plus
WEB: www.nativelanddesign.com
BEST ADVICE: Solicit advice from your CPA and industry peers and pay close attention to balance sheets.