

C R A B G R A S S ?

TAKE CONTROL WITH PENDIMETHALIN.

If crabgrass is a growing problem on your turf, you're not using the right herbicide. What you need is Pendimethalin.

No other preemergent offers a broader spectrum of control. Fact is, this high-performance herbicide effectively controls crabgrass, most annual grassy



weeds, and many annual broadleaf weeds, stop growing—and start dying—before emerging.

What's more, Pendimethalin works hard—and long.

Through the entire season. That's because its low volatility and slow decomposition characteristics keep it active in the soil longer.

Pendimethalin also makes your life easier. You have the flexibility to spread it on as a dry granule,

alone, or in

combination

with fertilizer

products. Or

you can use

the sprayable formulations, available as a 3.3 EC,

60 WDG and 60 WP.

No wonder professional turf managers have made Pendimethalin the #1 preemergent herbicide.

So take control of your turf—and your reputation. Use Pendimethalin herbicide to control crabgrass and more. Because the only thing you should see growing like a weed is beautiful grass.

Call now for more information or for the distributor nearest you.

1-800-545-9525

extension 1609A

T
A
K
E
C
O
N
T
R
O
L



CRABGRASS CONTROL

PRODUCT	Rate (lb ai/A)	% Control	
		97 DAT	129 DAT
PENDIMETHALIN 60WDG	3.0	97	97
PENDIMETHALIN 60WDG	1.5+1.5	98	98
BARRICADE 65WG ^a	0.75	100	100
DIMENSION 1EC ^b	0.5	99	99
TEAM .87 FG ^c	1.5+1.5	88	82

Ohio State University 1996

And Pendimethalin has excellent turf tolerance.

University and field research studies have shown that Pendimethalin provides consistent, superior weed control—yet offers tremendous tolerance to warm- and cool-season turfgrasses.

Here's how it works: After Pendimethalin makes contact with the germinating weed seed, it disrupts the seed's biochemical processes,

which makes the weed seed

CRABGRASS CONTROL

PRODUCT	Rate (lb ai/A)	% Control	
		84 DAT	154 DAT
PENDIMETHALIN 60WDG	3.0	100	93
PENDIMETHALIN 60WDG	1.5+1.5	100	99
BARRICADE 65WG ^a	0.75	100	95
DIMENSION 1EC ^b	0.5	100	86
RONSTAR 2G ^c	2+2	97	24

Virginia Polytechnic Institute & State University

P E N D I M E T H A L I N .

LANDSCAPE *management*

INSIDE

GREEN BOOK 1998

ON THE COVER: KEEP THE TURF AND ORNAMENTALS GREEN AND GROWING WITH HELP FROM THE PEOPLE AND PRODUCTS LISTED IN GREEN BOOK 1998.

GREEN BOOK 1998

8 GREEN INDUSTRY ASSOCIATIONS

32 EVENT CALENDAR

40 UNIVERSITY CONTACTS

52 REGULATORY CONTACTS

56 POISON CONTROL CENTERS

60 STATE POSTING REGULATIONS

64 GUIDES TO COOL- AND WARM-SEASON WEED, INSECT AND DISEASE CONTROL

84 EDITORIAL INDEX
Feature articles
News stories
Contributing authors

88 PRODUCT INDEX

64

68

74

89 PRODUCTS & SERVICES
Equipment: 89
Suppliers and services: 105
Control products: 109
Seed/sod/sprigs: 119

123 DISTRIBUTOR LISTINGS

140 SUPPLIER ADDRESSES

173 PRODUCT REVIEW

COLUMNS

2 OPENING SHOTS

DEPARTMENTS

176 AD INDEX

177 CLASSIFIED

LANDSCAPE MANAGEMENT (ISSN 0894-1254) is published monthly by Advanstar Communications, Inc. Corporate, editorial and advertising offices: 7500 Old Oak Blvd., Cleveland, OH 44130. Accounting, advertising production and circulation offices: 131 West First St., Duluth, MN 55802.

Subscription rates: one year, \$39, two years \$58 (U.S.); one year \$66, two years \$99 (Canada and Mexico); one year \$130, two years \$195 (all other countries). For air mail delivery, include an additional \$70 per order annually. Current issue single copies (pre-paid only): \$4 (U.S.); \$7 (Canada and Mexico); \$12 (elsewhere); add \$3.50 per order for shipping and handling. Back issues, if available, \$10 (U.S.); \$14 (Canada and Mexico); \$20 (other countries); add \$3.50 per order for shipping and handling (pre-paid orders only).

Office of publication: Advanstar Communications, Inc., 131 W. First St., Duluth, MN 55802. Periodicals postage paid at Duluth, MN 55806 and additional mailing offices.

Copyright ©1997 by Advanstar Communications, Inc. All rights reserved. No part of this publication may be reproduced or transmitted in any form or by any means, electronic or mechanical, including photocopy, recording, or any information storage and retrieval system, without permission in writing from Advanstar Marketing Services, Attn: Permissions, 7500 Old Oak Blvd., Cleveland, OH 44130 or phone (800) 225-4569 x742. Authorization to photocopy items for internal or personal use, or the internal or personal use of specific clients, is granted by Advanstar Communications for libraries and other users registered with the Copyright Clearance Center.



Canadian G.S.T. Number: R-124213133, IPM number: 841919

POSTMASTER: Send address changes to Landscape Management, P.O. Box 6198, Duluth, MN 55806.



Looking over our article index for 1997, we're glad to have brought you a variety of articles and news this year. But onward we go, as many things we reported on for you in 1997 will continue to pick up steam in 1998.

The biological market is "bubbling," as we wrote in June. These products are getting the attention of our leading turfgrass researchers, and have achieved official "seminar subject status" at turfgrass conferences.

Those who have reported favorably on biological products include Dr. Hank Wilkinson of the Univ. of Illinois, Dr. Fred Baxendale of Nebraska, and Dr. Eric Nelson of Cornell. Nelson, while not endorsing any particular bio product, spoke of their promise at the New York State Turfgrass Association show in Syracuse last month. Some superiors like them for positive pr, says Nelson. The "environmentally friendly" angle, a valid concern, is more acceptable to some. The questions is, are they also easy to fit into existing control strategy?

"Others see biological controls as perhaps the most effective and sustainable approach to disease management," says Nelson. The use of corn gluten meal products as herbicides is on the rise, reports Nelson. Discovered by Dr. Nick Christians of the University of Nebraska, and reported on by LM a couple years back, five million pounds have been sold in 1997, for goosegrass and crabgrass control. Not a huge amount, but it's good to see an "alternative" product that works. There are also some notable new control products from the big boys, such as Rohmid's MACH 2, Bayer's Merit, and Conserve, from DowAgrosciences (the soon to be new name for DowElanco).

We feel we were assertive in our athletic field

editorial this year. Groups such as the STMA and its regional chapters; people such as Floyd Perry; Dr. Kent Kurtz; David Mellor; and Dr. David Minner have all contributed mightily this year. Managing editor Ron Hall and myself have spoken with many other athletic turf managers who feel the most important issue of the day is finding ways to fund turfgrass management and renovation. Watch for more on this from LM in 1998.

We're proud to have been the first Green Industry magazine to highlight the growing need for equipment maintenance training, and the lack of good mechanics in times of full employment.

We also broke the story on the Green Industry labor crisis, which earned us an award from Turf & Ornamental Communicators Association (TOCA). In fact, we took six TOCAs!

Other employee issues we covered in 1997: recruitment; training; retention; incentive pay and motivation.

In October, we brought you our *35th Anniversary Issue*, a special look back at how far the industry has come since 1962.

Looking ahead, the EPA is on a roll as it cranks up its Food Quality Protection mandates and examines endocrine disorders and children's exposure to pesticides and dirty air.

But let's not get too excited about 2000. It's just another year when it comes to getting the customers, getting the employees, getting the funding, and getting the job done. There are no breaks from '99-00, and the season then will be just as long as in any other year.

As editors, we know what you want to see from this magazine, and we strive to get you the best information you can use on any given day.

This *Green Book* is an example. It's your year-long reference to the people and places that make the Green Industry tick. Just about anyone you need to call is listed here, from turfgrass researchers to equipment manufacturers. When you have a question that needs answering, think '*Green Book*,' and your answer is not far off.

Best wishes for a great '98!

Green Industry ideas, issues are 'to be continued'



Terry McIver

TERRY McIVER
Editor-in-Chief

There's more than fertilizer in this bag.



There's a total resource. One that can help you grow healthy, green turf with a strong root system and a solid base. Turf that's healthy and better able to fight disease, pests and everyday wear and tear. That resource is Terra. You'll find a complete, new line of Terra Professional Fertilizers – with primary, secondary, micronutrient and pesticide packages available. Plus, you can count on the support, service, assistance and expertise it takes to select and use the right

fertilizer. The product that will do the job for you. For fertilizers, turf seed, plant protection products and a whole lot more – work with Terra. You'll get more.



Terra Industries Inc.
P.O. Box 6000
Sioux City, Iowa 51102
1-800-831-1002
www.terrainindustries.com

Working with you.



Circle No. 131 on Reader Inquiry Card



Every lawn and landscape has thousands of tiny time bombs hiding in the soil. Broadleaf weed seeds. And the best time to stop the explosion

is before they emerge. A preemergent herbicide application creates a zone of protection where weeds get whacked as fast as they germinate.

So your customers never see any weeds, and the turfgrass gets off to a fast, healthy start. It works so well, it can eliminate a lot of callbacks and



©Trademark of DowElanco

How to defuse a lawn.



maybe two or three postemergence herbicide applications. One treatment of Gallery® preemergent herbicide is all it takes. Use it spring or fall on

turf or ornamentals to prevent more than 95 kinds of broadleaf weeds for up to eight months. Now, Gallery is even labeled for use in

California. Always read and follow label directions. For more information, call us toll-free at 1-800-352-6776.

 DowElanco

Gallery®

"PEN WRITER"

If you could make more money, increase your customer service & eliminate posting...

Would You?



"Pen Writer" electronically synchronizes The Newton-MP 2000 hand held, with 16.1mhz speed & 5mb Ram, and "Route Rite" software, version 3.2+. Providing an efficient paperless environment for your office, a hardcopy for your customer without the technician needing to come back to the office. No Posting because its all electronic.

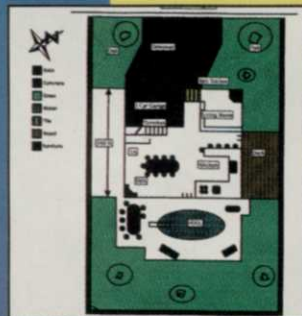

"Pen Diagramer Plus" allows the integrated drawing of diagrams with labels, notes, findings & recommendations. This makes our inspections reports a breeze. Fill in the blanks, Draw, Print, fax, integrate it or upload it, from the field.



Bar-code item with "Pen Diagramer Plus" and wand. Scan barcodes with date, time and your notes. Accurate reporting!

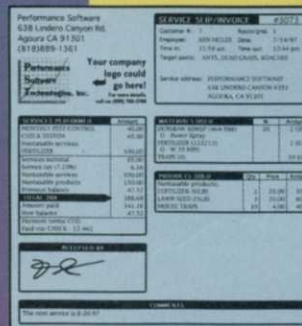

Invoices printed right at the customers door with your logo. The customer signs on "Pen Writer" and it is printed on bill. It is also great for bids with inventory of material, product, people, & equipment costs.

"Route Rite" is our fully featured desktop routing and accounting package, since 1991. It is totally integrated and works in the DOS, Win.

3.11, Win 95, single and multi-user environments with Novell, NT, Win Terms, Intranet, DDE, DLL, ODBC & data warehousing. Mix & match your needs.

Purchase or Lease (from \$85.00 monthly - includes "Route Rite" 1000, plus one "Pen Writer" software & MP2000, "Pen Diagramer Plus"). Printers, Barcode Wands & fax modems are optional.

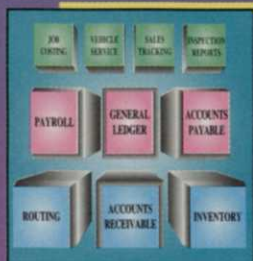

For more information please
CALL 800-788-0788,
FAX 818-889-4623
or visit us on the
INTERNET www.gopst.com

Performance
Software
Technologies, Inc.

"Route Rite", "Pen Writer", "Pen Diagramer Plus" are registered trademarks of Performance Software Technologies, Inc. DOS, Windows and NT are products of Microsoft. Newton is a registered trademark of Newton, Inc.

Circle 123

LANDSCAPE management

EDITORIAL STAFF

Terence McIver **Editor-in-Chief** (216) 891-2709
E-mail: tmciver@advanstar.com
Ron Hall **Managing Editor** (216) 891-2636
E-mail: rhall@advanstar.com
Dr. Bill Knoop **Technical Editor** (903) 860-2410
E-mail: knoop@mt-vernon.com
Vernon Henry **Group Editor** (216) 826-2829
Lisa Lehman **Art Director** (216) 891-2785
Lisa Bodnar **Graphic Designer** (216) 891-3101

READER ADVISORY PANEL

Jerry Coldiron **Boone Links / Lassing Pointe G.C.** Florence, Ky.
Corey Eastwood **Stockdale Country Club** Bakersfield, Calif.
Mike Guthrie **Ground Control Landscaping** Orlando, Fla.
Larry Iorri **Down to Earth Landscaping** Wilmington, Del.
Pat Nibler **ProGrass** Wilsonville, Ore.
David Mellor **Milwaukee Brewers** Milwaukee, Wisc.

BUSINESS STAFF

William J. Cooke **Executive Vice President** (216) 891-3130
John D. Payne **Group Publisher** (216) 891-2786
Brenda Dunlap **Administrative Coordinator** (216) 891-2734
Linda O'Hara **Senior Production Manager** (218) 723-9281
Karen Laszlo **Controller/Marketing Director** (216) 891-2705
Debi Harmer **Production Director** (218) 723-9325
Karen Edgerton **Circulation Manager** (218) 723-9280
Lynn Viele **Green Book Coordinator** (218) 723-9393

ADVERTISING OFFICES

Headquarters 7500 Old Oak Blvd.
Cleveland, OH 44130-3369
(216) 243-8100 Fax: (216) 891-2675
John D. Payne **Group Publisher** (216) 891-2786
E-mail: jpayne@advanstar.com
Patrick K. Toal **Regional Manager**
(904) 280-4205 Fax: (904) 280-2122
E-mail: ptool@advanstar.com
Tom Galligan **National Sales Manager**
3901 52nd Ave.
Kenosha, WI 53144-1830
(414) 653-9523 Fax: (414) 653-9524
E-mail: tgalligan@advanstar.com
John Kiesewetter **Western Sales Manager**
859 Willamette St.
Eugene, OR 97401
(541) 461-0022 Fax: (541) 461-0044
E-mail: jkiesewetter@advanstar.com
Denise Zappala **Classified / Market Showcase** (216) 891-3162
Anthony Lavdas **Account executive** (216) 891-3118

MARKETING SERVICES

Marcie Nagy **Reprints (100 minimum)** (216) 891-2744
Mike Balzano **Circulation List Rental** (800) 225-4569, ext. 697
Advanstar Marketing **Microrfiche/film Copies** (800) 225-4569, ext. 839
Chris Baxter **Subscriber/Customer Service** (218) 723-9477
Tammy Lillo **International Licensing** (218) 723-9518
Books, directories, back issues, photocopies
(800) 598-6008; (218) 723-9180



ADVANSTAR
COMMUNICATIONS

Chairman and Chief Executive Officer Robert L. Krakoff
Vice Chairman James M. Alic
VP, Business Development Skip Farber
VP/Finance, CFO and Secretary David W. Montgomery
VP, Strategic Planning Emma T. Lewis
Executive Vice Presidents Kevin J. Condon, William J. Cooke,
Alexander S. DeBarr, Brian Langille,
Glenn A. Rogers
Treasurer & Controller Adele D. Hartwick



Move to Kubota Country

Move to Kubota country and you'll find versatility, durability and operator comfort. The Kubota B-Series (13 to 18 PTO horsepower) tractors are compact to fit in tight places and powerful to get lots of jobs done. Kubota performance matched implements include rotary tillers, front loaders, mid and rear mount mowers, boxscrapers and snowblower.

Need more power? Move up to the innovative Grand L-Series (25 to 37 PTO horsepower). Hydrostatic steering, shuttle transmission with shift-on-the-go provides ease of operation. Kubota's exclusive optional Glideshift transmission has clutchless operation through all eight speeds, forward and



reverse. These tractors are smooth and quiet, with Kubota's E-TVCS engine which ensures clean emissions while providing high torque rise. Get one with an integral cab with heat and air-

conditioning for year 'round comfort.

Visit your Kubota dealer and find out how to make your move - to Kubota country!



For more information, please write to:

Kubota®

KUBOTA TRACTOR CORPORATION

P.O. Box 2992, Dept. LM

Torrance, CA 90509-2992

or call Toll Free 1-888-4 KUBOTA ext. 403

(1-800-458-2682 ext. 403)

Financing available through Kubota Credit Corporation



Jeepers, creepers, where'd you get that Sweeper?

Great for
all season
cleaning!



SWEEPSTER

1-800-715-5308

www.sweepster.com

Circle 136

Introducing A New Kind of Savings Plan:

Jiffy-Pots® from Jiffy Products

Plant pot-and-all!

Jiffy-Pots are 100%
biodegradable - roots
grow right through
the pot wall!



• Save time.

• Save labor.

All natural Jiffy-Pots from Jiffy Products increase efficiency,
eliminate waste and add favorably to your bottom line.
Available in a full range of sizes to meet any planting need.

Call 1-800-323-1047 to start your new savings plan today!



Jiffy Products

Jiffy Products of America, Inc.
Batavia, IL 60510
Fax: 630-406-3906
www.jiffyproducts.com

• Save money.

Circle 114

LANDSCAPE management

A proud supporter of these green industry
professional organizations:



Associated Landscape Contractors of America
150 Elden Street, Suite 270, Herndon, VA 20170
(703) 736-9666; <http://www.alca.org>



**American Association of Nurserymen
(National Landscape Association)**
1250 I St. NW, Suite 500, Washington, DC 20005
(202) 789-2900



Golf Course Superintendents Assn. of America
1421 Research Park Dr.
Lawrence, KS 66049-3859
(913) 841-2240; <http://www.gcsaa.org>



**Independent Turf and Ornamental
Distributors Association**
1217 Wayburn
Grosse Pointe Park, MI 48230
(313) 331-7739

International Turfgrass Society

Crop & Soil Environmental Sciences, VPI-SU,
Blacksburg, VA 24061-0403
(561) 996-3062



National Arborist Association

The Meeting Place Mall, P.O. Box 1094,
Amherst, NH 03031-1094
(603) 673-3311; <http://www.natlarb.com>



National Golf Foundation

1150 South U.S. Highway One, Jupiter, FL 33477
(407) 744-6006



Ohio Turfgrass Foundation

P.O. Box 14824, Columbus, OH 43214
(614) 261-6750

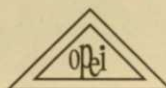

The Outdoor Power Equipment Institute

341 South Patrick St.
Old Town Alexandria, Va. 22314
(703) 549-7600; <http://opei.mow.org>



Professional Grounds Management Society

120 Cockeysville Rd., Suite 104,
Hunt Valley, MD 21031
(410) 584-9754



Professional Lawn Care Association of America

1000 Johnson Ferry Rd., NE, Suite C-135,
Marietta, GA 30068-2112
(770) 977-5222; <http://www.plcaa.org>



Responsible Industry for a Sound Environment

1156 15th St. NW, Suite 400,
Washington, DC 20005
(202) 872-3860



Sports Turf Managers Association

1375 Rolling Hills Loop, Council Bluffs, IA 51503-8552
(712) 366-2669; (800) 323-3875;
<http://www.aip.com/stma>

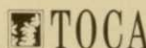

Turf and Ornamental Communicators Association

P.O. Box 156, New Prague, MN 56071
(612) 758-5811

No Matter What the Job Always Take a ShortCut™



New HBar Steering

The most operator-friendly steering system on the market – the learning curve is measured in minutes, not hours.

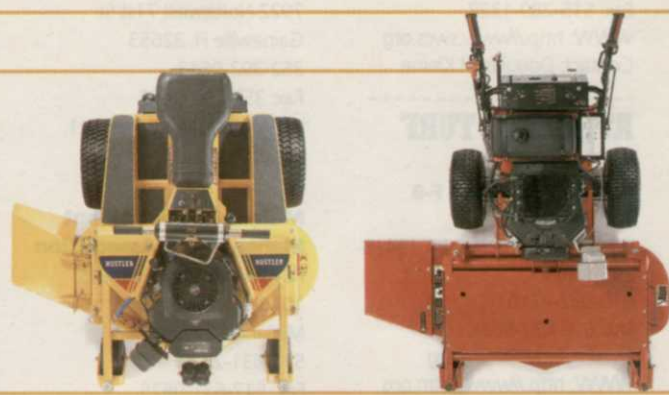
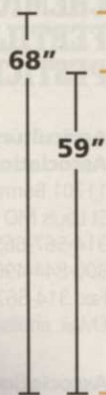

The Hustler ShortCut is more compact than comparable walk-behind mowers.

- ▶ True zero degree turns and compact size – twice as productive as hydro walk-behinds, even more productive than either front-mount or mid-mount zero turn riders.
- ▶ Choose between sitting or standing – mow comfortably all day long.
- ▶ Several horsepower and deck sizes to choose from – there's a ShortCut to meet your needs.

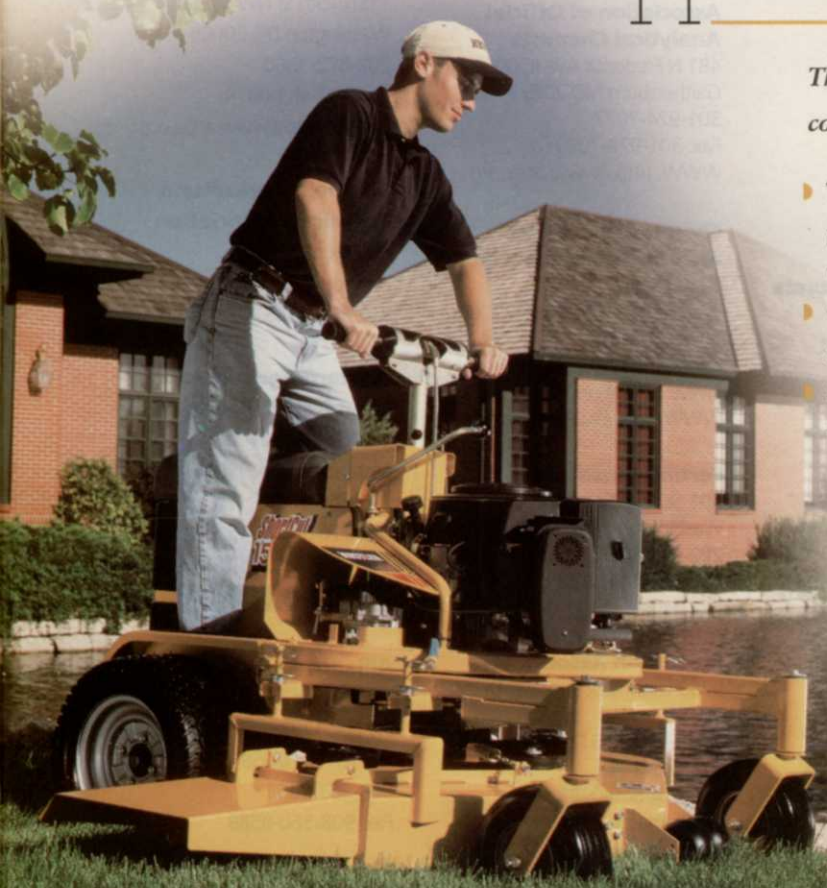

HUSTLER®

Out Hustle all the rest™

1-800-395-4757

www.excelhustler.com

Excel Industries, Inc. ■ Hesston, KS 67062

Circle No. 110 on Reader Inquiry Card

AGRONOMY

American Society of Agronomy/Crop Science Society of America
 677 S Segoe Rd
 Madison WI 53711
 608-273-8080
 Fax: 608-273-2021
 WWW: <http://www.agronomy.org>

Soil & Water Conservation Society
 7515 N E Ankeny Rd
 Ankeny IA 50021
 515-289-2331
 Fax: 515-289-1227
 WWW: <http://www.swcs.org>
 Contact: Douglas M Kleine

ATHLETIC TURF

ASTM Committee F-8
 100 Barr Harbor Dr
 West Conshohocken PA 19428-2959
 610-832-9710
 Fax: 610-832-9666
 EMail: gluciw@astm.org
 WWW: <http://www.astm.org>
 Contact: George Luciw

National Institute on Park & Grounds Management
 730 W Frances St
 Appleton WI 54914-2365
 920-733-2301
 Fax: 920-733-2301
 EMail: nipgm@tpo.org
 Contact: Barbara Walters

National Recreation & Park Association
 22377 Belmont Ridge Rd
 Ashburn VA 20148
 703-858-0784
 Fax: 703-858-0794
 WWW: <http://www.nrpa.org>
 Contact: Kathy Spangler

Sports Turf Association Canada
 328 Victoria Rd
 Guelph ON Canada N1H6H8
 519-763-9431
 Fax: 519-766-1704
 WWW: <http://www.voguelph.ca/gti/gest/sta.htm>
 Contact: Lee Huether

Sports Turf Managers Association
 1375 Rolling Hills Loop
 Council Bluffs IA 51503-8552
 712-366-2669
 Fax: 712-366-9119
 EMail: trustytips@aol.com
 WWW: <http://www.aip.com/stma>
 Contact: Lee Huether

AQUATICS

Center for Aquatic Weed Control
 University of Florida
 7922 Northwest 71st St
 Gainesville FL 32653
 352-392-9613
 Fax: 352-392-3462
 WWW: <http://www.aquat1.ifas.ufl.edu/>

Midwest Aquatic Plant Management Association
 Roy LeFevre Dow Gardens
 1018 W Main St
 Midland MI 48640
 517-631-2677
 Fax: 517-631-0675

USDA Aquatic Weed Laboratory
 University of California
 Davis CA 95616
 916-752-0631

Water Wastewater Equipment Manufacturers Association
 Dulles International Airport
 PO Box 17402
 Washington DC 20041
 703-444-1777
 Fax: 703-444-1779

BOTANY

American Society of Plant Physiologists
 15501 Monona Dr
 Rockville MD 20855
 301-251-0560
 Fax: 301-279-2996
 EMail: aspp@aspp.org
 WWW: <http://www.aspp.org>
 Contact: Kenneth M Beam

International Plant Propagators Society Western Region
 743 Linda Ave NE
 Salem OR 97303-4549
 503-393-2934
 Fax: 503-393-2030
 EMail: wbluhm@juno.com
 Contact: Wilbur L Bluhm

US Botanic Garden Conservatory
 First St & Maryland Ave SW
 Washington DC 20024
 202-225-8333

CHEMICALS/ FERTILIZERS/ PESTICIDES

Agricultural Retailers Association
 11701 Borman Dr Ste 110
 St Louis MO 63146
 314-567-6655
 800-844-4900
 Fax: 314-567-6808
 EMail: amills@agretailerassn.com

Association of Official Analytical Chemists
 481 N Frederick Ave #500
 Gaithersburg MD 20877
 301-924-7077
 Fax: 301-924-7089
 WWW: <http://www.aocac.org>

Chemical Specialties Manufacturers Association
 1913 I St NW
 Washington DC 20006-2106
 202-872-8110
 Fax: 202-872-8114
 EMail: csma@juno.com
 WWW: <http://www.csma.org>

Fertilizer Institute
 501 Second St NE
 Washington DC 20002
 202-675-8250
 Fax: 202-544-8123

Mid America Crop Protection Association
 9735 Landmark Parkway Dr Ste 14
 St Louis MO 63127
 314-849-9446
 Fax: 314-849-0988
 EMail: macpa@tetranet.net

National Agricultural Chemicals Association
 1156 15th St NW
 Washington DC 20005
 202-296-1585
 Fax: 202-463-0474

National Fertilizer Solutions Association
 11701 Borman Dr
 St Louis MO 63146
 800-844-4900
 Fax: 314-567-6808
 EMail: amills@agretailerassn.com

Potash & Phosphate Institute
 655 Engineering Dr Ste 110
 Norcross GA 30092-2837
 770-447-0335
 Fax: 770-448-0439
 EMail: sfox@ppi-far.com
 Contact: David W Dibb

Responsible Industry for a Sound Environment
 1156 15th St NW Ste 900
 Washington DC 20005
 202-872-3860
 Fax: 202-463-0474
 WWW: <http://www.acpa.org>

Southern Agricultural Chemicals Association
 PO Box 686
 Dawson GA 31742
 912-995-2125

Western Agricultural Chemicals Association
 3835 N Freeway Blvd
 Sacramento CA 95834
 916-568-3660
 Fax: 916-565-0113

ENVIRONMENTAL

Alliance for Environmental Concerns
 PO Box 4292
 Warren NJ 07059-4292
 908-563-9252
 Fax: 908-560-8588