

# OFTANOL USERS KNOW THE BEST WAY TO OUTSMART GRUBS IS WITH A LITTLE EXTRA HOMEWORK.

Getting rid of grubs that attack your customers' lawns can be pretty tricky sometimes. Unfortunately, simply treating against these destructive pests doesn't always guarantee success.

But many lawn care operators have learned that all it takes to outsmart grubs is a little preparation—finding the right product and the right time of year to make the application. The product is OFTANOL Insecticide. Studies show that time after time, OFTANOL provides grub control. And delivers better control than other widely used products such as Sevin® and Diazinon Insecticides.

The right time to apply it? That will vary from region to region. But a good rule of thumb is

©1992 Miles Inc. 923101

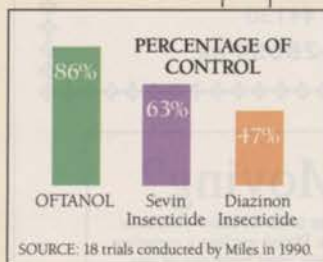

to treat with OFTANOL when grubs are at or near the surface. An easy way to check is by just pulling back a bit of sod and looking for an infestation. Or call your local Extension office to determine peak periods of grub feeding in your area.

These are, of course, just the basics of effective grub control. If you'd like to learn more about OFTANOL and its proper usage, contact your local Miles representative. Or just give us a call at (800) 842-8020. One of our trained professionals

will be standing by to answer your questions. Miles Inc., Specialty Products, Box 4913, Kansas City, MO 64120.

So why let grubs continue to test your patience when the easy answer is OFTANOL.



Sevin is a Reg. TM of Rhone-Poulenc Ag Company



JAN FEB MAR APR MAY JUN JUL AUG SEP OCT NOV DEC

EGG LAYING PERIOD

**RATES:** \$1.25 per word (minimum charge, \$40). Bold face words or words in all capital letters charged at \$1.50 per word. Boxed or display ads: \$105 per column inch-1x (one inch minimum); \$100-3x; \$95-6x; \$90-9x; \$85-12x. (Frequencies based on a calendar year). Agency commissions will be given only when camera-ready art is provided by agency. For ads using blind box number, add \$20 to total cost of ad per issue. Send ad copy with payment to Susan Ramseth, LANDSCAPE MANAGEMENT, 7500 Old Oak Blvd., Cleveland, OH 44130 or call 216-891-2742. Fax Number 216-826-2865.

**BOX NUMBER REPLIES:** Mail box number replies to: LANDSCAPE MANAGEMENT, Classified Ad Department, 120 W. 2nd St., Duluth, MN 55802. Please include box in address.

## POSITION WANTED

### FREE CLASSIFIED AD

To all "POSITION WANTED" Classified Advertisers!

- Maximum 40 words
- Maximum 2 issues

Offered as an industry service - Let LANDSCAPE MANAGEMENT help you with your employment needs. For more information contact:

**Susan Ramseth**  
**LANDSCAPE MANAGEMENT**  
 7500 Old Oak Blvd., Cleveland, OH 44130  
**216-891-2742-Phone 216-826-2865-Fax**

**LOOKING FOR A HOME:** Hard working, reliable, honest, landscaping & irrigation professional of 15 years with "Hands on Philosophy" looking to relocate to the Rocky Mountain Region. Seeking employment with a company committed to excellence. Desires to work toward partnership. Ken Mencil, 85 Woodmere Road, Bridgeport, CT 06610 (203)372-7828 FAX (203)372-7175. 9/92

## Moving?

Be sure to let us know your new address. Please enclose a complete address label from one of our recent issues.

## BUSINESS FOR SALE

**FOR SALE:** Reputable and prosperous Lawn Care, Tree Care and Lawn Irrigation business in Southern New Jersey. Gross sales \$500,000. Customer accounts: 1,075 Lawn Care, 300 Tree Care and 975 Irrigation. Highly skilled personnel. Tangible assets exceed \$150,000. Modern office and operations center on 6.5 acres available. Great expansion opportunity for growth oriented company. Owner retiring. Call Doug after 6 p.m. 609-726-1521. 7/92

**LANDSCAPE MAINTENANCE BUSINESS FOR SALE** - 100 plus solid accts dating back to 1984. Potential unlimited. In fast growing Tri-State River Area of Bullhead City, AZ. \$110K. (602)754-3277 Evenings. TF

**Cemetery For Sale:** 15 acre cemetery 1 hour Metro D.C. in W. Va. For information contact John Thompson. RE-MAX. 301-739-4800. 7/92

## EQUIPMENT FOR SALE

**PIPE LOCATOR INEXPENSIVE!** Locates, traces underground drain, water pipe lines of clay, PVC, ABS, steel, cement. Finds sprinklers, valves, clogs. Bloch Company, Box 18058, Cleveland, Ohio 44118. (216)371-0979. TF

## BUSINESS OPPORTUNITIES

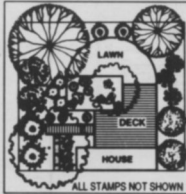

**LANDSCAPE DESIGN KIT 3 SAVES YOU TIME**  
 48 rubber stamp symbols: trees, shrubs, rocks, step stones, vine, & more. 1/4-1 3/4 in. dia  
 \$74.95 + \$4.50 sh  
 CA orders add 7 3/4% tax. 28 PG STAMP BROCHURE \$1.00  
**AMERICAN STAMP CO.**  
 12290 Rising Rd., Dept. 1192  
 WILSON, CA 95693  
 VISA MasterCard Phone (916) 687-7102

**GARDEN CENTER, GIFT SHOP, FLORIST-** Near Annapolis, MD. Well established and very profitable. Major hwy. Location on 2.66 acres improved with 2 bldgs. Real Estate included in sale. Business Brokers Unlimited (410)269-8833. 7/92

**NOW... LEARN PROFESSIONAL LANDSCAPING AND GARDENING AT HOME!** Accredited program provides thorough training in all phases of commercial and residential landscaping. Diploma awarded. Free booklet describes program and opportunities in detail. Lifetime Career Schools, Dept. A-578, 101 Harrison St., Archbald, PA 18403. 9/92

Live and work on the beautiful island of Maui in the State of Hawaii. Well established landscape & lawn maintenance business for sale. Major commercial and residential contracts. Long list of equipment in like new condition. Work year-round. Excellent growth possibilities. Illness forces sale. Asking \$300,000. Call (808)877-3644. 7/92

**OWN YOUR OWN TREE/LAWN SPRAYING ROUTE.** Low to no \$\$ down!! Why work for someone else, when you can be your own boss earning 60-85K per year! Several territories available in Long Island, New York's prestigious communities. Qualified individuals must have minimum two years managerial background and or three years field experience. Apply in strict confidence to: LM Box 493. 8/92

**LET THE GOVERNMENT FINANCE** your new or existing small business. Grants/loans to \$500,000. Free recorded message: (707)448-0330. (OL8) 7/92

**ARE CHEMICALS KILLING THE CHEMISTRY BETWEEN YOU AND YOUR CUSTOMERS?** If you're not growing, you might want to consider converting to or adding a NaturalLawn Franchise. We are the industry leader in organic-based lawn care. We offer reduced franchise fees to existing businesses with a minimum of \$50,000 in existing annual lawn care revenue. **NaturalLawn of America, Mike Catron, 1-800-989-5444 (C).** 7/92

**EXCITING OPPORTUNITY/"SLEEPING GIANT!"** Organic lawn care company with dynamic track record seeking to expand nationally. Looking for investors - partners - lenders or sale. **HIGH** rate of return and/or shared equity option. For further information call (716)442-2151, in Rochester, NY. 7/92

**FOR SALE:** Jacobsen E10 5 gang Blitzer \$4,750. Jacobsen 3 gang Blitzer \$1,500. Toro Park Master 7 gang mower \$7,250. (OBO). (501)776-3802, Jim. 7/92

## MID DAKOTA CORP. TREE TRANSPLANTER

Lightweight, Variable Size Rootball (16" - 28"), Component Adaptable (sprayer, logsplitter, dump box, post-hole digger). Available in 3 models (towable, bucket mount, 3 pt.).

### MID DAKOTA CORP.

Box 728 • Garrison, ND 58540

Phone (701) 337-5619 or 1-800-327-7154

GSA Contract No. GS-00F-5442A SIN No. B37



**For Sale:** Used Brouwer Sod Harvesters and Hitch-Hiker Forklifts. Many lines of equipment for sod growers as well as full line of Ford, Brouwer, and Kubota parts in stock. Huber Ranch Sod Nursery, Inc., Schneider, IN. Ph: 800-553-0552. 7/92

**SPRAY TRUCKS:** 1987 and 1989 GMC Diesel 4,000 - 700 Gal stainless steel tanks, Hannay Reels w/300' of hose. Excellent condition in and out. 30,000 miles. PTO. \$14,000 & \$16,000 neg. 651 Pine Street, Uniondale, L.I., New York 11553, (516)489-3800. 7/92



# Before you buy a fairway mower, have your Toro<sup>®</sup> dealer take this test.

1. *Can the Toro 450-D perform on hilly terrain?*  
**The Ransomes 350D can.** Because the engine is over the drive wheels, the 2-wheel drive Ransomes 350D is surefooted enough to tackle challenging terrain. For the ultimate in traction, there's the 4-wheel drive model that gives new meaning to the words rugged performer.
2. *Can the Toro 450-D cutting heads be adjusted by hand?*  
**The Ransomes 350D can.** Reel/bed knife and cutting height adjustment is easily made with a simple twist of a knob. No tools are required. What could be easier?
3. *Can the Toro 450-D operator visually monitor cutting performance while mowing?*  
**The Ransomes 350D operator can.** All cutting units are located in front of the operator. The Toro 450-D wing units are positioned *behind* the operator, limiting visibility.
4. *Can the Toro 450-D be transported at an efficient speed?*  
**The Ransomes 350D can.** It offers 15.5 mph transport, while the Toro 450-D lags behind at 12.5 mph.
5. *Can the Toro 450-D mow in wet conditions without footprinting?*  
**The Ransomes 350D can.** It doesn't leave its mark — even on wet ground. The 350D is designed to evenly distribute weight to reduce the ground pressure which causes footprinting.

\* Toro<sup>®</sup> is a registered trademark of The Toro Company.

The Toro 450-D has met its match — and then some — in the Ransomes 350D. So go ahead. Ask your Toro dealer these five questions, and your next question will be: how soon can I get a Ransomes 350D?

Call 1-800-228-4444 for a free on-site demonstration.



Built to Last

**RANSOMES**

**Finn Hydroseeders, Mulch Spreaders, Krimpers, Pit Burners, Fiber Mulch & Tackifiers. New & Used. Wolbert & Master, Inc.,** P.O. Box 292, White Marsh, MD 21162. 301-335-9300, 1-800-234-7645. TF

**ATTENTION: String-Head products.** A replacement for **AIRBORNE MOWER** blades. Fits Flymo, Allen, Grass Craft, **ETC.** Also **NEW**, a commercial, long-lasting, fixed head for **LINE TRIMMERS**; Shindiawa, Echo, Stihl, Tanka, **ETC.** **Order now.** \$34.95 & shipping. **Royal Edger & Mower, 10831 49th St. N., Clearwater, FL 34622** or **Call (813)573-1700** or **FAX us (813)573-2745.** Dealers inquire. 7/92

Howard Gem 20" reconditioned \$3,500 plus engine choice also 24" and 30" Gems. Reconditioned BCS 745 14 h.p. Kohler or Ferrari 14 h.p. diesel electric start \$2,000. Disc Trenchers-Root Cutters, Stump Cutters, Chain saws, Power feed Chippers 18 h.p. to 120 h.p. Commercial Tillers/Engines-parts & service, Dowdeswell (Howard Gem), BCS, Howard, Maschio, Mainline, Wisconsin, Kohler, Acme. **For the Quality Service you expect. G & S TILLER SALES, 2031 Fourth Avenue, Joliet, IL 60433. (815)726-7921.** 7/92

**HYDRO-MULCHERS AND STRAW BLOWERS:** New and used. **JAMES LINCOLN CORPORATION, 3220 S. Jupiter Rd., Garland, TX 75041.** (214)840-2440, (800)527-2304. TF

**NEW and USED EQUIPMENT—Asplundh, Hi Ranger and Lift-All Forestry Bucket Trucks, Chipmore Wood Chippers. Mirk, Inc., (216)669-3567, (216)669-3562, 7629 Chippewa Road, Orrville, Ohio 44667.** TF

**SPYDERS: New/Used/Rebuilt. New KOHLER K582 Engines, KABOTA Water Cooled Replacement engine kits. Complete line of Spyder and engine parts. All Spyder up date kits. Hydraulic pump and motor repair service. MOBILE LIFT PARTS INC., 5402 Edgewood Rd., Crystal Lake, IL 60012. 800-397-7509, 815-455-7363.** 8/92

**FOR SALE: Jacobsen HF-5 7,400, Toro GM-3 green mower 3,000, Jacobsen 5 gang fairway, 5 gang Blitzer, 7 gang Blitzer and hydraulic 5 gang. Ransomes 213-D 6,500. All equipment reconditioned and ready for Spring. 313-653-5695.** 7/92

**REINCO HYDROGRASSERS** and power mulchers in stock. **Opdyke Inc., (Philadelphia Area) 215-721-4444.** TF

**BUCKET TRUCKS: Straight Stick, Corner Mount and Knuckle Boom Cranes. Brush Chippers - New Asplundh (Morbark Disc Type), New Asplundh Drum Type. Best prices anywhere. Used Chippers - Asplundh, Woodchuck, etc. 2 to 8 usually in stock. Sprayers, Dumps, Stakes, Log Loaders, Crew Cab Chip Box Dumps, Railroad Trucks, 50 in stock. Sold as-is or reconditioned. Opdyke's, Hatfield (Philadelphia Area), 215-721-4444.** TF

**BUCKET TRUCK: Hi Ranger 65', 57', 50'. Skyworkers with chip boxes. Asplundh bucket trucks with chip boxes. Asplundh brush chippers. Bean 55 gal. sprayers. Pete Mainka Enterprises, 633 Cecilia Drive, Pewaukee, WI 53072. 414-691-4306.** TF

**NEW AND USED BROUWER EQUIPMENT: Mowers - VACS - Fork Lifts - Harvesters - and full line of replacement parts. Contact Ed or Glenn Markham at 1-800-458-3644.** TF

## HELP WANTED



United Horticultural Supply/Great Lakes Division is looking for professional, experienced sales representatives with high levels of energy and currently selling to the golf course trade.

The individuals we select will possess the necessary skills in salesmanship, dealing with people, positioning products, and serving customers.

If you feel you meet these qualifications, perhaps we should talk. Please send your resume to:

**United Horticultural Supply**  
16713 Industrial Parkway  
Box 18037  
Lansing, Michigan 48901  
Attn: Terry Higgins  
**UNITED HORTICULTURAL SUPPLY**  
*Working to Enhance our World*

Gothic Landscaping, a major landscape contractor is looking for Maintenance Route Supervisors and Landscape Installation Supervisors for Antelope Valley and Los Angeles divisions. Please send resume and salary history to: 27502 Ave. Scott, Valencia, CA 91355. 7/92

## LAWN AND TREE SALES AND MANAGEMENT EHRlich GREEN TEAM

Our continued growth and expansion has created several openings in sales and branch management.

The Ehrlich Green Team is an established, well diversified lawn and tree care company, servicing six Mid-Atlantic states. We are a division of the J.C. Ehrlich Company with a commitment to quality customer services since 1928. The Ehrlich Green Team has pioneered integrated pest management principles in lawn care and tree care.

We are seeking individuals who are achievement and results oriented and enjoy hard work. Green Industry experience will be helpful. If you have a desire for advancement and self development, you need to talk to us.

Prompt attention will be given to responses which include a resume and compensation history. Strict confidentiality is assured. Please reply to:

**JOHN A. CARSON, DIVISION MANAGER**  
**EHRlich GREEN TEAM**  
**J.C. EHRlich CO. INC.**  
P.O. BOX 13848  
**READING, PA 19612-3848**  
EOE M/F

**LANDSCAPE CONSTRUCTION MANAGER/PARTNER:** Demonstrated ability to manage complete construction department. Must have extensive experience with the following: estimating, sales, client relationships, installation supervision, knowledge of Hispanic Labor Market, bilingual, purchasing. Degree preferred. Design Build experience preferred. We are a progressive award winning company located in two Texas metropolitan areas with sales approaching 3 Million. You are proven winner, you refuse to be second best. You must be willing to sacrifice in order to build long-lasting customer loyalty and a profitable construction division. Significant profits. Send resume to LM Box 475. 7/92

## REGION/BRANCH LEVEL SERVICE AND SALES POSITIONS

Locations in the North Central, Northeast, Southeast, West. Use your outstanding leadership ability and people-handling skills to establish a career with a real future as the recognized leader in lawn care services to both residential and commercial accounts. We are expanding our market penetration and need talented self-motivated branch and sales managers who can take us to the top.

You will receive:

- \*COMPETITIVE SALARY
- \*COMPLETE TRAINING
- \*CAR ALLOWANCE/COMPANY VEHICLE
- \*FANTASTIC BONUS POTENTIAL
- \*COMPREHENSIVE BENEFITS

If you have:

- \*PROFIT AND LOSS RESPONSIBILITY EXPERIENCE
- \*SALES OR SALES MANAGEMENT EXPERIENCE
- \*SUPERVISORY EXPERIENCE

Start your future today by send you resume in complete confidence to:

**ORKIN LAWN CARE**  
**Pat Guy**  
**2170 Piedmont Road NE**  
**Atlanta, GA 30324**

## FOR SALE

**LAWN SEED:** Wholesale. Full line of top quality grasses. Improved bluegrass varieties, tall fescues and fine bladed ryegrasses. We specialize in custom mixing. Olinger Seed Company, 89 Hanna Parkway, Akron, OH 44319. Call collect (216)724-1266. TF

**Tulip Colorblends-Nature's Fireworks.** Tulips for Fall planting. New ideas and Competitive Prices. GCSAA members have pre-approved credit. Customer Service and Follow-up Assistance call 1-800-877-8637. Write to: **Schipper & Co., P.O. Box 7584, Dept. L92, Greenwich, CT 06836-7584. Our Roots Are Bulbs.** 9/92

**PENNSYLVANIA GROWN SOD: PENNCROSS - Bentgrass available soil free. BLUEGRASS BLEND, BLUEGRASS/RYEGRASS Blend-Shipped via our trucks - forklift unloaded. VICNOR FARMS, INC., Connoquenessing, PA 16027. 800-842-0461** 10/92

**BENT GRASS available for immediate pick-up or delivery. For information call Jade Run Turf and Sod Farm: 800-332-1220.** 7/92



# Now the environment is right.

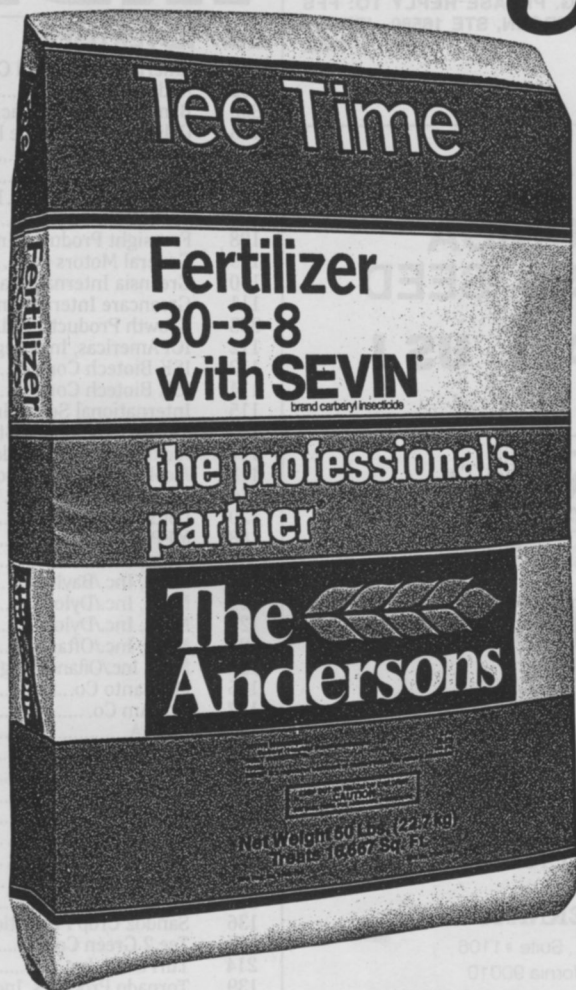

Effective,  
economical  
control of  
all major turf  
insects as  
you fertilize

The Andersons  
Lawn Fertilizer Division  
P.O. Box 119  
Maumee, OH 43537  
1-800-225-ANDY (2639)

Circle No. 102 on Reader Inquiry Card

## SOFTWARE

Route Manager System for scheduling and accounts receivable record keeping. Serving the Lawn Care Industry since 1982. List price \$350. Fortunate Computers, 46 N. 4th Street, Coplay, PA 18037. 800-275-0620. 12/92

**SUPERSCAPE**



SuperScape Management system offers the landscape professional the following:

- \*Ease of use
- \*Reduced support costs
- \*Reduced training costs
- \*Excellent management info
- \*Large time savings
- \*Increased sales

Benefits too numerous to list. Simply the best software in the industry. Don't buy until you call.

1-800-580-5880

SI SoftQuest, Inc.

**SOFTWARE**

## MISCELLANEOUS

**ENGINES, EQUIPMENT, COMMERCIAL MOWER PARTS AND MORE!** - Get your **FREE** catalog from Landscapers' Supply Corp. by calling 1-800-222-4303 or in New York 1-914-429-8300. 12/92

**FREE PARTS CATALOG**— If you own a 36"—48"—52" walk behind mower and you feel you're paying too much for parts, call Preco Distributors toll-free and request our parts catalog. **BELTS, BLADES, GRASS CATCHERS, WHEELS AND LOTS MORE!** Replacement parts that fit: **BOB-CAT, BUNTON, KEES, EXMARK & OTHERS.** 1 day shipping coast to coast available. All parts carry a 90-day warranty. Don't wait, call 24 hours a day. **TOLL-FREE 1-800-428-8004, in Massachusetts 413-583-6100. PRECO DISTRIBUTORS, 97 Center Street, Ludlow, MA 01056. TF**

## FINANCING

**OUR ACCOUNTS RECEIVABLE PROGRAM OFFERS CONTRACTORS UNLIMITED LINES OF CREDIT, IMMEDIATE CASH FLOW AND LETTER OF FINANCIAL COMMITMENT, LOW NET-WORTH-NO PROBLEM. NEW BUSINESS START UPS O.K. ON CONTRACTS WITH ALL FEDERAL, STATE COUNTY-AGENCIES, MOST MAJOR COMMERCIAL FIRMS, UNIVERSITIES, AND HOSPITALS. BANK RATES AND 48 HOUR FUNDING. PLEASE REPLY TO: FFS CAPITAL, 899 BERGEN, STE 16580, JERSEY CITY, NJ 07306. 11/92**

# IN THE GREEN

## COMMERCIAL INSURANCE for LAWN CARE OPERATORS

**M.F.P. Insurance Agency, Inc.**  
50 West Broad Street, Suite 3200  
Columbus, OH 43215  
(614) 221-2398

Contact:  
**Richard P. Bersnak, President**  
or  
**Jeanne Bartkus**

Circle No. 188 on Reader Inquiry Card

# ADVERTISER INDEX

NO.	ADVERTISER	PAGE NO.
101	American Cyanamid Co.....	52-53
102	Andersons, The .....	75
302	Bandit Industries, Inc.....	60
103	California Landscape Lighting.....	62
105	Deere & Co., John .....	2-3
106	Deere & Co., John .....	2-3
	DowElanco.....	12,13,16,17,24,25
107	Florida Nursery.....	51
108	Foresight Products, Inc. ....	48
109	General Motors Corp. ....	23
110	Greensia International .....	76
111	Greencare International.....	50
303	Growth Products, Ltd.....	60
112	ICI Americas, Inc (Reg.).....	48A-48B
113	ISK Biotech Corp.....	41
114	ISK Biotech Corp.....	41
115	International Seeds, Inc. ....	55
116	Jacklin Seed Co./NuStar.....	15
117	Jacklin Seed Co./Glade .....	47
118	Jacobsen Div. of Textron (Demo).....	7
119	Kubota Tractor Corp. ....	29
120	Lofts Seed, Inc.....	CV4
188	MFP, Inc.....	76
301	Miles, Inc.....	60
121	Miles, Inc./Bayleton.....	36-39
122	Miles, Inc./Dylox .....	27
123	Miles, Inc./Dylox.....	56-59
124	Miles, Inc./Oftanol .....	71
126	Miles, Inc./Oftanol (Reg).....	64-65
125	Monsanto Co.....	45
127	Nor Am Co. ....	63
128	PLCAA .....	49
129	Petrolon .....	CV3
130	Ransomes, Inc.....	73
131	Ransomes, Inc.....	73
132	Reemay, Inc. ....	33
133	Rhone Poulenc, Inc. ....	43
134	Rhone Poulenc, Inc. ....	43
135	Rhone Poulenc, Inc.....	20-21
304	Roots, Inc.....	60
136	Sandoz Crop Protection.....	30-31
138	Tee 2 Green Corp. ....	CV2
214	Turf Seed, Inc. ....	35
139	Tornado Products, Inc.....	60
140	Wandtke and Associates .....	62

This index is provided as an additional service. The publisher does not assume any liability for errors or omissions.

**IF YOU BUY  
ZOYSIA JAPONICA  
GRASS SEED  
YOU NEED TO CALL US!**



**ZOYSIA SEED**

- Very Reasonable Prices
- Higher Purity and Germination
- Good Wear Tolerance
- Slow Growth, Resulting in Lower Maintenance

Distributors Inquiries Welcomed



**GREENSIA INTERNATIONAL**

3807 Wilshire Blvd., Suite # 1106

Los Angeles, California 90010

Tel: (213) 382-9596 • Fax: (213) 382-6676

Circle No. 110 on Reader Inquiry Card



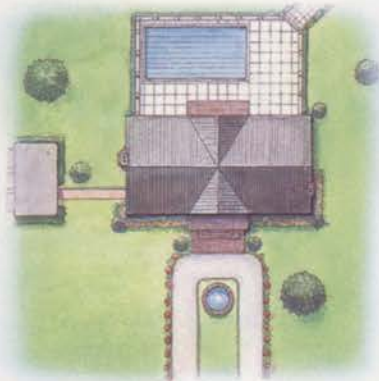
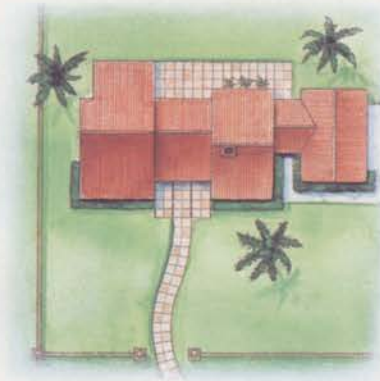
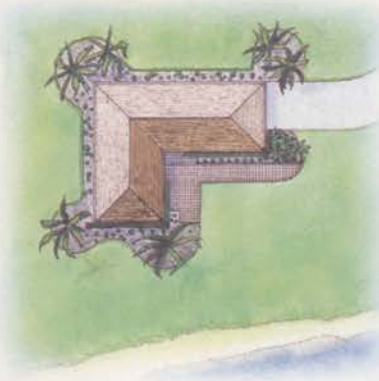
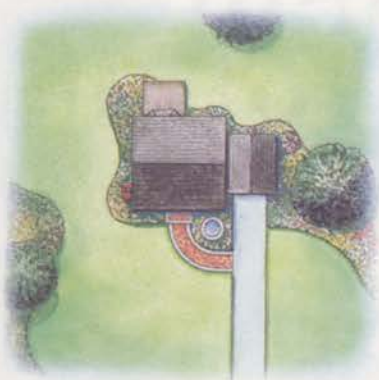

# Make sure your equipment goes the whole nine yards.

Use Slick 50 Small Engine Formula. It gives mowers, trimmers, cutters and clippers the same kind of advanced PTFE treatment that protects your car's engine from wear. Your equipment runs longer, with fewer breakdowns. So you get to rake it in, instead of your repairman.

**SLICK**<sup>®</sup>  
The Engine Wear Protector. 50

