

**SOMETIMES  
YOU CAN'T SEE THE TREE  
FOR THE FOREST.**

The woods are full of fertilizer companies offering basically similar products, so why choose LaRoche's Vertagreen? **We're a little different.**

Our consistent investment in research technology and product testing has helped us produce a state-of-the-art product.

**Take Vertagreen with Team™ herbicide, for example.**

Nothing controls goosegrass, crabgrass and other annual weed grasses, while enriching lawn and turf, better than Vertagreen with Team herbicide. It's gentle on grass, hard on weeds and it's available in fertilizer and in sprayable form.

**Then there's Vertagreen with Surflan®**

Apply Vertagreen with this herbicide and say "Hello" to great looking, weed-free turf. And say "Goodbye" to as many as 50 unsightly weeds and junk grasses before they emerge. Think of it as preventive medicine for the lawn.

Tough as it is on weeds, Vertagreen with Surflan is gentle enough to use on your ornamentals—over 175 different varieties safely. Which makes it the perfect feed and weed product where lawn and garden share equal billing.

**More good news.**

For late spring, Vertagreen also offers a triple-duty herbicide, insecticide and fertilizer that does all three jobs with one application.

**If we haven't got it, we'll make it.**

Some lawns and micro-climates require special, even unique fertilizer formulations. No problem. Tell us what you need or we'll be happy to check out your location and develop exactly what you require.

**More than your order, we want your business.**

We're in this lawn care industry for the long haul, so we don't take customer relationships lightly. Product superiority alone isn't enough and we know it. Should you have a problem, we'll help and fast. It's one of the reasons we have rivals but no equals.

**If this kind of thinking starts you thinking, call us today with your order at:**

Atlanta, GA: 1-800-554-1088 or 1-800-554-1099  
Greensboro, NC: 1-800-833-1438  
Chicago, IL: 1-800-323-6416  
1-800-942-0589 (in Illinois)

 **verta·green**

**LaRoche Industries Inc.**  
1100 JOHNSON FERRY ROAD, N.E.  
ATLANTA, GEORGIA 30342

Circle No. 126 on Reader Inquiry Card



Larry, what makes Fairway Fertilizer with TGR™ Poa Annua Control so different from other weed control products? “Instead of acting like a

conventional herbicide, the new Scotts product *slows* the growth of the *Poa* plant, diminishing its competitive ability. The result is a gradual, more natural transition to desirable grasses without a sudden decrease in playing surface quality.”

That really changes the way you think about growth regulators. How does it fit in with current turf management practices? “Fairway Fertilizer with TGR Poa Annua Control has proven to be effective in reducing *Poa* populations even under conditions that would normally enhance their growth. Extensive testing has shown that this product fits in with a range of different management practices. Treat your turf with successive fall and spring applications until the *Poa annua* has decreased to the desired level.”

What about those ugly *Poa annua* seedheads? “A significant benefit of the new product is a reduction in the visibility of *Poa annua* seedheads after one

application. When applied before seedhead emergence in the spring, the treatment will slow the emergence of the seedhead stalk, resulting in fewer visible seedheads and more uniform turf color and playing surface.”

How about color response? “This formulation provides not only selective control of *Poa annua*, but also extends the greening response well beyond what an equal rate of fertilizer alone can achieve.”

For more information on Scotts new Fairway Fertilizer with TGR Poa Annua Control, call your ProTurf Tech Rep. Or call Scotts direct at 800-543-0006. In Ohio, call collect (513) 644-2900.

“Now, with Scotts®  
new TGR™ technology,  
you can outgrow your  
*Poa annua* problems.”

Dr. Larry Widell, Scotts Research project leader (Plant Growth Regulator R&D), talks about new Fairway Fertilizer with TGR™ Poa Annua Control.





Aggressive bentgrass can be seen encroaching into an area of *Poa annua* treated with ProTurf Fairway Fertilizer with TGR *Poa Annua* Control.

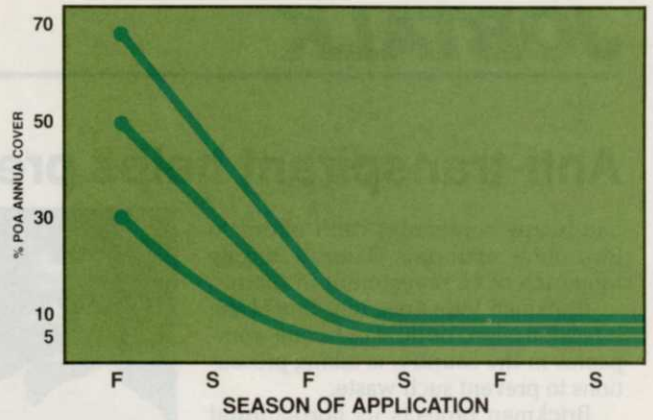

Typical *Poa annua* population suppression is shown over time with continued use of Scotts Fairway Fertilizer with TGR *Poa Annua* Control. The degree of control may be influenced by turfgrass management techniques, climate, soil type and *Poa annua* biotype.



The treated area (left) in this mixed *Poa annua*/bentgrass fairway has been converted to predominantly bentgrass after three applications.



Notice the selective elimination of the *Poa annua* and the increased greening of the treated plots 7 weeks after application to a mixed stand of perennial ryegrass, Kentucky bluegrass and *Poa annua*.



Fewer seedheads are apparent in fairways when treated in the spring. The lens cap indicates the upper right corner of the treated plot.



## Anti-transpirant helps prevent landscape losses

Landscape companies can't afford to lose plant materials. There's simply too much of an investment in them.

Brickman Industries Inc., one of the largest design/build landscape companies in the country, is taking precautions to prevent such waste.

Brickman protects its horticultural materials being transplanted by using an anti-transpirant.

"The anti-transpirant is actually a waxlike coating which protects leaves against excessive loss of moisture during periods of stress," says Daniel C. Skinner, support services manager at Brickman's Langhorne, Pa., office. "Plug up the stomata with the anti-transpirant and there is less water loss."

Wilt-Pruf anti-transpirant, which Brickman uses, dries to form a clear, flexible film on leaves and does not interfere with plant growth, according to the product's manufacturer. Respiration, osmosis, and photosynthesis are reduced just slightly.

Wilt-Pruf, a water-based pine oil emulsion, is an organic, biodegradable material that comes in containers ranging from 14 ounces (aerosol) to 55-gallon units. Brickman buys its 55-gallon drums through a local lawn and garden distributor.

### Tree-moving: a specialty

Brickman performs tree moving at all its regional offices, often handling trees six to 15 inches in diameter. The trees are dug by hand and the balls are then shaped and wrapped with burlap.



Daniel C. Skinner, support services manager at Brickman's Langhorne, Pa., regional office, says using anti-transpirants on trees to be moved is vital.

"We have a 99 percent success ratio in moving big trees," says Skinner, noting the biggest tree the company has moved weighed 80,000 lbs.

Applying an anti-transpirant reduces the shock when trees are dug, says Skinner. "We spray the tree with the anti-transpirant the day before

digging. We have been using Wilt-Pruf at a 1:5 ratio."

Brickman uses the same ratio on materials being held and on newly-established landscape materials.

Brickman's Langhorne office sometimes specifies that the trees or other materials they purchase be sprayed with an anti-transpirant the day prior to digging for delivery.

"We do that in our own nurseries," says Skinner. "Our own crews also prune out one-third of the foliage on big trees in addition to spraying with Wilt-Pruf ahead of digging."

At the Langhorne office, the nursery is filled to capacity each fall since Brickman crews plant year round. Planting in the winter is common in the East and any materials coming from Midwest nurseries must be brought in before freezing weather halts digging.

"We spray these trees every month. We do the same during the winter for the majority of the plantings we have made the prior season," says Skinner.

For more information on Wilt-Pruf, contact Wilt-Pruf Products Inc., P.O. Box 4280, Greenwich, CT 06830.



A Brickman crew member sprays an anti-transpirant on a new landscape planting to prevent desiccation.

WT&T

There's no better value for crabgrass control than Balan. And none with more experience. It's been used more years by more golf course superintendents than any other granular preemergence herbicide.

Its easy-to-spread clay carrier is one reason why. It makes application more uniform, reduces the dust common in other carriers and also increases your equipment calibration accuracy.

With Balan, you get superior preemergence crabgrass control for eight to ten weeks with

a single application. Then you can overseed or perform other turf management jobs, without worry of reduced seed germination. If you want longer control, the Balan price allows you a second application.

Balan. The better spreader. Talk to your Elanco distributor soon. Or write:

Elanco Products Company  
A Division of Eli Lilly and Company  
Lilly Corporate Center, Dept. E-455, Indianapolis, IN 46285, U.S.A.  
Balan®—(bifenox, Elanco Products Company)



Circle No. 117 on Reader Inquiry Card

## **Proven Balan.<sup>®</sup>** **The better spreader for crabgrass control.**



# THE ADVANTAGE OF A BROKEN



IF YOUR TORO TRIMMER BREAKS  
DURING THE FIRST YEAR, WE'LL FIX IT  
OR GIVE YOU A LOANER FREE.

Introducing the Broken Promise.  
A bold guarantee that puts an end to downtime  
by keeping you working even when your  
gas trimmer isn't. Simply stated, the Broken

Promise guarantees if your Toro straight-shaft  
gas trimmer fails due to equipment failure  
within the first year, your Toro dealer will fix it  
right away or give you a loaner at no charge.

We believe our straight-shaft gas trimmers  
are the finest on the market. In fact, their  
performance and value equal those of any Toro  
product. The Broken Promise applies to the

# ADVANTAGES ON PROMISE.

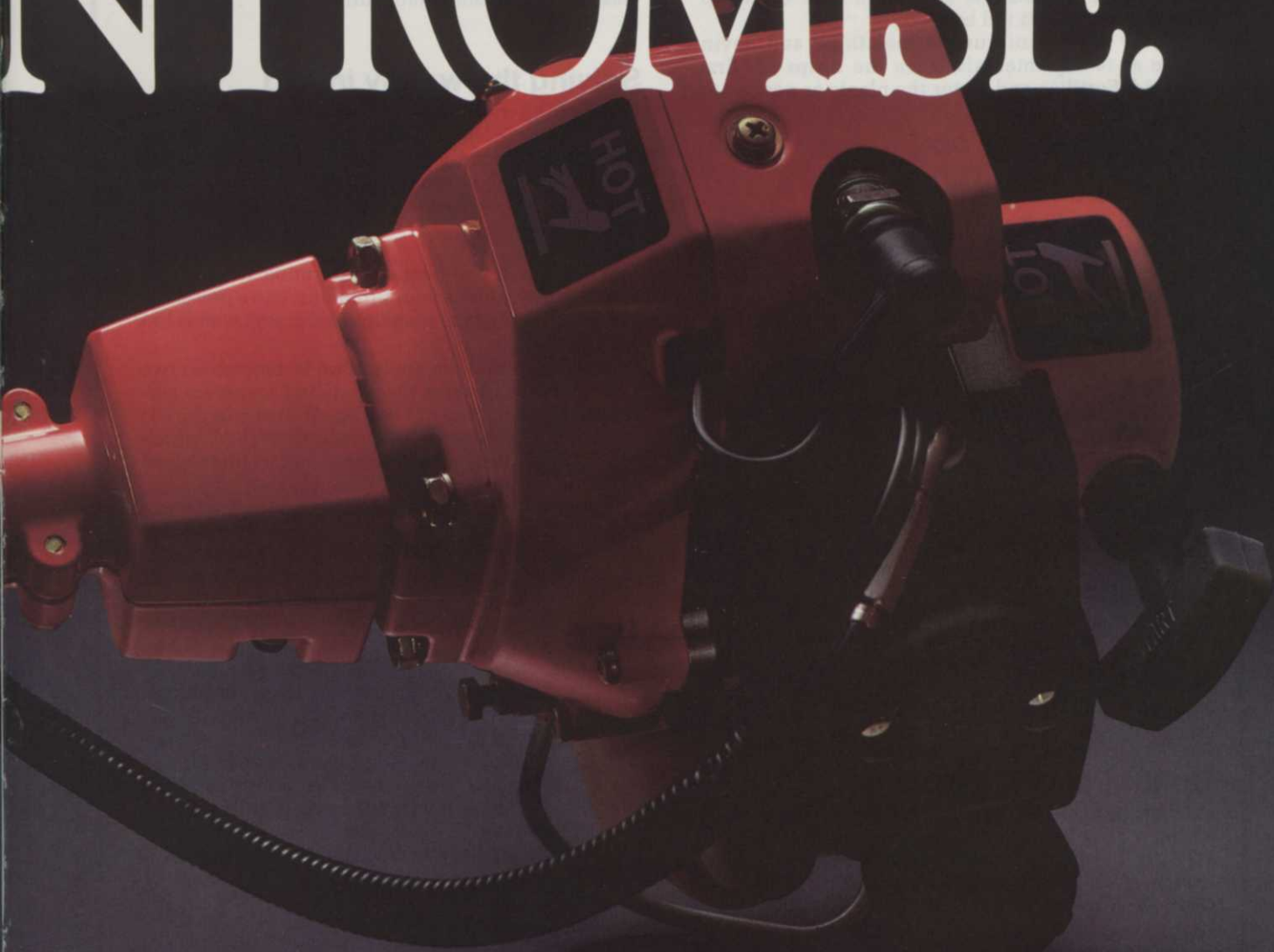

24cc TC3000 and TC4000, and the 33cc TC5000. All three feature Toro's famous straight-line power, plus the versatility of optional blade accessories.

What's more, we want you to take advantage of this time-saving guarantee as soon as possible. Stop in and see your participating Toro Dealer for details about the

"Broken Promise" No Downtime Guarantee.

After all, there are many gas trimmer dealers who promise customer satisfaction. Now only your Toro Dealer guarantees it. Promise.

HAVEN'T YOU DONE WITHOUT  
A TORO LONG ENOUGH?

Circle No. 254 on Reader Inquiry Card

**TORO**

# PROBLEM SOLVERS

by Balakrishna Rao, Ph.D.

## Privet hedge problems

**Problem:** Every year the privet hedges show grayish-colored leaves. Eventually they become yellow. It looks like insect damage. Any idea what it might be and what can be sprayed to protect them? (New York)

**Solution:** From the symptoms you are describing, the dendrothrips problem seems to be related to privet thrips (*Dendrothrips ornatus*). In some years, this pest can become very serious. Affected plants show a grayish, dusty appearance. The larvae are yellow and spindle-shaped; the adults are dark brown to black with a bright red band.

Spray with a mixture of malathion and Sevin twice at 14-day intervals when the thrips are first noticed. Fertilize and water the plants as needed to improve their vitality.

## Dog repellents

**Problem:** Are there any chemicals which can be applied on humans to repel dogs? (Canada)

**Solution:** I am not familiar with any products on the market which can be used as repellents against dogs. Reports indicate that moth balls can be used on bushes to distract male dogs. It would be nice to have some repellent to distract dogs from chasing while providing service in the yard. Maybe some of our readers may respond to this question.

## Sequestrene use on lawns

**Problem:** Can we use Sequestrene on St. Augustinegrass and bermudagrass lawns to supply iron? What is the rate? (Texas)

**Solution:** Yes, you can use Sequestrene on St. Augustinegrass and bermudagrass lawns to supply iron. Use at 1/2 lb. per 1,000 sq. ft. This is an expensive material compared to other products on the market.

## Control of scale insects

**Problem:** On our clients' properties we see a number of different kinds of scale insects on different plants. What is the best control method? Is it possible to control all of them by applying one chemical at one time? (Michigan)

**Solution:** In general, the best management approach to scale insect problems is to apply dormant oil against overwintering scales followed by a chemical application later when the crawlers are seen.

Scale insect problems are difficult to manage. Most overwintering scale insects can be managed to some extent by the application of dormant oil alone or in combination with ethion before bud break in the spring.

The timing is not dependent upon the species of

scale insect. The crawler emergence of these scale insects, however, may vary from species to species. Accordingly, the chemical application time should coincide with specific crawler emergence. Therefore, one application of a given insecticide will not be able to provide control of various scale insects.

The best approach is to identify the scale insect, determine the crawler emergence period, and apply a crawler control spray as a follow up to a dormant oil spray. Dormant oil can be phytotoxic to some species. Read and follow label directions.

## Solving the weedy infield

**Problem:** After our softball and baseball fields were built, they were left unattended for two years. Now we have many weeds growing in the infields. During original seeding part of the infields was sown. What would be the best way to get rid of the problem? (Minnesota)

**Solution:** First, you need to determine which types of weeds are causing your problems. Use a pre-emergence herbicide to manage annual grassy weeds like crabgrass.

Make sure that the application is done about two to three weeks before the predicted crabgrass germination period in early spring. After the herbicide application the area should not be disturbed, which would break the chemical barrier and result in weed problems.

For broadleaf weeds, post-emergence herbicides should be applied when weeds are actively growing. If you are dealing with mostly rosette-types of weeds (e.g. dandelions), a herbicide containing 2,4-D with MCPP is sufficient.

In most cases, an application in April and again in October is necessary. Creeping or vining weeds like knotweed require dicamba for adequate control. From late spring through early fall, whenever the weeds are actively growing, apply a herbicide containing 2,4-D, MCPP, and dicamba.

This combination will not take care of all the weeds. Weeds like veronica, violet, and ground ivy are difficult to control with the normal application of amine formulations. These weeds can best be managed by the use of products containing ester formulations of 2,4-D and/or triclopyr.



Balakrishna Rao is Director of Lawn Care Technical Resources for The Davey Tree Co., Kent, Ohio.

Questions should be mailed to Problem Solver, Weeds Trees & Turf, 7500 Old Oak Boulevard, Cleveland, OH 44130. Please allow 2-3 months for an answer to appear in the magazine.





# You Can Depend on the green garde® High Performance Spray Team

**NEW! 4-SPIRAL WHITE HOSE** . . . a unique 600 PSI hose designed to withstand the rigors of the spray industry. **Solid PVC Tube with two layers of criss-cross spiral reinforcement** . . . **nothing like it anywhere!** Available in 3/8" and 1/2" ID, 300 and 400 foot continuous lengths.

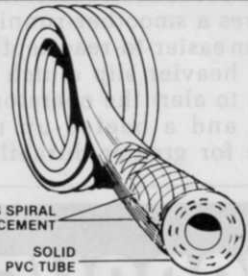

TWO LAYERS SPIRAL REINFORCEMENT  
SOLID PVC TUBE

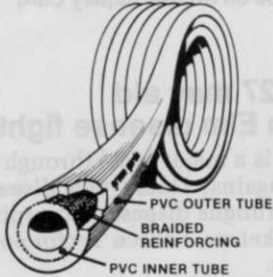

**BRAIDED NEON HOSE** . . . the best quality hose money can buy. **Avoid downtime and chemical spills** . . . **use the hose preferred by top operators all over North America.** 800 PSI working pressure; available in 1/4", 3/8", 1/2", 5/8" and 3/4" ID; 300, 400 and 600 foot continuous lengths. Some odd lengths, in various ID's, also available at special prices.

**JD9-C Hi-Performance SPRAY GUN** . . . used by just about everybody. A rugged, dependable, versatile performer in any spray application. Fully adjustable from fog to long distance stream. **Five tips** available to fit your needs . . . **adapter** to attach the many fine Spraying Systems wands and spray tips. **Also available . . . JD9-CT with gauge port and plug**, allows you to easily calibrate your sprayer.

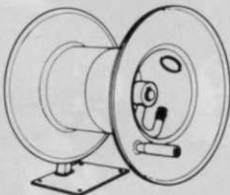

**Heavy-Duty ALUMINUM HOSE REELS** . . . unique single pedestal design makes mounting anywhere a breeze. Constructed of marine alloy aluminum -- eliminates corrosion problems. **Attractive . . . and popularly priced!** Available in four sizes, with capacity from one to four hundred feet of 1/2" hose. **MARK IV** model accepts 250 feet of 3/4" hose.

**REPLACEMENT HOSE REEL SWIVELS** . . . tested at over 3000 PSI dynamic service pressure! The same heavy-duty units supplied on our hose reel, now available separately. Fits Hannay and other reels with no modification. Extended service **VITON** o-rings means longer wear; and, when replacement *does* become necessary, it can be done, in the field, with an inexpensive kit, in less than a minute. Three sizes: 1/2", 3/4", 1".

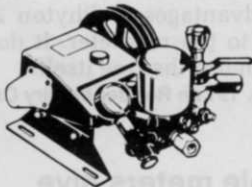
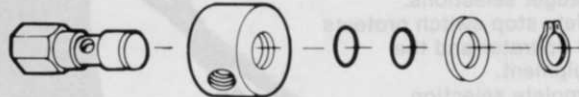

**Hi-Performance TRIPLEX PLUNGER PUMPS** . . . the choice of successful operators. Rugged! Reliable! Outperforms and outlasts diaphragm pumps! Pumps almost any fluid. Available in six models, from 3 to 35 GPM, up to 500 PSI service pressure. **Nothing else to buy** . . . pumps come with pressure regulator, pulley, glycerine-filled gauge, bypass valve, surge chamber, mounting rails, NPT adapters . . . **ready to use!**

**Heavy-duty ROOTFEEDER** . . . for tree and bed rootfeeding. Built to last . . . replaceable hardened tips. Up to 12 GPM capacity. Two stainless steel feeding needle extensions also available. **Fits on JD9-C Spray Gun.**

**ACCESSORIES AND PARTS** . . . we have exclusive design flooding nozzles (five patterns); hosecutters with stainless steel blades for fast, *safe* clean cuts on PVC hose; plated steel long-shank GHT hose fittings in 1/2", 5/8" and 3/4" sizes; aluminum alloy short shank GHT hose fittings in 3/8", 1/2" and 3/4" sizes; mini-hand duster *and* chest-carried combination duster/granule applicator; Band-It® banding products and tools, etc. All replacement parts in stock, **always.**

**SERVICE** . . . our most important product! It is the standard of the industry . . . and it's included in the price of every Green Garde product you buy. Normally, orders are shipped same day as received.

**Green Garde® WARRANTY** . . . the best in the business . . . and, it's **EASY!** If our product fails to perform satisfactorily you get a replacement, credit or refund. Quality products make our life simple . . . **try some Green Garde® quality today!**

See these and many other fine Green Garde products at your distributor or contact us at (312) 593-6464

© Copyright 1986 Encap Products Company — All Rights Reserved

ENCAP PRODUCTS COMPANY P.O. Box 278 Mt. Prospect, IL 60056

# PRODUCTS

## New PreSeeder offers several new features

The ATI Corporation has introduced an improved PreSeeder which offers several new features designed for operating ease and convenience.

The PreSeeder, according to ATI, features a smoother-running drive line, an easier-to-read depth indicator, a heavier slip clutch with an alarm to alert the operator to slippage, and a beefed-up unitized frame for greater durability. The

chain drive runs in oil bath resulting in longer life and less maintenance.

The PreSeeder speeds up soil preparation as much as four-fold, and in addition to creating a fine-textured seedbed for better germination, also levels out high and low spots and lines up stones and debris for easy removal.

The machine is easily adaptable to most tractors and requires only a 20 hp tractor for operation.



Circle No. 190 on Reader Inquiry Card

## TORQUE-FREE One-Man Earth Drilling

### Ideal for Landscaping

- Patented torque bar eliminates kick back.
- Simple, safe one-man operation cuts labor costs in half.
- Digs a fast clean hole in seconds — diameters of 1½" to 16".
- Available in mechanical and hydraulic models with a variety of auger selections.
- Safety stop switch protects the operator and the equipment.
- Complete selection of augers and accessories.

Send Today  
for Complete Information.



# Little Beaver, Inc.

P.O. Box 840 • Livingston, TX 77351  
(409) 327-3121 • telex: 386596

Circle No. 130 on Reader Inquiry Card

## Phyton 27 may aid in Dutch Elm disease fight

Phyton 27 is a major breakthrough in the fight against Dutch elm disease and other fungus diseases, according to the marketer, Source Technology Biologicals.

The fungicide, with active ingredient copper sulphate pentahydrate, is very deadly to fungus and bacteria. Phyton 27 actually kills the Dutch elm disease within the tree while



fungistatic products only allow the fungus to cease growing or reproducing.

Simple injection, reduced wounds on the tree, and labor savings are three advantages to Phyton 27, according to the marketer. It does not burn or harm the tree itself.

Circle No. 191 on Reader Inquiry Card

## Portable meters give accurate pH readings

Engineered Systems and Designs' two new portable digital pH meters are designed for convenience and accuracy in the field or laboratory.

The model 57 reads an accuracy of .05 pH and displays to .01 pH. The model 59 reads to an accuracy of .01 pH and displays the same.

Both read the entire pH range of 0-14 and feature manual temperature compensation from 0-100 degrees Centigrade, a standardized control, an externally accessible slope control, and an on/off battery check switch. Both contain solid state circuitry and are

*continued on page 74*