

Meeting Dates



Arizona Spring Turfgrass Conference, Tucson National Golf Club, May 12.

Central Plains Field Day, Central Plains Turfgrass Foundation, Research Plots, Kansas State University, Manhattan, Kan., June 2.

Turf Research Field Day, Rutgers State University College of Agriculture and Environmental Science, New Brunswick, N.J., June 11.

Michigan Association of Municipal Cemeteries, 9th Annual Conference, Holiday Inn, Traverse City, Mich., June 20-21.

Annual Meeting, American Society of Agricultural Engineers, Purdue University, Lafayette, Ind., June 23-25.

National Fertilizer Solutions Association, Round - Up Program, Ridpath Hotel, Spokane, Wash., July 8-10.

National Fertilizer Solutions Association, Round - Up Program, Hotel Muehlebach, Kansas City, Mo., July 22-23.

National Fertilizer Solutions Association, Round - Up Program, Marriott Motor Inn, Atlanta, Ga., Aug. 13-14.

Golf Course Superintendents Field Day, University of Rhode Island, Kingston, R.I., Aug. 20.

Lawn and Utility Turf Field Day, University of Rhode Island, Kingston, R.I., Aug. 21.

Turfgrass Management Conference, Hawaii Turfgrass Association, East West Center, University of Hawaii, Honolulu, Hawaii, Aug. 27-29.

Annual Turfgrass Field Day, Michigan State University, East Lansing, Sept. 4.

Lawn and Ornamental Days, The Ohio Agricultural Research and Development Center, Wooster, Sept. 9-10.

Central Plains Turf Conference, Kansas State University, Ramada Inn, Manhattan, Kan., Oct. 15-17.

National Fertilizer Solutions Association, National Convention and Equipment Exhibition, Cincinnati Convention Center, Cincinnati, Ohio, Nov. 9-13.

Note: Dates for this column need to reach the editor's desk by the 10th of the month preceding the date of publication in order to make the printing deadline.

Ready to START?
Locke's New
Highwheel Mowers
are cutting
commercial
mowing costs
all over the
country!



rotary mowers—from 22" to 26"—boast swivel head and swivel wheels for easier handling.

Push or self-propelled cutters are perfect companion machines to heavier-duty Locke reel or Devere-Locke rotary mowers...

Call your Locke dealer for free demonstration of these light yet rugged machines!



WRITE FOR FREE BOOKLET
Complete line of heavy-duty reel and rotary mowers for commercial use.



Manufacturing Companies, Inc.
5637-M MacCorkle Ave., S.W.
South Charleston, W. Va.

For More Details Circle (113) on Reply Card

**4 RAIN JETS OUTPERFORM
24 ORDINARY SPRINKLERS**



CHOICE OF PATTERNS

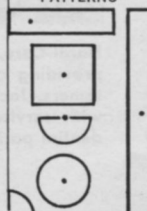

**Install for Greater Profit
and Customer Satisfaction**

*Only RAIN JET supplies everything you need to install complete underground sprinkler systems—valves, flexible pipe, fittings and choice of brass or adjustable sprinklers.

*RAIN JET rotary, pop-up, pendulum sprinklers fit any area. Selection includes true square patterns and ground cover heads.

*Fast, easy installation of fewer heads makes pricing extremely competitive. Customers are delighted. No costly "callbacks."

*RAIN JETS are nationally advertised to consumers. Free installer mats available.

GENEROUS DISCOUNT TO INSTALLERS. SEND FOR CATALOG AND FREE "HOW TO INSTALL" BROCHURE.
RAIN JET CORPORATION, Dept. WTT-21
301 S. Flower St., Burbank, Calif. 91503

For More Details Circle (106) on Reply Card