



"Measure the Price by the Years"

Years Ahead!

The announcement of the Jacobsen Fairway Mower is an event of real importance in golfdom. Long rated as a quality builder, now Jacobsen announces a Fairway Mower with these startling, *exclusive* advantages. 1. It mows over "chocolate drops" without scalping or scuffing. 2. It mows the sides of traps, steep grades etc.—anywhere a tractor can go. 3. It mows *up to the green* without placing one pound of pressure on your precious greens. It's years ahead. Write for catalog.

JACOBSEN MANUFACTURING CO.
734 WASHINGTON AVE., RACINE, WIS.

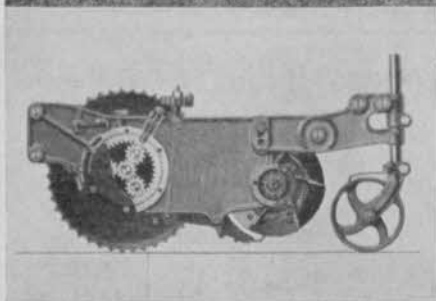

15 EXCLUSIVE FEATURES

Added to the foregoing features, the new Jacobsen Fairway offers 12 more exclusive features, making it the mechanical marvel of the mower field. You must see them to appreciate them.

JACOBSEN POWER MOWERS

GREENKEEPERS!

PROTECT GRASS WITH *NuREXFORM* ARSENATE OF LEAD

• March is the month when young earthworms and grubs start toward the ground surface to chew on tender grass roots.

Greenkeepers can have a special dish all set for these pests by applying NuREXFORM Arsenate of Lead to the turf either alone or with the fertilizer application. NuREXFORM settles into the ground



to a depth of two or three inches and forms a poison barrier to chewing insects.

We recommend NuREXFORM because of its ease of application, however, GRASELLI Arsenate of Lead is equally effective as a poison. Order your spring supply of NuREXFORM today. Send for your copy of "How It Kills the Grubs."

E. I. DU PONT DE NEMOURS & COMPANY, INC.



GRASELLI CHEMICALS DEPARTMENT
WILMINGTON, DELAWARE

New England Distributor: APOTHECARIES HALL CO., WATERBURY, CONN.

Get your number!



DOOR PRIZES will be given at the Dolge exhibit at the convention—so be sure to go to the Dolge booth. Yours may be one of the lucky numbers, and even if it isn't, you can get important information there on how to make a big saving on course maintenance supplies.

Lloyd Dolge will be there from the 15th to the 18th. Don't forget—we'll be seeing you.

The C. B. Dolge Co.
Westport, Conn.

BARGAINS: Several Re-built
Fairway and Greens Mowers

Write for Complete Catalog—Get our
prices before you buy anything

FLAGS
AND
POLES



HOLE
CUTTERS
CUPS

1938 will be
A GREAT IDEAL YEAR

See the new heavy duty
IDEAL FAIRWAY MOWERS
AND GREENS MOWERS

"Over-Nite" Service

EVANS IMPLEMENT CO.

569-71 Whitehall, S. W.
ATLANTA, GA.

IN EIGHT YEARS

No TORO MASTER TRACTOR Has Worn Out



THE MASTER A

The Master A tractor has a wheel base of 87 inches and is built specifically for use with Master underslung hitches. To be used primarily for mowing, but also for general utility work. Economical to operate and capable of fast work. For clean, smooth cutting combined with speed, power and unusual hill climbing ability, there is no tractor outfit on the market that will match the Master A, when used with Trojan five and seven gang high speed mowers.



THE MASTER B

There is real power when you need it, plus speed when you want it in Toro Master Tractors. That is the combination which all tractors will have in the future. The Model B shown here has a wheel base of 97 inches and has an all steel electrically welded dump box with a capacity of one full yard. You can do all forms of general utility work with the Model B. It will go over the ground in a hurry and handle the toughest jobs easily.

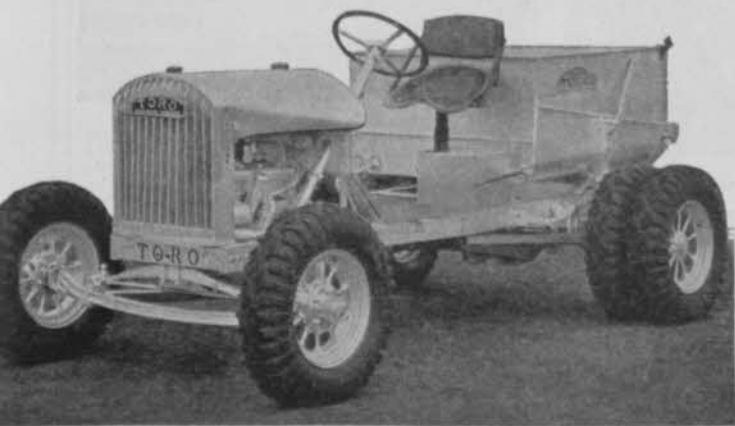

TORO MANUFACTURING CORP.

USED BY THE COUNTRY'S
Leading Golf Clubs

THE
Peerless
MOWER SHARPENER

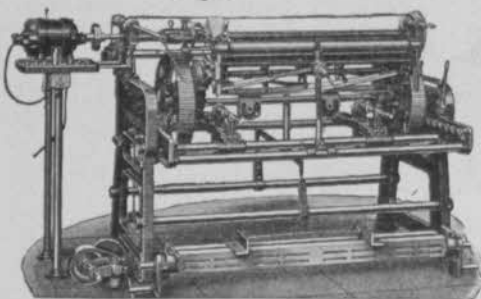

• The Peerless Mower Sharpener will keep your cutting units sharp and your turf looking its best the year around. It's simple to operate, sharpens in half the usual time and handles all types of power mowers and tractor units. Made in two sizes—for blades up to 36 in. or 42 in. wide. Reconditioner for "lapping in." Catalog and prices upon request.

THE
Silver King
TRACTOR



• The Silver King is an ideal Golf Course Tractor designed to take care of every service required for complete turf maintenance. Features include: low first cost, unusual economy of operation, high speed, ample power, low pressure tires or wide roller type wheels as desired, light weight, four speed transmission, 2 1/4 to 25 miles per hour. Catalog and prices upon request.

CATALOG *free!*
THE FATE-ROOT-HEATH CO.
1137 BELL ST. • PLYMOUTH, OHIO

WE KNOW HOW IMPORTANT

it is to

YOU

GOOD SEED is obviously important. But prompt delivery and reliability are, too, of great importance.

HENDERSON'S GRASS SEEDS are of recognized quality.

PROMPT DELIVERY is assured because we always maintain full stocks of golf grasses.

RELIABILITY IS assured because your order will be filled by experienced men.

Write for our Sports Turf Price List.

PETER HENDERSON & CO.

35 CORTLANDT ST., NEW YORK, N. Y.

**High Pressure Sprayers
FOR GOLF COURSE USE**



THIS tractor-powered Hardie Golf Sprayer provides big capacity, ready mobility and amazing efficiency at very low cost. It is only one of a complete assortment of sizes and styles of Hardie specialized golf sprayers. Spraying for weed control, brown-patch, protection of trees, and for application of liquid fertilizers is an accepted, indispensable part of modern management. You can do it most economically and efficiently with a Hardie. Ask your equipment dealer or write The Hardie Mfg. Company, Hudson, Mich.; Portland Oregon; Los Angeles, Calif.; Kansas City, Mo.; New York City; Brockport, N. Y.; Jacksonville, Fla. Export Dept. 120 Madison Ave., Detroit, Mich., U.S.A.

**HARDIE
DEPENDABLE
SPRAYERS**

CHROMIUM PLATED AND
POLISHED "SILVER TOP"
Easily Visible at Night



NEW!
Announcing
the NELSON
"SILVER TOP"
VALVE

*With Removable Main Valve
and Supplementary Shut-Off*

The new Nelson "Silver Top" Valve for underground sprinkling systems embraces three important improvements.

1. Main valve removable from top of casing without disconnecting from water main or disturbing turf.
2. Supplementary shut-off that closes automatically when main valve is removed. This saves water and permits other sprinklers on line to operate.
3. Highly polished, chromium plated cap that is easy to locate at night.

The Nelson "Silver Top" Valve is engineered for efficient operation and ruggedly built of red brass throughout. It represents an outstanding improvement in valve design for permanent, underground sprinkling systems.

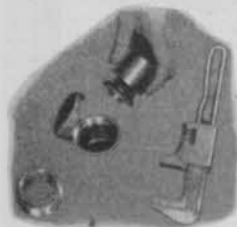

A variety of Nelson Sprinkler Heads are available to use with the "Silver Top" Valves. Every condition can be met with Nelson equipment.

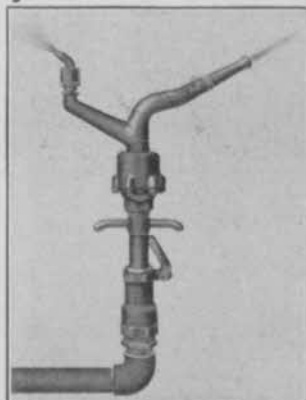

When the main valve assembly is removed the supplementary shut-off closes automatically. Pressure is still on the line. Other sprinklers continue to operate.

L. R. NELSON MFG. CO.
PEORIA, ILLINOIS

L. R. Nelson Mfg. Co.
Peoria, Illinois

Gentlemen:

Please send 1938 Sprinkling equipment catalog giving complete information on the new "Silver Top" Valve and other Nelson equipment.

NAME

ADDRESS

CITY..... STATE.....

NELSON
Sprinkling Equipment



IN ANY LEAGUE —

THE BIG NOISE IS —

Silver Scot TOURNEY

Get a load of the conversation that's kicking around hot showers in the winter stove league! Listen to the shooting and shouting of the leading Pros and Amateurs in the Grapefruit Circuit and you'll learn that this year MacGregor's *Silver Scot Tourneys* are "the clubs to beat" in any league. MacGregor's *Silver Scot Tourney Clubs* are Tommy Armour's newest and sweetest design—but what have they got that makes them the big noise of the tournament treks? Well, if we could put into words the gold dollar feel of these *Silver Scot Tourney Clubs*, we wouldn't have to ask you to order your sample set. Pro-only, of course, and that means profit protection without any ifs, ands, or buts—so let's get your sample order rolling, today. CRAWFORD, MACGREGOR, CANBY CO., DAYTON, OHIO
BRANCH OFFICES: New York, 11 Park Place; Chicago, 23 E. Jackson Blvd.; Los Angeles, 714 S. Hill St.; San Francisco, 121 Second St.; Seattle, 1107 Second Ave.

MacGregor

SILVER SCOT BALLS, WOODS, IRONS
SOLD EXCLUSIVELY THROUGH GOLF PROFESSIONALS

'37 GOOD TO GOLF

Annual USGA Report points to progress in all phases of game

REVEALING continued improvement in golf, the report of the USGA Executive committee, submitted at the association's annual meeting Jan. 9, 1938, and covering the year ending Nov. 30, 1937, showed a net increase of 21 in USGA member clubs, bringing the total to 813. This is an increase of 46 clubs over the 1935 low in USGA membership. High during the last 11 years was in 1931 when the association had 1,154 clubs.

The association increased its surplus by \$13,576.41 during the fiscal year to \$76,463.16, despite a \$2,275.17 slump in income from the women's championship. No Walker Cup or Curtis Cup matches were held in 1937 so the association did not have approximately \$9,000 expense attached to these competitions, as in 1936.

Detail of the accountants' report of USGA operations reveals a clear picture of able and thrifty management by the association's officers and staff executives. In the prominence and completeness given its financial statement the USGA presents a model for other associations in golf.

Pros Credited With Game's Advance

Credit for soundness of the game's growth was paid to pros because of the increase in group instruction of juveniles under the nation-wide PROMotion plan. John Jackson, retiring president of the USGA, in submitting the report of the Executive Committee, cited as excellent examples of this development of youngsters' interest in golf, the work done by the Michigan PGA, and the Detroit District GA's work in connection with the juvenile program and caddie welfare.

Mention was made of consideration the

Executive Committee had been giving to ending any increase in distance of the ball.

The Rules of Golf Committee had a busy year. After extensive consideration the stymie was revised on an experimental basis, so that for at least a year, the nearer ball must be lifted when it is within 6 inches of the cup in match play. A footnote was added to the 14-club rule, permitting a player to replace a club which becomes unfit for play, and adding club or clubs up to the limit of 14 without borrowing from an opponent, partner or fellow competitor.

Open Entries Set Record

The Championship Committee reported a record entry of 1,402 in the Open. The committee also advised that the increase in money-prize winners from 20 to 30 in the Open and the increase in prize money from \$5,000 to 6,000, which was put into effect in 1937, would be continued in 1938.

Amateurs in USGA competition must now state on entry blanks the nature of their employers' business and of the entrant's duties, thus eliminating from amateur competitions players engaged in occupations conflicting with the amateur definition.

In stroke play competition conducted by the association in 1937 the USGA recommended "the player whose ball is nearer

1938 OFFICIAL USGA TOURNAMENT CALENDAR

- May 17—Entries close, National Open.
 May 31—Sectional qualifying rounds, National Open.
 June 3-4—Walker Cup Matches, St. Andrews, Scotland.
 June 9-11—National Open, Cherry Hills Club, Englewood, Colo.
 Late June—National Intercollegiate Championship, Louisville (Ky.) CC.
 July 22-August 6—District qualifying rounds, National Public Links.
 August 10—Entries close, Public Links.
 August 12—Entries close, National Amateur.
 August 22-27—Public Links Championship.
 August 30—Sectional qualifying rounds, National Amateur.
 September 3—Entries close, Women's National.
 September 7-8—Curtis Cup Matches, Essex County CC, Manchester, Mass.
 September 12-17—National Amateur, Oakmont (Pa.) CC
 September 19-24—Women's National, Westmoreland CC, Wilmette, Ill.

to the hole exercise the right given him by Stroke Rule 10 to play first in a case where he otherwise might lift to avoid interference with the stroke of his fellow-competitor." Results were excellent, and the recommendation is renewed. The British PGA, and later the US PGA followed the USGA lead in adopting rules making it mandatory to play the nearer ball in case of possible interference.

The USGA decided to certify for any R & A championship only American amateurs who could meet the entrance requirements for the corresponding USGA championship. The R & A acts similarly.

Bear Down on Prize Values

A. M. Reid, new president of the USGA, who headed its Membership and Reinstatement Committee and the Amateur Status and Conduct Committee during 1937, in the Amateur Status and Conduct report reiterated the association's policy that amateur prizes should be merely symbolic. "The attraction in amateur golf is purely sport," states the committee. The committee also said it "is always glad to rule on the propriety of a given prize" and advised that prizes "should not be of such type, either in monetary value or number, as to be bait to attract competitors, nor should they be advertisements for commercial donors." The committee expressed concern "about rumored acceptance by amateurs of golf merchandise without fair

payment or payment of any kind," and "rumored acceptance by amateurs of contributions toward their expenses in competition."

The Amateur Status and Conduct report has ruled that amateurs would forfeit their status by participating in "open tournaments of certain character in which commercial enterprises are promoted."

Amateurs were warned against writing or radio-broadcasting golf instruction and against advertising themselves. It was stated that an amateur could not accept an "honorary" club membership unless it was awarded as "purely and deservedly honorary and in recognition of an outstanding performance or contribution to golf."

It was pointed out that greenkeepers, caddie-masters and assistant pros are not amateur golfers.

At least half of the clubs submitted to the Implements and Ball Committee for approval during 1937 were of the putter type. This committee also found during the year that some of the cheaper golf balls were not in accordance with USGA rulings.

The Committee of Sectional Affairs reported that many clubs expanded from 9 to 18-holes during the year and changed from sand to grass greens.

Green Section Serves Clubs

The Green Section Committee gave an outline of its activities during 1937, which was one of the Section's busiest years. More than 2,000 letters were sent to member clubs in which technical advice was submitted in reply to club queries. Dr. John Monteith, Jr., chief of the Green Section staff, visited 59 clubs in 19 states and inspected turf improvement work in Europe during the past year. A brief digest of the Section's work on putting greens, fairways and tees, grasses, fertilizers, weed control, disease control and soil improvement showed highlights of the tremendously valuable work done by this department of the USGA.

Morton Bogue, retiring General Counsel for the association, reported on legal matters involving caddie employment, injuries on courses, and the effect of workmen's compensation and social security legislation on minor and adult employees at golf clubs. The complexity of legal problems now concerning golf clubs might well be cited as another strong reason for club membership in the USGA.



Wings at four angles assure daylight from at least two walls, and generally three, of every room to be used by the Pennhill members.

UNITE IN NEW HOME

Pennsylvania club incorporates latest ideas in new layout; to open this spring

THE new Pennhills Club of Bradford, Penna., a consolidation of the former North Penn Golf club and the Country club, is erecting a building on the former site of the old golf club. Inclement weather has not deterred in any way the excavation and construction of this project, and the architect, Clifford C. Wendehack, famous for his club design throughout the world, says it will be ready this spring. The building is the last word in clubhouse design and provides all facilities, both golfing and social, previously enjoyed by the members of the consolidated clubs.

The building is situated at an elevation of 1,500 feet and is surrounded by hills to the north, east and west, affording an inspiration for a club setting seldom equalled in this country.

The form of the plan is also unusual, and was adapted to the gentle slope of the property on the hillside. The various portions of the building form wings extending at four angles, and are so arranged to take advantage of the entire panorama of the valleys and hills, as well as the points of compass, prevailing breezes, and the maximum amount of sunshine obtainable for the pools and terraces during the summer months.

The arrangement of the plan has probably never been used before in clubhouse design. It is pertinent in every regard, to this location; but the relation of the vari-

ous parts of the building is centralized so that it may at all times be controlled by the management.

The style and design of the building were selected as appropriate to fit into the surrounding scenery; the colorings of the walls and roofs were chosen to blend in with the hills and trees which form its natural back-ground. Local materials have been employed throughout, in order to obtain this effect.

The main walls are constructed of brick, manufactured in the locality, and vary from a light buff to darker reds and browns. Walls are backed up with terra cotta and form a semi-fireproof shell of the structure. In certain portions of the exterior, such as the main entrance and terraces, stone is used to increase the interest of the brick. Some gables are formed of timber and stucco for a variation of texture and color. Roofs, of varicolored slate, are rather steep to shed snow and ice.

The central point of interest in the entire building is the turreted tower. Like its prototypes in the wind-swept mountain country of Northwestern England, it is built of brick, with stone quoins and

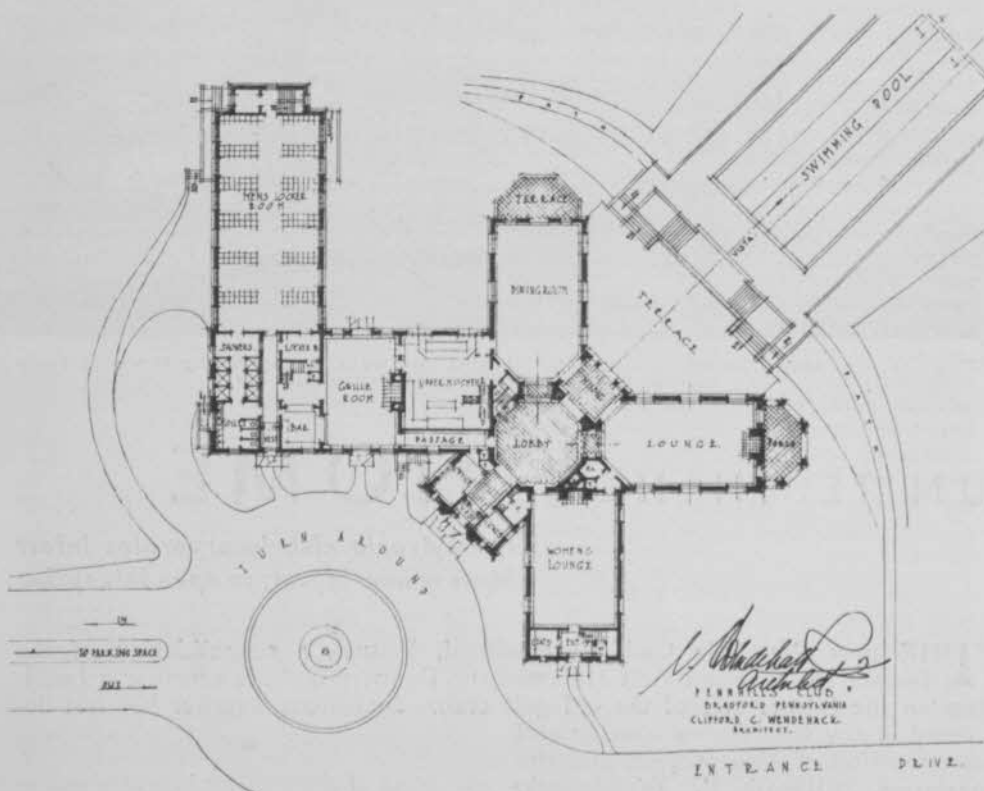

Notice how skillfully the golf portion of the clubhouse has been separated from those areas designed for the social side of club life.

coping which rise in the center of the composition, against the background of the surrounding hills.

All the social, dining, and locker-rooms are arranged in a manner whereby cross ventilation and a view of the pool and the vistas may be had from all portions of these rooms. This produces an airy and cheerful atmosphere in all the club rooms.

From the main entrance of the club, which is approached from the drive and the turn-around, we enter through a vestibule into the lobby which contains all the facilities requisite for the club's functioning. To the left is the office and registry for guests, telephone, switch board, etc., which controls the operation of the entire building. To the right, are coat room facilities for members and guests, powder and wash room facilities for women, and telephone booths. Beyond this vestibule through a high, wide, archway is an octagonal foyer through which a fine view is had of the dining terraces, the swimming

pool terraces, and the pool proper; and beyond, a magnificent view of the entire valley.

To the right of this lobby we enter the lounge, at the end of which is a high stone mantel, with a porch beyond. To the left is the main dining room which opens upon the main dining terrace, and an end terrace where afternoon refreshments may be served, overlooking the pool and the golf course.

Opening out from this central lobby is a staircase which leads to a private dining room, the manager's quarters, and the men's billiard room on the second floor. There is also access from this main lobby to the women's clubroom, which is about the same size as the main lounge; card parties and receptions may be held here without in any way interfering with the normal activity of the club.

This women's room is so situated that it may be used in conjunction with the women's locker-room, which is directly