

## NEWS IN BRIEF

**ORLANDO, Fla.** — Arnold Palmer Golf Management Co., an international golf facility management firm, has moved its corporate offices to Palmer's Bay Hill Club here. Part of the Bay Hill Lodge was converted into offices for the APGMC staff.

**MARSHALL COUNTY, Iowa** — Proposals for two nine-hole golf courses will proceed now that they have won unanimous approval for special-use permits from the Marshall County Board of Adjustment. Local resident William Grewell said he hopes to open Country Drive GC by late summer or fall. Mike Eckhart, treasurer of the West Marshall Golf Course Association, said Lincoln Valley GC will open by June 1994.

**CHANDLER, Ariz.** — Construction of UDC Home's Foothills Club West GC resumed in January, and will be completed this summer. The course, designed by Kenneth M. Kavanaugh of Tucson, is scheduled to open next winter. Kavanaugh has also begun an extensive course renovation for the city of Tucson's Randolph South Municipal GC. Construction is scheduled to be completed in the summer of 1994.

**FLOYDS KNOBS, Ind.** — Not far from his Southern Indiana home, Fuzzy Zoeller is watching his eighth course come to life. Zoeller owns 51 percent of Covered Bridge GC, a \$7.5 million course and housing development he designed on 350 acres. It's scheduled to open by spring of 1994.

**ST. LOUIS** — Monsanto Co. has announced it has signed a letter of intent with Chevron Chemical Co. to purchase the assets of that firm's Ortho Consumer Products Division. Monsanto officials indicated the purchase price will be approximately \$400 million, including working capital employed in the business.

## Creative solution to unravel longstanding Homestead dispute?

By PETER BLAIS

**GLEN ARBOR, Mich.** — A citizens group has dredged up an old idea along the shores of Lake Michigan as a way to resolve the conflict surrounding the controversial Homestead golf course.

A 10-member steering committee, composed of leaders of groups interested in the project, has proposed a land swap between Homestead resort owner Robert Kuras and the National Park Service, administrator of nearby Sleeping Bear Dunes National Lakeshore.

The swap involves an exchange of 267 acres of Homestead land for a 258-acre Park Service parcel, according to committee spokesman Don Reddicliffe.

The Park Service would set aside the Homestead land, which includes the 3.68 acres of wetlands near the Crystal River that have tied up the development in regulatory red tape and the courts for more than six years.

*'This won't be easy. An act of Congress is difficult to get and will take time. But it's worth the effort if we can get this resolved.'*

—Don Reddicliffe, spokesman for citizens group

The Homestead could use the adjacent Park Service acreage, which Reddicliffe described as rolling farmland "without wetlands or creeks to worry about," to develop its long-sought golf course. A former owner once considered developing the site into a golf course.

Since it involves federal land, the swap would require an act of Congress, Reddicliffe explained. The group's goal is to gain local support that would hopefully generate resolutions and letters of support. Those would be sent to the district's Congressmen, who could introduce the needed legislation.

"A similar plan was considered five or six years ago," Reddicliffe said. "But it wasn't considered possible. Since then we've had six years of bitter debate. More people are looking at this as a way to resolve the issue and move on."

Some oppose the idea. "The Sierra Club said it was absolutely against any exchange of Park Service land. That was predictable," Reddicliffe said.

But he was encouraged by the willingness of Kuras and the Park Service to "at least listen" to the idea. The swap gained an editorial

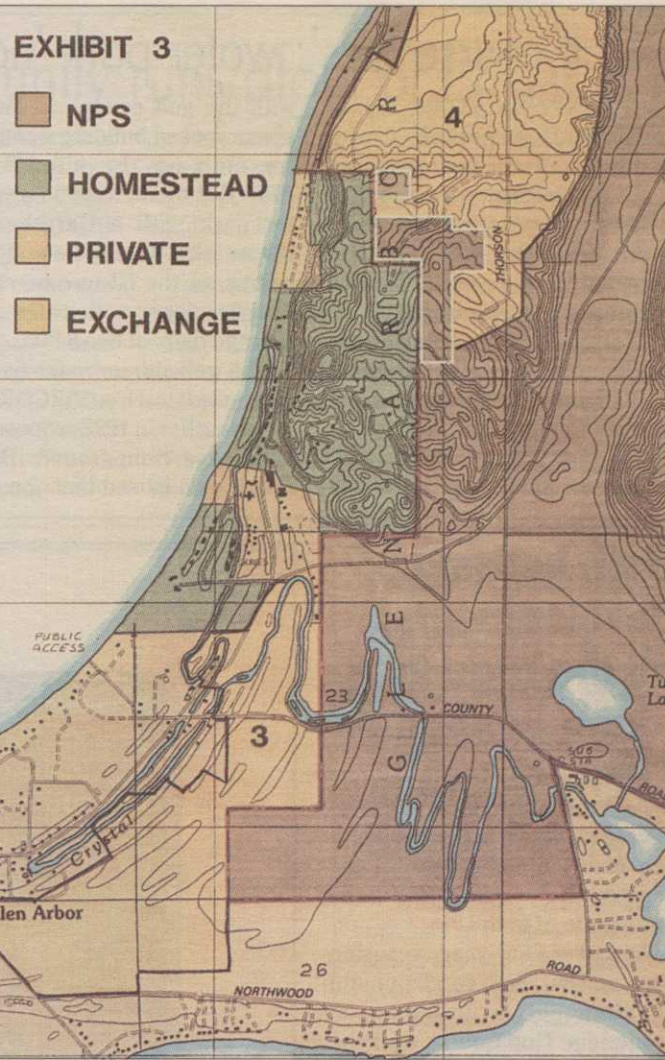

The solution would involve swapping the parcel belonging to developer Robert Kuras (labeled #3) for a Park Service parcel, labeled #4.

endorsement from *The Detroit News* and was termed "a viable compromise" by the local *Traverse City Record Eagle*.

Reddicliffe is most optimistic because of the willingness of steering committee members to give up time from their busy schedules to seek a solution. Committee members include leaders of such influential groups as the Friends of the Crystal River, Glen Lake Association, Citizens Council of the Sleeping Bear Dunes Area and National Dunes Advisory Committee.

Reddicliffe is president of the Glen Arbor Coalition, a civic betterment group.

"This won't be easy," he said. "An act of Congress is difficult to get and will take time. But it's worth the effort if we can get this resolved."

Continued on page 9



**Solid Bridges. Solid Company.  
Solid Warranty.**

Fox Lake Construction, Inc., 1174 Georgia Hwy., Franklin, NC 28734  
(800) 874-9403 • Fax (704) 524-5441

## Suppressing Poa Annua Seedhead...

No other soil wetting agent suppresses *Poa annua* seedhead emergence while it helps to move water deeply and uniformly throughout the rootzone. Isn't it time you give AquaGro® a try?

... Another Reason To Use AquaGro.

**AQUATROLS**

The Water Management People

800-257-7797

From anywhere in the U.S. and Canada.