

GOLF COURSE NEWS

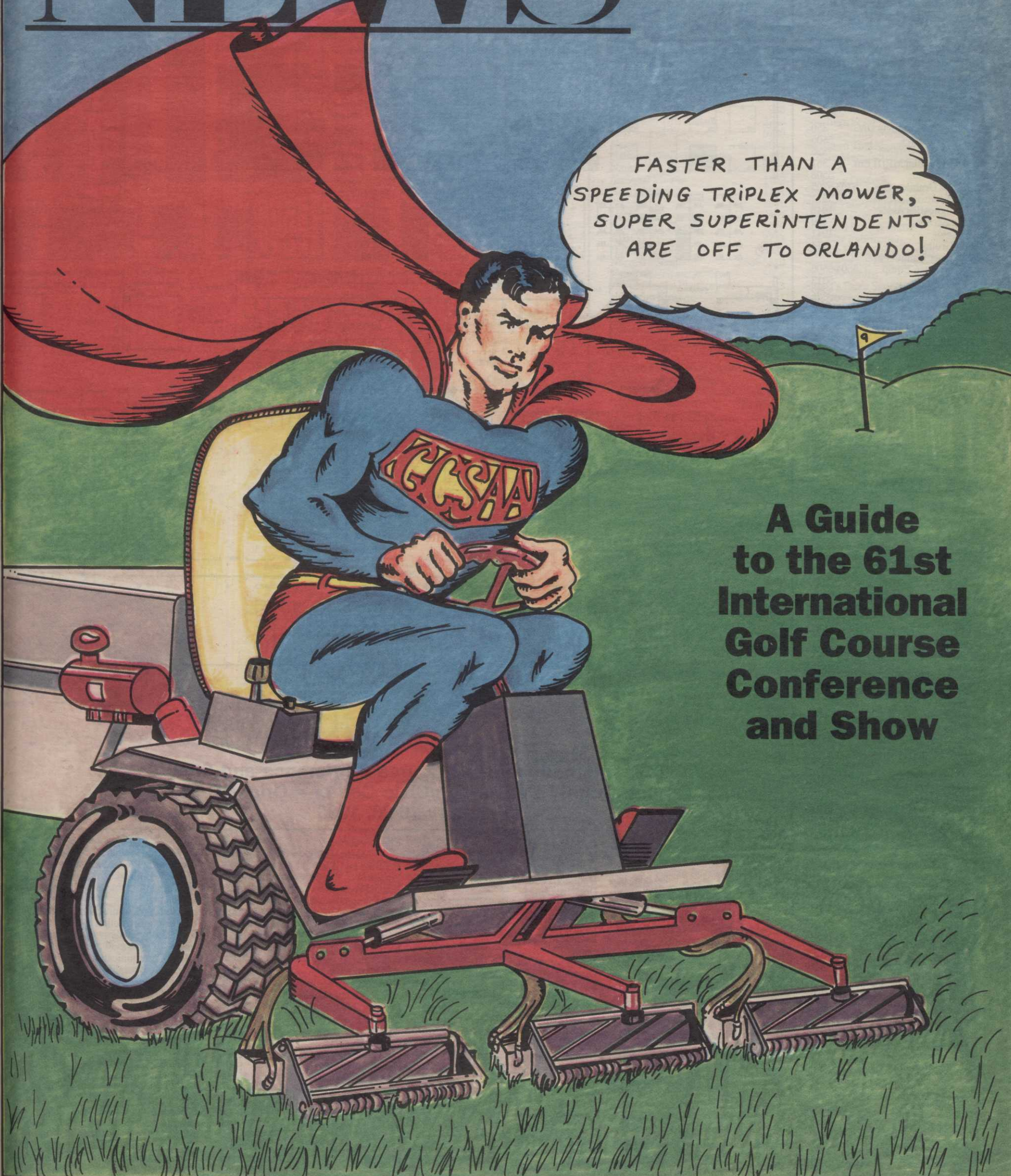

FASTER THAN A
SPEEDING TRIPLEX MOWER,
SUPER SUPERINTENDENTS
ARE OFF TO ORLANDO!

**A Guide
to the 61st
International
Golf Course
Conference
and Show**

Following is a list of all exhibitors and their booth numbers at the 61st International Golf Course Conference and Show, sponsored by the Golf Course Superintendents Association of America, Feb. 19-26 in Orlando, Fla.

Advertisers in this issue of *Golf Course News* are those listed in green, and their booth locations are colored on the map.

Please pull out this four-page center section of the paper and carry it with you as a guide to the show, lectures and other events.

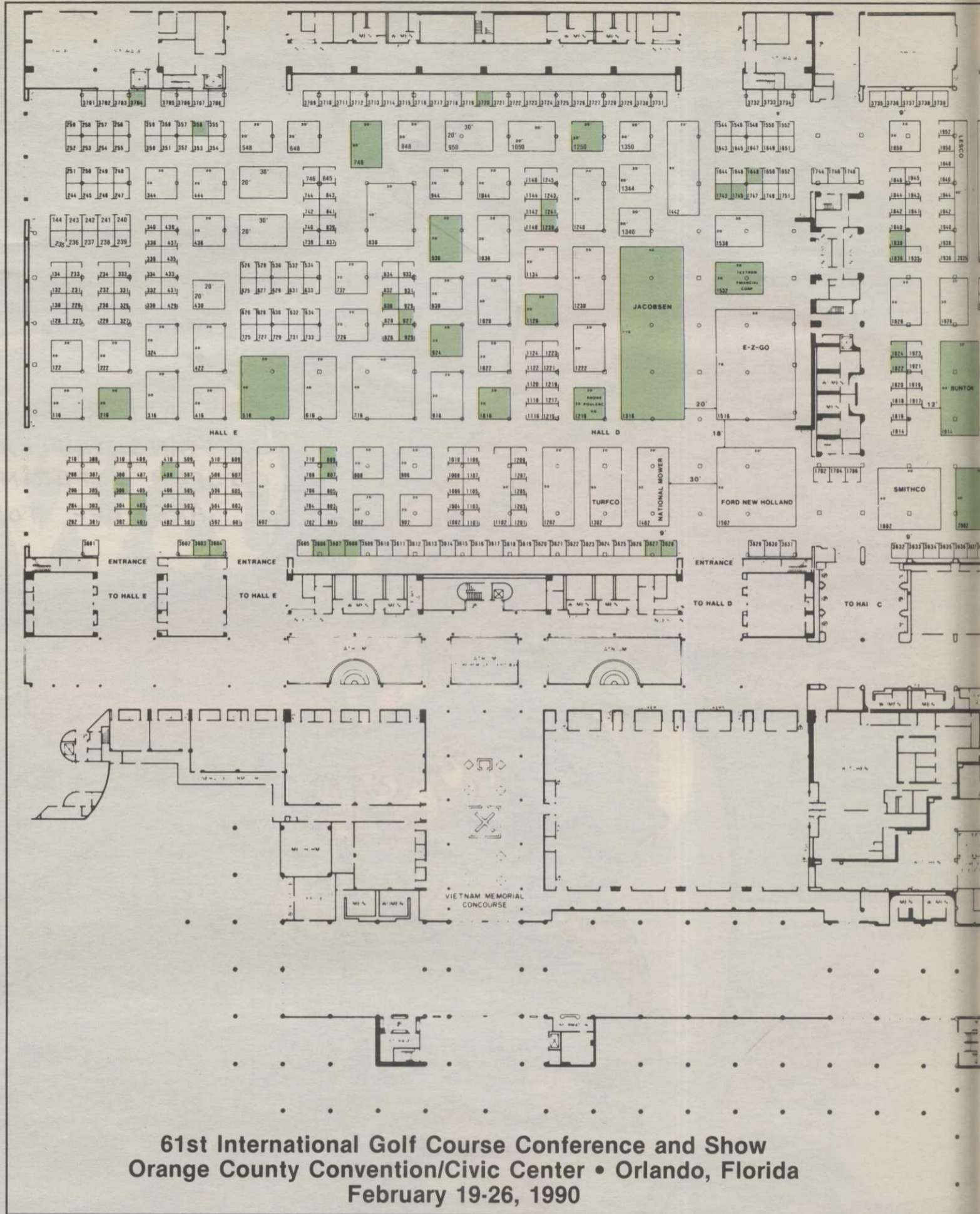

- 3M Electrical Products Div. 350
- Aabaco Industries 5505
- Accuform Golf Limited 3326
- Accu-ProCut dba MRJH Ent. 351
- Action Sign 5508
- Advanced Drainage Sys. 5703-5705
- Aeration Industries Int'l 5612
- Agri-Diagnostics Assoc. 1948
- Airlake Aeration 439
- Air-O-Lator 1941
- Alamo Group 344
- Allen Power Equipment/
So. Lawn Equip. 5504-5506
- American Carts 5313
- American Colloid 3252
- American Cyanamid 2936
- American Golf 5425
- American Honda Motor 444
- American Monarch 725-757
- ASGCS 5328
- Ametek/Plymouth Prod. Div. 5231
- Amiad U.S.A. 352-353
- AMPEL (American Pelletizing) 255
- Amturf Seeds 3725-3726
- Anderson Seed 708
- Andersons, The 1008-1010
- Applewood Seed 3619
- Applied Biochemists 1923
- Aquamaster 1749-1751
- Aquachade 505
- Aquaterr Instruments 633
- Aquatrols 3134-3136
- AquaTurf 235-237
- Aqua-Aid 3449
- Arco Parts 3447
- Arthur L. Davis 5131
- Associated Golf Concepts 1344
- Atlantic Mills 1243
- ATS Research 5725-5727
- A.C.F. 5606
- A.F. Trenchers Ltd. 501-503
- B & W Sales/Trebor 1544-1546
- Ball-O-Matic 3714-3716
- Bannerman Aerway 222
- Barlow Tyrie 801
- Baron Wire & Cable 3351
- Bartron 3643
- BASF 5326
- Becker-Underwood 629
- Beecomist Systems 5208-5210
- Belton Industries 5607
- Berkeley Pump 240
- Bernhard & Ltd. 3314
- Best Equipment Serv. & Sales
- Best Sand/Garick 5119
- Billy Goat Industries 502-504
- Bioe Technology 5432
- Blackburn Mfg. 336
- Blunks Wholesale Supply 3730-3731
- Bob Oltman & Assoc. 1936-1938
- Briggs & Stratton 2548
- British & Int'l Golf
- Greenkeepers 5630
- Brooks Products 1746-1748
- Brouseard-Carney
- Rice Hull Organice 3758
- Brouwer Turf 2314
- Brown Mfg. Trenchmaster 1550-1552
- Broyhill 3120
- Buckner Backflow & Irrigation 2602
- Bunton 1914
- Burkeen Manufacturing 3750
- Burlington Scientific 929
- B.H. Sales/Bell Turf Equip. Mfg. 924
- Cal Olson 1945
- Canaan Industries 206-208
- Carlisle Tire & Rubber 5030-5032
- Carney/Gustafson Range Equip. 1044
- Carroll Childers 2030
- Carson Industries 3723
- Carsonite International 5413
- Cart-Parts 632-634
- Cedar Chemical 5026
- CelPril Industries 3636
- Central Florida Turf 310
- Certified Laboratories 241
- Chemical Containers 334
- Chemigation Systems Int'l 234
- Chem-Pro Precision Spray 416

61st International Golf Course Conference and Show
Orange County Convention/Civic Center • Orlando, Florida
February 19-26, 1990

- | | | | |
|---|------------------------------------|---|---|
| Cherry Lake Tree Farm 5307-5309 | C-C Enterprises 841 | Eljen/Ritterings/
Master Dist. 3637-3639 | FMC 3629-3631 |
| Ciba-Geigy 3202 | C.H. Love &
D & D Marketing 538 | Emerald Isle, Ltd. 1935 | Foley-United Industrial 2347-2351 |
| CIM Industries 526 | Dathaten America 2926 | Emrex 1022 | Ford Motor, Power Prod. 1140-1142 |
| Classen Mfg. 3243-3245 | Deere & Co. 2614 | Encap Products 1002-1004 | Ford New Holland 1502 |
| Cleary, W.A. Chemical 2547-2551 | Deines 3721-3722 | Environmental Golf 5232 | Fore-Par 3142-3146 |
| Clover/Fel-Pro Inc. 3647 | Designer Golf 729-731 | Environmental Protection 3754 | Foster Turf 3617-3618 |
| Club Car 2002 | Deutz 3244-3246 | Excel Industries 2226 | Four Star Agricultural Serv. 5227 |
| Club of America 848 | DICKEY-John 5404 | Expo Consult 256 | Fox Lake Construction 3738-3739 |
| Club Managers Assoc.
of America 5532 | Dico 1644-1646 | Exxon Chemical 5812 | Fox Valley Systems 6403 |
| Club Mate Products 430 | Direct Safety 1820 | E.F. Burlingham/
Farmers Mktg. 3651-3652 | Gandy 5220 |
| Columbia ParCar 2834 | Dispro Display Products 3757 | E-Z-GO Textron 1516 | GCSAA Communications 5420 |
| Comet Industries 944 | Ditch Witch 5202 | F.W. McConnell Limited 324 | GCSAA Membership Serv. 5420 |
| Commercial Pump Service 1230 | DNA Enterprises 1649 | Fairway Designs of Fla. 3343 | Giant Vac Mfg. 2802, 2902 |
| Conrad Fafard 5407 | Dol Brothers Sod 257-258 | Fairway Products 607 | Glenmac 5131 |
| Continental Bridge 3423-3425 | DonuT Trimmer Equip. 616 | Federal ASC 1743-1745 | GNC Pump 3734 |
| Con/Span Culvert Systems 1650 | Dotech 3348 | Fermenta 1743-1745 | Golf Course Association 5731 |
| CoRoN 358-359 | Douglas Products 1205 | Fertl Soil 803-805 | Golf Course Bldrs. of America 5429 |
| Course Savers 1744 | Dowty Industrial 354 | Filter Supply 930 | Golf Course Management 5420 |
| Coursigne 1124 | Duerr 3727-3728 | Fine Lawn Research 3609 | Golf Course News 5801 |
| Coxwell's 1548 | DuPont 3648 | Finn 5501-5503 | Golf Tech & Design 5702 |
| Creative Sales 702 | Dura Plastic Prod. 807-809 | Fisons Horticulture 594 | Golfax, Ltd. 5802 |
| Crenshaw/Doguet Turfgrass 3708 | D.E. Wolfe Metal Fab 3709-3711 | Flat-Gard 603 | Goossen Industries 748 |
| Curtis Dyna Fog 5406 | Eco Soil Systems 5127-5129 | Flexalon 3762 | Government Prod. News 5728-5732 |
| Curtis Instruments 3707 | Egypt Farms/E&S Soil & Peat 3352 | Flowtronex Int'l 950 | Grace-Sierra 2135-2139 |
| Curtis & Curtis 5828 | EICON 3704 | Floyd & McKay Aerofier 3319-3321 | Granite Graphics 5803-5805 |
| Cushman-Ryan 2314 | Elanco Products 2247-2252 | | Great Salt Lake
Minerals & Chem 5310 |
| Cylex 1120-1122 | | | Greencare International 3302 |



Greenscape Pump Services 5121	ICI Americas 1116-1118	Koos/Shore 5312-5314
Greensmix 1950-1952	IGENE Biotechnology 252	Kubota Engine Div. 1340
Griswold Controls 404-406	IMAS 5604	Kubota Tractor 2850
Grounds Maintenance 5329-5331	Innovative Equipment 837-839	Kurtz Bros. 3346
Growth Products, Ltd. 528	Insta-Plak, Wood Products 301-303	Lab Systems/Software 1944
Gro-Power 2142	Institute of Groundsmanship 242	Lake City Community College 5632
Gustafson 845	Intergroup Systems 3701-3702	Lakos Separators & Filtrat. 328-239
Hahn 2634	International Seeds 1222	Lancaster Level-Flo 5606-5608
Hall-Kimbrell Envir Serv. 5325-5327	Interstate Battery System 282	Landscape Management 5434
Hammer's Plastic Recycling 5128	Ironite Products 144, 243	Landscape Products 1842
Hancor 3233	Irrigation Association 5431	Lantana Peat and Soil 340
Harco Fittinge-Harrington 3449	Irrrometer 3323	Lasco Fittings Div. Philips 2148-2152
HDN Book Sales 5332	I.B.D. Mfg. 5430	Lawson Products 3717-3718
Helena Chemical 3224-3226	T&T 1943	Layne-Western 507-509
Hendrix and Dail 331	Jacobsen Div. of Textron 1316	Lebanon Total Turf Care 1239-1241
Henry Golf Ball Washer 3642	JDR Enterprises 3719	Lely 1442
Hertz Equipment Rental 5228	JRM Chemical 532	Leonard Technologies 3733
Hinepergers Poly Ind. 1814-1816	J.A. Cissel Mfg. 1643	Lesco 2035-2036
HMC/The Green Machine 1538	J.R. Simplot 1207-1209	Lester Electrical 2242
Hoechet-Roussel Agri-Vet 401-403	Kalo 1652	Lewis Standard Tools 1144-1146
Horticulture Automation 259	Karsten Turf 1350	Liquid Ag 308
Howdry Ltd. 3735	Kawasaki Motors, U.S.A. 838	Liquid Sod 628
Howard Fertilizer 5511	Kawasaki Motors - Eng.Div. 128-132	Locke Mfg. 1221-1223
Howard Johnson's Etp. 808	Kent Manufacturing 740	Lockwood Mfg. 1747
Howard Price Turf Equip. 602	KeyStone Retaining Walls 3239-3241	Lofts Seed 1128
Humate International 3724	KLM Bio Systems 1844-1846	Lombardini USA 1940-1942
Hunter Industries 3232	Kohler/Engine Div. 2122	Lundin & Co. 5602
Hyundai Precision & Ind. 516	Komatsu Zenoah America 3603-3604	Maibo 202

Maletti Macchine Agricole Spa. 902	Sandoz Crop Protection 228-230
Manhattan Ryegrass Growers Assoc. 1107-1109	Saratoga Fence 601
Markers 5824	Schipper Bulb 356
Marlin Industries 5706	Seed Research of Oregon 925-927
Martin Wheel 3614-3616	Selectric 5608
Master of the Links 5601	Shindaiwa 5512
Matco Products 3712	Shuttlecraft U.S.A. 1050
McMasters Rice Hull Compost 5707	Side-Winder 3705-3706
Malex USA 1928	Sierra Industries 429
Melroe 316	Sign Gallery, The 3743
Michigan Peat 249	Simplex-Ideal-Peerless 605
Michigan Seat 3729	SISIS Equipment 3601
Micro-Trak Systems 3325	Smithco 1802
Miles W. Fry & Son 248	Snapper Power Equip. 732
Milliken Chemicals 931-933	Snowco-Kuker 1850
Milorganite 2447-2451	Soil Technologies 3235
Miltona Turf Products 3606-3608	Solatrol 3759-3760
Monsanto 3126	South Ag 5620
Motorola Electronic Command 2942	South Florida Turf Equip. 5320
Mowing Machine 908	Southern Concrete Pavers 3742
Multi Seal Tire Sealant 3746	Southern Golf 5436
M-B Inc. of Wisconsin 5720	Southern Screen & Emby. 3747-3749
Naiad 3645-3646	Southern Turf Management 251
National Diversified Sales 431	Southern Turf Nurseries 3338
National Golf Foundation 5631	Speare Manufacturing 231-233
National Mower 1402	Sports 4 1005
Nearby Mfg. 1134	Spraying Devices 1240
Neogen 2241	Spraying Systems 227-229
Neptune Research 405	Spring Valley Turf Prod. 5409
NGK Spark Plugs 5026	Standard Golf 2214
NIBCO 3713	Standard Sand & Silica 5023
Noland Graphics 5832	Star City Fabrication 5827-5831
Normarc Seed 5808-5810	Sta-Rite Fluid Power Group 122
North American Green 5308	Stenten's Golf Cart Access. 309
North Central Plastics 733	Stone Graphics 402
Northrup King 3419-3421	Stuart's Farm Service 3703
Nor-Am Chemical 2240	Sundstrand-Sauer 3625-3626
Nunes Manufacturing 3238	Sunniland 704-706
Nutri-Turf 1245	Superior Controls 3622
Olathe Manufacturing 2642	Sustane 1648
Onan 1828	Sweepster 2243-2244
Oregon Fine Fescue Comm. 433	SyncroFlo, Inc./Kesler Int'l 422
Oregon Ryegrass/Highland Bentgrass Comm. 832-834	Technic Tool 5701
Otterbine/Barebo 3632-3635	Tee-2-Green 1102
O.M. Scott and Sons 2114	Teledyne Total Power 1250
Page-Com 830	Terra Equipment Ltd. 626
Palmetto Turf Farm 630	Terra International 5129
Par Aide Products 1016	Textron Financial 1532
Parkway Research 3736-3737	Tex-Net 134
PBI-Gordon 1028	Thompson Mfg. 726
Peco 438	Tifton Turf Farms 631
Pelican Marine Ent. 5127	TNT Utility Systems 3613
Pennington Seed 5212-5214	Toro Co., Commercial Prod. 2514
Pepco 306	Toro Co., Irrigation Div. 2502
Perfect Picker 3605	TransAmerican Soil Blenders 3620-3621
Perfection Sprinkler 3250	Triple Crown Fence 409
Perma-Sign by Ocala Marble & Granite 5123-5125	Trojan Battery 1201-1203
Pest Management Supply 5230	True Temper/Cyclone 530
Phillips Fibers 3345	Turf Drainage Co. of America 5226
Pickseed West 3220-3222	Turf Merchants Int'l 648
Piece 330-332	Turf Services 3761
Pike Creek Turf Farms 338	Turf Specialists 253-254
Pinhigh Reel Sharpening 510	Turf Specialties 204
Pioneer Peat 3755-3756	Turfco Mfg. 1302
Plant Food 5628	Turfco Int'l 1101-1105
Plant Marvel Labs 506-508	Turf-Tec International 3611
Plantstar 5130-5132	Typographic Data Consultants 250
Playfield Industries 244-245	T. Christy Enterprises 355
Precision Laboratories 1836-1838	T.A.T. Golf Signs & Supply 3350
Precision Small Engine 216	UAP Special Products 5626
Premier Brands 3349	Uniroyal Chemical 305-307
Prestige Cars 5410	Unit Structures 408
Professional Golfers' Assn Management Soc. 5531	United Stockmen 210
Progressive Electronics 5311	University of Minn.-Waseca 5330
Promark Products 1303	USGA Green Section 5529-5530-5629
Pumping Systems 2914	U.S. Battery Mfg. 744-746
Pursell Industries 1645-1647	Valent U.S.A. 3392
Pursley Turf & Tree Farm 5710	Van Waters & Rogers 246-247
R & R Products 2141-2151	Vanderhave Oregon 3248
Rain Bird Sales, Golf Div. 2132	Vermeer Manufacturing 3653-3655
Rain Jet Floating Aeration 1917-1921	Vicon 2348-2352
Rain Master 302-304	Vigoro Industries 3320-3324
Rain Saver 648	Warrens Turf Nursery 3627-3628
Ransomes 2202-2302	Washington Manufacturing 544
Raven Enterprises 3602	Water Hog 5120
Recreation Resources 5031	Water Utilities Services 1840
RedMax 3603-3604	Watertronics Pumping Systems 936
Reelsharp USA 3720	Weather-matic 3114
Reemay 1946	Western Pumping Systems 916
Regal Chemical 2448-2452	Western Wood Structures 1219
Regency Wire & Cable 1744	Weyerhaeuser Silva-Fiber 5604
Repower Specialists 1818	White Hydraulic 5021
Resort Publishers 5603	Wilbur-Ellis 435-437
RF Inter-Science 5427	Wilco Distributors 3732
Rhone Poulenc 1216	Wilkins Regulator Div., Zurn Ind. 710
Richway Industries 3744-3745	Willamette Seed 3443-3445
Rico Mfg. & Supplies 3751-3752	Winrock Grass Farm 3610
Ringer 3150	Wittek Golf Supply 3623-3624
Riverdale Chemical 802	Yamaha Motor, U.S.A. 3102
Roberts Seed 5826	Yanmar Diesel Engine (USA) 5020
Roots 5704	Yardney Water Mgmt. Sys. 357
Roseman Mfg. 2650	Yeager-Twose Equipment 327-329
Roto-Hoe 333	York Modern 3649
Ruffin 5502	Zajac Performance Seeds 3237
R.G.B. Laboratories 1822-1824	
Salsco 5302	

This list of exhibitors was provided by the Golf Course Superintendents Association of America.

Mon., Feb. 19

8 A.M.

Monday and Tuesday Two-Day Seminars

- Basic principles of turfgrass management
- Business communication and assertiveness techniques
- Disease identification and control
- Environmental considerations in golf course management
- Golf course design principles
- Insect pests on golf course trees and shrubs
- Introduction to surveying
- Irrigation I: Equipment and technology
- Managerial productivity
- Turfgrasses: Qualities, uses and sources

Tues., Feb. 20

8 A.M.

Two-Day Seminars Continue One-Day Seminar

- Golf course safety, security and risk management

Wed., Feb. 21

8 A.M.

One-Day Seminars

- Biology of turfgrass soils
- Calculations and practical mathematics to use in turfgrass
- Employee training
- Financial management
- USGA golf course rating system
- Water quality and irrigation scheduling

Wednesday and Thursday Two-Day Seminars

- Basic turfgrass botany and physiology
- Golf car fleet operations
- Golf course construction techniques and management
- Golf course restoration, renovation and construction projects
- Integrated pest management
- Introduction to soil science
- Irrigation II: Systems design and management
- Landscape plant materials
- Plant nutrition and fertilizers
- Public relations and public speaking
- Turfgrass insects: Basic and advanced principles
- Weed control

Thur., Feb. 22

8 A.M.

Two-Day Seminars Continue**One-Day Seminars**

- Budgeting and forecasting
- Cardiopulmonary resuscitation
- Certification exam study guidelines
- Effective business writing
- Developing your hazard communication program
- Negotiating
- Safe pesticide management
- USGA intermediate rules of golf

8 A.M. - 5 P.M.

Certification study guidelines to gain Certified Golf Course Superintendent status. A course offered for superintendents beginning to study for the certification examination. It includes lunch. Participants must register on GCSAA conference registration form.

11 A.M.

Conference and Show Registration Past Presidents' Luncheon Meeting 2 P.M.**International Reception**

5:15 - 8 P.M.

Opening Session and Reception, open to all attendees in the Peabody Orlando Hotel. The keynote address will be given by Dr. Ken Blanchard, author of "One Minute Manager" library. A cash bar reception with music and dancing will follow, featuring the Pink Flamingos.

8:30 A.M.-Noon

Concurrent Education Sessions (20 minutes per topic)

- Critically evaluating your needs: What should be in your job contract; the equipment bid process; comparison of cultivation equipment; gas versus diesel; low-maintenance alternative species for golf course roughs; how seed is evaluated; snake oils or legitimate products?; caution: turfgrass sampling in progress; sampling turf to improve grub control; your legal recourse for faulty work or products.
- Golf course management techniques I: Annual flower beds: designs that work; perennial plantings for the golf course; deep-tine aerification and root responses; the mechanism of winter injury; preventing winter desiccation on greens; using computers to

manage turf in the 21st century; the "grow-in" of Stone Harbor Golf Club; motivating your personnel; weather effects of El Nino, La Nina; using a camera for documentation.

- Managing today's environment: Ground water and the golf course environment; minimizing nitrate leaching from turf to ground water; the Cape Cod study: implications for the future ground water; pesticide fate in turfgrass; designing facilities for the safe and efficient storage, mixing and handling of chemicals; EPA update; coordinating a pesticide disposal day; employee training; the nursery industry: a natural for combating global warming; disease detection update.

11:30 A.M.

CGCS (Certified Golf Course Superintendent) Certification Luncheon.

Friday, Feb. 23

Pre-registration is required.

1 - 4:30 P.M.

Concurrent Education Sessions (20 minutes per topic)

- Golf course management techniques II: soil compaction and plant growth; subsurface application of pesticides and other materials; pesticide use and the creation of liability; new fertilizer technologies; controlled release — tee up the latest technology; the environment and grub control; controlling mosquitoes and other flying pests; practice tee overseeding; preparing for medical emergencies; the honeymoon is over.

- Southern turfgrass management: Controlling fire ants; spring dead spot research on Bermudagrass; the cause and control of localized dry spot on putting greens; does Zoysia have a place on your golf course?; watering and aerification during dry seasons; golf

course grow-in: an art or a science?; weed control in wildflowers and ornamentals; sod establishment with dormant Bermudagrass; the Bermudagrass-bentgrass putting green issue; modern procedures for winter overseeding of perennial ryegrass.

- Water quality and distribution: water quality and golf operations: do we have a problem?; prudent water management of warm-season grasses; irrigation efficiency; irrigation supply: the evolution of a new pond; low volume, low pressure systems; canopy temperature-based irrigation scheduling for cool-season turfgrass; weather stations versus the superintendent; fertigation programs for golf courses; xeriscaping: another viewpoint; wily weeds in water hazards.

5:15 P.M.

Members Briefing/Meet the Candidates

Saturday, Feb. 24

7:30 A.M.

Conference and Show Registration

9 A.M.

Ribbon Cutting Ceremony and Trade Show Opens. The trade show floor will close at 5 p.m.

CGCS (Certified Golf Course Superintendent Certification Examination. All examinees must be approved applicants in the certification process and prior to Jan. 15 must have submitted a written statement to GCSAA headquarters of intent to test.

11 A.M.

International Round-Table

Noon

Voting Delegates' Luncheon

1 - 4 P.M.

Voting Delegate Check-In

1 - 4:30 P.M.

Concurrent Symposia

- "Sand topdressing and cultivation,"

a discussion led by Drs. Paul Rieke of Michigan State University and Robert Carrow on the University of Georgia on methods for adapting cultivation and topdressing practices to fit specific golf turf conditions considering why, how and when. It will be chaired by Gary D. Sayre and panelists will include David Steon of the Honors Course in Colteqah, Tenn., Dan Quast of Medinah (Ill.) Country Club, and Jim Moore of the USGA Green Section in Waco, Texas.

- "Disney's commitment to professional horticulture," a talk by Katy Moss Warner, general manager of the Walt Disney World Nursery. Using slides, who will give a tour of the Walt Disney World horticultural operation and tell how the beautiful landscapes are achieved and maintained. Michael W. Rothenberg will chair the session.

1 - 4:30 P.M.

Golf Course Builders of America Session on The Golf Course Builders and Turf Management. Topics will in-

clude:

- Relationship between the golf course superintendent and the builder. International Golf Group President Jerry Pierman will address the relationship between the superintendent, builder and developer, a relationship that at times can be a harrowing experience unless they understand one another.

- Golf course construction in Canada. Atlantic Golf Construction Ltd. President Larry Brown will discuss the challenges facing a builder in Canada's diverse terrain and climate.

- Why USGA Specifications? USGA Green Section National Director William Bengeyfield will tell the USGA specifications are of vital interest to everyone in golf.

- Quality control of your growing media. Transamerican Soil Blenders President Troy McNeil will address the importance of the quality of the products selected for the greens mix and the mixing of those products.
- Getting water on the golf course.

Rain Bird Golf Division Vice President Ed Shoemaker will discuss the amount of water needed, technical requirements and measuring, along with product development, control systems, pressure regulating control valves, valve-in-head rotor pop-up sprinklers and drip irrigation products for unusual water needs.

- Forward tees and their role in modern golf course design. Golf course architect Alice Dye will speak on this popular concept.

- The architect/builder and his relationship to the developer and the superintendent. Golf Course Builders of America President Perry Dye will present his view of the vital relationship between the builder, architect and developer.

7 P.M.

Golf Course Builders of America annual dinner. Pre-registration will be made through the association's executive director, Don Rossi, at Palm Beach Gardens, Fla., headquarters.

Sunday, Feb. 25

tification Committee will be present to answer questions or discuss concerns.

1 - 4:30 P.M.

American Society of Golf Course Architects Session, including:

- Introduction and overview by ASGCA President Robert Trent Jones Jr, who will emphasize the balance between the environment and the golf course with examples from the Spanish Bay and Poppy Hills courses on the Monterey Peninsula.

- Historical perspective of theory by Brian Silva, who will illustrate how the great architects of the past and present have incorporated the natural look into their designs.

- Case histories of Western projects, presented by Robert Muir Graves, who will share his experiences since 1959.

- Case histories of Southeastern United States, with Charles Ankrom, who has used his early experiences in real-estate development into course design projects since founding his firm in 1972.

- How the "natural look" is incorporated into remodeling projects, presented by Jeff Brauer, who will explain

his design approach, which includes sequential procedure and detailed plan preparation.

Golf Course Mechanics Session, a first-ever presentation, and open by pre-registration. Following a welcome from Pat Ryan of Libertyville, Ill., vice president of the Chicagoland Golf Course Mechanics Association, the program will include:

- Keeping up with the times, by John Maguire of Mundelein, Ill., president of the Chicagoland association.

- Birth of an organization, by Tino Martinez of Royal Poinciana Golf Course in Naples, Fla.

- Mechanics association from a superintendent's viewpoint, by Bruce Williams of Bob O'Link Golf Club in Highland Park, Ill.

- Professionalism, by Ed Combost of Lake City (Fla.) Community College.

- Relative height of cut, window for optimum cut, by Rich Smith of The Toro Co. in Minneapolis, Minn.

7 P.M.

President's Reception (By Invitation)

Monday, Feb. 26

7:30 A.M.

Conference and show registration

8 A.M.

All Exhibitors Continental Breakfast Meeting

8 A.M. - Noon

USGA Green Section Program, among whose prominent speakers will be:

- F. Morgan Taylor Jr., chairman of the Green Section Committee, who will give a welcome and introduction of new research projects undertaken by the USGA.

- Golfers President Edward Connor, speaking on computer analysis for golf course restoration.

- James F. Moore, director of the Green Section's Mid-Continent Region, who will tell how misdirected good intentions can spell trouble.

- B.P. Russell, chairman of the USGA Executive Committee's Public Golf Committee, who will talk on the coming of public golf.

- GCSAA President Dennis D. Lyon of City of Aurora, Colo., Golf Division,

speaking on it's the little things that count.

- Stanley Metzger, superintendent at Country Club of Colorado, who will talk on the professionalization of the golf course superintendent.

- USGA regional directors and agronomists, who will present turf tips.

Trade Show Opens (and remains open until 1 p.m.)

Certification Examination

1 P.M.

GCSAA Annual Meeting

6 P.M.

Banquet Reception

7 P.M.

Annual Banquet highlighted by the presentation of the Old Tom Morris Award to Sherwood Moore. Entertainment featuring Tony Orlando will top off the dining and dancing, and the conference as well.