



NEW HYBRID MOWER CUTS FAIRWAYS LIKE GREENS

Inspired by John Deere's established customer feedback programme, the 8000e E-Cut hybrid fairway mower is an industry first.

This brand new, three-wheeled, ultra-light fairway mower is mainly designed for golf course use, but is also suitable for other sports turf customers requiring a top quality finish.

The 8000e is equipped with John Deere's new 46cm QA5 cutting units, to give an overall 2.03m width of cut.

This five-gang mower allows the operator to cut fairways like greens, with a tighter stripe, excellent contour following and exceptional manoeuvrability.

In particular, the three-wheel configuration allows increased productivity around the tightest bunkers as well as larger tee areas. This design's lower ground pressure also leaves a minimal 'footprint', making the

8000e E-Cut a more productive alternative to hand mowing larger areas of fine turf, for example.

Powered by a 37hp turbocharged diesel engine, the 8000e E-Cut mower combines low noise and engine emission levels with reduced fuel consumption, due to the use of John Deere's innovative hybrid drive technology. This system, which is also featured on the new 7500e and 8500e E-Cut fairway mowers, eliminates all potential hydraulic leak points from the reel drive circuit.

The GRIP all-wheel drive traction system also comes as standard. This minimises wheel slip by sending hydraulic flow from the wheels that slip to the wheels that grip, providing the operator with excellent traction and reducing the risk of tyre marks, whether mowing up and down or side to side on slopes and hilly areas.

i www.deere.co.uk

NEW VIBRATORY ROLLER RANGE

Designed for use on the Bobcat's skid-steer loaders, compact tracked loaders, all-wheel steer loaders and telehandlers, Bobcat has launched a new range of vibratory rollers offering five different models with widths from 122 to 203 cm (48 to 80 in).

Replacing the previous 122 and 183 cm models, the new 122 cm and 185 cm models are both available in padded and smooth drum versions. In addition, a smooth shell kit is available for the padded versions of the 122 and 175 cm models.

i www.bobcat.eu



THE REAL AIR FORCE

Our heavy duty product line of blowers and collectors is packed with features to get the clean up done quickly and efficiently.



With the renowned AgriMetal build quality, isn't it time you saw the real air force at work.

AgriMetal

Tel: 0845 026 0064 www.jsmd.co.uk



Disease Control

A new way of thinking

Background

Sherriff Amenity, working with independent research organisations such as the Sports Turf Research Institute (STRI) and with chemical manufacturers, have carried out extensive trials on the efficacy and compatibility of fungicide tank-mixes. This work was commissioned in order to provide new and innovative solutions to the turf disease problems experienced by our customers.

Tank-mixing

Mixing two or more products in the spray tank can be carried out to reduce the potential for disease resistance development. Certain tank-mixes can also improve the quality of the turf and reduce the time taken for the turf to recover from disease attack.

Fungicides are selected with different modes of action so that the resulting mixture will attack the target disease on two or more fronts. This makes it difficult for the pathogen to develop resistance to the treatment.

Tank-mix Packages

Data from each trial has been thoroughly assessed and analyzed. The results have helped us to develop our innovative Fungicide Packages, available exclusively through Sherriff Amenity. Please contact us to find out more.

Sherriff Amenity, Cambridge House, Nottingham Road, Stapleford, Nottingham, NG9 8AB
Tel: 0115 9390202 Fax: 0115 9398031
email: info@sherriff-amenity.com web: www.sherriff-amenity.com



Harrogate week

Your Guide to The Largest Indoor
Turf Maintenance and Sports
Facility Exhibition in Europe
incorporating...

An Extensive Five Day
Education Programme



Exhibition

Tuesday 19 January 2010
Wednesday 20 January 2010
Thursday 21 January 2010

Education

17-21 January 2010

Venue: Harrogate International Centre, North Yorkshire, England

Visit our
Harrogate Week
page on...
facebook

Supported by:



ENGLISH GOLF UNION
...at the heart of golf





An Industry Comes Together

In a world of uncertainty it is comforting to know that some things remain solid and dependable.

Harrogate Week has held its well established place in the calendar for over 20 years and while recent years have proved more challenging it has continued to be a “must” for sports turf professionals.

This year is no different and visitors will have the opportunity to top up their knowledge base at

Europe’s premier education programme – Continue to learn – while at the same time keeping abreast of the latest developments and new products launched by the some of the most innovative and creative companies around.

In recent years BIGGA has worked hard to form alliances with other like-minded bodies and the success of this policy can be seen with the number of organisations who use Harrogate Week to host

their own events. This year the R&A, the EGU, the PGA, the GTC, the BALI, the GCMA and the CMAE are all in attendance ensuring that the mix of people grows and the opportunity to share knowledge increases.

I hope that all who attend make the most of the many opportunities that are available.

Scott MacCallum
Editor



Continue to Learn Programme 2010

Presented in the Queen's Suite of Harrogate International Centre, the Continue to Learn Education Programme includes a varied, comprehensive workshop and seminar programme, aimed at greenkeepers, groundsmen, their supervisors, golf course managers, sports ground managers, club managers and others working in the turf industry.

It is regarded as one of the finest educational programmes to be found anywhere in the world.



Sunday 17 January

10.30 - 18.00	Practical Management of a Safety Management System (Day 1)	QS
10.30 - 18.00	Moving into Management (Day 1)	QS
10.30 - 18.00	Golf Course Design (Day 1)	QS
10.30 - 18.00	Preparing and Delivering Powerful Presentations (Day 1)	QS
10.30 - 18.00	Finance and Accounting for Golf Club Managers and Course Managers	QS
10.30 - 18.00	Irrigation: Planning, Installation and Water Management	QS
10.30 - 18.00	Emergency First Aid	QS

Monday 18 January

9.00 - 17.00	Practical Management of a Safety Management System (Day 2)	QS
9.00 - 17.00	Moving into Management (Day 2)	QS
9.00 - 17.00	Golf Course Design (Day 2)	QS
9.00 - 17.00	Preparing and Delivering Powerful Presentations (Day 2)	QS
9.00 - 17.00	Basic Golf Mechanic Workshop	QS
9.00 - 17.00	How to be an Outstanding Manager	QS
9.00 - 17.00	Drainage: Theory, Practice and Realities	QS
9.00 - 17.00	ROLO Health and Safety Course	Holiday Inn

Tuesday 19 January

9.00 - 17.00	BTME & ClubHouse Exhibition	Halls
9.30 - 10.00	Enhancing the Biodiversity of the Golf Course	QS 3
9.30 - 12.30	Basic Electrical System Maintenance	QS 5
9.30 - 17.00	Training an Assistant and Continuing Education	QS 10
10.15 - 10.45	European Greenkeeping Passport - Your Future?	QS 3
10.30 - 11.00	How Do I choose My Wetting Agent Programme	QS 7
11.00 - 12.00	An Introduction to the CMAE and the Certified Golf Club Manager Programme	QS 3
11.15 - 11.45	Sustainable Aeration and Drainage for Golf Courses, Trees and Winter Sports Pitches	QS 7
12.00 - 12.30	Recycling	QS
12.00 - 17.00	Green Roofs and Walls	Holiday Inn
13.15 - 13.45	Sustainable Turf Management - Utilising Soil Potential with Organic Matter	QS 7
13.30 - 16.30	Golf Club Marketing (for non-marketing people)	QS 5
13.45 - 14.15	Redevelopment of the Outfield at Headingley Carnegie Stadium	QS 3
14.00 - 14.30	Nematode Management - A Developing Story	QS 7
14.30 - 15.00	Greens Construction	QS 3
14.45 - 15.15	Nutrition for Early Spring Growth	QS 7
15.15 - 15.45	Performance, Profile and Profit - Real Benefits from Environmental and Social Action	QS 3
15.30 - 16.00	45 Years of Compacts	QS
16.00 - 17.00	Awards Ceremony	QS 3
16.15 - 16.45	Rescue: Using a Selective Ryegrass Killer on Golf Courses	QS 7
19.00 - 22.30	BIGGA Social Night - Wild West Bonanza	Old Swan Hotel

Wednesday 20 January

9.00 - 17.00	BTME & ClubHouse Exhibition	Halls
8.20 - 10.30	The 2mm (or above) Debate	QS 3
9.00 - 16.30	Continuing Development Seminars (EGU, GCMA and R&A)	QS 7
9.30 - 12.30	Water Feature Management	QS 1
9.30 - 12.30	Good Soil Chemistry and Biology: The Answer to Practical Sustainability	QS 5
9.30 - 17.00	Corporate Golf and Logo Merchandise	QS 10
11.00 - 13.00	Diseases Pressure on Links Golf Courses, Fairy Rings Control and Development on Water Management	QS 3
12.00 - 17.00	SUDS and Water Harvesting	Holiday Inn
13.30 - 16.30	Carbon Auditing, Energy and Waste	QS 1
13.30 - 16.30	Master Greenkeeper Workshop	QS 5
13.45 - 14.30	Irrigation Planning and Installation - Behind the Scenes	QS 3
14.45 - 15.30	The Centre Court Roof	QS 3
16.00 - 16.30	Smart Watering for a Healthier Environment	QS 3
17.15 - 18.30	BIGGA AGM	QS 7

Thursday 21 January

9.00 - 16.00	BTME & ClubHouse Exhibition	Halls
9.30 - 10.00	STRI Transition Trials (Poa to Bent / Fescue) Plus Organic Matter Control	QS 3
9.30 - 10.15	Bunkers for the 21st Century	QS 5
9.30 - 12.30	Performance, Profile, Profit	QS 1
9.30 - 12.30	The Rules of Golf and Course Set Up for PGA Events	QS 10
9.45 - 10.15	False Economy in Grounds Management	QS 5
10.30 - 11.00	A Tree for All Reasons	QS 7
10.30 - 11.15	Bunkers for the 21st Century	QS 5
11.00 - 11.30	Growing Turf for the West Course at Wentworth	QS 3
11.15 - 11.45	The Case for Higher Education in Golf Greenkeeping	QS 7
11.45 - 12.15	Integrated Vegetation Management	QS 3
12.00 - 12.30	Sustainable Turf Management - Understanding the Benefits of Cold Process Seaweed Extract	QS 7
12.30 - 13.00	Dialing in Your Surfactant Programme for Firm, Fast and Dryer Playing Surfaces	QS 3
12.45 - 13.15	Using Integrated Turf Management to improve turf quality	QS 7

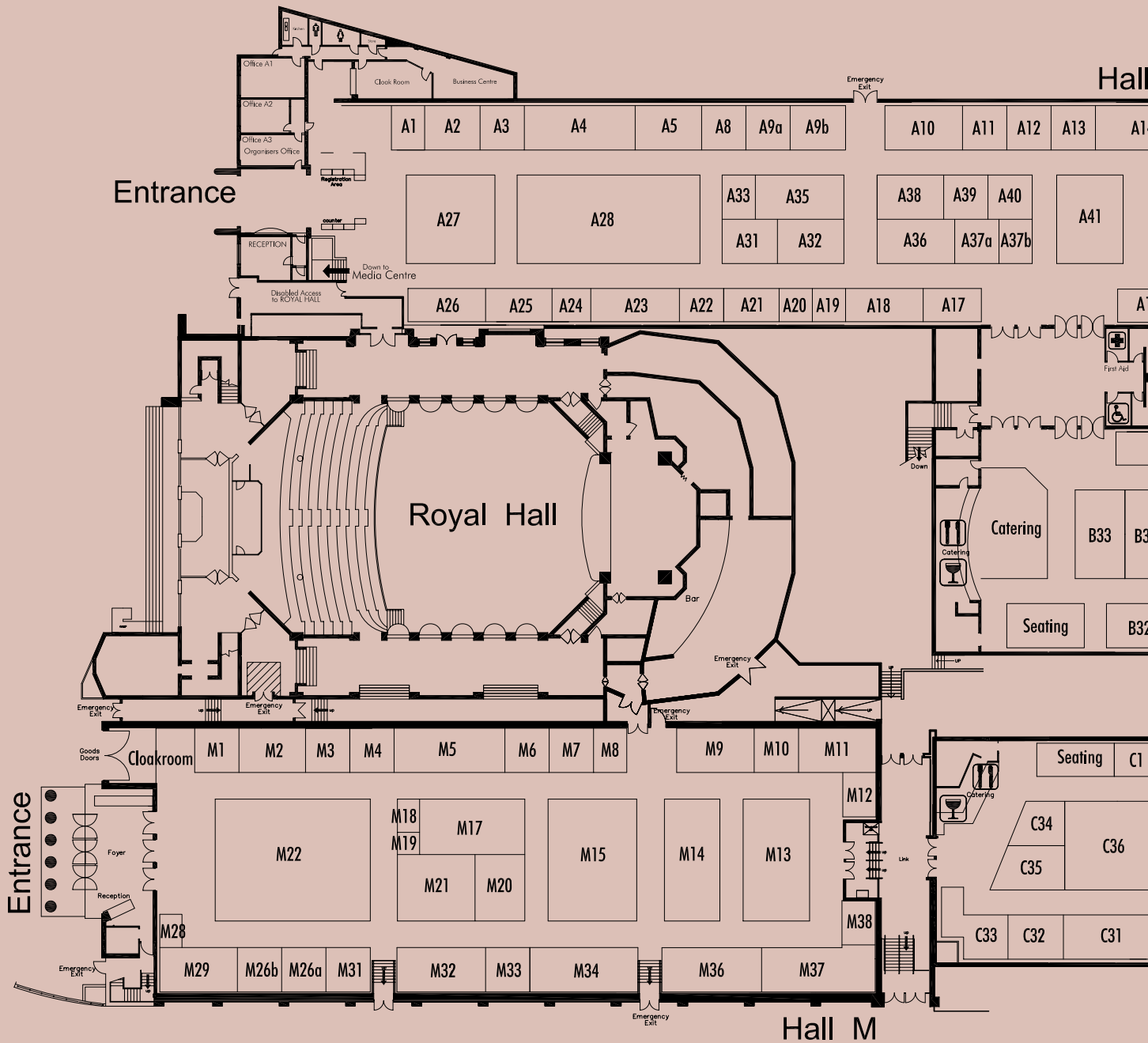

Exhibitor	Stand No
2	
2iC Consultants Ltd	C10a
3 PointPower	B23
A	
Abbott (MJ) Ltd	A33
AFT Trenchers Ltd	B11
Air-Eze Ltd	B30
Air-Seal Products Ltd	M28
Aitkens Sportsturf Ltd	A36
Amazone Ltd	M26b
Askham Bryan	B28
Aquadyne Sales & Marketing	C3
Aston Horticulture Ltd	A20
B	
Badcock Services Ltd	B27
Bailoy	C42
BALI	B38a
Barcham Trees Plc	M31
Barenbrug UK Ltd	A23

Baroness Mowers	C31, C36
Bayer Environmental Science ...	C51
Bellwood Trees	A40
Bernhard & Co Ltd	B33
Blec Global Ltd	A37a
Border Sports Services Ltd	C15
Bridgewater College	C11
BIGGA	B19
British Seed Houses	A15
C	
Campey Turf Care Systems	B40, B40b
Carbon Neutral Landscapes ...	M26a
Celuplast Ltd	A25
Ceres Turf Inc	A31
Charterhouse Turf Machinery Ltd	B37
CL Golf	C29
Cleveland Sitesafe Ltd	B29
Club Car	M21
Coles Cheviot Trees	M7
Complete Weed Control Ltd	C38
Countax Ltd	M36

Course Care	C13
Coursesaver	M19
D	
DENNIS	M9
E	
Eagle Promotions Ltd	C50
Ecosolve Limited	M2
Elmwood College	C12
Engcon	C16a
European Golf Machinery	B10
European Turfgrass Laboratories Ltd	B3
Exhibitors Lounge	C18
F	
Farmura Environmental	A17
Floratine Products Group	A1
G	
Gambetti Barre UK Ltd	A41
Garfitts International Ltd	M38

GCMA	C9
Golf & Turf Machinery Ltd	M20
Groundcare Products	M6b
Groundsman Industries	A12
Grundfos Pumps	A9a
H	
Hardi Limited	M32
Headland Amenity Ltd	C25
HumberPalmer's Fertilisers	C48
Hunter's Promotions Ltd	B7
Husqvarna	M17
Huxley Golf	C34
I	
Indigrow Ltd	B32
Internet Cafe	C17
Inturf	A37b
Irri-Supplies	C7
ITT Lowara	A10
J	
Jex Plant UK Ltd	C14a

Exhibition Hall Plans

Halls A, B, C and M have different coloured fascia boards to help you identify which hall you are in.

- HALL A - Red**
- HALL B - Blue**
- HALL C - Yellow**
- HALL M - Green**

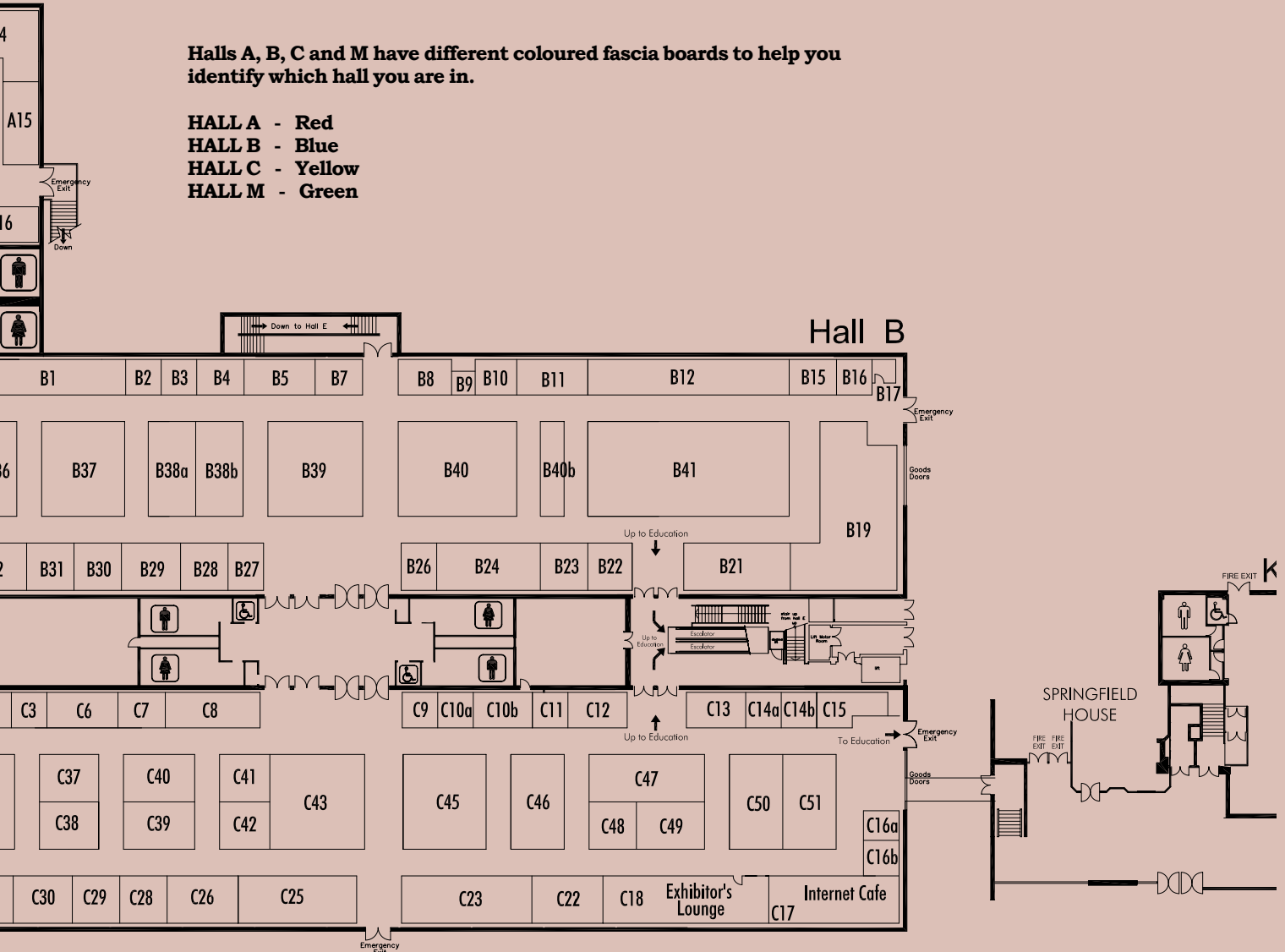

John Deere Ltd..... B12, B21, B22, B41
 John Greasley Ltd..... C41
 Johnsons Sports Seed..... A18
 JSM Distribution M34

K
 Kensett Sports A14
 Kubota (UK) Ltd C32, C35

L
 Lastec UK Ltd..... C43
 Lely Partners in Turfcare A5
 Limagrain United Kingdom..... C33
 Lindum Turf B5
 Lloyds & Co Letchworth Ltd C45
 LS Systems Ltd..... C37

M
 Massey Ferguson (AGCO) Ltd... A27
 Maxicrop UK Ltd A24
 Metcheck M18
 Myerscough College..... B15

N
 New Holland M13, M37
 North Staffs Irrigation B26

O
 Ocmis Irrigation A21
 Orkney Seaweed Co Ltd A8

P
 Parsaver Golf M12
 Penn State University B16
 Phoenix Amenity Supplies..... C26
 Pinseeker Ltd C22
 Powakaddy International Ltd..... B31
 Protea Mowers M10
 PSD Agronomy Ltd A19

R
 Rain Bird Europe S.A.R.L..... A9b
 Ransomes Jacobsen Ltd..... M22
 Reaseheath College..... C14b
 Reco..... M15
 Revaho UK Ltd A35

Rigby Taylor Ltd..... C23
 Rufford..... C40

S
 Scotts Professional B39
 Sheltons Sportsturf Drainage
 Solutions B8
 Sherriff Amenity C8
 Sisis Equipment..... B24
 Speedcut Contractors Ltd..... A22
 Sportcrete Ltd C46
 STRI A16
 Swan Golf Designs B2
 Symbio B4
 Synergy / Ultraplant..... A11
 Syngenta B38b

T
 Tacit B1
 Talbot Sports Turf M8
 Tarmac Topsport..... A26
 Techneat Engineering Ltd C6
 Terrain Aeration Services Ltd B9

The Grass Group (Trilo UK Ltd) .A38
 Tillers Turf Company Ltd A32
 Tomlin (DW) C39
 Toro Commercial Products A28
 Toro Irrigation A4
 Tower Sport (Europe) Ltd C47
 Tru-Turf Equipment..... C30
 True Surface by Turfline M1
 TurfCare Group Ltd..... C10b
 Tym Tractors UK M4

V
 Verde Sports Ltd C1
 Vitax Ltd..... A3

W
 Waste2Water Europe Ltd..... B36
 Wiedenmann UK Ltd..... M14

Y
 Yamaha Motor (UK) Ltd C49



Montpellier
image courtesy of HIC



Cattleman's Association



Blues Bar

A GUIDE TO HARROGATE

Harrogate Week is unlike any other event. It is your chance to meet and interact with decision makers 24 hours a day. After the show closes there are endless opportunities to network in the Harrogate bars and restaurants with fellow turf professionals.

As you can imagine, Harrogate Week proves a busy time for the pleasant spa town.

With much to see and do, Harrogate offers fine cuisine and a lively nightlife along with a glamorous heritage, famous for its Turkish baths.

WHERE TO EAT...

When you're feeling peckish or want to mix business with pleasure...

Alberts	Tel: 01423 568446	Bar & dining
B.E.D.	Tel: 01423 568600	Modern English
Bengal Spice	Tel: 01423 502610	Indian
Betty's.....	Tel: 01423 502746	Traditional English
Biscaya Bay	Tel: 01423 500089	Basque French
Caramba Tapas & Bar	Tel: 01423 505300	Tapas
Cattleman's Association .	Tel: 01423 561456	Tex Mex
Chez La Vie	Tel: 01423 560666	Traditional English
Drum and Monkey	Tel: 01423 502650	Seafood
Harrogate Brasserie.....	Tel: 01423 505041	English
Hedley's Wine Bar.....	Tel: 01423 562468	English
Horoscope.....	Tel: 01423 508144	Chinese
Joe Rigatoni.....	Tel: 01423 500071	Italian
La Tasca	Tel: 01423 566333	Tapas
Loch Fyne	Tel: 01423 533070	Seafood
Rajput.....	Tel: 01423 562113	Indian
Thai Elephant.....	Tel: 01423 530099	Thai
William and Victoria	Tel: 01423 506883	English

WHERE TO STAY...

Holiday Inn Harrogate, Kings Road	Tel: 0871 423 4876
Old Swan Hotel, Swan Road	Tel: 01423 500055
Studley Hotel, Swan Road	Tel: 01423 560425
Grants Hotel, Swan Road	Tel: 01423 560666
Majestic Hotel, Ripon Road.....	Tel: 0870 168833
Crown Hotel, Crown Place	Tel: 01423 567755
Cairn Hotel, Ripon Road.....	Tel: 01423 504005
Cedar Court Hotel, Knaresborough Rd.....	Tel: 01423 858585
St George Hotel, Ripon Road.....	Tel: 01423 561431
Kimberely Hotel, Kings Road	Tel: 01423 505613
White Hart Hotel, Cold Bath Road	Tel: 01423 505681
Alexa House, Ripon Road	Tel: 01423 501988
Yorkshire Hotel, West Park	Tel: 01423 565071
Travelodge, The Ginnell.....	Tel: 0871 9846238
Shannon Court, Dragon Avenue	Tel: 01423 509858
Grafton, Franklin Mount	Tel: 01423 508491
Camberley, Kings Road	Tel: 01423 561618

For more information on accommodation and bookings visit:
www.reservation-highway.co.uk access code "bigga"
 or Tel: 01423 525577.

THINGS TO DO AND WHERE TO PARTY...

Carringtons, Station Parade	Tel: 01423 525551
The Moko Lounge, Kings Road	Tel: 01423 525862
The Viper Rooms, Parliament Street.....	Tel: 01423 520567
Odeon Cinema, East Parade.....	Tel: 0871 2244007
Harrogate Theatre, Oxford Street	Tel: 01423 502116
UK Super Bowl, Tower Street	Tel: 01423 529191

HOW TO GET TO HARROGATE

Rail

Harrogate is served by the main line stations in Leeds and York. Trains run approximately every 30 minutes at peak time. Harrogate International Centre is a 10 minute walk from the station. Taxis are available outside the station and will cost around £3.50.

For further information on rail services to Harrogate contact National Rail Enquiries on 08457 48 49 50 or visit www.nationalrail.co.uk.

Air

Leeds Bradford International Airport www.lbia.co.uk

Leeds/Bradford airport is approximately 12 miles from Harrogate. Taxis are available at the airport at a cost of approximately £18. You may wish to visit the following websites for flight information.

www.flybe.com
www.jet2.com
www.airsouthwest.com

The "Bus 2 Jet" 767 service links Leeds Bradford International Airport with Harrogate town centre. The service runs every 90 minutes between 0615 and 2245, with an average journey time of around half an hour. For further information on this service please contact Harrogate & District Travel Ltd on +44 1423 566061

Or visit www.bus2jet.com

Manchester International Airport www.manchesterairport.co.uk

Manchester International Airport is situated halfway between London and Edinburgh, 75 miles from Harrogate. Public Transport links are available 24 hours a day offering services to Harrogate via Leeds or York.

Coach

National Express www.nationalexpress.com

National Express is the UK's largest scheduled coach network, offering several services a day to Harrogate from all over the UK.

Car

www.theaa.com

Directions

From M1: Leave at Leeds and take the A61 to Harrogate, approximately 15 miles. Harrogate International Centre is

signposted.

From M62: Leave at Leeds and take the A61 to Harrogate, approximately 15 miles. Harrogate International Centre is signposted.

From the South A1(M): Leave the A1(M) at Wetherby and take the A661 to Harrogate, approximately 10 miles. Harrogate International Centre is signposted.

From the North A1(M): Leave A1(M) at junction 47 and take the A59 to Harrogate, approximately 8 miles. Harrogate International Centre is signposted.

From the East: Take the A59 to Harrogate. Harrogate International Centre is signposted.

From the West

Take the A59 to Harrogate. Harrogate International Centre is signposted.

Harrogate Town Centre Car Parks

MULTI-STOREY
Victoria, Jubilee, West Park

SURFACE LEVEL
Odeon, Park View, Montpellier Shoppers, West Park

All town centre car parks are open 24 hours.

Charges apply all days at all times (including Public Holidays)

Free parking for Blue Badge holders and motorcycles

Pay and Display parking is in operation in most town centre streets in Harrogate.

Charges and restrictions apply on Sundays and Bank Holidays in all parking areas unless otherwise stated.



Sea

Direct Ferries www.directferries.co.uk

Direct Ferries are part of Direct Ferries Ltd, an online travel provider based in the UK offering ferry crossings to the UK from the continent. Registered agents of the ferry operators are listed on the website, they sail to 14 Countries and 54 ferry ports on over 60 routes.

North Sea Ferries, from Rotterdam/Zeebrugge to Hull, 59 miles from Harrogate.

Park & Ride

BTME & ClubHouse provides a FREE 'Park and Ride' service from the Great Yorkshire Showground (from the A1M: exit A59 towards Harrogate, follow the ring road to the Great Yorkshire Showground (A661).) to Harrogate International Centre on all three days of the conference and exhibition. If you are planning to drive to Harrogate, this service will help you avoid any traffic problems in town and save you looking for a parking space.

The shuttle service will run at the times:

- Tuesday 20 January 08.30 to 17.30
- Wednesday 21 January 08.30 to 17.30
- Thursday 22 January 08.30 to 16.30

Raise your game.

British Seed Houses is the premier source for grass seed and fertilisers for your Golf Course.

Don't compromise on your choice of grass seed if you want excellent performance and first rate appearance.

For Tees and Fairways BSH Grade 'A' mixtures contain top performing cultivars. For Greens we have the UK's most extensive range of high performing Bent grasses, and our range of Floranid® slow release fertilisers are the ultimate complement all round.

Contact your dedicated regional advisor today for all the expert advice you'll ever need for successful seeding.



Visit www.bshamenity.com
or call 01522 868714 to contact your regional advisor.

HARROGATE WEEK 2010 PRESENTS...

WILD WEST BONANZA

TUESDAY 19TH JANUARY 2010 - 7PM TO 10.30PM

ENTERTAINMENT INCLUDES...

THE OLD SWAN HOTEL, HARROGATE
DRESS CODE: SMART/CASUAL

- DOLLY PARTON AND KENNY RODGERS TRIBUTE ACT
- DJ - SALOON BAR SHOOTOUT - BUCKING BRONCO
- TIN CAN ALLEY - COCONUT SHY - ARCADE GAMES MACHINES

Plus! Wild Casino with 8 Luxury Full-Size Tables

BUY YOUR TICKETS BEFORE 30TH NOVEMBER 2009 FOR ONLY £20^{+VAT}
(£25^{+VAT} THEREAFTER)

INCLUDES RECEPTION DRINK AND MEAL, CONTACT SANDRA ON 01347 833800, FOR FURTHER DETAILS