

Organiser; Trevor Smith, Manet, Horton Road, Horton Heath, Wimbourne, Dorset, BH21 6SB, Tel: 0410 835242. Closing date will be 10 days before the Tournament date ie: Monday October 5. To finish with, I have news of another retirement. Bob Parsons of Barton on Sea Golf Club has decided to call it a day after 45 years. I hasten to add, that is, 45 years at Barton on Sea Golf Club. I wonder if that might be a record. Bob has been a staunch supporter of the Section for a number of years. Hopefully we will still see his friendly face at some of our meetings. On behalf of the section I would like to wish you a long and happy retirement Bob.

Ken Lodge.

### South West

Yet more wind and rain greeted the South West Greenkeepers for the summer tournament at Filton GC. This event was particularly well supported with nearly 50 of us turning up to indulge in the delights of this Bristol course which was in totally immaculate condition thanks to Nick Wilson and his team. We then had an especially fine meal and diverted our gaze from the young waitress long enough for Chairman Chris Sealey

to read out the winners. (Just for the record our team captain Matt Hawker tried to chat up the waitress but was unsuccessful).

The scores were as follows, Head Greenkeepers; 1. Gary Cook, 77; 2. Nick Wilson, 78; 3. Marc Haring, 79. Assistants; 1. James Braithwaite, 67; 2. Craig Fudge, 68; 3. Peter Baynton, 70.

You will notice that the assistants' scores are appreciably better than the Head Greenkeepers. I can only put this down to the extreme strain we Head Greenkeepers are under and also to the fact that we get no time to practice our golf compared to the assistants.

Special thanks are due to Scotts UK who sponsored the day's event and who provided all the prizes and of course to Filton Golf Club who allowed us the use of their course and facilities. Don't forget the coach trip to BTME. Paula tells me that with such an incredible deal on offer this year, the places are going quickly. If anyone is interested then give Paula a ring. There are two matches coming up. The first is at Yeovil against the South Coast Section on September 16 and the second at St Pierre against the South Welsh section on October 7. If you have put your name down for

either of these then please ensure your availability.

Marc Haring

### South Wales

Firstly thanks to Chris Solman for his around the green notes. Unfortunately Chris has other commitments so you now have me to bring you up to date. The Spring Competition results played at Southerndown GC:- The Cardiff Cup, Richard Patterson; Browns Shield, D. Gladwin; John O'Gorman Cup, David Jenkins.

Thanks also to Gary Johnstone and his team for the excellent course conditions.

The matchplay results so far; Kerry Jones beat Angus Macleod, Mike Jones beat Adrian Panks, Dave Gladwin beat Andrew Hatcher, Malcolm Davis beat Andrew Phillips, J. B. Jones beat Richard Patterson, Rob Frater beat David Morgan, Peter Lacey beat Idwall Morris, Daryl Bray beat John Borge, Russell Anderson beat Gary Johnstone, Mike Norfolk beat Peter Edwards.

Another excellent Open day was held at Pencoed College on Saturday June 27 with a large attendance. This also was a good opportunity to view one of the colleges latest ven-

tures, their newly constructed 9 hole Golf Course. Hopefully an annual match us versus the college is being arranged, watch this space.

Rain on June 24 decided that the match v Secretaries was postponed at Creigiau GC - a new date has been arranged on Wednesday September 2. Please phone Peter Lacey if you are available.

Sounds early but it may be in your interest to contact Paula Humphries on 01363 82777 to book your place on a coach to the BTME, at a cost of only £95 per person with an assistant from the same club going for £85. Cannot be bad for three nights B&B.

Up and coming events include, the Regional Seminar featuring Frank Newberry & Ian McMillan at Cannington College on November 25.

A Regional training course is to be held again at the Marriott Hotel Swansea on December 10/11, on Golf Course Design Construction & Establishment.

Last but not least congratulations are in order for Meryl and Neil Smith and D. Thomas on the arrival of their baby girls. Please do not hesitate to contact me with any information on 01656 742761.

Richard Hatcher





**South East**  
Derek Farrington  
Tel: 01903 260956

**Essex**

Date Tuesday November 16, 1999. Time 9am. Place Writtle College. No, I have not gone completely mad, well not quite yet. But this will be when we, the Essex Section, will have the honour of staging the 1999 South East Region Regional Seminar and the committee are looking for ideas, topics, helpers and sponsors for this important event in next year's diary. So anyone interested please contact Martin on 01245 603131. Over the last few months we have had two committee members stand down from their posts. Andy Sheehan and Reg Hooker. Vice Chairman and Education Officer. We would like to take this opportunity to thank them both for their services, especially Andy who has held a number of positions for many a year. Anyone interested in helping on the committee please contact Martin (01245 603131). Next month we will have a total update on the outstanding golfing days (this due to cut off dates for publication). On to the pair's knock out competition. Michael Fance and Scott Reeves are into one semi final where they will play either Barry Brown/Stuart Jenkins or Lee Adams/Gary Speller. While Jon Selwood and Steve Cox wait in the other semi final for the winners of the Andy Sheehan Jack Sholton/Nick Horsewell match.

The Essex Captains held their annual match against the Greenkeepers at Romford Golf Club with the Captains winning as usual. The individual winner of the Greenkeepers competition was Weald Park Golf Club's Doug Mackison. On behalf of all the Greenkeepers who played, we would like to thank Romford Golf Club, their staff and all the captains for their kind hospitality. To Barry Brown and his green staff for all their hard work and on the excellent condition of the course. If you did not receive an invite this year, why not drop a few hints to your Captain Elect for 1999, so you will not miss out on an excellent day out.

On the new members front welcome aboard to Richard Cook, Frinton Golf Club and Lee Squires, The Fairways, and hope to see you at Maylands Golf Club.

That reminds me, our next golfing outing will be on Wednesday, October 7, at Maylands Golf and Country Club. For further details ring Richard Pride 01268 752281. See you there, Dave Wells 01702 522202

**London**

No London Section Column last month, due to a lack of sufficient news to fill the space. After a very damp June, keeping the exceptional

grass growth under control and preparing the courses under difficult conditions seemed to keep everyone fully occupied. However, here is a brief round up of new appointments.

Firstly, congratulations to Duncan McGilvray on securing the post of Course Manager at Potters Bar Golf Club. I am sure Letchworth Golf Club will find Duncan's boots difficult to fill, but their loss is Potters Bar Golf Club's gain, and I am sure we all wish him well for the future. Simon Bolden has left Enfield Golf Club to take up the job as Deputy Head Greenkeeper at Crews Hill Golf Club - Simon had been at Enfield for nine years and his old boss John Kerr and the lads wish Simon good luck. Nick Heller and Tim Phillips, of Grimsdyke, have moved on to gain further experience. Tim to Bushy Golf & Country Club and Nick to Moor Park. Dave Knight, ex Aldenham, and Scott Walker have replaced them on Chris Gravestock's team at Grimsdyke. Kerry Jarman has moved from Sandy Lodge to Moor Park (watch out for grease everyone), and Steve Nicholson has moved from Old Fold Manor to Sandy Lodge.

News from Mervyn Downing - Head Greenkeeper at Aldenham. The car park improvements are complete - after a new entrance was constructed and landscaped last year, the whole area has been surfaced with tarmac, car parking bays permanently lined out and the erection of security lights completed the project.

A few years ago it was "Ally's Barmy Army," but during this summer's World Cup, it has been more like "Monty's Mad Marauders," as part of the North London Greenkeeping contingent became the "Tartan Hordes." Pubs in Barnet waited in fearful anticipation and anxiety to see whether it would be their turn to be invaded prior to the Scotland World Cup games. Landlords were not worried about violence, nor were they worried about profits (quite the reverse), no, it was Monty and Don's interpretation of Braveheart for which they waited in trepidation. I am told by a shocked survivor that the Highland holocaust washed over them in full regalia, kilts, claymores, flags, faces painted with the Cross of St Andrew, Tam O'Shanter's worn with ginger wigs - but it was those legs - those horrible scary legs - that was the worst bit.

The summer golf tournament this year was held at The Buckinghamshire on July 7 and after weeks of rain and grey skies, the sky turned blue and sun came out - a good start to a great afternoon. The Buckinghamshire was constructed in 1991 by Southern Golf with the project managed by Kajima. Designed by John Jacobs, the 'Bucks' is already rated in the top 100 Courses in the UK by Golf World Magazine. Situated next to the River Colne, the Clubhouse is the historic Grade II listed Denham Court Mansion, which has provided very elegant surroundings for some of the top stars of

professional golf. The Bucks hosts the European Championship of the Andersen Consulting World Championship of Golf and also the closing Tournament of the PGA European Senior's Tour, namely the Tournament of Champions, so we were sampling what the Pro's are offered and very nice it was too.

A good turn-out of 46 entries produced the following results from the format of 18 holes of Stableford Golf. 1. Kenny Mackay, Hanbury Manor, 38 Points; 2. Ian Semple, Old Fold Manor (not quite 38 points); 3. Mike Harper, West Herts, 28 points. The Guest Prize was won by Les Clarke and the longest drive was won by Steve Little, of South Herts. The results for nearest the pin, sponsored by Willmot Pertwee Amenity were as follows; 1. Dave Kirk, Hadley Wood, 2. David Ede, West Herts, 3. Kenny Mackay, of Hanbury Manor. The top score by the trade contingent was by Clive Parnell.

Thanks must be given to The Grass Roots Trading Company who helped, in part, to fund the day and who gave us a most interesting talk on new products at a pre-dinner presentation. Managing Director, Jamie Bennett also led everyone in singing an impromptu rendition of 'Happy Birthday to You' to help celebrate Course Manager, Phil Chiverton's birthday. I would also like to take the opportunity to congratulate Phil on his marriage to Ann on April 15 this year, which took place in Australia and was followed by a five week honeymoon around 'Oz'. Thanks to Phil, his Head Greenkeeper, Steve Hook, for all their hard work preparing the course and to the management of the Buckinghamshire and all the catering staff for a marvellous day.

Late news just in. Well done to Lee Robinson, of Flackwell Heath, who is taking over from John Nudds as Head Greenkeeper at Gerrards Cross. John is retiring at the end of the year and Lee, who started his career at Gerrards Cross, is looking forward to his new appointment. Also congratulations to Trevor Smith, Course Manager of Welwyn Garden City GC who is the first Greenkeeper to achieve NVQ Level 4 through the Greenkeeping Training Committee. That's all folks - See you at Saltex, September 8, 9 and 10.

Peter Hopkinson.

**Surrey**

Congratulations to Ken Harding who is now in charge at Worplesdon Golf Club. We all wish him good luck, good weather and a co-operative Greens Committee.

Earnest Doe sponsored the Cresta Cup at Foxhills on June 16 and the prize winners were 1. Dave Wyborn; 2. Nigel Colley; 3. John Mathis. The McMillan Tankard was competed for at Sunningdale on August 5 and our thanks to Brian and his team for another excellent afternoon's golf. Thanks also to the Sunningdale arti-

sans for the use of their clubhouse. The results were; 1. Steve Johnston, 36pts; 2. John Mathis, 36pts; 3. Mike Yorston, 36pts.

Peter Broadbent and his team at Effingham Golf Club are still talking about an unwanted visitor who arrived with a bang at the end of May. A thunder bolt struck property within yards of the sheds at Effingham causing fire damage, shock and additional laundry expenses for the greens staff!

Stuart Dent, First Assistant at Croham Hurst, is leaving to take up his new position at Metro Golf Centre at Hendon as Head Greenkeeper. We all wish him the very best. Good luck Stuart. James Watson has told me of his intended move to warmer climes. Goodbye Clandon Regis Golf Club, Guildford, Hello Capderpera Golf Club, Majorca. Good luck James and if you need anything I'll arrange a visit immediately. Richard Evans from Addington Palace Golf Club and his partner Liz are celebrating the birth of their first born, a bouncing baby boy 8lbs 13oz. Congratulations Rick, very best wishes from us all, especially BW.

Brian Willmott.

Northern  
Ireland

**South East**

On August 1 we had our BBQ at Groomsport Golf Centre a great evening was had by all and winners of the chipping contest were, Terry Crawford, Jonathan McCabe and Ken Henderson. We feel it was beneficial to the Section to have a social event, along with educational and golfing events.

Many thanks go to Alan Boyd, (Boyd Golf Course Accessories) and to his wife Frances Boyd for preparing all the food and sponsoring the event. If there is anyone who has information within the section or would like anything mentioned they can contact me on 01247 472186

Jonathan McCabe.

see us on stand Q14  
**SALTEX** 98  
Sports, Amenities, Landscaping  
8-10 September '98 Windsor Racecourse

# TOUGHEN UP YOUR APPROACH TO WEAR AND TEAR

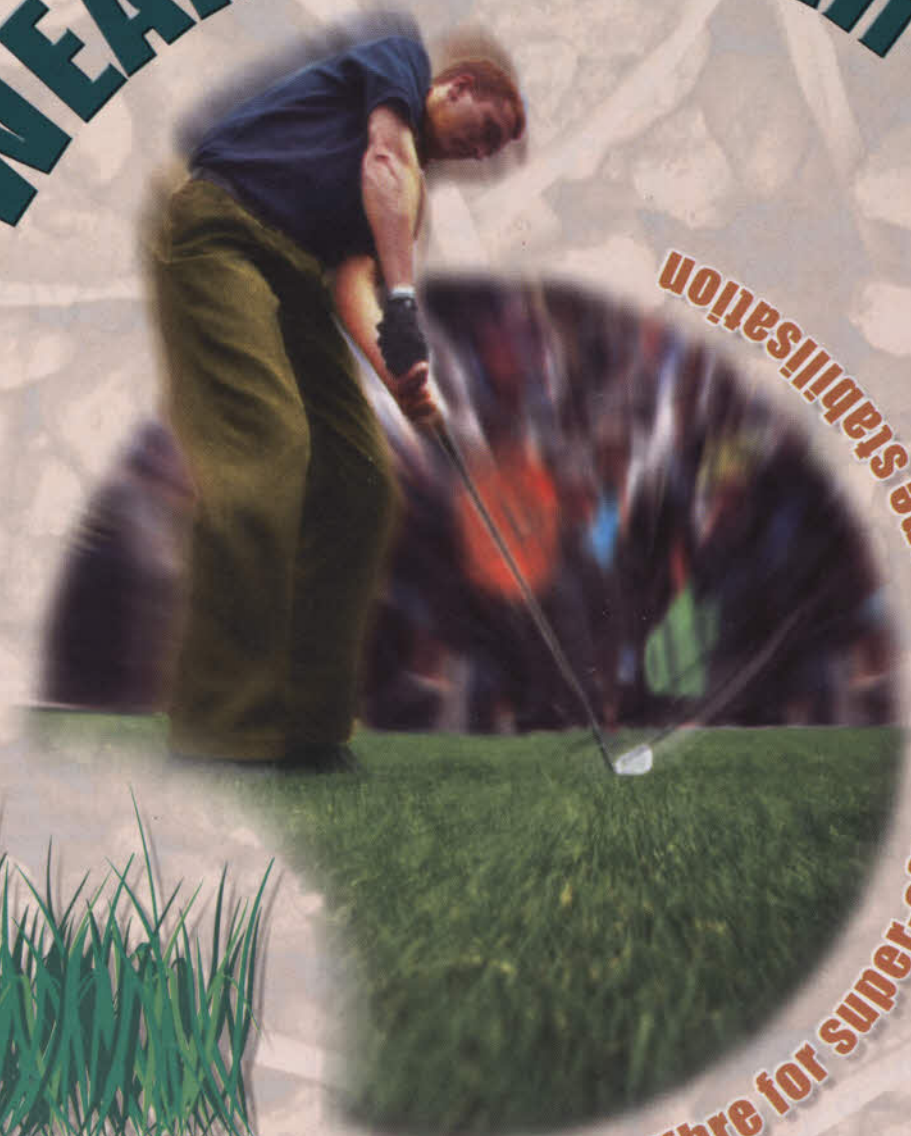

*A great new fibre for super-efficient rootzone stabilisation*

**LOKSAND**<sup>TM</sup>  
fibre

*The stabilising influence*

If wear and tear is knocking the stuffing out of your course, its time to toughen up your act with a new product from the world leaders in rootzone stabilisation fibres. The unique, crimped profile of LOKSAND<sup>TM</sup> fibre will bring back the bounce and give long-lasting durability to high-wear areas of turf.

Call Simon Senior for the very latest success story in sport.

Plasticisers Limited Drighlington Bradford West Yorkshire BD11 1BY England. Tel: 0113 285 2202 Fax: 0113 285 3328

**Drainage expert Barry Cooper talks about a summer which has found out which courses have sufficient drainage. And more importantly which do not.**

# Water, water, everywhere

After a very wet winter and spring and a very unsettled summer many golf courses have been counting the cost of lost green fees and corporate revenue due to inadequate course drainage or in some cases no drainage at all.

Some of the most badly affected courses have been some of the most expensive to construct. I refer of course to the many American and Japanese designed golf courses where only surface water has been catered for and the only drains laid in the ground are non perforated solid pipes carrying water from a system of gully pots that have been placed to intercept swales that have been created. This system of drainage is totally inadequate in this country, and unless ground water is controlled by laying conventional perforated drain pipes to a depth of at least 750mm the

golf course will remain wet after heavy rain.

Many people believe that there is no such thing as a water table in clay land, but I can assure you that this is not true, and unless this water table is kept at least 750mm below the surface, the ground is not dry enough in the winter for the rains to fall on and percolate away. On most clay based courses a system of lateral drains laid across the steepest fall at 15 metre centres and 750 - 800mm deep will control and remove surplus sub-soil water.

It is difficult to believe, but many courses that have been constructed during dry summers and autumns have had no fairway drainage installed, because it did not seem necessary at the time. I do not need to dwell on the extra costs involved in draining a completed and seeded golf course, against draining the

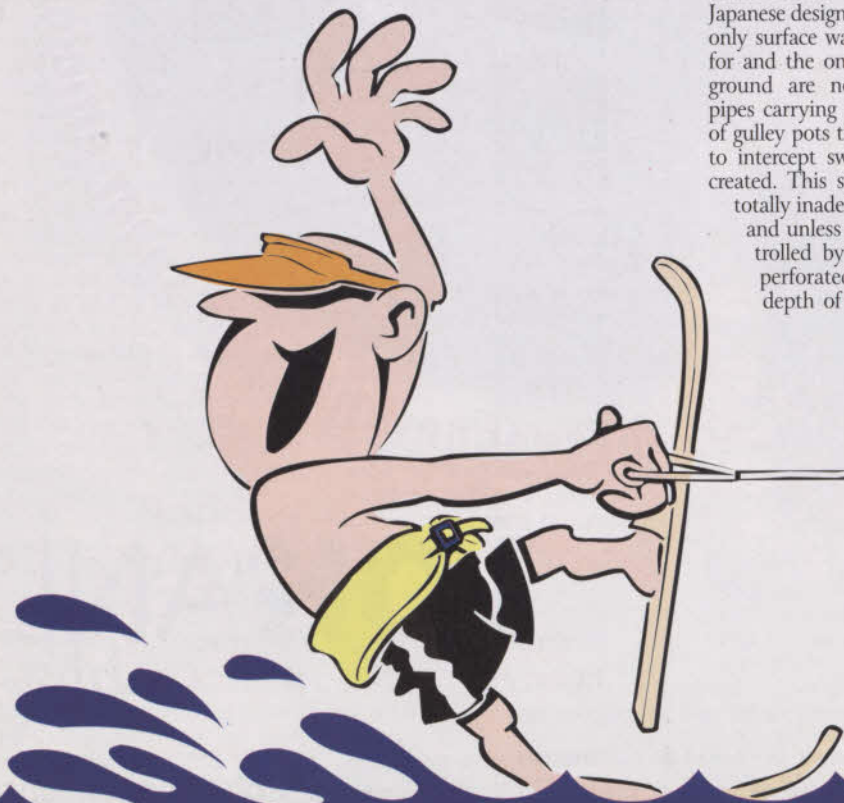

same golf course during its construction.

Seasons such as the ones we have all recently experienced also bring to light drainage problems caused by certain trees having been planted on the golf course. These trees are mainly Poplars, Willows and Alders. All of these trees need water to thrive and during a "semi-drought" time such as 1995-96 the roots from these trees will have had to search harder for water, and any pipe within 20 metres of any of these trees is in grave danger of being penetrated and blocked by a mass of fibrous roots.

I have actually known these roots to travel as much as 50 metres along a pipe line. Drains that have been laid at a shallow depth ie:300mm to 500mm are also very prone to becoming blocked after a dry summer, because the ground cracks and this allows top soil to fall into the

cracks, which in turn gets washed into the pipes when the rains come.

I will end this article by again pleading with Green's Committee Chairmen and Course Managers who are contemplating having drainage work carried out on their course, please employ either a qualified drainage consultant or contractor to design your drainage scheme. This way you can always query the reason why, if the scheme does not work.

Finally, all drainage schemes work very much more efficiently if they are undertaken during the Summer months and not during Autumn and Winter.

Barry Cooper is a Drainage Consultant who boasts some of the country's finest golf clubs among his clients. He can be contacted on Tel: 01858 467684.

## TOP HOLE FOR GOLF GREENS

- SUPER FINE
- SUPER TURF
- QUALITY GRASS SEED MIXTURES
- TOP DRESSINGS
- ROOT ZONE MIXTURES available in 25kg bags, ton bags & bulk

### FAIRFIELD TURF

Fairfield Court  
Fairfield, Brookland  
Romney Marsh  
Kent TN29 9RX

Tel: 01797 344731  
Fax: 01797 344737



Ad Ref 18

T: 01494 79 46 46



JULY - SEPT  
PROMOTION

**NEW**

### OAKLAND TEE MARKER

Buy a set of red & white Oakland tee markers and receive your **YELLOW TEE MARKERS F.O.C**

### SPECIAL OFFER

Purchase 6 cans of spray paint  
**RECEIVE 2 F.O.C**

Purchase 6 cases of spray paint  
**RECEIVE A 2-WHEEL APPLICATOR F.O.C**

quality golf course equipment

F: 01494 79 47 47

Ad Ref 35

# PLAN YOUR ROUTE

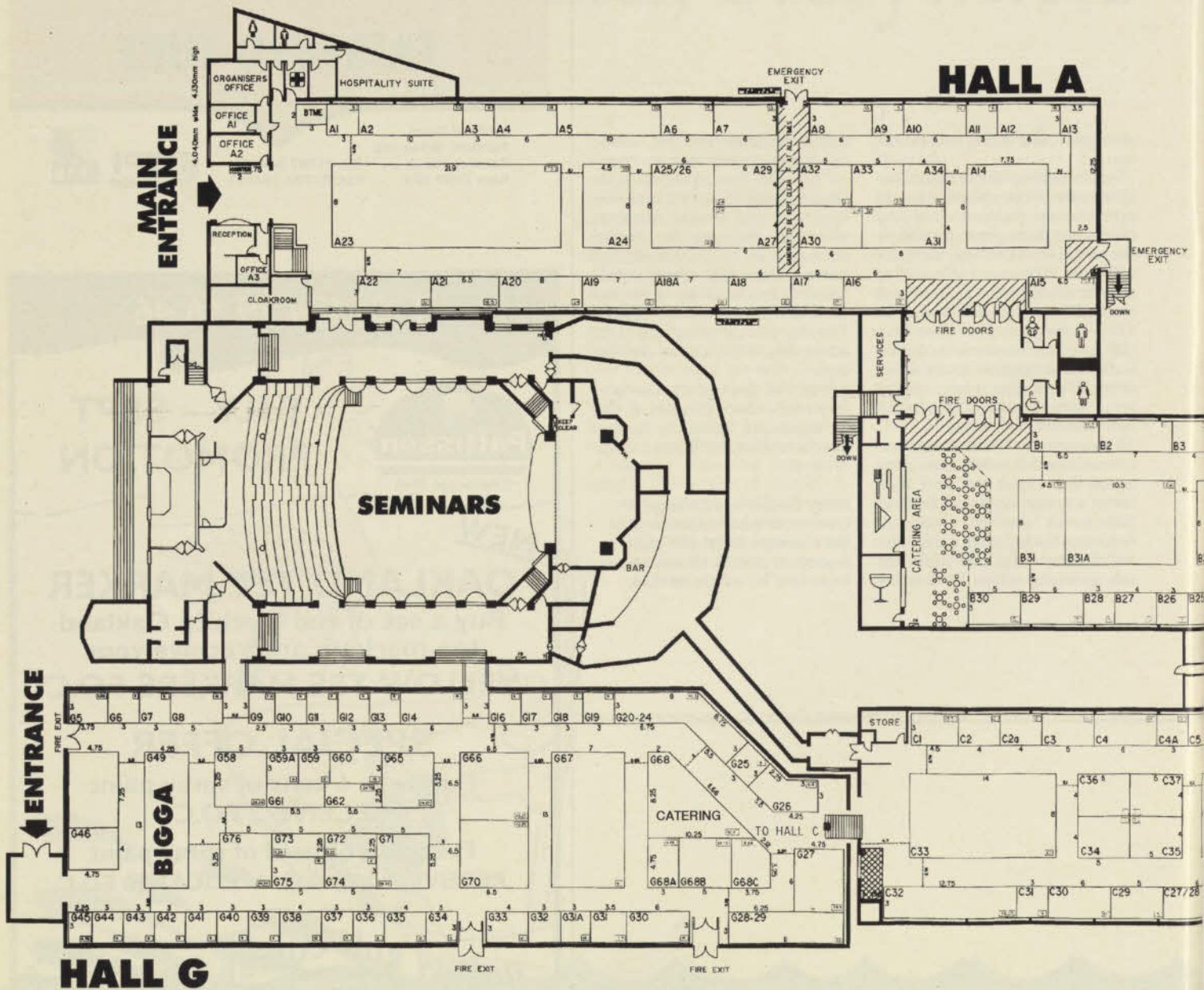

- |                                     |                                 |                              |                                     |   |
|-------------------------------------|---------------------------------|------------------------------|-------------------------------------|---|
| A1 Petroleum Products & Services    | A18a Bernhard & Co              | B4 Undergear                 | B27 Prime Waterman                  | G6 Angus Horticulture                               |
| A2 Watermation                      | A19 Eagle Promotions            | B5 Lindum Seeded Turf        | B28 Better Methods Europe           | G7 Complete Weed Control                            |
| A3 Border Golf                      | A20 Barenbrug                   | B7 Avoncrop Amenity          | B29 Lloyds & Co                     | G8 STRI   |
| A4 Tower Chemicals                  | A21 Simon Tullett Machinery     | B8 York & Martin             | B29 Letchworth Ltd                  | G9 BIGGA Northern Region                            |
| A5 Ocmis Irrigation (UK) Ltd        | A22 Allen Power Equipment       | B9 King's Horticulture Ltd   | B30 Standard Golf                   | G10 British Association of Golf Course Constructors |
| A6 Countax                          | A23 Textron                     | B10 North Staffs Irrigation  | B31 Huxleys                         | G11 European Turf Grass Laboratories                |
| A7 Sportsground Irrigation          | A24 Rolawn (Turf Growers) Ltd   | B11 Green Tech               | B31a Hardi                          | G12 Fairway Credit                                  |
| A8 Amenity Land Services            | A25-26 Wiedenmann Ltd           | B12 Multi-Core Aerators Ltd  | B32 Charterhouse Turf Machinery Ltd | G13 Association of Golf Club Secretaries            |
| A9 PSD Agronomy                     | A27 Supaturf Products           | B13 Talbot                   | B33 Scotts Professional Products    | G14 Sovereign Turf                                  |
| A10 British Seed Houses Ltd         | A29 Marlwood Ltd                | B14 Major Equipment Ltd      | B35 Toro Commercial Products        | G16 Seminar Registration                            |
| A11 Totrax                          | A30 Aitkens                     | B14a Gannon Oils             | B36 Toro Irrigation Limited         | G17 Golf Course News                                |
| A12 County Crops Ltd                | A31 Inturf Ltd                  | B15 Hepworths                | B38 Amazone                         | G18 To be confirmed                                 |
| A13 Kubota (UK) Ltd                 | A32 Vitax Ltd                   | B16 Groundsman Industries    | B39 Par 4 Irrigation Ltd            | G19 GCSAA   |
| A14 Kubota (UK) Ltd                 | A33 Risboro Turf                | B17-18 Saxon Industries      | B40 Bowcom Ltd                      | G20-24 Amenity Technology                           |
| A15 Turfmach                        | A34 Boyd Golf Course Associates | B19 Symbio                   | C1 Swan Plant Services              | G25 Greenkeeping Supply Company                     |
| A16 Farmura (Environmental)         | B1 Tacit                        | B20 Cleveland Sitesafe Ltd   | C2 Fairfield Turf Ltd               | G26 Blazon  |
| A17 Johnsons Seeds                  | B2 Rufford Top Dressing         | B21 Garfitts                 | C2a Verde Sports                    | G27 English Golf Union/Welsh Golf Union             |
| A18 British Overhead Irrigation Ltd | B3 M J Abbott                   | B22 Sharpes International    | C3 Mommersteeg International        | G28-29 IOG  |
|                                     |                                 | B23 Martin Brothers (UK) Ltd | C4 Sub Air Systems (IPU)            | G30 Cooper Peglar                                   |
|                                     |                                 | B24 Logic Irrigation         | C4a Caprari Pumps                   | G31 Pro Turf  |
|                                     |                                 | B25 Irrigation Control       | C5 Perryfield Holdings              | G31a Bowley Hinton Associates                       |
|                                     |                                 | B26 Golf Sign Company        | C6 Olivers Seeds Ltd                | G32 Garden Master                                   |
|                                     |                                 |                              | C7 White Horse Contractors          | G33 City Irrigation Ltd                             |
|                                     |                                 |                              | C8 Wessex Water                     | G34 Welsh College                                   |
|                                     |                                 |                              | C9 Headland Amenity Products        | G35 Myerscough College                              |
|                                     |                                 |                              | C10 Links Leisure                   | G36 Warwickshire College                            |
|                                     |                                 |                              | C11 Green-Relief™                   | G37 Hadlow College - S/O                            |
|                                     |                                 |                              | C12 Kawasaki Motors (UK) Ltd        | G38 Elmwood College                                 |
|                                     |                                 |                              | C13 Bourne Amenity                  | G39 Cannington College                              |
|                                     |                                 |                              | C14 Tildenet                        | G40 Reaseheath College                              |
|                                     |                                 |                              | C15-16 Coursecare/Wear              | G41 Askham Bryan College                            |
|                                     |                                 |                              | C17 Banks Amenity                   | G42 Heron Electric                                  |
|                                     |                                 |                              | C18 Par Aide UK                     | G43 G T Group                                       |
|                                     |                                 |                              | C19 Mitchells                       | G44 Ultra Plant                                     |
|                                     |                                 |                              | C20 J D Greasley Ltd                | G45 Eamonn Wall & Co                                |
|                                     |                                 |                              | C21 Hayter Ltd                      | G46 GTC   |
|                                     |                                 |                              | C22 Farm & Garden Machinery Ltd     | G48 Catering  |
|                                     |                                 |                              | C23 Dennis                          | G49 BIGGA   |
|                                     |                                 |                              | C24 Nature First Ltd                | G58 Pan Britannica Industries                       |
|                                     |                                 |                              | C25 Maxicrop International Ltd      | G59 L S Systems                                     |
|                                     |                                 |                              | C26 Hydroscape                      | G59a E T Breakwell Ltd                              |
|                                     |                                 |                              | C27-28 Humate International         | G60 Vitagrow Fertilisers Ltd                        |
|                                     |                                 |                              | C29 Eric Hunter Grinders            | G61 Aligure Products                                |
|                                     |                                 |                              | C30 Club Car                        | G62 Cooper Clarke                                   |
|                                     |                                 |                              | C31 Tonick Watering                 | G65 Force Limograin                                 |
|                                     |                                 |                              | C32 John Deere Ltd                  | G66 Rhône-Poulenc                                   |
|                                     |                                 |                              | C33 John Deere Ltd                  | G67 Rigby Taylor                                    |
|                                     |                                 |                              | C34 Blec Ltd                        | G68 Catering  |
|                                     |                                 |                              | C35 D W Tomlin                      | G68b BT Mobile                                      |
|                                     |                                 |                              | C36 Boughton Loam                   | G68c Club House                                     |
|                                     |                                 |                              | C37 Tarmac                          | G70 Gem Professional                                |
|                                     |                                 |                              | C38 New Holland UK Ltd              | G71 Rain Bird                                       |
|                                     |                                 |                              | C40 Sisis Equipment                 | G72 British Institute of Golf Course Architects     |
|                                     |                                 |                              | C41 Hayter Ltd                      | G73 Fargo   |
|                                     |                                 |                              | C42 Pattison                        | G74 Cargill Plc                                     |
|                                     |                                 |                              | C43 Etesia UK Ltd                   | G75 Trelleborg                                      |
|                                     |                                 |                              | C44 Twose of Tiverton               | G76 Amenity Solutions Ltd                           |
|                                     |                                 |                              | E1 Eric Hunter Grinders             |   |

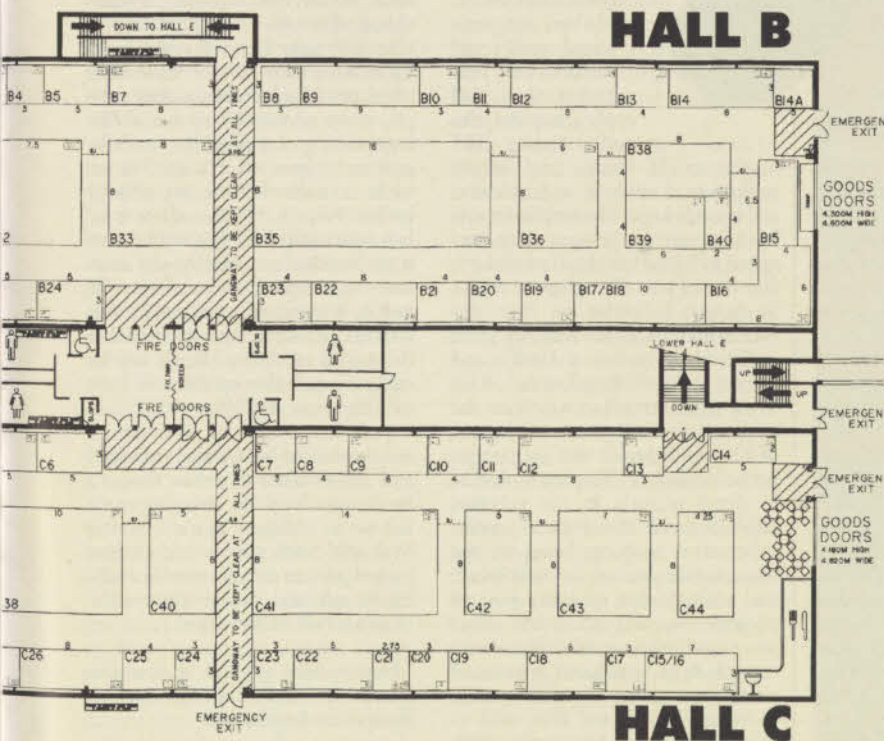
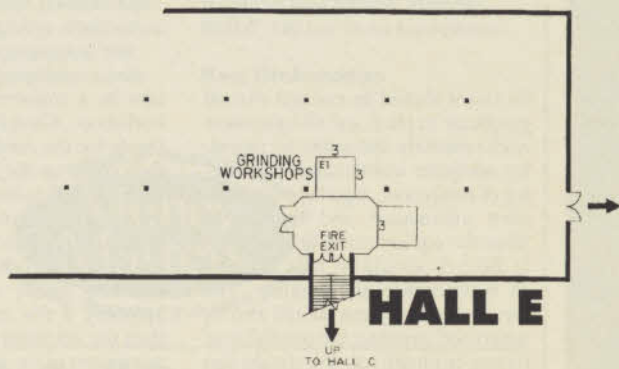

**SEE YOU THERE**



# Taking precautions



Over the next few months we are going to look at the general and more specific health and safety requirements for Maintenance Buildings. The buildings that on most golf courses are used for the storage and maintenance of equipment. We have so far looked at individual pieces of health and safety legislation. We will now look at how this legislation affects a working area of the golf course. Let's first look at the legislation involved:

The Health and Safety at Work Act 1974; Specific sections of the Factories Act; The Management of Health and Safety at Work Regulations; The Manual Handling Regulations; Provision and Use of Work Equipment Regulations; Supply of Machinery Regulations; Electricity at Work Regulations; Noise at Work Regulations; Control of Substances Hazardous to Health Regulations (COSHH); Personal Protective Equipment Regulations; Fire Safety (Workplace) Regulations Safety Signs and Signals Regulations

The first one to look at is the Health and Safety at Work Act. As you will recall this places a general duty on the employer and employee. The employer must ensure that the equipment provided is safe to use. To

do this it should be ensured that all guards are in place and all equipment works correctly and safely, by providing adequate maintenance and testing of equipment, together with sufficient information and training to allow the equipment to be used safely. Records should be kept covering all maintenance and training. The use of the equipment should also be supervised to reduce the possibility of misuse or unsafe use. We should also have written systems and procedures for carrying out specifically hazardous jobs, for example sharpening of mower blades, lifting equipment using blocks and tackle.

Where we mentioned earlier the Factories Act, the section that still applies requires the periodic testing and inspection of chains and lifting equipment. This must be certificated and records kept. The employee also has a duty to use the equipment safely and to follow laid down procedures and not to put themselves or others in danger. Following on from the Health and Safety at Work Act 1974 is the Management of Health and Safety at Work Regulations 1992. These regulations place a duty on the employer to carry out an assessment of all risks to health that are present in the Workplace. This was looked at in detail recently in the previous issues, however in essence it requires information to be gathered on the hazards that are in the Workplace and address what risk they pose to persons exposed to them. This process of assessing risks then allows controls to be introduced, systems or procedures adopted or other means to reduce the risks and allow work to be carried out in a safer manner. Risk assessments would be needed for tasks such as mowing, grass/rough cutting, use of portable tools, use of grinding wheels and all other tasks that you would be required to under-

take in a maintenance building or workshop. Carrying on the same theme for the need to assess risk we then come to the Manual Handling Operations Regulation 1992. As with the previous Regulations these apply to all workplaces and place a duty on employers to, firstly, avoid Manual Handling totally if at all possible. Secondly, if this cannot be achieved then the employer is to carry out an assessment of the risk that each manual handling task poses. When carrying out a Manual Handling assessment, there are four main areas that need to be investigated, these being firstly, the task ie what is actually needed to be done? Secondly, you have to take into account the individual who will be required to perform this task. This will entail looking at whether or not the person has a history of back problems, for example, or are physically capable of lifting, pushing or pulling the items or equipment involved. The third factor to be considered is the actual load itself ie What is it? What shape is it? Is it rigid or flexible? Is it stable? Has it got handles? etc. Finally, you must take into consideration where this task or operation is to take place ie is it to be carried out in an open shed in the middle of winter when it will be cold/wet and the operator will be wearing extra clothing which may impede movements etc. The risks of injury need to be assessed, recorded and action taken to reduce them to the lowest level by providing such items as lifting tackle, hoists, hydraulic tables or workbenches, trailers, etc, or do you provide training in safe and correct lifting techniques for all staff involved.

Next month we will look at the Provision and Use of Work Equipment Regulations.

**Further information on training courses and consultancy contact Lantra National Organisation Ltd (Jean John on 01282 831973 or Tony Rees on 01686 622799).**





### Turfgrass Diseases and Associated Disorders

By Catherine E York  
Published by the Sports Turf Research Institute  
Price £10.50  
ISBN 1 873431 39 2

Published in soft back, this 60 page book covers the identification and control of turfgrass diseases in cool season grasses. Written by Dr Kate York, Plant Pathologist at the STRI, it is written in an easy to understand style, with sufficient advice on how to control and avoid the various diseases. Each disease has its own section, giving alternative names, causes, symptoms, the type of grass susceptible, condi-

tions which favour the disease and methods which can be used for control. Each disease is also illustrated with a small, but adequate photograph. The book, finally, includes a set of tables which give a useful guide to the susceptibility of various grasses in the UK, Germany, France, Italy and the Netherlands.

The author has managed to fit a lot of information into a small book, without making it too complicated. A useful addition to any greenkeeper's library at a very affordable price.

The book is available from the STRI, St Ives Estate, Bingley, BD16 1AU or from bookshops.

**Ken Richardson**



### This month, Geoff Steel gives some very valuable advice to those about to dive into the property market...

Most of us at some time aspire to become property owners. For those who have made it they will probably agree it is one of the most traumatic times of their lives. I will try and offer a few simple ideas to assist any readers who are thinking of buying.

Before you find a house it is essential to know how much you can afford to pay, and how much you can borrow. Generally it is possible to have a mortgage for three times the main wage earner's annual income plus one times the second wage earner. However, some lenders will exceed this limit. A typical cost at current interest would be £73 per month for every £10,000 borrowed - a mortgage of £40,000 would typically cost £292 per month.

Ideally you will have some funds for a deposit and with this in mind you can now decide what you can afford to buy. Do not forget to allow for solicitor and survey fees, plus 101 other costs involved in moving house.

Many buyers like to purchase older properties but it can be very difficult to obtain a mortgage without strings attached. A mortgage will probably be conditional on certain works being carried out, or with some money retained until the work is completed. Without access to additional capital most buyers find themselves unable to complete the purchase as the seller will still want the full purchase price. The purchase of a new house is

often much easier. The builder may have made arrangements to provide mortgages at advantageous terms. Don't immediately accept what is on offer - check with other lenders or an Independent Financial Advisor to compare terms.

The process of buying a house in England and Wales\* is that a purchaser makes an offer. If the seller accepts the offer, the purchaser then applies for a mortgage. The purchaser's solicitor will then check that the owner is legally able to sell and that there are no other developments being planned which will affect the house. It is not until exchange of contracts that either side is committed to the transaction. On exchange it is normal for the seller to ask for a deposit and on completion the full balance of the purchase price must be paid.

Next month I will look at the different types of mortgage.

**Geoff Steel is an Independent Financial Advisor with Walsh Lucas and Co and he welcomes comments from readers. His Freephone telephone number is 0800 7835132**

\*In Scotland it is customary for a seller to secure a mortgage first and then make an offer based on a survey which is then carried out on a prospective purchase by the mortgage lender. Once the offer has been accepted both sides are committed to going ahead.



# FREEBIE THREE FREE

Welcome to part two of the BTME'99 competition, which could be your chance as a Greenkeeper to attend this prestigious event absolutely free!

Together with BTME, the Learning Experience 1999 will provide a varied and informative education programme. The programme for 1999 includes the Golf Course Design Workshop, and NEW for '99, a Basic Machinery Maintenance Workshop. Contact Sami Collins for further details.

All you have to do to stand a chance of winning one of the freebiethreefree superb prizes is to answer six questions. There were two last month, two in this issue, shown below, and the final two plus the entry form will appear in the October edition.

**FIRST PRIZE:** Return rail travel from anywhere in the UK plus three night's accommodation at a top hotel in Harrogate and entry into all the education seminar sessions.

**SECOND PRIZE:** Return rail travel from anywhere in the UK plus two night's accommodation at a top hotel in Harrogate and entry into all the education seminar sessions.

**THIRD PRIZE:** Return rail travel from anywhere in the UK plus one night's accommodation at a top hotel in Harrogate and entry into all the education seminar sessions.

## SEPTEMBER QUESTIONS

1. Name the new workshop for 1999
2. What is the name of BIGGA's Education and Training Assistant?

Remember do not send in your entry until the October edition of Greenkeeper International arrives, containing the third, and final two questions.





# Ocmis Irrigation

**What is the nature of your business?**

Design, supply installation and service of irrigation systems for golf courses and sports pitches.

**What major changes have you seen in your sector of the industry over the last 10 years?**

The implementation of more precise control systems enabling the greenkeeper to manage application and use of water to a much higher degree. The use of Medium Density Polyethylene pipe as used by the Water Authorities available in 100 metre coils, replacing the traditional UPVC pipe which have many joints - one per six metres.

**How do you believe the industry as a whole has changed over the same period?**

Far more aware of water costs - mains water now averages approximately 80p per cubic metre. Far more aware of water usage and application rates and how often to apply the required amount. Far

more aware of irrigation system operation and maintenance through training courses, college courses and the need for irrigation

**Looking into your crystal ball what major developments do you envisage over the next 10 years in your sector?**

The continuing upgrade of the old piping systems and control systems. Even more interest in precise application of water and reliable operation. More attention being paid to sprinkler positioning and nozzle performance.

**And in the industry as a whole?**

The industry will benefit from training given to greenkeepers ie they will enter into a market knowing what they want to buy and why they need it.

**What contribution do you believe BIGGA has made to the industry since the Association was formed?**

BIGGA has promoted the green-

keeper within their own profession. Other people within the golfing sector are now aware of the input and status of a good greenkeeper. BIGGA has promoted greenkeeper training and highlighted that better greenkeepers promote a better golf course.

**Why are you pleased to be associated with BIGGA?**

Because BIGGA promotes an image awareness in the requirements and needs of a professional person doing a professional job,

**What do you believe to have been your company's greatest contribution to the fine turf industry?**

The unique service backup and training offered by Ocmis, the advocacy and use of MDPE pip and compression fittings. Implementing and designing new standards for remedial works on golf courses - utilising machinery which with minimal disruption is capable of installing pipe up to 160 mm in diameter without significant scarring.

Ocmis Irrigation  
Higher Burrow,  
Kingsbury, Martock,  
Somerset TA12 6BU

Tel: 01460 241939  
Fax: 01460 242198



## Would you like true Greens?

YOU NEED TRUE-SURFACE LIGHTWEIGHT VIBRATORY GREENS ROLLERS

- Consistently fast and true greens without lowering cutting heights
- Raise cutting heights or miss a mowing to relieve stress without loss of speed
- Restore surface after aeration
- Vibrate top dressing onto the surface
- The faster way to roll that follows contours just like your mower does



TRUE-SURFACE rollers weigh no more than your standard mowing units. Their unique vibratory action energises the surface particles and transforms the green back to its original shape without using a heavy roller!

USED BY MANY TOP CLUBS THROUGHOUT EUROPE INCLUDING:

- |                                 |                      |
|---------------------------------|----------------------|
| ● St Andrews                    | ● Royal Portrush     |
| ● Gleneagles                    | ● Mere               |
| ● Carnoustie                    | ● Moor Park          |
| ● Forest Pines                  | ● Chobham            |
| ● Slieve Russell Hotel          | ● Dale Hill          |
| ● Lamberhurst                   | ● Slinfold Park      |
| ● Chart Hills                   | ● Fairwood Park      |
| ● Birchgrove Estate             | ● Alwoodley          |
| ● Merrist Wood                  | ● Dalmahoy Hotel     |
| ● North Hants                   | ● Torino             |
| ● Skibo Castle                  | ● Minchinhampton     |
| ● Woking                        | ● Todmorden          |
| ● Parkwood                      | ● Ostswelzerischer   |
| ● Golfplatz Holsdorf            | ● Royal West Norfolk |
| ● Crail                         | ● Secret Valley      |
| ● Kobenhavn                     | ● Royal Dublin       |
| ● Club de Bonmont               |                      |
| ● Gollanlage Munzingen-Freiburg |                      |
| ● Golfpark Schloss Wilkendorf   |                      |
| ● Hamburger Falkenstein         |                      |

ORDER YOUR SET DIRECT FROM THE EXCLUSIVE EUROPEAN DISTRIBUTORS NOW!

**GREENSWARD DIRECT**  
**0113 267 6000**

FREE DELIVERY THROUGHOUT EUROPE



To fit Ransomes Greenplex 160, Toro, Jacobsen, John Deere, Lesco and Huxley

## HTC18 PROFESSIONAL SCARIFIER/COLLECTOR

- Unique floating head mechanism allows ground contours to be followed accurately.
- 1.8m working width.
- 1.8m discharge height.
- Large capacity hopper.
- Easily converted into a sweeper collector.
- Can be fitted with fine finish grass cutting flails.



**WESSEX**  
TRADING ESTATE  
OAKHANGER ROAD  
BORDON HANTS GU35 9HH  
TEL 01420 478111



**WESSEX**  
The right choice