

Results: Cat 0-9. 1. M. Hodgson. Overall winner 41 pts. 2. G. Border, 3. D. Crocher; Cat. 10-18. 1. H. Stevenson, 2. A. Reed, 3. R. Lawton; Cat 19-28. 1. T. Cheeseborough, 2. I. Pemberton, 3. D. Joby. Best Nett on Par 3. 1. Pemberton. Best Visitor. J. Pemberton.

Thanks to sponsors Course Care and the other trader suppliers who gave prizes, Rigby Taylor, Aitkens, Skeens and Norman Sneddon.

Thanks to Norman Sheddon for the card marking. It's great to have Norman with us since retiring last year. Thanks Norman.

Welcome to new member Tommy Pickles, Course Manager at Seaham Harbour GC, Co Durham.

News of some of our members is that Phil Walshaw, Head Greenkeeper at Salbrun has pulled a back muscle while Chris Fiddell broke his leg in a motor bike accident. He is slowly improving and we wish them both well. Graham Scott is helping Bob Lawton at Billingham while Chris is off.

Bruce Burnell

Midland Midland

Here are the results of the first golf tournament of 1996. Apologies for the lateness due to me missing the magazine deadline. 1. D. Fellows 68; 2. J. Wood 70; 3. M. Cutler 70; 4. P Holtman 72; 5. A. Roberts 72; 6. J. Palmer; 7. M. Bryant 73; 8. J. Randall 74; 9. S. Mucklow 74; 10. M. Hughes 74 (All scores nett). Nearest the Pin. D. Fellows; Longest Drive M. Hughes - just beat R. Thomas by the thickness of a tee peg.

J. Brown, who was playing in his first tournament, scored a nett 71 but could not collect a prize as he had forgotten his handicap certificate. Under the Association rules, all players must play in two tournaments before they can receive a prize unless an EGU handicap certificate can be produced. There were four new members playing for the first time - it is good to

hear to new members joining in.

After the tournament there was a handicap review. D. Fellows 11 to 10. As this was for the Hayter Challenge may I remind all players who qualified that the final is on July 16, 1996.

The committee would like to thank all the following companies and their representatives for their support. Firstly, E. Breakwell for being the major prize sponsor and all the other Trade Associates for their raffle prizes. TACIT for sponsoring the Nearest the Pin and Longest Drive. New scoreboards were used on the day, supplied by Bathgate Silica Sands and we thank Mr GM Wood Managing Director for these.

We thank all the staff at South Staffordshire GC for all their help and support and I'm told a good afternoon was had by all concerned. Ken Richardson attended on behalf of HQ.

New members to welcome this month are as follows - James Mannion, Richard Swingle, David Marsh and Richard Jones.

Kim Blake

East of England

Firstly my apologies for the last two months. The reports were not received by Scott so our first Golf Day is a bit short of results and news from the region.

Our first Golf Event of the year was held at Ramsey GC and sponsored by Peterborough Garden Machinery. A poor turn out for our section but all who played had a enjoyable sunny days golf. Thanks to Phil Belton and staff for presenting the course and a good test of golf.

1. Andrew Brown 35pts, 2. Graeme Macdonald 34pts.

The top five placings this year will receive points which will go towards an Order of Merit and the overall winner will receive a BIGGA Blazer.

Our day out in May was played at Market Rasen. This course must be the hidden jewel of the East of England, because it offers all you

can want of a golf course.

A tough test of golf, breath taking holes, tree lined fairways and in excellent condition, pleasant clubhouse and staff and excellent catering. The day was sponsored by Rigby Taylors and Hayters, with prizes donated also from Aitkens, Fieldcare and Purdys. The Rigby Taylor Trophy and decanter went to Richard Smith, Immingham GC, 78 - 12- 66. 2. George Mackay, Lanceby GC, 84 - 17 - 67 who took the Whisky tumblers, 3. Graeme Macdonald, Ryston Park GC, 77 - 5 - 72, who received Brandy glasses. 4. James Dair, Oundle GC, 74 - 1 - 73 took the wine glasses. Nearest the pin on the 18th was won by Les Purdy, who played the last shot of the day and was the only person to hit the green. Rigby Taylor rep, Stuart Jeffs, certainly did not lose any business caddying for John Scothey because his mobile must have gone off 20 times which John said affected my putting (his excuse).

The Hayter qualifiers from Market Rasen to represent EoE at Peterborough Milton in the regional final are as follows

Cat 0-9. G A Macdonald, Ryston Park, James Dair, Oundle, Michael Wood, Thorpe Wood, Richard Owen, Boston West.

Cat 10-18. Richard Smith, Immingham, George Mackay, Lanceby, Kevin Hodges, Northshore, Alan Buckley, Newark
Cat 19-28. G Taylor, Market Rasen, G Ogden, Stoke Rochford, F Cobb, Newark, J Hewson, Market Rasen.

A welcome to new members Leigh Siddon and Jonathan Deavin. The next event is at Newark GC on the 26th June sponsored by Purdys, Hayter Regional Final July 16, Peterborough Milton.

Graeme MacDonald

Bucks, Berks and Oxon

The second golfing event of the season takes place at Henley GC on Monday July 15. If you haven't

entered by now then I'm afraid it is too late because numbers are restricted.

The following day is the Hayter Regional final at Peterborough Milton. I feel pretty confident that the 12 representatives of the B, B&O will do us proud (they can't do any worse than we did last year). Good luck to the Section lads.

Congratulations to Martin Jones and staff for a successful Benson and Hedges tournament. for the benefit of all members local greenkeepers helped with the bunker raking throughout the week. It's probably the only time in my life that I've enjoyed raking bunkers. Mind you I don't envy the guys doing them daily!

If you cast your memory back some months I mentioned the introduction of a newsletter (what newsletter I hear you say) Well hopefully after a few hiccups you have received it now. Hopefully you have some feedback with regards to this venture both positive and negative.

See you all at Henley on the 15th.

Lindsay T. Anderson

South East Kent

On June 9 the Hayter Regional Qualifier was held at Benton Hall GC in Essex. On a very hot day conditions were very tricky with the ball bouncing everywhere often into the few small ponds hidden around the course.

The Kent Section was well represented and out of the nine qualifiers on the day we supplied four.

The lucky ones are: Cat 1. 2. H. Morgan 3. N. Gillham; Cat 2. 2. R. Malt; Cat 3. 2. B. Abbott.

I would like to thank the Kent players who filled in as reserves at short notice unlike some Section players who failed to turn up at all. On behalf of the players I would like to thank Benton Hall for a super day and for making us very welcome and to Hayter for their continued support with this

ITS EFFECT IS SHATTERING

Charterhouse



Deep aeration on an intensively used golf course is vital if the grasses which we require are to survive.

We purchased our first Verti-Drain back in 1983 and very quickly bought a second. Both these machines have been working on a continuous basis providing excellent results and utilising only a minimum of spare parts.

*Comment From Walter Woods
St. Andrews Links Golf Course supervisor*

For your free guide to compaction relief send this coupon to Charterhouse Turf Machinery Ltd., FREEPOST, (G1/2283), Haslemere, Surrey GU27 1DW.
Tel: 01428 661222 Fax: 01428 661218

Name: _____

Position: _____

Address: _____

Postcode: _____

G1.7.96

COURSES THROUGHOUT THE WORLD

tournament.

Details for the next competition at Wilderness will be sent out soon with start times.

I would also like to with John Roots a speedy recovery from his car accident recently. Get well soon John.

Watch this space for further information.
Huw Morgan

Surrey

The Spring Tournament this year had a very good turn out with 51 Surrey members entering. The event was played at Foxhills GC over the Longcrosbie course. Thanks firstly must go to Foxhills for accommodating us in such great numbers and to Neville Shade, the Course Manager, and his staff for turning the course out in such great shape. Also a big thank you to Hayters for their sponsorship and all the rest of the trade's generosity. Results:

Cat 0-9. 1. D. Langheim, 2. D. Murdoch, 3. T. Ingram, 4. A. Freeman; Cat 10-18. 1. D. Jones, 2. G. Pitfield, 3. B. Eyre, 4. G. Kyle; Cat 19-28. 1. E. Stiles, 2. J. Lockyer, 3. J. Roberts, 4. M. Bellarmy. Longest Drive C. MacMillan.

The turnout for this event was outstanding and most encouraging for our Section. I hope those of you who had not played in our Section events before had a most enjoyable day and will be in attendance at future events. Thanks for everybody's support. Keep it up! It makes our job on committee more worthwhile.

There's a cause for congratulations on several items of news.

Firstly to Kevin Day and his family of Woking GC upon the birth of a son, Fraser. Well done! Hope all are well. Also to Mark Bellarmy of the Drift on his marriage to Deborah on May 25. Further congratulations to Puttenham GC's, Tim Watts, who is at present the club's First Assistant. Tim has completed 27 years with Puttenham and at the youthful age of 42 we consider this to be quite a feat.

Forthcoming events include the MacMillan Tankard on Aug 7 and also the Parker Salver on September 12 and the Autumn Tournament on October 3. Entry forms for these events should soon be dispatched if they haven't been already.

David Gibbs

South West and South Wales Region

We had a great day for our Hayter Regional Final at Salisbury & South Wilts GC on June 12. Everything was perfect and our thanks to the golf club and all the staff for making us feel so welcome.

Around the Green



A brilliant sunny day with a course in superb condition - we couldn't ask for more...but we got it in the form on excellent food. Everyone recommends the treatle bread and butter pudding.

Results and our Hayter Team for Fairhaven on September 18.

The Section Shield was won by The South West with a score of 924 while the three category mugs are C. Tozer, B. Jones and J. Breyley.

(All scores nett) Cat. 0-9. 1. N. Pring, 69, 2. C. Rawlings, 71, G. Payne, 72. Reserve. B. Emberley.

Cat 10-18. 1. A. Knight, 73, 2. W. Potter, 74, 3. P. Wentworth, 75. Reserve, D. Jenkins.

Cat 19-28. 1. A. Crichton, 72, 2. J. Barr, 73, 3. A. Archer, 75. Reserve, A. James.
Marion Child

South West

Despite a later date for this year's Westurf, again held at Long Ashton Golf Club, we were once again subjected to some poor weather with heavy rain greeting visitors to the show. This year's events had many new ideas with a redesigned show ground having a central demonstration area, a public address system to publicise demonstrations and products and a major draw prize. There was also a question and answer forum organised by the region with the Association's Executive Director, Chairman, Editor and Membership Officer in attendance. Despite the publicity for this last item it was disappointing to see so few people attending what could have provided some interesting discussion. Improved afternoon weather helped in the success of the day with thanks as ever to Gordon and Marion Child for their organisation and to everybody in the section who helped in the event's setting up, running on the day and clearing up afterwards.

The annual Greenkeeper/Amateur Tournament was this year held at Erlestoke Sands GC. This enjoyable competition is always well supported with this years being no exception as over 50 people played on the day. Don Southey and his staff worked extremely hard to have the course in excellent condition despite the slowness of the growing season. The course itself provided a good test of golf with most of us returning average

scores. However one or two pairs did come in with the now familiar rugby score! Thanks go to Secretary Mike Pugsley and Erlestoke Sands for allowing us and our guests course courtesy, to Trevor and Pauline Head for an excellent buffet meal and once again to Don and his staff for the time spent preparing the course.

The results are as follows:-1. Jason Cooper (Saltford) and Paul Evans 48 points (back 9); 2. Robin Greaves (Thornbury) and Tim Greaves 48 points; 3. Chris Sealey (Chippenham) and Doug Maddison 45 points (back 9); 4. Anthony Knight (Kingsdown) and Robert Pyaz 45 points; 5. Gary Cook (Enmore Park) and Kevin Budd 43 points.

This year's match against the secretaries will be held on the July 30 at Holsworthy GC. Team Captain Terry Humphery may well have been in contact with you for selection by the time you read this report.

Another reminder that Supervisory and Management Courses are being run by Headquarters between October 7 and November 8. Contact Ken Richardson at Headquarters for more details.

Finally I look forward to seeing you all at the Summer Tournament at Mendip GC on July 25.
Kevin Green

Devon and Cornwall

I start my report this month by wishing Don Hunt of Roffeys a speedy recovery from his sudden illness, Don's commitment to our section has been second to none, we all look forward to seeing Don at our meetings in the very near future.

Congratulations to Michael Bosley of St Enodoc who has been nominated by Cannington College to represent them in this year's Toro/PGA European Tour Student Greenkeeper of the Year. Good luck Michael.

The summer meeting programme is now well under way, unfortunately I was unable to attend the first meeting held recently at Yelverton Golf Club. Our organiser for these meetings Steve Evans reported that the meeting went well. Our thanks to Head Greenkeeper Steve Peters and Yelverton G.C for allowing us use of their facilities. Our next meeting will be held at Woodbury Park Golf & Country Club on Wednesday 17 July, the agenda will be as usual, arrive and meet in the car park at 6.15pm prompt, course walk with host Course Manager Jeff Mills returning to the Clubhouse at approximately 8pm for a bite to eat. If you would like to attend please call Steve Evans on 01208

863647 by Wednesday 10 July.
Richard Whyman

South Coast

Our Summer Golf Meeting will be held at Stoneham Golf Club on Wednesday August 14 1996. The Competition will consist of an 18 Hole Four Ball Better Ball.

Members may bring a guest from their Golf Club or a Greenkeeper Colleague from another Club. The cost of the day will be £11.50 each. All Cheques to be made payable to BIGGA South Coast Section and forwarded along with entry forms stating current handicap to: Mark Webb, 12 Lime Road, Alresford, Hampshire, SO24 9LD, Telephone 01962 733061. The closing date for entries is Monday 5 August.

Once again I must ask all the Trophy holders to make sure the Trophies are on the prize table at the end of the Competition.

Westurf has been and gone again. The re-vamping of the show seemed to have met with every one's approval whom I spoke to. Personally I thought it made a big improvement to the show. The Demonstration Area in the Centre was a great success. A number of the Members of the Trade took full advantage of this facility and this allowed demonstrations of their machinery.

We must not forget Gordon and Marion who do so much for Westurf and all the other regional events. Without them these events would just not happen. So thank you both.

It is very sad that I have to finish on a low note as regards to Westurf. "South Coast Section where were you?" You were very conspicuous by your absence. Walking around the show I could count the numbers of you on my hand, Westurf is the main support of our region and we should support it a lot more than we do. Incidentally I do not consider the weather as a reason for not attending. For those few who do make the effort I thank you for your support.
Ken Lodge

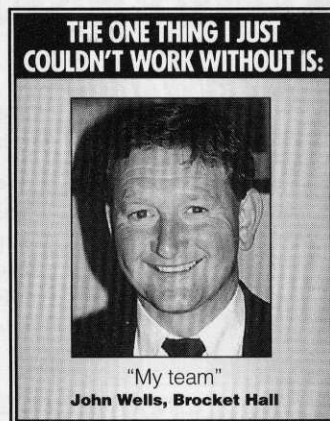

REAL WORLD TEST

Loaders, Diggers, Excavators

GREENKEEPER INTERNATIONAL

Hugh Tilley explores a very necessary market for greenkeepers

Muscle is required for a whole range of tasks on the golf course, from simply filling a top-dresser to constructing greens, handling fertilisers and digging ditches, and nowadays for reasons of time efficiency and/or health and safety this muscle is inevitably provided by tractor loader, excavator or loader/back-hoe.

Many clubs used to keep an elderly (ex-agricultural) tractor with loader, often of dubious reliability, while others had second-hand loader/diggers, however elderly machines can be more liability than asset (and often offend the eye and pride) thus most clubs have replaced them with new purpose designed machines more suited to their tasks. Nevertheless there are still ex-agricultural or ex-construction tractor front loaders and JCBs still in use, but while these may be effective at scooping up sand and loading a trailer or top dresser most greenkeepers see them as cumbersome and too heavy to use for work on the course. Older machines may also be deficient when asked to work hard or lift greater weights, nor are many of them equipped with the 'shuttle gears' or 'quick attach' which makes for faster and easier working, and makes them more versatile.

A quick poll round several local south-west clubs failed to find anyone admitting to having anything except modern and reliable loaders – until further pressed when several greenkeepers admitted to such machines, "retired but useful as a standby", to quote one. One local authority course which previously used industrial loader tractors – passed on by its highways department – has, since winning their contract (under CTT), justified a new loader while for serious digging or excavating such as for drainage or piping in irrigation they now hire.

Perhaps because greenkeepers now see the need for reliable equipment which is cost efficient and justified by the work of the course, most have settled for a compact tractor fitted with a

loader. Where they have a need to excavate or trench, and most do, there are several makes of back-hoe specifically designed for compact tractors. However not all compact tractors are ideal as the base for loader or backhoe so it is worth considering the loader when initially specifying the tractor. Retro-fitting "when the club has the money" may not be a good idea for loaders and back-hoes when their fit to the tractor is so crucial to functionality allow the dealer or manufacturer to sort out any compatibility or fit problems in his yard, in his time and at his expense.

Clubs which are contemplating serious work for a loader or excavator may be best advised to con-

sider purpose made machines. Hire may also be an economic option. It is important to consider the implications before embarking on self-drive hire, implications of health and safety as well as of work rate and job quality. The best and most cost effective choice particularly for drainage or trenching is often to hire digger complete with an experienced operator, even if does not allow "the boys to play with a new toy". It is also important to remember that some operators are more equal than others – ask locally. All greenkeepers in this feature found operating their loaders easy, and some have become very skilled diggers.

Cheapest of all loaders are the

skid steer loaders, but the whole 'skid' concept is alien to greenkeepers. Small wheeled loaders are more expensive but may be justified for their ease of use and high work rate. All wheel steer and all wheel drive offers minimum damage to surfaces, be they grass, gravel or tarmac. Lift height and capacity may be limiting factors with some smaller machines if trying to fill a lorry. Mini excavators are more specialist but may be justified if there is the work for them. Ability to remove loader and/or back-hoe quickly and easily is an ideal more in theory than in practice, few clubs with them ever take them off.

The JCB 2CX at The Belfry

With 200 hectares and three 18 hole courses plus surrounding woods and boundaries The Belfry has a need for a purpose made loader. Selecting the JCB 2CX gave the complex a compact relatively light machine with four wheel drive and four wheel steering. Derek Ganning, course manager, said that this meant low compaction and no 'turf scrub' in turning, and no tracks across fairways – an important factor when



Derek Ganning with his JCB 2CX at The Belfry

REAL WORLD TEST
Loaders, Diggers, Excavators
GREENKEEPER INTERNATIONAL

you run championship courses.

The machine replaced a compact tractor with back-hoe which proved to be inadequate. Derek commented that the loader is used for a wide range of duties on the estate, in particular it has made The Belfry much more efficient on jobs such as path construction, ditching and forming bases for greens and tees. There are also some six miles of ditches to maintain.

As well as the four in one bucket the front loader is equipped with pallet forks which have enabled the machine to unload materials, such as fertiliser bags and 50 gallon tanks of liquid feed. In fact it is the only machine in The Belfry's £2.4 million fleet of machines which can handle this size of unit load. Four wheel steering is particularly effective when working with the forks and in confined spaces. A complete range of bucket was provided for the backhoe, and in addition The Belfry has a grader blade for the machine. Other duties foreseen for the JCB 2CX are snow clearance and sweeping, thus a snow plough blade and brush attachment have been ordered. Derek stated that dealer support, particularly from Dan Conway at Gunn JCB, has been very good and as part of the purchase package he (Dan Conway) arranged for specific members of the greenkeeping staff to trained at the JCB training and demonstration grounds at Ashbourne. This training is seen as having been invaluable. In fact Derek said it is essential that all operators have a certificate of competency under current health and safety law, and no one at The Belfry is allowed to operate the machine without one.

Since having the machine Derek said he is finding more and more work for it, already there is seldom a day when it does not work and it has become such an indispensable part of the estate that, often required to be in two places and do two jobs in the same time that he is considering buying a second.

JCB 801.4 at St Margaret's Golf & Country Club - Dublin

With heavy clay underlying the course St Margaret's has a considerable need for drainage - as a result they elected to buy a 1.4



Lewis Landlord on a Ford New Holland 2120

tonne JCB mini excavator. The course, an 18 hole par 72, is relatively new, and as well as some remedial work there is still some construction to be carried out. In addition the machine has helped to put in the considerable number of trees which have been planted around the course.

The JCB 801.4 is a light and compact excavator which runs on rubber tracks so making a minimum of surface damage. Head greenkeeper at St Margaret's is James Fisher and he reports that he is absolutely delighted with the unit. He has found it easy to use and all eight staff can use it although two have most experience and as a result are the most capable. The machine is now two years old and has 575 hours on its clock, which is not an insignificant number for a machine of this type in this use. Greenkeeper International was told that the machine is a popular machine which is eminently 'borrowable'.

The club has several buckets for the machine, however James said that much of the work is done with the narrow 6" bucket as this makes so little damage. Typical of current usage is an irrigation pipe burst which had been discovered just before Greenkeeper Interna-

tional phoned. Digging down to it took little time and the whole repair was effected in under half an hour. A dozer blade is built into the machine and this simplifies refilling trenches. Another important use for the excavator has been forming bunkers. Maintenance is extremely simple and no reliability or repair problems are reported.

The club also has a larger wheeled loader which is used for materials handling and loading.

Lewis Landlord and Landlugger on a Ford New Holland 2120 at Woodspring Golf & Country Club

This is one of the most common combinations of loader and backhoe to be found on golf courses - Woodspring's unit is mounted on a Ford New Holland 2120 tractor, which says Steve Chappell, course manager, provides ample power without being too heavy. It has been on the course for six months and during that time it has proved totally reliable and its maintenance straightforward.

In giving the reasons for the purchase Steve put 'need' as number one - the course is on heavy blue clay, and there are a lot of materials such as aggregate, top

dressing, earth etc., which have to be handled. Several alternative makes were considered, however Steve has previous good experience with Ford (now called 'New Holland') and this together with the price asked (the machine was part of a 'package') and the support available from the dealer, T H White, clinched the deal.

The tractor has manual transmission and four wheel drive, this latter Steve considers is essential to make most efficient use of available power. In fact, he said, the tractor has never been found lacking in power either when used with the front bucket or when operating the backhoe. Both loader and backhoe are quick to attach and detach although to date this has only been done by the maker when demonstrating at handing over. The club was given a comprehensive induction by dealer T H White and Lewis's representative. Steve said that all his staff except the trainees use the machine, and he rated it as "very user friendly." He considered it important that all his staff could use all machinery on the course as this maximised labour flexibility - and their interest in the job. Ten or 15 minutes was about all the time needed for operators to get used to the digging controls - and several operators have become extremely proficient.

The club has three buckets for the backhoe, nominally 200, 300 and 600 mm wide which covers all their main requirements from trenching to ditch cleaning, while the front loader has a simple 4ft wide bucket. The club expects to purchase a set of pallet forks in the future. Loading is usually into top dresser or tractor trailer and for this lift height has proved to be ample.

The tractor is equipped with turf tyres which gives it the versatility to be used for a range of other duties should this ever be required.

MF 875 loader on MF362 tractor at Peterstone Golf Club in South Wales

Peterstone purchased its tractor and loader as a "good low-hours second-hand" unit from MF dealer Ted Hopkins who is just a few hundred yards down the road. It was available at the right

On-course specialists.



Off-course specialists.



KUBOTA OF COURSE!

For every aspect of course work, it's Kubota of course!

Kubota has got what it takes for the myriad tasks that are involved – with powerful tractors and matched attachments that combine specialist skills with all-round ability.

Like the latest *Grandel* range – three models which offer 33.8, 37.1 and 43.7 DIN hp. Perfect for cutting large areas of grass, but equally at home with heavy (up to 1050kgs) lifting work.

Or the versatile *ST30*. It's the lightest compact in its class and, with Kubota's exclusive Bi-Speed Turn, one of the most manoeuvrable – able to turn within 2m with minimal turf damage.

They are all specialists. But they all have a sound all-round game.

For more information about these or any of the Kubota range for golf courses, complete and post the coupon. We'll send you the full facts as a matter of course...



AD
REF
86

TELEPHONE
THE KUBOTA
HOTLINE ON:
01844
218289

NAME: _____

ADDRESS: _____

POST CODE: _____ TELEPHONE: _____

Kubota

**YOU'RE BETTER
OFF WITH KUBOTA**

GI.7.96

Kubota (UK) Limited, Dormer Road, Thame, Oxfordshire OX9 3UN. Tel: 01844 214500 Fax: 01844 216685

REAL WORLD TEST

Loaders, Diggers, Excavators

GREENKEEPER INTERNATIONAL

price, in the right condition and at the right time, and while, by Philip Bowes's, joint head greenkeeper, own admission, it is a larger, heavier and more powerful unit than is necessary for loading, the tractor is essentially required for operating a hydraulic gang mower which is the club's means of cutting their fairways. This means that 'quick attach' for the loader has to be just that – and it is, normally taking about five minutes to fit or remove. However there is the proviso that there is something solid, such as a steel building stanchion or the wall of the top-dressing bunker into which the loader can be pushed to get it fully bedded onto its attachment points. Philip also said that it was important that hydraulic pressure was released from the lines before attaching or detaching the unit – or all sorts of difficulties can ensue.

The loader requires one single and one double acting hydraulic

service for operation. The arms being operated by single acting rams means that the loader can't be pushed down into the ground, however Philip did not see this as a disadvantage. More important is having a double acting system for crowding and tipping the bucket as this gives complete control of filling and emptying the bucket and this is particularly important when loading Peterstone's Toro Workman topdresser.

Most of the loader work is shifting top dressing, firstly from where it is tipped (lorries can't get in or turn in) into the greenkeeper's compound, and secondly from this bunker to the topdresser. The bucket matches the top dresser well both in terms of its width and capacity, as a result the Bowes have found the most ideal operation is to use the tractor to transport each load in the bucket out to the topdresser. In this way all 18 greens can be dressed in under five hours.

The tractor does not have four wheel drive and Philip does not consider it is required, his feeling is that if 4WD is required then the tractor should not be on the ground. His view is that four wheel drive is an added cost and complication. It has to be added that Peterstone is a very flat and level course.

In the two years the loader has been at Peterstone it has required no repair or maintenance and there have been no oil leaks in either rams or hoses.

Kubota ST30 with LA350ST front loader and KL180 backhoe at Bradford Golf Club

Derek Thackeray at Bradford opted for a 29hp Kubota ST30 with Kubota front loader and backhoe (pictured below), this was bought in January 1994. The ST30 has hydrostatic transmission, has now clocked up about 400 hours, and neither loader nor backhoe are ever removed.

The hydrostatic transmission, Derek says, makes the tractor ideal for front loader work giving it a very fast work cycle, and he quoted the feat of moving 250 tonnes of root zone mix in under two days.

Having both loader and backhoe designed specifically for Kubota is seen as an important guarantee of compatibility as well as providing an assurance of back-up – there is a good local dealer. Bradford use the machine for a variety of purposes but one which occupies it for a considerable amount of its time throughout the year is picking up the grass clippings. The mowers leave these in piles just off tees or greens from whence they are later picked up by the tractor bucket and loaded onto a 3 tonne trailer. The Kubota is (naturally) equipped with grassland tyres and Derek stated that these provide ample grip for most normal use.

The club has a greenkeeping staff of five plus a trainee and all use the Kubota, Derek said the trainee took about half an hour to become proficient.

Asked about its service history, the answer was simply "no problems." In an overall appraisal Derek said he is happy to recommend it to anyone, it was one of the best machines that he has ever bought.

LEWIS



LANDLUGGER 25Q, 35Q, 45Q
Range of Quick fit Loaders
to suit Compact Tractors of
16-45hp approx.

Also available models of backhoes, both
Sideshift and centre pivot

LEWIS EQUIPMENT LTD

Tel: (01789) 773044

Fax: (01789) 490379



NOT QUITE THE
SMOOTHEST FINISH





THE FINEST CUT OF



The only choice on the putting surface. Introducing the Greens King V.

It all starts with the superior cut you expect from Jacobsen. Then it goes a few steps further. Meet the new Jacobsen Greens King V Triplex Greens Mower. Lighter. Quieter. More operator friendly. More serviceable. More versatile (Just pull a pin to change a reel). More productive.

In short, more of everything you need.

Ask your Jacobsen dealer for a demonstration today.



ALL... **JACOBSEN**



**The only choice on the tees and surrounds.
The Tri-King 1900 Series.**



For years, the Jacobsen Tri-King has been the professional's choice for tees and surrounds mowing. The new Tri-King 1900 does the same great job. Only Better. Take a look for yourself at a few of the reasons why. Rapid access 3 piece hood assembly, power steering, automatic 3 wheel drive. Then ask your Jacobsen dealer for a demonstration. You'll find the name over the page.

THE PROFESSIONAL'S CHOICE ON TURF.

T H E J A C O B S E N

D e a l e r N e t w o r k

Abbey Mowers
Corley, West Midlands 01676 542884

B. Skeen (H.M.) Ltd
Billingham, Durham 01642 370160

B.S. Mowers
Bristol, Avon 0117 935 3588

Charnwood and Highmeres
Mountsorrel, Leicester 0116 237 5454

Chelmsford Grass Machinery
Chelmsford, Essex 01245 462264

Cyril Johnston & Co Ltd
Belfast, Northern Ireland 01232 813121

Eastern Garden Machinery
Gorey, Jersey 01534 855466

F.G. Adamson & Son
Swanland, East Yorkshire 01482 631148

Greencare Ltd
Kilcullen, Co. Kildare 00 353 45 481655

Haynes Agricultural (Kent) Ltd
Maidstone, Kent 01622 755726

Henry H. Sheach. Grass Machinery Ltd
Kircaldy, Scotland 01592 652262

Jenman Engineering Services
Southampton, Hants 01703 601528

Keith Morgan Mowers
Usk, South Wales 01873 880244

Medland, Sanders and Twose Ltd
Exeter, Devon 01392 77211

Motrac
Nescliff, Shropshire 01743 741528

Peterborough Garden Machinery
Peterborough, Cambs 01733 268168

Purdys Grass Machinery
Retford, Notts 01777 704275

Risboro' Turf
Aylesbury, Bucks 01844 274127

Ron Smith & Co
Hereford, Worcester 01905 23887

Scats Machinery
Billingshurst, West Sussex 01403 782031

Sharrocks Grass Machinery Division Ltd
Wigan, Lancs 01257 422710
Sandbach, Cheshire 01477 500700

Stanley Pond Ltd
Blandford, Dorset 01258 451221

Thurlow Nunn Standen
Woodbridge, Suffolk 01394 382801



Jacobsen's national parts and service support is widely recognised as the best in the turfcare business. Jacobsen now provides complete sales and service back-up for Gravely groundcare products and the Turfco top dressers.

For further information please call your local dealer.

THE PROFESSIONAL'S CHOICE ON TURF.



Jacobsen House, Telford Way Industrial Estate, Kettering, Northants NN16 8UN.
Tel: 01536 417777 Fax: 01536 310245

The very model of a MODERN APPRENTICESHIP!

Ken Richardson, BIGGA's Education Officer and David Golding, Education Director for the Greenkeepers Training Committee continue to answer the most asked questions on education.

Whom should I contact for more information on N/SVQs on a more local basis?

There are 41 qualified advisers up and down the country (see list) They will be able to identify training needs – whether you need to go to college, require top up training or are fully competent to gain an immediate award.

How does the industry ensure that national standards are maintained?

Both the GTC Centre and the College Centres have to ensure that a quality control structure is in place. Eighteen of the above advisers are also Internal Verifiers and their job is to ensure all assessors assess to national standards. There are now over 300 qualified greenkeeper assessors throughout the country and to identify your nearest assessor you should contact your Internal Verifier.

What are Modern Apprenticeships?

They are the latest Government initiative to ensure quality training for anyone under the age of 25. The scheme is open to new entrants to the greenkeeping profession as well as anyone already working on a golf course.

What is the aim of Modern Apprenticeships?

To raise the standard of the workforce with the goal that those undertaking the Modern Apprenticeship must be capable of achieving NVQ Level 3.

How much would it cost me?

The training may not cost you or your club anything. A 100% train-

ing subsidy is available for those employers in England and Wales who have a modern apprentice accepted on the training scheme. For full information contact the GTC.

What about Scotland?

The Modern Apprenticeship framework has yet to be accepted in Scotland but the GTC hope to contract with Local Enterprise Councils in future so that the framework will be accepted in Scotland.

I thought the Training and Enterprise Councils were controlling Modern Apprenticeships?

They do. The GTC has contracted with one Training and Enterprise Council to offer Modern Apprenticeships to all employers and candidates ensuring that qualified advisors, training, assessment and funding is available.

■ Next month Ken and David will look at how you become an assessor.

LOCATE YOUR NEAREST ADVISER

Scotland

Iain Macleod, Tain GC
Alasdair McLaren, Abernethy GC*
Donald Menzies, Peebles GC*
Stephen Hogg, Drumpellier GC*
Stuart Taylor, Glasgow GC*
Alan Holmes, Blairgowrie GC
Ian MacMillan, Balbirnie Park GC
Paul Murphy, Downfield GC*

Northern England

Brian Story, Silloth-on-Solway GC
Tony Mears, Dinsdale Spa GC*
George Malcolm, Middlesbrough GC
Barrie Gregson, Mottram Hall Hotel*
Anthony Davies, Prestbury GC
David Berry, Bury GC

Howard McAddey
Pat Murphy, Shipley GC*

Midlands

David Walden, Thorpe Wood Golf Course
David Leatherland, Kedleston Park GC

Tony Howorth, Willersley Park GC

Martin Smith, Ramsdale Park Golf Centre*

Robert Lupton, Wolstanton GC*
Peter Woodward, Moor Hall GC
Kim Blake, Fulford Heath GC

Wales

Brian Anderson, Abergele & Pensarn GC*

Michael Williams, The Glamorganshire GC

South West

Richard Whyman, Bude GC
Gordon Child*

Charlie Woolnough, Teignmouth GC

Paul Jenkins, Lilleybrook GC
Kevin Green, Filton GC*

Ivor Scoones, Long Ashton GC
Kerran Daly, Salisbury & South Wilts GC

South East

Peter Jones*

Martin Gunn, Temple GC*
Alan Mitchell, The Hampshire GC

Duncan McGilvray, Letchworth GC

Stewart Boyes, Harpenden GC*
David Wood, Hever GC
Terry Huntley, Ashford Manor GC*

Peter Negus, Willingdon GC*
David Crawford, Royal Jersey GC

* = Also Internal Verifier

**THE ONE THING I JUST
COULDN'T WORK WITHOUT IS:**



"Water"
Paul Tustain, Panshanger GC



All Seasons Dressings

A MEMBER OF THE GREENWOOD GROUP OF COMPANIES

Offering a wide range of:

★ Sands ★ Soils ★ Root Zones ★ Top Dressings ★ Surrey Loams
(Individually prepared and sterilised to your exact specification)

★ Green and Tee Construction ★ Seeds and Fertilisers

Our mixes are prepared and sterilised by our experienced staff at our licensed production plant at Chobham (Lic. No. SOC/128/3641) and delivered by our own transport to ensure reliability.

Should any product fail to satisfy we will remove and replace it free of charge.

OUR REPRESENTATIVE WILL CALL IF REQUIRED.

119 London Road, Kingston upon Thames, Surrey KT2 6NH Tel: 0181 546 3960 • Fax: 0181 547 1923



MAKE TRACK

to BTME 97, the premier showcase for all companies in the fine turf industry. Shaded areas on this plan indicate stand spaces which are booked and 25% deposit has been paid. Join them today - call Louise Lunn on 01347 838581

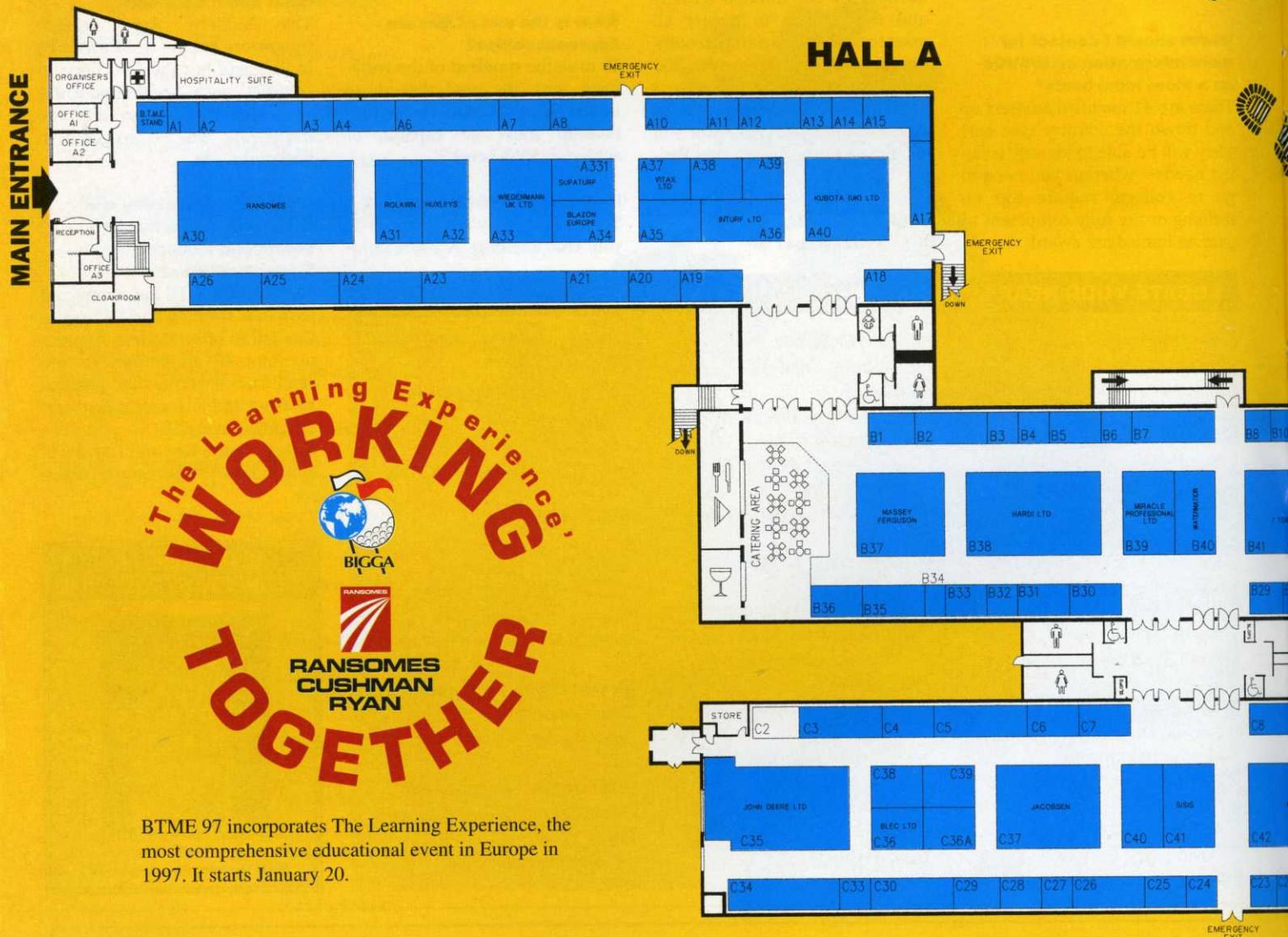

BTME 97 incorporates The Learning Experience, the most comprehensive educational event in Europe in 1997. It starts January 20.

- Aitkens Sportsturf
- Allen Power Equipment Ltd
- Allett Mowers Ltd
- Amenity Land Services Ltd
- Amenity Technology
- Askham Bryan College
- Association of Golf Club Secretaries
- Atterton & Ellis Ltd
- Avoncrop Amenity Products
- Barenbrug UK Ltd
- Better Methods Europe
- British and International Golf
- Greenkeepers Association
- BIGGA Northern Region
- Blazon Europe
- BLEC Ltd
- Boyd Golf Course Accessories
- British Association of Golf Course

- Constructors
- British Institute of Golf Course Architects
- British Overhead Irrigation Ltd
- British Seed Houses Ltd
- C.M.W Equipment Co
- Cannington College
- Charterhouse Turf Machinery Ltd
- Cleveland Sitesafe Ltd
- Cooper Peglar
- Council of European Golf Course Architects
- County Crops Ltd
- Course Care
- D W Tomlin
- E P Barrus
- Eagle Promotions Ltd
- Elmwood College

- Eric Hunter Grinders Ltd
- Etesia S.C.S
- Euromec Ltd
- Fairway Credit
- Farm & Garden Machinery Ltd
- Farmura Ltd
- Fen Turf Dressings
- Fenchurch Insurance
- Fleet (Line Markers) Ltd
- Garfitts International Ltd
- GCSAA
- Gem Professional
- Golf Club Management
- Grass Roots Trading Company
- Greenkeeping Supply Company
- Green Direct
- Green-Tech Ltd
- Greenkeepers Training Committee

- Groundsman Industries
- H. Pattison & Co Ltd
- Hadlow College of Agriculture & Horticulture
- Hardi Ltd
- Hayters Plc
- Headland Amenity Products
- Hepworths Minerals & Chemicals Ltd
- HLD Limited
- Huxleys Grass Machinery Ltd
- Industrial Power Units Ltd
- Institute of Groundsmanship
- Inturf Ltd
- J D Greasley Ltd
- Jacobsen E-Z-Go Textron
- John Deere Ltd
- Johnsons Seeds
- Kawasaki Motors Ltd

CKS

BIGGA TURF MANAGEMENT EXHIBITION



BTME '97

HARROGATE
The Number One Choice

& EDUCATIONAL SEMINAR PROGRAMME

January 22-24, 1997

HALL B

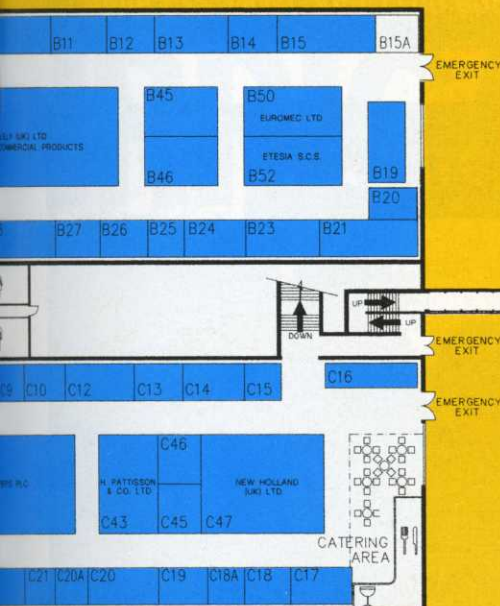

HALL C

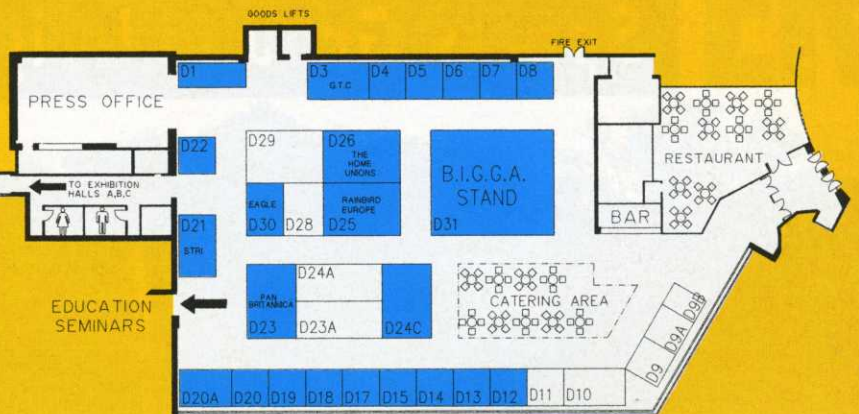

HALL D

Kings Horticulture Ltd
Kubota (UK) Ltd
Lamborghini (UK)
Levington Horticulture Ltd
Lindum Seeded Turf
Links Leisure Ltd
Lloyds & Co Letchworth Ltd
M J Abbott Ltd
Major Equipment Ltd
Marlwood Ltd
Martin Brother (UK) Ltd
Massey Ferguson
Maxicrop International Ltd
Miracle Professional Ltd
Mommersteeg International
Moore Uni Drill Ltd
Myerscough College
Nature First Ltd

New Holland UK Ltd
North West Turf
Ocmis Irrigation Ltd
Pan Britannica
Perryfields Holdings Ltd
Peter Hoare & Company
Petroleum Products and Services Ltd
Prime Waterman Ltd
PSD Agronomy Limited
Ransomes Sims & Jeffries Ltd
Reaseheath College
Rhône Poulenc Environmental Products
Rigby Taylor Limited
Risboro Turf
Ritefeed Ltd
Rolawn Limited
Rufford Topdress Supplies Ltd

Saxon Industries
Scotts UK Ltd
Seward Turf Maintenance
Sharpes International
Shelton Trenching
SISIS Equipment (Macclesfield) Ltd
Sovereign Turf
Sports Ground Irrigation Co
Sports Turf Research Institute
Standard Golf (UK) Ltd
Supaturf Products Ltd
Supreme Mowing Ltd
Symbio
T & G Turf Irrigation
T.I.L. Irrigation Ltd
TACIT
Talbot Farm Landscapes
The Golf Sign Company

The Home Unions
Tilcon Truscupe
Tildenet Ltd
Tonick Watering
Toro Commercial Products/Lely (UK) Ltd
Totrax Ltd
Turf Management
Turf Management Systems
TURF-ACTANT Sales
Turfmech
Undergear Equipment Ltd
Vitax Ltd
Warwickshire College
Watermation Ltd
Welsh College of Horticulture
White Horse Contractors Ltd
Wiedenmann UK Ltd
York & Martin

**Pop-ups lost
their pop?
Valves lost
their verve?
Controller lost
control?**

ALL IS NOT LOST!

**For a realistic and commonsense
solution to your irrigation problems
– or an installation from scratch –
contact us now:**

I.L.S

Irrigation Systems & Equipment
Oundle Road, Luton,
Peterborough PE8 5ND
Phone/Fax: 01832 272450

AD
REF
525

**Complete Water Management Service
For:
IRRIGATION WATER SOURCES
WATER FEATURES**



- Full Water Quality Assessment
- Algal Control
- Non-Invasive Silt Reduction
- Treatment Of Polluting Water Sources

For Any Water Problem
Call: David Ward, Senior Biochemist

Tel: 0181 669 0011 Fax: 0181 773 8449

AD
REF
516

Sports Ground Irrigation Co.



**Enhance your lakes
and water features**

...with the widest range of floating fountains
and aerators now available from:

**SGI Sales, 6 Stuart Road, Market Harborough,
Leicestershire LE16 9PQ**

Tel: 01858 463153 ♦ Fax: 01858 410085

AD
REF
491