

PLAN YOUR ROUTE

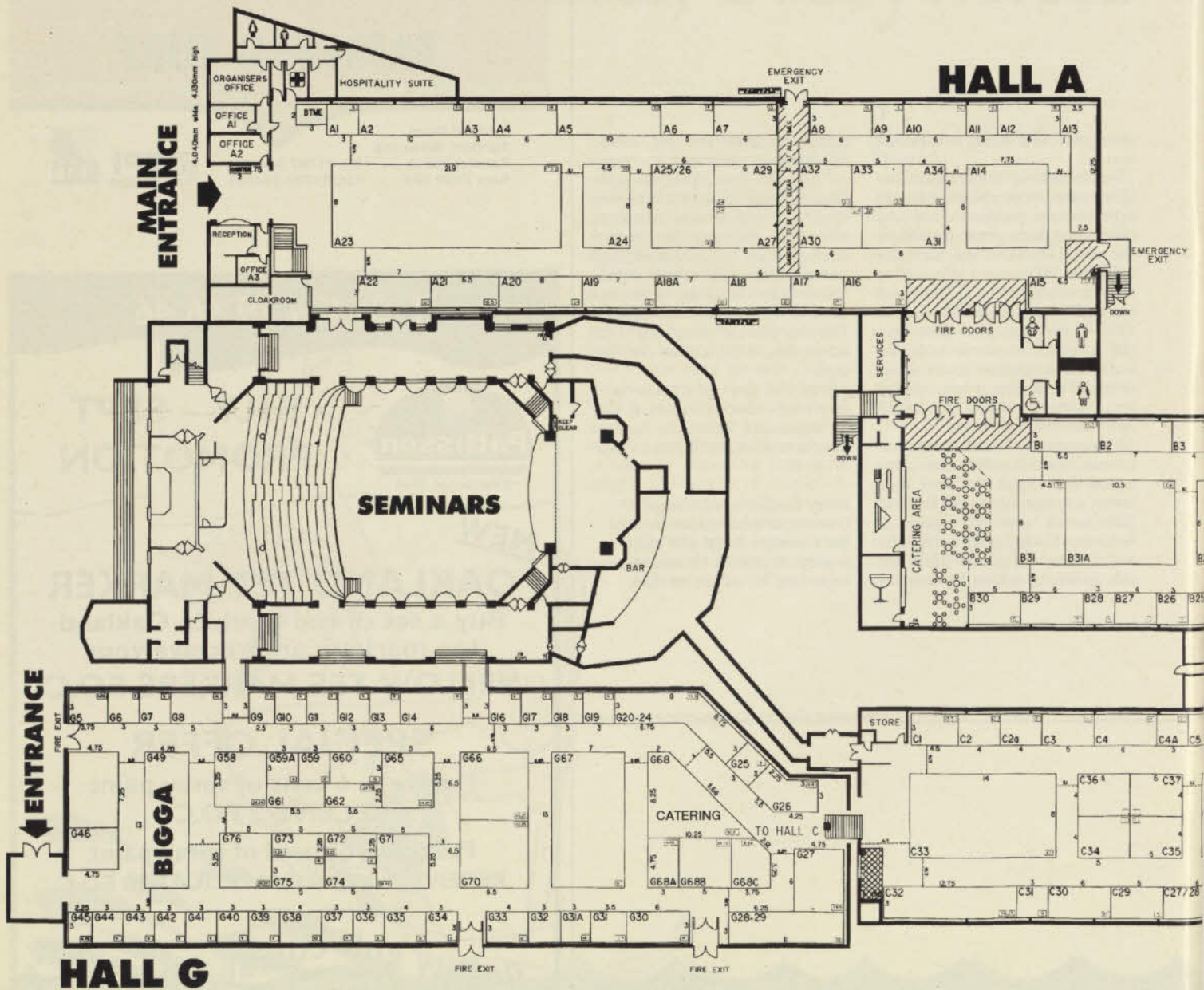

- | | | | | |
|-------------------------------------|---------------------------------|------------------------------|-------------------------------------|---|
| A1 Petroleum Products & Services | A18a Bernhard & Co | B4 Undergear | B27 Prime Waterman | G6 Angus Horticulture |
| A2 Watermation | A19 Eagle Promotions | B5 Lindum Seeded Turf | B28 Better Methods Europe | G7 Complete Weed Control |
| A3 Border Golf | A20 Barenbrug | B7 Avoncrop Amenity | B29 Lloyds & Co | G8 STRI |
| A4 Tower Chemicals | A21 Simon Tullett Machinery | B8 York & Martin | B29 Letchworth Ltd | G9 BIGGA Northern Region |
| A5 Ocmis Irrigation (UK) Ltd | A22 Allen Power Equipment | B9 King's Horticulture Ltd | B30 Standard Golf | G10 British Association of Golf Course Constructors |
| A6 Countax | A23 Textron | B10 North Staffs Irrigation | B31 Huxleys | G11 European Turf Grass Laboratories |
| A7 Sportsground Irrigation | A24 Rolawn (Turf Growers) Ltd | B11 Green Tech | B31a Hardi | G12 Fairway Credit |
| A8 Amenity Land Services | A25-26 Wiedenmann Ltd | B12 Multi-Core Aerators Ltd | B32 Charterhouse Turf Machinery Ltd | G13 Association of Golf Club Secretaries |
| A9 PSD Agronomy | A27 Supaturf Products | B13 Talbot | B33 Scotts Professional Products | G14 Sovereign Turf |
| A10 British Seed Houses Ltd | A29 Marlwood Ltd | B14 Major Equipment Ltd | B35 Toro Commercial Products | G16 Seminar Registration |
| A11 Totrax | A30 Aitkens | B14a Gannon Oils | B36 Toro Irrigation Limited | G17 Golf Course News |
| A12 County Crops Ltd | A31 Inturf Ltd | B15 Hepworths | B38 Amazone | G18 To be confirmed |
| A13 Kubota (UK) Ltd | A32 Vitax Ltd | B16 Groundsman Industries | B39 Par 4 Irrigation Ltd | G19 GCSAA |
| A14 Kubota (UK) Ltd | A33 Risboro Turf | B17-18 Saxon Industries | B40 Bowcom Ltd | G20-24 Amenity Technology |
| A15 Turfmach | A34 Boyd Golf Course Associates | B19 Symbio | C1 Swan Plant Services | G25 Greenkeeping Supply Company |
| A16 Farmura (Environmental) | B1 Tacit | B20 Cleveland Sitesafe Ltd | C2 Fairfield Turf Ltd | G26 Blazon |
| A17 Johnsons Seeds | B2 Rufford Top Dressing | B21 Garfitts | C2a Verde Sports | G27 English Golf Union/Welsh Golf Union |
| A18 British Overhead Irrigation Ltd | B3 M J Abbott | B22 Sharpes International | C3 Mommersteeg International | G28-29 IOG |
| | | B23 Martin Brothers (UK) Ltd | C4 Sub Air Systems (IPU) | G30 Cooper Peglar |
| | | B24 Logic Irrigation | C4a Caprari Pumps | G31 Pro Turf |
| | | B25 Irrigation Control | C5 Perryfield Holdings | G31a Bowley Hinton Associates |
| | | B26 Golf Sign Company | C6 Olivers Seeds Ltd | G32 Garden Master |
| | | | C7 White Horse Contractors | G33 City Irrigation Ltd |
| | | | C8 Wessex Water | G34 Welsh College |
| | | | C9 Headland Amenity Products | G35 Myerscough College |
| | | | C10 Links Leisure | G36 Warwickshire College |
| | | | C11 Green-Relief™ | G37 Hadlow College - S/O |
| | | | C12 Kawasaki Motors (UK) Ltd | G38 Elmwood College |
| | | | C13 Bourne Amenity | G39 Cannington College |
| | | | C14 Tildenet | G40 Reaseheath College |
| | | | C15-16 Coursecare/Wear | G41 Askham Bryan College |
| | | | C17 Banks Amenity | G42 Heron Electric |
| | | | C18 Par Aide UK | G43 G T Group |
| | | | C19 Mitchells | G44 Ultra Plant |
| | | | C20 J D Greasley Ltd | G45 Eamonn Wall & Co |
| | | | C21 Hayter Ltd | G46 GTC |
| | | | C22 Farm & Garden Machinery Ltd | G48 Catering |
| | | | C23 Dennis | G49 BIGGA |
| | | | C24 Nature First Ltd | G58 Pan Britannica Industries |
| | | | C25 Maxicrop International Ltd | G59 L S Systems |
| | | | C26 Hydroscape | G59a E T Breakwell Ltd |
| | | | C27-28 Humate International | G60 Vitagrow Fertilisers Ltd |
| | | | C29 Eric Hunter Grinders | G61 Aligure Products |
| | | | C30 Club Car | G62 Cooper Clarke |
| | | | C31 Tonick Watering | G65 Force Limograin |
| | | | C32 John Deere Ltd | G66 Rhône-Poulenc |
| | | | C33 John Deere Ltd | G67 Rigby Taylor |
| | | | C34 Blec Ltd | G68 Catering |
| | | | C35 D W Tomlin | G68b BT Mobile |
| | | | C36 Boughton Loam | G68c Club House |
| | | | C37 Tarmac | G70 Gem Professional |
| | | | C38 New Holland UK Ltd | G71 Rain Bird |
| | | | C40 Sisis Equipment | G72 British Institute of Golf Course Architects |
| | | | C41 Hayter Ltd | G73 Fargo |
| | | | C42 Pattison | G74 Cargill Plc |
| | | | C43 Etesia UK Ltd | G75 Trelleborg |
| | | | C44 Twose of Tiverton | G76 Amenity Solutions Ltd |
| | | | E1 Eric Hunter Grinders | |

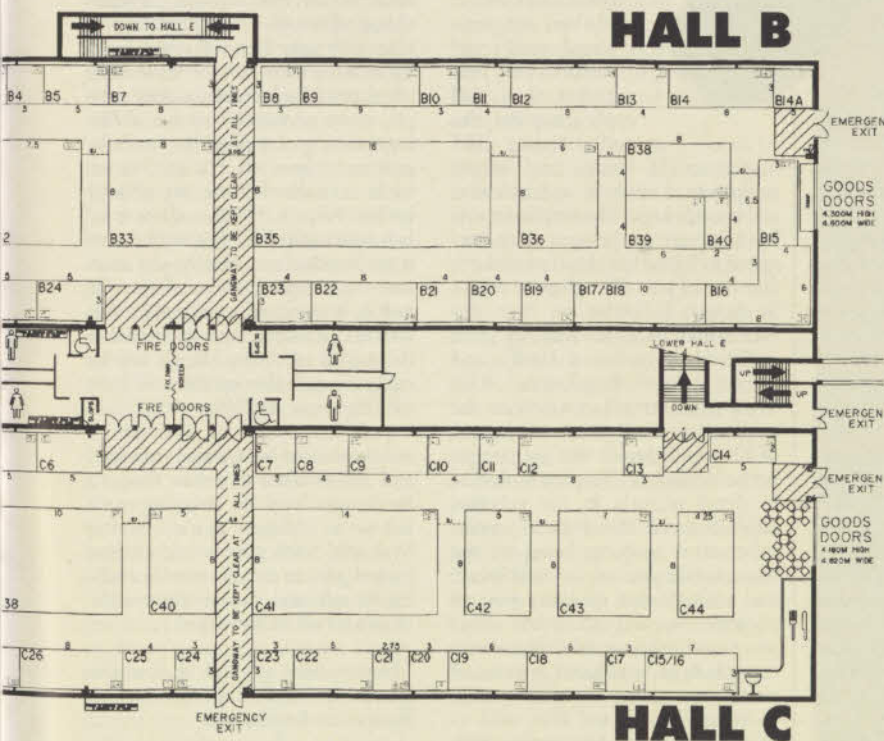
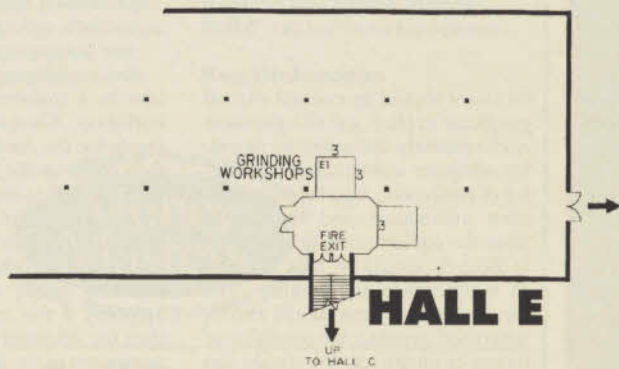

SEE YOU THERE

