

Money Management

IRAs UNDER TAX REFORM

(Prepared by the Michigan Association of Certified Public Accountants)

Contrary to what you may have read over the past few months, the Individual Retirement Account (IRA) is not dead. A bit weaker, perhaps, but alive nonetheless, reports the Michigan Association of CPAs. Last year, Congress took a giant step in an attempt to return the IRA to its original purpose: to provide a personal retirement income fund for lower to middle income Americans who often were not covered by pension plans at work. As a result, the Tax Reform Act of 1986 imposed new restrictions on who is eligible to deduct IRA contributions and just how much may be deducted.

But don't despair. Even if you don't qualify for a deduction (and many people still do), you can still contribute up to \$2,000 to an IRA and earn tax-deferred income. Interest, dividends and capital gains continue to compound tax-free in an IRA until you begin to withdraw from your account. You can use an IRA's tax advantage to the fullest by investing your entire deposit at the beginning of the year. And, of course, the longer you contribute to an Individual Retirement Account, the greater the advantage of tax-sheltered earnings. But keep in mind that the original value of the deduction and the value of the tax-deferred growth will become less valuable as lower tax rates are phased-in.

With all the talk about the demise of the Individual Retirement Account, it's easy to lose sight of the fact that the deductibility of the IRA contribution is only one of the two important tax benefits an IRA offers. Even under tax reform, many experts feel the IRA remains a good long-term investment.

WHO GETS THE DEDUCTION?
Two factors determine whether

you still qualify for an IRA deduction and how much you can deduct. The first "test" is whether you or your spouse is covered by a retirement plan at work and the second factor is your adjusted gross income. If neither you nor your spouse are considered active participants in a retirement plan at work for any part of the taxable year, the rules remain the same. You can continue to contribute and deduct up to the lesser of \$2,000 a year or 100 percent of compensation (\$2,250 for a spousal IRA and \$4,000 if each spouse earns at least \$2,000 and makes the maximum \$2,000 contribution).

If you or your spouse is covered by a retirement plan, you may still contribute to an IRA, but the amount of your contribution that you may deduct depends on your adjusted gross income. If you are single and your adjusted gross income is \$25,000 or less, you may continue to deduct up to the lesser of \$2,000 or 100 percent of compensation for an IRA, even if you are covered by a pension plan at work. Likewise, if you are married and your joint adjusted gross income is \$40,000 or less, you can continue to deduct up to \$4,000, if you both work and each earns at least \$2,000. Incidentally, your adjusted gross income must be figured before subtracting an IRA deposit.

There is no deduction allowed for an IRA contribution if you are covered by a company plan and have an adjusted gross income of \$35,000 or more if single, and \$50,000 or more if married and filing jointly. This limit applies even if only one spouse is covered by a pension plan.

Single taxpayers with adjusted gross incomes between \$25,000 and \$35,000 and married couples with adjusted gross incomes between \$40,000 and \$50,000, may partially deduct IRA contributions. The rule is that for every \$1,000 in income over the ceilings of \$25,000 or \$40,000, you lose \$200 in deductions. So if you're single and have an adjusted gross

income of \$30,000 and make a \$2,000 IRA contribution, \$1,000 worth of your IRA contribution may not be deducted.

For those who cannot take the deduction, an IRA contribution may still make sense because of its potential for tax-deferred growth. Active participants in employer-sponsored plans, who are not eligible to make deductible contributions, may make non-deductible contributions to an IRA. The maximum allowable contribution to an IRA is the same for both non-deductible and deductible contributions. Although you miss out on the deduction, you can still enjoy the benefit of tax-deferred earnings.

WITHDRAWALS FROM IRA
Most of the old rules governing IRA withdrawals remain intact. Because IRA tax breaks are designed to encourage you to save for retirement, unless you are permanently disabled, any withdrawal of IRA money before age 59½ is subject to a 10 percent penalty tax in addition to the tax due. As was previously the case, you must begin making withdrawals from your IRA no later than April 1, of the year following the year in which you reach 70½.

If you suspect that the change in the rules for putting money into an IRA might affect the rules for taking it out, you're exactly right. The Tax Reform Act of 1986 complicates the way your IRA savings are taxed when you withdraw your money. Before, all withdrawals from an IRA were taxed as ordinary income. Clean and simple. That remains the case for funds attributable to deductible contributions and all accumulated earnings, but non-deductible contributions made after the Tax Reform Act of 1986 will not be taxed again. You do not have the option of first withdrawing the non-taxable money in your account based on

the total of deductible contributions and all accumulated earnings. Each time you withdraw funds, a certain portion may be taxed and the rest may be tax-free. It is up to you to add up everything you have in your IRA and then determine what percentage of your withdrawal is taxable. You'll need to keep track of what portion of your total contributions was deductible and what portion was not. Depending on your contributions and earnings, the percentage will change from year to year.

While IRAs have increased the likelihood of a financially secure retirement for countless Americans, CPAs advise you to consider the deductibility, tax-deferred status and withdrawal requirements of Individual Retirement Accounts, as well as the possibility of alternate tax-deferred or tax-free investments that may give you a better or equivalent yield, before making an investment decision.

Farmers - Apply For Refund

The Department of energy has received only about 1,800

applications for agricultural oil overcharge refunds, a small number according to Michigan Farm Bureau Information Director Mike Kovacic, compared to the amount of farmers who may be eligible.

"It doesn't cost a farmer anything to apply for a refund for oil overcharges that occurred between August of 1973 and January of 1981," Kovacic said. "All they have to do is estimate how much diesel fuel, kerosene, motor oil, heating oil, propane or grease they purchased from independent suppliers during that period, and they could get \$8 for every 10,000 gallons of fuel used."

Kovacic said the amount of refund will vary with the type and size of farms. "Because petroleum demands differ based on the crops grown, the number of acres farmed is not the only factor. For example, it takes about 10 gallons per acre per year to produce a wheat crop compared to about 127.5 gallons per acre per year to raise apples." Farmers can get refund application forms from their local county Farm Bureau office.

"All is for the best in the best of all possible worlds."
Voltaire

BACK DOOR PARTY STORE
500 Ann Arbor Street Phone 313-428-8287 Manchester, Michigan

BEER WINE KEG BEER

GROCERIES

Now At Back Door Party Store

MICHIGAN LOTTO

Instant and Daily Lottery Tickets

UNION 76 GAS Full Service and Self Serve

THE MANCHESTER ENTERPRISE

25¢ COPY

120TH YEAR VOLUME NUMBER 46

USPS NO. 327-460

THURSDAY, SEPTEMBER 3, 1987

Manchester Community Fair 1987 Queen



Cheryl Kempher was selected by a panel of judges to reign as the Manchester Fair Queen. Cheryl is a senior at Manchester High School and is the daughter of Mr. and Mrs. Walter Kempher.

Michigan Has Her Mountains

Manchester Enterprise
October 15, 1925

Little Visited Spot, Rich In Scenic Beauty Is Worthy A Place As State Park

Very few people have any idea of what the state of Michigan possesses in the way of mountain scenery. Most of them will laugh at you when you hint that there is a hill anywhere in the peninsular state that will outtop the Irish Hills, south of Manchester.

Some of our residents, notably Ed. E. Root and A.J. Waters, have roamed all over the southern peninsula and have heard their engines knock sometimes when driving up an unusually large mole-hill. Some have stopped their cars at the top and viewed the country round about and come home and told the neighbors what they saw near Newago, Gaylord or Somers.

Occasionally one has ventured

Early Deadline!

Due to the Labor Day holiday on Monday, September 7th, The Manchester Enterprise will have early deadlines for all news items and advertising.

All pictures and display advertising must be in by 5:00 p.m. Friday, September 4th.

All classified ads and news articles must be in by 10:00 a.m. Tuesday, September 8th.

up to the Soo or to Marquette, but they had more to say about woods and lakes than anything else. So let us say, that if you want to see a mountain in Michigan you must visit Porcupine Mountain, in the copper range of Ontonagon county. "There is no area like it, nor such virgin forest and rugged picturesque topography between the forests of northern Minnesota and the Appalachian ridges," said a state park secretary.

Government Peak, where a state fire observation tower is located, looms up 1,250 feet above Lake Superior and 1,850 feet above sea level. But there are higher peaks not far away that top any between the Black Hills and the Alleghenies.

Some of our readers have been charmed with the lakes in the Adirondack Mountains in New York, or the lakes in the White Mountains in New Hampshire, little dreaming that in "Michigan my Michigan" they might behold Carp Lake and Little Carp lake in the Porcupine range, not only a counterpart of these, but surely their superiors. They are like blue gems set down among the green mountains, with Lake Superior curving around at their feet. R.H. Torrey has his eye upon that wonderful region and we may expect the state to locate a park there before many years roll around, with one of those northern Michigan roads leading to it.

Hit or Miss

By A Farley

As much as I hate to admit it, this is the last HIT or MISS to be published. My grandpa, H.H. Farley, passed away August 26th and one of his last requests of me

was to write his last column. Compared to my grandpa, my be as good so I hope you will bear with me.

First I would like to thank the many people that read his column over the years. Because of HIT or MISS my grandpa could go through his final years with dignity and grace.

My grandpa always held a special place in his heart for Manchester and it's special after I always felt like I'd missed something when he told me about the good old days. When he would hear someone start to talk poorly about small towns, grandpa would always defend them. He always said that a small town was like a big family and

big towns were where the little guy always got lost.

My grandpa's life was something most of us can only wish for. He had a long full life of happiness with his family and friends but more than anything he was a newspaper man and he said he never could have made it without his partner and love, my grandma.

He is gone now and is in a much better place than the rest of us people. During my childhood and because of towns like Manchester and Clinton, the memory of Hollis and Isadora Farley will remain and mean something.

The Farley family left behind love and misses you both.
Della A. (Farley) Ford

Grand Champion Steer and Lamb Purchased By IGA



The Grand Champion Steer was purchased by the Manchester IGA, a division of Walco Foods. Pictured is Fair Queen Cheryl Kempher, Store Manager Jim Priest and Bryan Strahle, whose steer won the championship.



The Manchester IGA also purchased the Grand Champion Lamb raised by Lisa Lozier, pictured far right.

Confused by NEW tax laws? Learn about them from H&R Block.

America's Finest Income Tax Course
Learning income taxes now could offer you money-making opportunities and save you money on your return at tax time.

Enroll today! Classes start Monday

H&R BLOCK

Solve The New Tax Law Mysteries. Enroll in H&R Block's 1987 Tax Law Course!

Interested in learning which tax laws change and which will remain the same in 1987? Want to gain some tools for dealing more effectively with new rules and regulations?

Enroll in the H&R Block Income Tax Course. Learn how to cope with the tax law changes and use them to your advantage. Find out how you can save money on your taxes during 1987.

The 13-week basic course starts on August 31. Course work covers all aspects of tax preparation including the changes in tax laws affecting 1987 returns. Experienced Block instructors will teach tax law, theory, and application. In addition, you receive hands-on experience in preparing individual returns.

Qualified course graduates may be offered job interviews for positions with Block. However, Block is under no obligation to offer employment, nor are graduates under any obligation to accept employment with H&R Block.

One low fee includes all materials, supplies, and textbooks. Successful course graduates receive a Certificate of Achievement and 7.5 continuing education units.

Contact the H&R Block office at Tecumseh, call 517-423-7497 for more information and a registration form, Monday through Friday 10-3.

FORD MIDWEST FORD, INC.
NOW UNDER NEW OWNERSHIP

"Guarantee of \$100 Savings or FREE 100 Gallons of Gasoline," If we can't beat your best deal on a new Ford product.

• Register for Drawing: FREE Mini Indy Car

1986 Escort GT

NEW CARS AND TRUCKS

| | | | |
|--------------------------------|--------|----------------------------|--------|
| '85 Ford LTD Brougham..... | \$6488 | '83 (2) Ford T-Birds..... | \$4988 |
| '85 Tempo GL..... | \$4488 | '83 Escort Wagon..... | \$2988 |
| '85 Escort..... | \$4388 | TRUCKS | |
| '84 Ford T-Bird..... | \$5988 | '87 Ford Ranger..... | \$7988 |
| '84 Tempo GL..... | \$3688 | '86 Ford F-150 Pickup..... | \$8988 |
| '84 Mercury Topaz..... | \$3688 | '85 Ford F-150 Pickup..... | \$6988 |
| '83 Mercury Grand Marquis..... | \$5488 | '85 Ford Ranger..... | \$5488 |

50 Others In Stock!!!

Selling Hours: Monday-Friday 8 am-8 pm Saturday 8 am-6 pm

FORD MIDWEST FORD, INC.

510 W. Main Street
Manchester, Mich.

(313) 428-8343

See Us For Your Next Ford!

• We service what we sell
• Free loaner cars for service
• We will pay for your drive!
• Shop us last, bring your best deal!

The Manchester Enterprise
 150 East Main Street Phone 428-8173 Manchester, MI 48158
 USPS 327-460

The Manchester Enterprise was established in 1867 and is published each Thursday at 150 East Main Street, Manchester, Michigan, with second class postage paid at Manchester, Edward E. Steele, Publisher, Lenora A. Steele, Editor

POSTMASTER:
 Send Form 3972 to The Manchester Enterprise, 150 East Main Street, Manchester, Michigan 48158.

DEADLINES:
 All Display Advertising AND Pictures (Black and White Only) Are Due By 5:00 P.M. Every Monday For Same Week Publication.
 All Classified Advertising And News Articles Are Due By 11:00 A.M. Every Tuesday For Same Week Publication.

Obituaries

Elwin P. Benedict
 811 City Road
 Manchester

Age 63, died Thursday, August 27, 1987, at St. Joseph Mercy Hospital in Ann Arbor. He was born February 11, 1924, in Manchester the son of Bernard and Edith Stautz Benedict. He married Maxine Keezer on June 9, 1951, and she survives. He had been an employee of the Ford Motor Co. for 38 years retiring in 1980.

Mr. Benedict was a member of St. Mary's Catholic Church, a Past Grand Knight of the K of C's and an Army veteran of WWII.

In addition to his wife, he is survived by 4 sons, Larry (Betty), Charles, David all of Manchester, Garry (Kathy) of Cincinnati, Ohio, 1 daughter Teresa Benedict of Dallas, Texas, 4 grandchildren Jennifer, Christopher, Lyndsay and Daniel, 2 sisters Helen Meyer and Leona Braun both of Manchester. He was preceded in death by a brother Allen (Spike) in 1981.

Mass of the Christian burial was held Saturday, August 29,

1987, at St. Mary's Church. Rev. Father Raymond Schlinkert officiated. Burial followed in St. Mary's Cemetery.

Walter M. Lamb
 Howell

Age 63, formerly of Manchester, died Thursday, August 27, 1987, at the Greenbriar Care Center. He was born March 27, 1924, in Kenton, Ohio, the son of Earl and Lydia Moore Lamb. He was an army veteran of WWII.

Mr. Lamb is survived by 1 son Walter Lamb, Jr. of Brooklyn, 4 daughters, Sandra Britton of Ann Arbor, Pamela Lee of Manchester, Angela Conn of Linden, Elizabeth Clouse of Manchester, 17 grandchildren, 3 great-grandchildren, a twin brother Wilbur Lamb of Brooklyn, and 1 sister Thelma Montgomery of Kenton, Ohio. He was preceded in death by a sister Juanita Fink.

Funeral services were held Sunday, August 30, 1987, at the Jenter Funeral Home. Rev. Robert Macfarlane officiated. Burial followed in Fairview Cemetery in Jumbo, Ohio.

Myrtle Sargenti
 Amesville, Ohio
 Formerly of Manchester

Age 81, died August 11, 1987, at O'Bleness Memorial Hospital in Athens after a brief illness.

Born in the Poston area, she was the daughter of the late Joseph and Sadie Holdercroft Young.

Mrs. Sargenti taught in the Manchester Schools (rural and later consolidated), during the 1930's and 1940's. While in Manchester she lived with Mr. and Mrs. C.W. Lamming.

She is survived by her husband Anthony J.; five sisters; and a brother.

Funeral services were held August 13, 1987, in Athens.



Hollis Farley
 Clinton, Michigan

Services for Hollis Farley were held Friday, August 28, 1987, at the Couture-Stark-Proctor Funeral Home in Clinton.

Mr. Farley of West Michigan Avenue, died August 26, 1987, at Herrick Hospital in Tecumseh. He was 83.

He was born in Jackson, November 17, 1903, to George and

Wacker's General Store
 Beer, Wine and Package Liquor
 Budweiser, Bud Light Miller, Miller Lite Miller Draft
 24 Pack Strohs—30 Pack
\$9.99
 Plus Deposit & Tax
G.E. Wacker Inc
 Gasoline-Fuel Oil-Grease Motor Oil-Diesel Fuel
 9050 Chelsea-Manchester Road
 Manchester, Mich. 48158
 SUMMER HOURS:
 Monday-Friday 7 am-9 pm
 Saturday 8 am-9 pm
 Sunday 9 am-9 pm

Engagement Announced

Idyl Farley. On August 22, 1926, he married Isadora Taylor of Jackson, and she died January 28, 1980.

Mr. Farley had been a resident of Clinton since 1946 when he purchased The Clinton Local. He and his wife published the newspaper until his retirement in 1976. He was a member of the Clinton Chamber of Commerce and had served on the Smith-Kimball Community Center Board for 17 years, including several terms as president of the board.

Mr. Farley began his newspaper career in 1926 when he and his wife purchased a newspaper in Onsted. After a brief stint operating a newspaper in Chicago in 1927, he returned to Tecumseh and was employed by The Tecumseh Herald until 1928, when he purchased The Manchester Enterprise and published it for 17 years.

Survivors include a daughter, Mrs. Jean Ford of Clinton; two granddaughters, Della Ford of Clinton and Mrs. Bruce (Darcy) Price of Midland; and two great-grandchildren.

The Rev. Jack Warner officiated at the service and burial followed in Riverside Cemetery, Clinton.



Mr. and Mrs. William Riley of Manchester are proud to announce the engagement of their daughter Kari Lynne to Mark Andrew Ball, son of Mr. and Mrs. Leon Ball also of Manchester.

Kari will graduate from Eastern Michigan University in December with a degree in Marketing and Advertising. Mark will graduate also from Eastern with a degree in Secondary Education in April of '88.

A May 6th wedding is planned.

JON HARDENBERG'S
 Photo and Record Shop
 428-9509
 120 East Main Street

Quality Film Processing
 Camera Accessories
 Copy Work
 Old Print Restoration
 Good Film Prices

Music Albums & Tapes
 Blank Audio and Video Tapes
 Buy or Rent "How To..." Videos

TUESDAY SPECIAL DOUBLE PRINTS AT NO EXTRA COST

FEATURING:
 BONNIE GREENWALD POTTERY

Sutton Agency, Inc.
 136 East Main Street
 Phone 313-428-9737
 Manchester

AGENTS:

Donald K. Sutton
Connie Widmayer
Kathryn Martin
Mary Knapp
Susan Mann

Phone Answered 24 Hours
 Monday-Tuesday-Wednesday-Friday 9-12:30 and 1-4:30 p.m.
 Thursday 9 a.m.-12 Noon

Auto-Owners Insurance
Hastings Mutual Insurance Company

1987 Lamb Club Buyers

| LAMB CLUB MEMBER | PRICE PER LB. | BUYER |
|------------------------------|---------------|----------------------------|
| GRAND CHAMPION - Lisa Lozier | \$4.75 | Manchester IGA |
| RESERVE CHAMPION - Ann Fahey | \$3.75 | Johnson Controls |
| Brad Macomber | \$2.50 | Koebbe Welding |
| Adam Erskin | \$1.75 | Diuble Feeds, Inc. |
| Adam Erskin | \$1.75 | Manchester Car Wash |
| Lisa Lozier | \$1.50 | McCalla Feeds |
| Sean Lowery | \$1.75 | Manchester Stamping |
| Brad Macomber | \$1.75 | K&W Equipment, Inc. |
| Melissa Steele | \$1.75 | Tirb Chevrolet |
| Drew Vassoff | \$1.50 | P. Lamont Okey, MD |
| Brian Ball | \$2.50 | Kemner Brothers |
| Valerie Haeussler | \$1.50 | Pinnacle Engineering Co. |
| Valerie Haeussler | \$1.50 | Atlas Feed & Grain Co. |
| Brian Ball | \$1.50 | Fahey Realty |
| Drew Vassoff | \$1.50 | Tom Lavender |
| Melissa Steele | \$2.00 | The Flower Garden |
| Joanne Kemner | \$2.00 | Johnson Controls |
| Bryan Hoef | \$2.25 | Manchester Chiropractic |
| Bryan Hoef | \$2.25 | Marti's Top Drawer Apparel |
| Angela Davis | \$1.75 | Kleinschmidt True Value |
| Ann Fahey | \$1.50 | Dave Kirk Excavating |
| Marcus Stockwell | \$1.75 | Back Door Party Store |
| Marcus Stockwell | \$2.00 | The Flower Garden |
| Joanne Kemner | \$1.50 | First of America |
| Kim Davis | \$1.50 | Pinnacle Engineering Co. |
| Daniel Bihlmeyer | \$1.75 | Gross Farm Equipment Co. |
| Daniel Bihlmeyer | \$2.00 | E.G. Mann & Sons Elevators |
| Kim Davis | \$2.00 | Manchester Stamping Corp. |
| Stephan Alber | \$2.00 | Schnearle Farms |
| Jodi Macomber | \$2.00 | Larry Becktel Insurance |
| Stephan Alber | \$2.75 | Wolverine Food & Spirits |



The Reserve Grand Champion Lamb, raised by Ann Fahey, was purchased by Johnson Controls.

OPINION POLL

Recently the Village Council announced that they wanted to use \$200,000 of the bond issue passed last December (this was a \$500,000 bond for water and sewer systems improvements) for the Industrial Park Site. The monies would be used to extend the existing water and sewer lines to the property located north of Johnson Controls.

In light of our problems with the system today, the question arises - would this money be better spent improving the existing facilities?

The input of the community is an important consideration. Write or call the Village Mayor, John Hinkley, or one of the Council members. Council members are Larry Becktel, Ted Tapping, Terry Harris, Don Limpert, Joe Marshall and Wendall Reinhart.

SHOW YOUR COLORS ON LABOR DAY
 U.S. Flags: 2x3, 4x6, 5x8 custom flags on order

FOX TENT AND AWNING CO.
 617 S. ASHLEY ANN ARBOR

665-9126

Hutton
Thomas A. Gorney
 Financial Consultant
 313-428-8796
 517-263-8570

IF I WERE A RICH MAN...

Just a small investment of time now, may yield future income and opportunities for you.

The difference in lifetime income between a high school graduate and a dropout is estimated at about \$100,000.

If you can afford at least one night per week (no money is required), you can get started this year on your high school diploma. Contact

you can

Chelsea-Manchester Community Education
 475-9830 or 428-7804

MANCHESTER CHIROPRACTIC CLINIC
 "TRY CHIROPRACTIC NATURALLY"

STAN GILBERT, D.C. 227 E Main St.
 313-428-7207 Manchester, Michigan

APPOINTMENT HOURS
 Monday, Tuesday, Wednesday, Friday 8 am-12 and 3 pm-7 pm.
 Thursday and Saturday 8 am-12 noon

FILLYAW' MARATHON SERVICE
 327 West Main St. Manchester, Mich.
 Phone 428-8576
 Monday-Saturday 7 am-7 pm

24 Hour Wrecker Service

STOP IN AND SEE ME FOR YOUR BEST TIRE DEAL!

GOODYEAR

WE NOW HAVE SUPER "M" LEAD FREE GASOLINE

FULL LINE OF MARATHON PRODUCTS

MARATHON

REPAIR YOUR DAMAGED WINDSHIELD FOR A FRACTION OF REPLACEMENT COST.

Most windshield breaks are repairable, and the cost is far lower than windshield replacement. The patented, proven Novus method can restore and repair windshields both structurally and optically, leaving damaged areas almost invisible. But act now! If crack damage spreads too far, it may become necessary to replace the entire windshield.

We come to you... Mobile Service Anywhere in Washtenaw County. MOST INSURANCE COMPANIES WILL PAY 100% OF REPAIR COST.

WAYNE'S WINDSHIELD REPAIR
 — 428-7028 —

Wedding Bells Ring

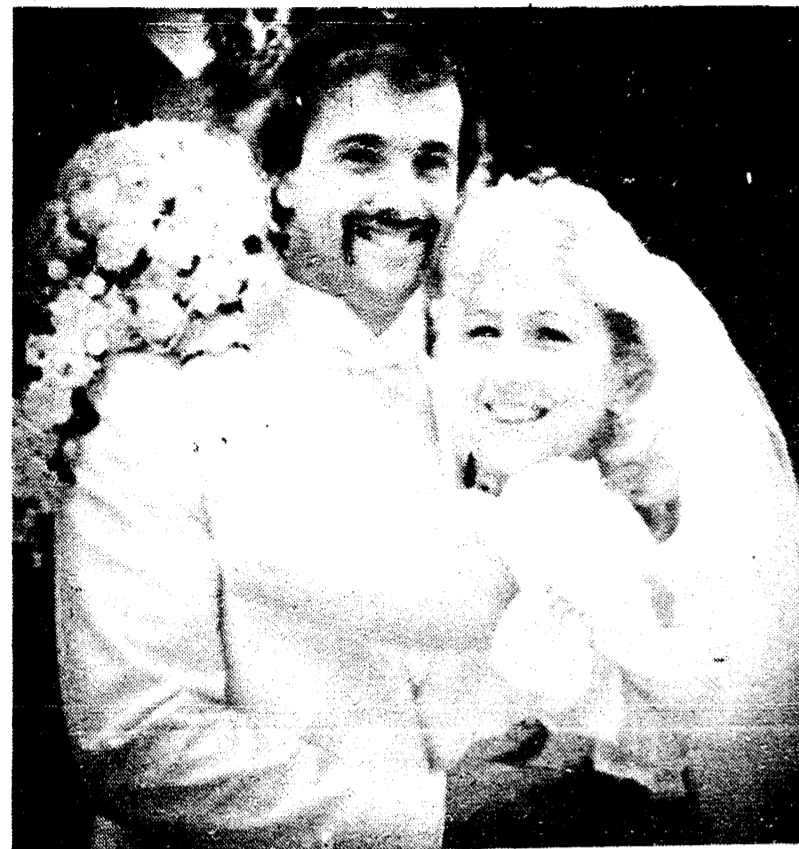

ruffles and carried pink and white roses with baby's breath and strings of pearl beads.

Terry and Joe Walkowe, brothers of the groom, Mark Walkowe of Durham, North Carolina, cousin of the groom, Tim Sannes, Uncle of the bride and Harry Hadley of Clarklake seated the guests while Adam Chmielewski of Grass Lake, cousin of the bride, carried the rings.

Immediately following the ceremony a reception was held at the American Legion Hall in Manchester.

Parents of the bride and groom are Mr. and Mrs. James Thelen of Manchester, Mr. and Mrs. Howard Stoll of Grass Lake, Mrs. Joan Walkowe and the late Joseph Walkowe of Manchester.

The newly-weds are residing in Manchester.

Bicycle Contest Winners

Winners in the Manchester Fair Parade bicycle decorating contest were: 1. Michelle Mann; 2. William Roberts; 3. Jacob Klein; 4. Zachery Majess; 5. Greg Mitchell; 6. Justin & Justin; 7. Catrina Bihlmeyer; 8. Lizzy Steele. Cash prizes were donated by the Manchester Tool & Die.

An afternoon ceremony at St. Mary's Catholic Church united Debra Ann Thelen and Patrick James Walkowe in marriage.

The Rev. Father Raymond Schlinkoff officiated at the August 1, service.

The bridal gown was fashioned in white summer taffeta with off the shoulder ruffles, applied bodice and chapel length train. The mid-calf length veil featured embroidery and pearl beads. Pink and white roses, baby's breath and a cascade of flowers and strings of pearl beads composed the bouquet carried by the bride. Attendants were Michaela dresses with off the shoulder

Hadley of Clarklake, matron of honor, and William J. Walkowe, brother of the groom, best man.

Bridesmaids included: Danielle Thelen of Grass Lake, sister of the bride, Stacey Walkowe, sister of the groom, Pamela Chavey of Tecumseh, cousin of the bride, Michelle Sannes, cousin of the bride and Michelle Walkowe, cousin of the groom. Sharon Stall of Grass Lake, sister of the bride and Kristie Sannes, a cousin of the bride were junior bridesmaids.

The matron of honor and the bridesmaids wore floor length teal dresses with off the shoulder

Cameras In Courtroom Approved

The Michigan Supreme Court has approved an order to permit cameras and recording equipment in Michigan courtrooms on a one-year trial basis.

Chief Justice Dorothy Comstock Riley announced the Court's action at the 30th annual Michigan Judicial Conference being held at Shanty Creek Conference Center near Bellaire.

With more than 200 trial and appeals court judges in the audience, Riley said that the state's highest court has approved an order permitting television, radio and photographic coverage of most proceedings in the state's 241 trial courts, the Court of Appeals and the Supreme Court starting next February 1.

Michigan will become the 24th state to permit electronic and photographic coverage in all of its courts.

As of last January 1, a total of 43 states permitted some form of electronic or photographic coverage of courts, according to the National Center for State Courts, but nearly half of them have restrictions limiting coverage to certain courts or types of trials.

The Michigan Supreme Court

took up the issue of cameras in the courtroom earlier this year after it received a recommendation from the Citizens' Commission to Improve Michigan Courts urging approval of a pilot program to permit cameras in the courtroom. Earlier, the State Bar Representative Assembly recommended a one-year experiment of electronic coverage of trial courts and TV coverage of appellate courts.

\$500 Reward For Information

The Washtenaw County Sheriff's Department is offering a five hundred dollar (\$500) reward for information leading to the arrest and conviction of the person or persons responsible for the murder of Carolyn Tooson. Ms. Tooson's body was found in the Huron River in Scio Township last April.

Anyone with information is requested to contact Detective Joe Hall or Detective William Kennon at 971-7185, or contact the Sheriff's Department Confidential Tip Line at 973-7711.



1987 Fair Parade Color Guards



Pony Pull



Girl Scouts Float



Compact Tractor Pull



Fair Parade Grand Marshals, Governor and Mrs. John Swainson.



Senior Class Parade Float

1987 Manchester Community Fair Parade Highlights

SAVE ONE PER CHECK

THERE'S NO PER-CHECK CHARGE AT GREAT LAKES

Your bank may be charging you as much as 25¢ for every check you write. Don't get mad. Get a Great Lakes Bancorp checking account.

When you bank with Great Lakes, there's no per-check charge, ever, and you'll earn daily interest on every dollar.

Plus, there are four ways to avoid a monthly service charge:

- Keep \$250 or more in your account
- Over 60 years of age
- Have automatic payroll deposit
- Have your Great Lakes mortgage payment automatically deducted

Before you pay another per-check charge, call us at 1-800-DIAL-453. One call can close your old account and open a new one with us. And at these prices, the savings really add up.



111 E. Main St., Manchester, 428-8379
401 E. Liberty St., Ann Arbor*, 769-8300
2400 Huron Pkwy., Ann Arbor*, 973-7811
2701 Plymouth Rd., Ann Arbor*, 769-7818

125 Briarwood Circle, Ann Arbor*, 769-7616
1900 Pauline Blvd., Ann Arbor*, 769-8386
1135 S. Main, Chelsea*, 475-1341

*Locations with GL-24 Centers for 24-hour banking convenience. †Saturday drive-up service, 9 a.m. - noon.

NOTICE Manchester Township Residents

A copy of the Local Unit Fiscal Report F-65 for 1986-87 is available for public inspection at the Township Office, 275 South Macomb Street, Manchester, Michigan.

Wilma E. Lentz, Clerk

ADVERTISEMENT FOR BIDS

Manchester School District will be accepting bids for construction of a five hundred square foot locker room within existing space of the Manchester High School. Specifications will be available at 9:00 a.m., Thursday, September 9, at the Administrative Office, 710 E. Main, Manchester. Bids are to be returned to, and will be opened at the Administrative Office, 710 E. Main, Manchester, Michigan, on Thursday, September 17, 1987, at 3:00 p.m.

"Thank You"

Manchester Optimist and Lamb Club Members Would Like To Thank The Following Livestock Sale Buyers:

STEER CLUB BUYERS

MANCHESTER IGA DOUBLE A GRAND CHAMPION RESERVE CHAMPION

OTHER CLUB MEMBER STEERS WERE PURCHASED BY:

- MANCHESTER STAMPING (2)
- JOHNSON CONTROLS (3)
- MANCHESTER TOOL & DIE
- GREAT LAKES BANCORP
- DR. OKEY
- DOWNTOWN MERCHANTS
- NAPOLEON LIVESTOCK & FEED MILL
- R.D. KLEINSCHMIDT
- DIUBLE FEEDS
- BURK'S BODY SHOP
- FIRST OF AMERICA
- DR. KLUWE
- DOUBLE A (2)
- SPEAR & ASSOCIATES, MANN REALTORS
- E.G. MANN & SONS

THE CLUB STEER WAS PURCHASED BY:
MANCHESTER ELECTRIC
TIRB CHEVROLET
MIDWEST FORD
SPEAR & ASSOCIATES, MANN REALTORS

WE WOULD LIKE TO GIVE A SPECIAL THANKS TO DALE HESELSCHWERDT OF NAPOLEON LIVESTOCK

LAMB CLUB BUYERS

MANCHESTER IGA JOHNSON CONTROLS GRAND CHAMPION RESERVE CHAMPION

OTHER CLUB MEMBER LAMBS WERE PURCHASED BY:

- JOHNSON CONTROLS (2)
- KOEBBE WELDING
- DIUBLE FEEDS, INC.
- MANCHESTER CAR WASH
- MCCALLA FEEDS
- MANCHESTER STAMPING (2)
- K&W EQUIPMENT, INC.
- TIRB CHEVROLET
- P. LAMONT OKEY, MD
- KEMNER BROTHERS
- PINNACLE ENGINEERING CO. (2)
- ATLAS FEED & GRAIN CO.
- FAHEY REALTY
- TOM LAVENDER
- THE FLOWER GARDEN (2)
- MANCHESTER CHIROPRACTIC
- MARTI'S TOP DRAWER APPAREL
- KLEINSCHMIDT TRUE VALUE
- DAVE KIRK EXCAVATING
- BACK DOOR PARTY STORE
- FIRST OF AMERICA
- GROSS FARM EQUIPMENT CO.
- E.G. MANN & SONS ELEVATORS
- SCHNEARLE FARMS
- LARRY BECKTEL INSURANCE
- WOLVERINE FOOD & SPIRITS

CLUB LAMBS WERE PURCHASED BY:
G.E. WACKER, INC.
KOEBBE WELDING
MANCHESTER ELECTRIC, INC.
EARL HORNING

Bids Taken On State Projects

Replacement of the deck on the US-31 bascule bridge over the Grand River in Grand Haven will be put out for bids September 2, the Michigan Department of Transportation (MDOT) said.

It is one of 17 highway and airport projects costing an estimated \$9.5 million on which bids will be taken starting at 10:30 a.m. at the Clarion Hotel in Lansing.

The bridge deck work will begin next spring and is expected to be completed by November 1988. During construction, six lanes of traffic will be reduced to four lanes. Traffic crossing the bridge averages 45,000 vehicles a day.

The department, in conjunction with the Grand Haven Chamber of Commerce, is holding a series of three informational meetings on September 16, with local merchants, businesses and public officials to discuss next year's construction schedule.

The bridge work has an estimated cost of \$1.9 million.

A job in Wayne County will construct a pumphouse and install pumps at the intersection of Congress and Second streets and change signing on the John Lodge Freeway from Fort Street to Randolph.

The project will also add lighting on the freeway from Fort Street to Woodward Avenue, on Jefferson from Third Street to US-10 and on Larned Street from Washington Boulevard to US-10.

The project is scheduled for completion in July 1988 at an estimated cost of \$1.6 million.

There are three shoreline erosion projects, one in Leelanau and Charlevoix counties and one each in Mackinac and Oceana counties.

In Leelanau and Charlevoix counties shoreline restoration on M-22 along Grand Traverse Bay and on M-66 south of Ironton is scheduled for completion in May 1988 at an estimated cost of \$260,000.

In Mackinac County shoreline erosion repair is scheduled for US-2 in Moran Township. The work is scheduled for completion in June 1988 at an estimated cost of \$110,000.

In Oceana County Erosion protection on Longbridge Road over the Pentwater River and on Polk Road over the Huffle Creek is expected to be completed by December 1987. The Oceana County Road Commission job is estimated at \$20,000.

In Washtenaw County removal of existing bridge and construction of a double span concrete box beam bridge and related approach work on Austin Road over the Raisin River is estimated to be done by August 1988.

Hunter Safety Class

The Manchester Sportsman Club will offer Hunter Safety Classes to anyone 12 years and older at the club grounds at 8501 Grossman Road on Tuesdays, September 8, September 15,

September 22, from 7:00 to 9:00 p.m. and Saturday, September 26, from 10:00 a.m. to 3:00 p.m. ALL CLASSES MUST BE ATTENDED.

This program is sponsored by the Department of Natural Resources, and the material is provided by the DNR. DNR licensed instructors are Lauren Huber, Daryl Taylor and Earl Iverson. You have to have a Hunters Safety Certificate if you want to hunt before the age of 16.

Sign up sheets will be available at the Manchester Middle School and Keith's Barber Shop, or contact Lauren Huber at 428-8116. Parents are urged to attend with their student.

Births Announced

Michael and Linda Reeter of Manchester are proud to announce the birth of their son, Travis Michael. He was born August 30, 1987, at Herrick Memorial Hospital in Tecumseh. He weighed 8 pounds and was 20 inches long.

Grandparents are Thomas Reeter of Naples, Florida, Neoma Reeter of Mt. Pleasant, MI and Mr. and Mrs. Peter Minor of Manchester.

Mr. and Mrs. Ronald Markowski of Parma are pleased to announce the birth of their daughter, Rachelle Leigh, on August 27.

She weighed 8 pounds, 13 ounces and has one sister, Amanda, who recently graduated from Western High School in Jackson.

Larry and Lois Woodward of Manchester are pleased to announce the birth of their daughter, Tara Sky, at St. Joseph Mercy Hospital on August 13, 1987. Tara weighed 8 pounds 10 ounces.

Proud grandparents are Vernon and Wilma Woodward of Chelsea and Marilyn McAtee of Grass Lake.

Kevin Lee Walter of Manchester is proud to announce the birth of his sister, Brandi Lynn, born on August 24, 1987. She weighed 7 pounds 7 ounces and was 20 1/2 inches long. Proud parents are Terry and Faye.

Maternal grandparents are Curt and Joan Day and paternal grandparents are Eugene and Jean Walter all of Manchester. Great-grandmas are Doris Evislizer and Madge Hill of Manchester and Mary Day of Tazewell, Tennessee.



The father of all news services was the General News Association of the City of New York, started in 1849.

Classes-Classes-Classes
MAKE YOUR OWN BAND BOX
SATURDAY, SEPTEMBER 19, 1987
 10:00 am-11:00 am
CALL 428-9640 TO SIGN UP
The Village Shoppe
 134 East Main St. Phone 428-9640 Manchester
 Monday-Saturday 10 am-5 pm Sunday 12 noon-5 pm

THE STEAM TELEVISION.

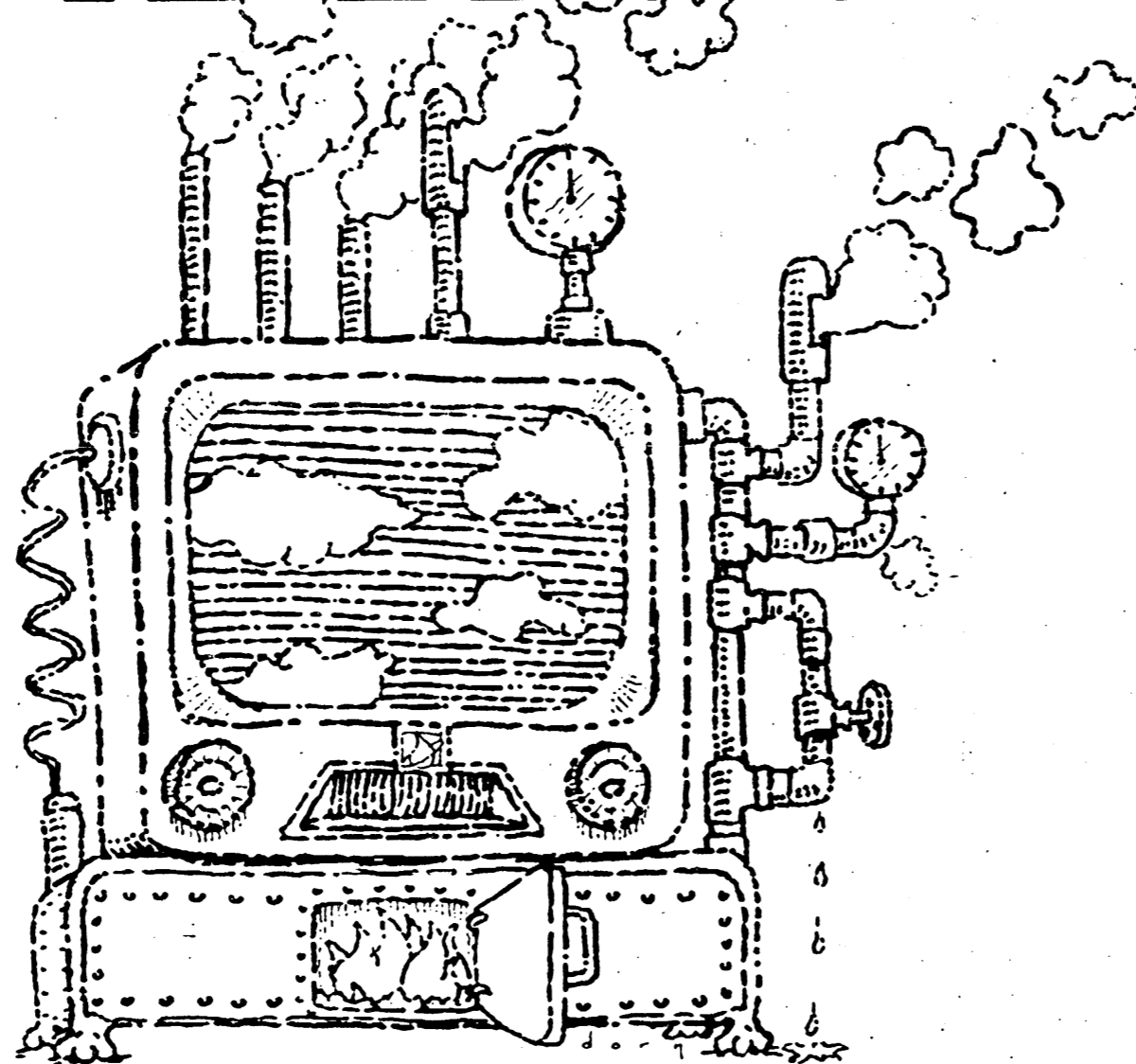

All you get are reruns of "Til the Clouds Roll By." Just imagine a world without electricity, and you'll know why Detroit Edison works so hard to make sure you're never without it. If you ever have a problem, call us. We're here to help. Good old electricity. It's more than a bargain. Comes right out of the wall. And never mildews your wallpaper.

Detroit Edison
 A good part of your life.

EMANUEL UNITED CHURCH OF CHRIST

Wednesday, September 2 - 12:30 p.m. Women's Guild Potluck and Meeting, 7:00 p.m. Music Committee, Lounge, 8:00 p.m. AA, Al Anon.

Thursday, September 3 - 7:30 p.m. Church Council.
 Sunday, September 6 - 9:30 a.m. Communion Worship, 10:30 a.m. Coffee Hour and Fellowship Time.

Monday, September 7 - Labor Day - office closed.
 Tuesday, September 8 - 12 Noon Senior Meal, 6:15 p.m. Country Dance Class, Gym, 7:30 p.m. Narcotics Anonymous.

ZION LUTHERAN CHURCH

Wednesday, September 2 - 1:30 Lydia, 7:45 Martha.

Sunday, September 6 - 9 a.m. Sunday School - Adult, 10:15 a.m. Worship, Rev. Larry Michaels, Supply of Sunday School teaching

ST. THOMAS LUTHERAN CHURCH

Wednesday, September 2 - 1:30 p.m. Ladies Aid.
 Sunday, September 6 - 9:30 a.m. Sunday School and Bible Class, 10:45 a.m. Worship with Holy Communion.

Monday, September 7 - 8:00 p.m. Church Council.
 Tuesday, September 8 - 8:00 p.m. Board of Evangelism and Missions.

BETHEL UNITED CHURCH OF CHRIST

Wednesday, September 2 - 1:30 Women's Fellowship meet.
 Thursday, September 3 - 7:30 p.m. Board of Christian Education meets.

Hospice Training

Hospice of Washtenaw, a non-profit health care agency, trains and utilizes volunteers in caring for the terminally ill and their families.

Volunteers serve families in a variety of ways: through supportive counseling, friendly visiting, health care education, light household chores and errand assistance. Other volunteers assist in office operations, publicity and public speaking. It is not necessary to have a background in health care to be a Hospice Volunteer.

Hospice of Washtenaw is an organized program of CARE FOR

THOSE WHO ARE NEAR THE END OF LIFE'S JOURNEY.

Our next training session will begin September 28, 1987, from 3:00 - 6:30 p.m. For more information please phone: 995-1995, Nancy Herc, Volunteer Coordinator.

Senior Citizens News

The weather hasn't been our favorite topic this past fair week, but it did make our lawns green again. We enjoyed fair activities anyhow, did you? September is here and we must watch out for our little ones - please drive carefully. Come to the Center for the last Friday bingo. It will be held on Thursdays following meals from now on. Labor or not, have a fun Labor Day.

Tuesday, September 8 - Welcome back! Council Meeting will begin at 9:30 a.m. Noon lunch will feature fish almondine (are you anxious to get back to Jan's and Cindy's good food?). Come one and all to senior meals for those 55 or over.

Wednesday, September 9 - Chamber of Commerce meeting and luncheon at 12 noon.
 Thursday, September 10 - Happy Birthday Party for all seniors born in August and September with cake and trimmings. You are invited to pork chop bake and bingo which will follow. The meal is free for you birthday kids.

Looking ahead: Saturday, September 12 - seniors will leave

at 9:00 a.m. for Hastings, MI and the Chariton Park Knicker and Quilt Show. Call Helen Knicker-bocker to make your reservation (428-7239).

Monday, September 21 - At 9:00 a.m. seniors leave on a shopping trip to Birch Run. Get your reservation in to Helen.

After the meals begin, hours at the Center will be: Tuesday, Wednesday and Thursdays from 1:00 - 4:00 p.m.

Thr Trumpeter is ready for September and October. You may pick up your copy at either the Center or in the dining room when you come for meals. Anyone wishing a copy mailed, call Rubena Boelter, 428-8655.

The following is a monthly schedule of Dial-A-Garden, the system of pre-recorded daily gardening tips sponsored by the Washtenaw County Cooperative Extension Service. The system is in operation 24 hours a day, 7 days a week. Interested persons are invited to call 971-1129 at their convenience to listen to timely, up-to-date gardening information.

Thursday, September 3 - Re-flower Christmas Plants.
 Friday, September 4 - Planting Hardy Bulbs.

Monday, September 7 - LABOR DAY, NO NEW DIAL-A-GARDEN.

Tuesday, September 8 - Tulip Varieties.

Wednesday, September 9 - Daffodils and Hyacinths.

PUBLIC ANNOUNCEMENT

Manchester Community School today announced its policy for free and reduced-price meals or free milk for children unable to pay the full price of meals or milk served under the National School Lunch, School Breakfast or Commodity School Programs. The following household size and income criteria will be used for determining eligibility.

| TOTAL FAMILY SIZE | A. SCALE FOR FREE MEALS OR FREE MILK | | | B. SCALE FOR REDUCED PRICE MEALS | | |
|-------------------------------|--------------------------------------|-------|------|----------------------------------|-------|------|
| | YEAR | MONTH | WEEK | YEAR | MONTH | WEEK |
| 1 | 7,150 | 596 | 138 | 10,175 | 848 | 196 |
| 2 | 9,620 | 802 | 185 | 13,690 | 1,141 | 264 |
| 3 | 12,090 | 1,008 | 233 | 17,205 | 1,434 | 331 |
| 4 | 14,560 | 1,214 | 280 | 20,720 | 1,727 | 399 |
| 5 | 17,030 | 1,420 | 328 | 24,235 | 2,020 | 467 |
| 6 | 19,500 | 1,625 | 375 | 27,750 | 2,313 | 534 |
| 7 | 21,970 | 1,831 | 423 | 31,265 | 2,606 | 602 |
| 8 | 24,440 | 2,037 | 470 | 34,780 | 2,899 | 669 |
| Each additional family member | +2,470 | +206 | +48 | +3,515 | +293 | +68 |

Children from households whose income is at or below the levels shown are eligible for free and reduced-price meals or free milk.

Application forms are being sent to all homes with a letter to parents or guardians. To apply for free or reduced-priced meals, households should fill out the form and return it to the school. Additional copies of the application form are available at the principal's office in each school. Households should answer all questions on the form. An application which does not contain all of the following information cannot be processed by the school: (1) the total household income AND the amount and source of income received by each household member (such as wages, child support, etc.) OR the household's food stamp case or AFDC number if the household is on food stamps or receives AFDC; (2) names of all household members; (3) social security numbers of all household members 21 years of age or older, or the word "none" for any adult household member who does not have a social security number; and (4) the signature of an adult household member.

FOOD STAMP/AFDA HOUSEHOLDS: If you currently receive Food Stamps or "Aid to Families with Dependent Children" (AFDC) for your child, you only have to list your child's name and Food Stamp or AFDC case number, print your name and sign the application.

The information provided by the household is confidential and will be used only for the purpose of determining eligibility and verifying data. Applications may be verified by the school or other officials at any time during the school year.

If children are approved for free or reduced-price meal or free milk benefits, the household must report to the school increases in household income over \$50 per month (\$600 per year) and decreases in household size.

Households may apply for benefits at any time during the school year. If a household is not currently eligible but has a decrease in household income, an increase in household size or if a household member becomes unemployed, the household should fill out an application at that time.

In most cases foster children are eligible for these benefits regardless of the household's income. If a household has foster children living with them and they wish to apply for free or reduced-priced meals or milk for them, the household should contact the school for more information.

Under the provisions of the policy Polly Brokaw will review applications and determine eligibility. Parents or guardians dissatisfied with the ruling of the official may wish to discuss the decision with the determining official on an informal basis. The household also has the right to a fair hearing. This can be done by calling or writing the following official: Polly Brokaw, 710 E. Main St., Manchester, Michigan 48158. Each school and the Superintendent's office have a copy of the complete policy, which may be reviewed by any interested party.

In the operation of the child feeding programs no child will be discriminated against on the basis of race, color, national origin, age, sex, or handicap. If any member of a household believes they have been discriminated against, they should write immediately to the Secretary of Agriculture, Washington, D.C. 20250.

Notice of Public Hearing on Increasing Property Taxes

THE MANCHESTER TOWNSHIP BOARD OF THE TOWNSHIP OF MANCHESTER WILL HOLD A PUBLIC HEARING ON A PROPOSED INCREASE OF .0214 MILLS IN THE OPERATING TAX MILLAGE RATE TO BE LEVIED IN 1987.

THE HEARING WILL BE HELD ON MONDAY, SEPTEMBER 14, 1987 AT 7:30 O'CLOCK IN IN THE P.M. AT MANCHESTER TOWNSHIP HALL, 275 SOUTH MACOMB STREET.

IF ADOPTED, THE PROPOSED ADDITIONAL MILLAGE WILL INCREASE OPERATING REVENUES FROM AD VALOREM PROPERTY TAXES 2% OVER SUCH REVENUES GENERATED BY LEVIES PERMITTED WITHOUT HOLDING A HEARING.

THE TAXING UNIT PUBLISHING THIS NOTICE, AND IDENTIFIED BELOW, HAS COMPLETE AUTHORITY TO ESTABLISH THE NUMBER OF MILLS TO BE LEVIED FROM WITHIN ITS AUTHORIZED MILLAGE RATE.

THIS NOTICE IS PUBLISHED BY:

Township of Manchester
 275 South Macomb St.
 Manchester, Michigan 48158
 313-428-7090

Thomas Marshall REALTOR Residence 313-428-8635

Thornton-Dalitz REALTOR

COMMERCIAL-RESIDENTIAL & FARM PROPERTIES
 417 South Fourth Avenue Telephone
 Ann Arbor, Mich. 48104-2395 313-995-9215

Michigan Veterinary Clinic, P.C.
VERA L. KLUWE, D.V.M.
 313-428-8365

Large and Small Animal Surgery and Medicine 18901 Sharon Valley Road
 Appointments: 9 AM - 9 PM Monday through Saturday Manchester, Michigan 48158-0025

CHEVROLET

A GOOD SELECTION OF NEW and USED CARS ON OUR LOT

TIRB CHEVROLET CO
 131 ADRIAN STREET MANCHESTER, MICHIGAN
 PHONE 313-428-8212 OR 313-428-8492

MON 7:30-8 TUE 7:30-6 WED 7:30-8 THUR 7:30-6 FRI 7:30-6 SAT 7:30-12 Noon

When Teenagers Work

With the start of school, teenagers will be adjusting school and work schedules. Many teens may seek their first part-time job and generally they have the support of parents, peers, employers and even school. Studies have consistently shown that working students learn work skills, explore career areas, develop social skills and a work ethic, learn to manage time, and earn wages.

A new book on working teenagers suggests that the picture isn't all that positive. Working teenagers lose touch with other age groups, are often exposed to numbing work activities and acquire bad work habits. They spend money instead of saving, sometimes making harmful choices. The working teen may be more likely to use drugs and alcohol. "When Teenagers Work" (Greenberger and Steinberg) is a thought-provoking book. But the authors conclude that their research doesn't indicate teens will stop working. The challenge is to make work meaningful and to evaluate the benefits of taking a job against costs.

Before job hunting, a teenager should consider the commitments he/she already has: School, sports, music, drama and other school activities, volunteer service, and community activities. Some activities just kill time but others expose students to people and experiences that are as important to growing up as is having a good job.

When a teenager decides to work it may not be best to take the first job that comes along. Some jobs related to vocational

classes can provide school credit and a structured learning opportunity (ie. co-operative education). Due to the shrinking numbers of young people, a teenager can be choosier in picking jobs. Excessive and late hours, and poorly trained managers are often problems for teenagers which can be avoided.

Assistance and information on opportunities to work are available at the high schools in the South & West Washtenaw Consortium. Teenagers in Chelsea, Dexter, Manchester, Milan and Saline should check with their high school guidance office about the Job Placement Service or call 428-8327 or 662-9898. All programs and services of the consortium are available to eligible students and graduates regardless of race, sex or handicap.

School Hot Lunch Menu

Monday, September 7 - NO SCHOOL. LABOR DAY.

Tuesday, September 8 - Hot Dog on Bun, Macaroni Salad, Dill Pickles, Ice Juice, Milk.

Wednesday, September 9 - Beef Ravioli, Tossed Salad with dressing, Bread & Butter, Molded Fruit Salad, Milk.

Thursday, September 10 - Ham & Cheese in a Pita Pocket, Carrot & Celery Stix, Applesauce, Milk.

Friday, September 11 - Fruit Punch, Taco's with sauce, lettuce/tomato and cheese, Buttered Corn, Fresh Fruit, Milk.

Manchester Village Council

September 8, 1987.

AGENDA

- 1) Call meeting to order
- 2) Pledge of Allegiance to Flag
- 3) Minutes of the prev. meeting
- 4) Approval of Agenda
- 5) Correspondence
- 6) Public Participation
- 7) Accounts Payable
- 8) Manager's Expense Account
- 9) Planning Commission
- 10) Treasurer's Report
- 11) Manager's Report
 - a. Conflict of Interest Policy
 - b. Limpert Easement Papers
 - c. Garnett Johnson Proposal
 - d. Pump Status Act 98
 - e. Easements for Indus. Park
 - f. ZBA Readopton
 - g. Swimming Pool Ordinance
 - h. Blight Ordinance
 - i. Foot Path Concerns
 - j. Travis Guidance on Authority of expenditures (Tres. Clerk, Employees, etc.)
 - k. Rural Housing Maint.
 - l. Budget Admndments/Budget Comparisons
 - m. Ad Hoc Committee Report - Engineering Firms
 - n. T.V. Macomb St. and Pavement Project
- 13) New Business
 - a. Consent Decree Negotiations in regards to Treatment Plant Grant
- 14) Closed Session - DPW Cont.
- 15) Adjourn

WWI Combat Patients Sought

The French Government is inviting World War I veterans who were patients at the American Hospital in Neuilly, France (Paris) 70 years ago to return to the hospital September 21-24 for ceremonies commemorating the 70th anniversary of the landing of the American Expeditionary Force in France and America's entry into the First World War.

The American Hospital, now a prestigious French-run treatment and research facility with international staff, was established by U.S. forces in 1917 to treat American combat casualties. The French Government and the hospital are offering World War I veterans who were treated there, and spouses, all expense paid trips to participate in four days of ceremonies, part of the French Government's year-long observance of the 70th anniversary of the landing of American forces on French soil during World War I. U.S. forces stopped the German drive toward Paris and turned the tide of war against the Germans.

Muriel Parkhurst, executive administrator of Veterans of World War I, Inc. in Washington D.C., is assisting the French Embassy in the search for the former hospital patients. "We are seeking a select group within a select group," she said. "The average age of our World War I veterans is 92 and their numbers are down to just over 179,000. We are hoping that publicity through veterans groups, VA facilities and the news media will help those former American Hospital patients get in touch so they can participate." World War I veterans who were treated at the American Hospital in Neuilly just outside Paris should contact Parkhurst at the phone number and address below by September 14th.

Muriel Sue Parkhurst, Executive Administrator, Veterans of World War I of the USA, Inc., 941 Capitol St., N.E., Washington, D.C. 20002-4234; phone 202-275-1388.

"A trip to France and a place of honor are at stake," she said, "but we need to hear from these veterans as soon as possible."

Norm Walz & Son Construction

Manchester, Michigan

**NEW HOMES
REMODELING
ADDITIONS
GARAGES
SIDING
DECKS**

**Custom Built
Cabinets**

428-7109

Kirk Excavating

Sand—Gravel—Fill Dirt
Basements—Driveways

428-7938

Dave Kirk

14180 Schleweis Road
Manchester

CUSTOM CABINETS MADE IN MANCHESTER

Competitive Prices
Installation Available
Design Service

—OR—

Let Us
Reface Your Old
Cabinets and Save \$\$

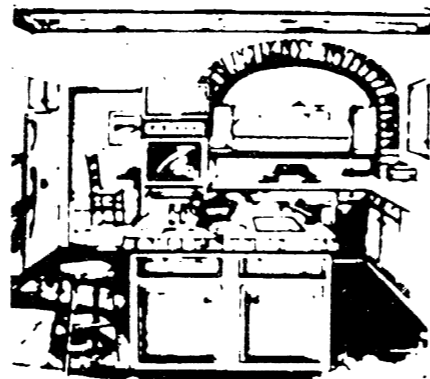

Dutch Country Kitchens

18352 W. Austin Road Phone 313-428-7292 Manchester

Dance Arts Academy

Offering Classes In

Creative Movement, Ballet
Tap and Jazz
Ages 2½-Adult

Director: SUSAN BUCK

DIRECTOR: SUSAN BUCK, Bachelor of Science & Master of Science in Ballet from Indiana University, former principle dancer of the Texas Ballet, studied and performed internationally, extensive experience in professional ballet and in the teaching of dance to all ages.

Registration:
Thursday, September 10th
Nellie Ackerson Middle School
7 P.M.-9 P.M.

FOR FURTHER INFORMATION
CONTACT SUSAN BUCK AT
769-0745 or 483-5574

1987 Optimist Steer Club Buyers



STEER CLUB MEMBER

GRAND CHAMPION - Bryan Strahle \$2.40
RESERVE CHAMPION - Jennifer Bailey \$2.25
Brad Macomber \$1.50
Amy Schearle \$1.25
Steve Samonek \$1.25
Doug Bristle \$1.20
Jennifer Kunzelman \$1.10
Amy Weidmayer \$1.20
Kevin Strahle \$1.20
Sara Samonek \$1.25
Tricia Horning \$1.10
Greg Weidmayer \$1.10
John Cousino \$1.00
Billy Day \$1.00
Joanne Kemner \$1.15
Stephan Alber \$1.00
Lisa Lozier \$1.00
Mark Lavender \$1.00
Patrick Waltz \$0.90

Bob Blumenauer \$0.90

Michigan Livestock donated towards two steers insuring each club member \$1.00 per pound.

PRICE PER LB.

BUYER

IGA
Double A
Manchester Stamping
Johnson Controls
Manchester Tool & Die
Great Lakes Bancorp
Dr. Okey
Downtown Merchants
Napoleon Livestock & Feed Mill
R.D. Kleinschmidt
Johnson Controls
Duble Feeds
Burk's Body Shop
First of America
Manchester Stamping
Johnson Controls
Dr. Kluge
Double A
Spear & Associates
Mann Realtors
E.G. Mann & Sons

Dutch Warn Cascade Conference



Double A Products, represented by Chuck Mattoff, purchased the Reserve Grand Champion Steer raised by Jennifer Bailey.

Manchester's high school football coaching staff left to right: Curt Fielder, JV; Wes Gall, Varsity; Jim Fielder, Varsity; Dick Fielder, JV; Jim Sloat, Varsity.

Photo by Jon

by jon

This years varsity squad has much to be optimistic about. The fact that we have 15 returning lettermen who led us to a 6 and 3 overall record last year should make Manchester fans ecstatic. Head coach Jim Fielder is looking forward to this season, but is a cautious man who doesn't believe in counting chickens before the eggs hatch.

Be here at Booster field Friday, when we host arch-rival Clinton.

Dick and Curt Fielder, JV coaches, trek to Clinton Thursday evening. Our little Dutch have not lost in two seasons and still look tough.

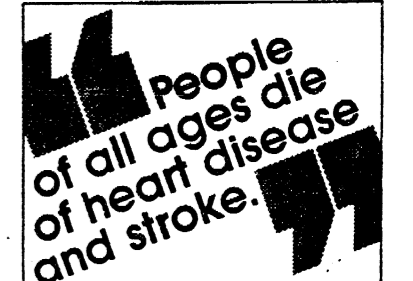

With your help, we're out to change that.

American Heart Association
WE'RE FIGHTING FOR YOUR LIFE

HERRICK DIAGNOSTIC AND TREATMENT CENTER

415 E. Kilbuck, Tecumseh, Michigan
(Formerly the Tecumseh Medical Bldg.)
Offering Services In

- ★ GASTROENTEROLOGY
Eugenius Ang, M.D.
- ★ NEUROLOGY
Allan Clague, M.D.
- ★ PODIATRY (Foot Surgery)
Don Schubert, D.P.M.
- ★ UROLOGY
C.T. Lin, M.D.
Ashwin Shah, M.D.
- ★ DERMATOLOGIST
Jeffrey Messenger, M.D.
- ★ CARDIOLOGY
Manhar Tegura, M.D.
- ★ OTORHINOLARYNGOLOGY
Harry Richter, M.D.
- ★ OTORHINOLARYNGOLOGY
Keo Poopat, M.D.

For Appointment Call
423-7481 or 423-7482

- ★ ALLERGIST
R.J. Guttridge, D.O. 423-4946
- ★ GYNECOLOGIST/OBSTETRICIAN
William Long, D.O. 423-6667

COUNTRY DAYS "Home Decorating and Gifts"

134 East Main Street Manchester, Michigan
313-428-9449
lower Level of The Village Shoppe

Order Your Wallpaper Now For
Those Fall Projects
30% SAVINGS SALE
Now In Progress

Friendly Family Dentistry Bruce Bates, D.D.S.

500 Galloway Drive Manchester, Michigan



SERVICE BY
APPOINTMENT

PHONE
313-428-8277

Open Monday-Friday 9 am-5:30 pm
Tuesday 12-9 pm Wednesday 12-8 pm
SOME SATURDAY MORNING HOURS AVAILABLE

New Patients, Medicaid
and Emergencies Always Welcome

VISA ACCEPTED
MOST DENTAL INSURANCE PLANS ACCEPTED

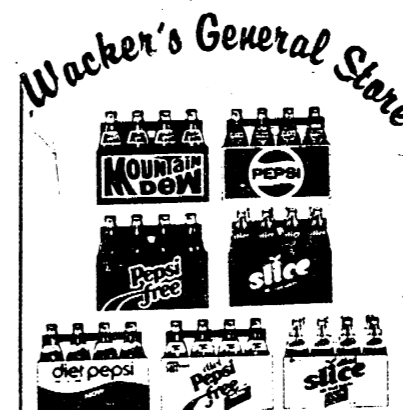

PEPSI, DIET PEPSI
MOUNTAIN DEW
PEPSI FREE
SUGAR FREE PEPSI FREE
A & W ROOT BEER
VERNORS
SUGAR FREE A & W
SUGAR FREE VERNORS
SLICE & DIET SLICE
\$2.29
½ LITER 8 PACK
plus deposit

2 Liter \$1.49
plus deposit

6 Pack Cans \$1.89
plus deposit

G.E. Wacker Inc
Gasoline-Fuel Oil-Grease
Motor Oil-Diesel Fuel
9050 Chelsea-Manchester Road
Manchester, Mich. 48158

Summer Hours
Monday - Friday 7 am-9 pm
Saturday 8 am-9 pm
Sunday 9 am-9 pm

DAN'S WESTSIDE AUTOMOTIVE

660 West Main Street Phone 428-9455 Manchester, Michigan

We have the latest in 4 wheel alignment equipment
6 important facts about wheel alignment

1. Extend tire life
It's happened to almost everyone: buy a set of tires, and before long one or two tires are wearing out before the others. On today's cars, this applies to the rear tires as well as the front tires. The most common cause of unusual tire wear is improper alignment. Over the years, a properly aligned vehicle can save hundreds of dollars in tire wear.
2. Spot problems early
A suspension system inspection is an inherent part of the wheel alignment operation. This gives the mechanic a chance to spot worn parts that would affect vehicle alignment. It also gives him an opportunity to spot small problems before they become big, costly ones.
3. Ensure safe driving
A periodic four wheel alignment makes sure your car handles properly and, more importantly, provides an opportunity for inspecting the suspension system for defective parts. In some ways, the safe driving aspect may be the most important benefit of wheel alignment.
4. Stretch fuel mileage
Fuel mileage increases as rolling resistance decreases. Proper wheel alignment sets all four wheels parallel which, in turn, assures minimum rolling resistance. This plus proper tire inflation provide top efficiency for maximum mileage.
5. Improve handling
Does your car pull to one side, does the steering wheel vibrate, do you have to constantly move the steering wheel to keep your car traveling straight ahead? These and other handling problems can generally be corrected by four wheel alignment.
6. Get a better ride
Proper alignment helps the front and rear suspension systems do their job. With all the system components in proper relation, road shock is efficiently absorbed, so the vehicle is more stable, and you get a smoother ride.

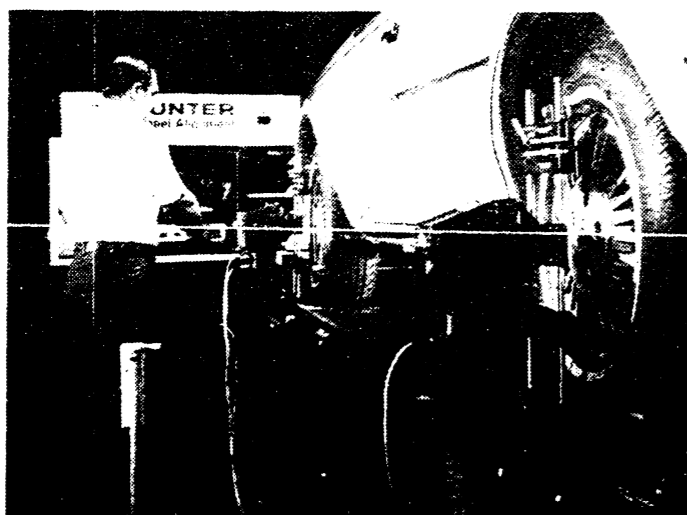

NEW HOMES
ADDITIONS
SIDING

GARAGES
ROOFING
DECKS

DANIEL R. WAMPLER
517-456-4305

FUND RAISING

Manchester Sportsman Club
8501 Grossman Road
Friday 6:45 p.m.

Manchester American Legion
203 South Adrian Street
Saturday 7:00 p.m.

your advertising dollars do better in the classifieds

All Classified Advertising Is Payable In Advance And Must Be Placed And Paid For Prior To 11 A.M. On Tuesday For Publication That Week.

JERRY WHITAKER EXCAVATING - Dozer, backhoe, dragline and 10 yard truck. Drain fields, basements, driveways, sand and gravel. Call 475-7841 tfn

FOR RENT - 1200 sq. ft. building on Main Street. Phone 428-8173. tfn

HYPNOTHERAPY - Smoking, weight, stress etc. Terri White RN MS Ann Arbor 994-4644. It works! tfn

TECUMSEH'S NEWEST Registered Briggs and Stratton, Tecumseh, MTD Warranty Dealer.

PRIME COMMERCIAL SPACE - For rent in the Manchester Mill. Contact D.E. Limpert. 517-456-4151. tfn

MANCHESTER ANTIQUE MALL - 35 Dealers. Open 7 days, 10-5, 116 E. Main 428-9357. tfn

CATTLE - Angus-chi, cows and calves, all ages. 428-8701. tfn

COPY PAPER AVAILABLE We have copy paper in sizes 8 1/2 x 11, \$4.75 for 500 sheets. 8 1/2 x 14, \$5.75 for 500 sheets. The Manchester Enterprise. tfn

LOST OR FOUND A PET? - Call Humane Society, 662-5585. tfn

OVER NIGHT - Accommodations at the Clinton Hotel, 104 W. Michigan Ave. Dining and full service bar. 517-456-4151. tfn

C & B PAINTING - Interior-exterior-free estimates. Contact Charles E. Benedict. Phone 428-7136 or 428-7416. tfn

FIELDER PAINTING - Interior and exterior. Free estimates. Senior Citizens discount. Phone 428-8506. tfn

MICHIGAN PEAT SALES - Black dirt for sale, \$10 a yard delivered. Fast delivery, 428-9664. tfn

AIREDALE TERRIERS - AKC registered, born 3 August '87. Dave 428-7845 after 5 p.m. 9-10p

MANCHESTER K OF C HALL - Available for wedding receptions, parties, meetings. Hall rental \$165 includes cleaning; use of kitchen \$25. Catering available. For further information call 428-8393 or 428-8886. tfn

WANTED - Standing Timber - saw logs or veneer. Buskirk Lumber Co. 517-661-7751. tfn

WALKOWE'S HOME IMPROVEMENT COMPANY - Phone 313-428-8468. Seamless aluminum gutters for low prices and dependable service. tfn

BLACK DIRT - Or peat. 6 yards \$50 delivered. Phone 428-7784 and 428-9415. tfn

SELF STORAGE - Unit for rent in the village, 428-7173. tfn

LANDSCAPING SERVICE - Dozing and backhoe, driveways, backfilling etc. Phone 428-8868 eves. tfn

CORKEY D'S DELI - Homemade Ice Cream & Waffle Cones - Sandwiches - Subs - Baskets - Burgers - Fries - Party Trays & Salads - Baked Goods of all kinds, phone ahead - 428-9216. tfn

VILLAGE HAIR FORUM - 201 East Main, Old Mill 428-7684. tfn

PIANO TUNING & REPAIR - Qualified technician - Ron Harris, 475-7134. tfn

MERRIMAN INSULATION - Free estimates. Blown-in cellulose, professionally installed. George Merriman, phone 517-592-5527. tfn

CHELSEA GREENHOUSES - 7010 Lingane Road, Chelsea, Michigan. 475-1353-54 or 475-9313. Flowers and plants for every occasion. We specialize in wedding flowers to fit your budget. We are as near as your phone and we welcome your business. tfn

SPACIOUS DUPLEX - 2 bedroom apartment available immediately. \$375 per month. Call evenings 428-7731. tfn

DANCE - Now taking fall enrollment for tap, ballet, jazz, tumbling and pre-school classes. To enroll and more information contact Annette at 428-9581 after 4 p.m. 9-17p

APARTMENT WANTED - Single adult seeks apartment in Manchester. Call Keith 973-9686 8 to 5. 9-3p

CAREER OPPORTUNITIES - Parents, teachers, homemakers - interested in a full or part-time career working with Discovery Toys? Call 428-8279 for more information. 10-1p

WILL DO BABYSITTING in my home. Monday - Friday 6:00 a.m. - 5:00 p.m. Full or part-time. Call 428-7475. 9-24p

DAY-CARE ASSISTANT needed - immediate opening Tuesday and Thursday. Call 428-7704. 9-17

BMW '83 R100T, 60th anniversary edition, pearl white, excellent condition, low mileage. 517-750-4100. 9-17

HAIR STYLIST WANTED - Experience preferred. Call 475-7677. 9-10p

RIDE NEEDED to Ann Arbor, to arrive by 8:15 a.m. 428-7173. tfn

MCDONALDS OF CHELSEA - Now hiring for day shifts, premium pay, flexible hours, full time. See manager for application. 9-24

ADULT CARE - 17 years to 117. My home - daycare, vacation and over night lodging. 1-517-423-4389. 9-17

"LEGAL SECRETARY position available commencing immediately in nonsmoking office. Approximately 20/hrs. per week, with occasional 30-40 hrs./week when regular secretary is on vacation. Requires excellent typing, health, and organization; basic bookkeeping and computer WP knowledge recommended. Start at \$4.00 to \$5.50/hr. with periodic increases as the job is mastered. Submit resume to Law Office, P.O. Box 276, Manchester, MI 48158." 9-3

CORNET, W/CASE \$250; 1/4 size violin w/case \$100. Please call 428-8064. 9-3p

FULL AND PART-TIME positions available for production work. Apply at 7931 Grand Street, Dexter. 9-3

BABYSITTER NEEDED for 2 small children starting September 7, prefer in my home. Call 428-9486. 9-3

BABYSITTING - In my home, Jennifer DuRussel, 428-7459. 9-17

FREE PUPPIES - 3/4 Lab, 1/4 Springer Spaniel, 4 males. Good hunting stock. 428-8086. 9-10p

WANTED - Sickle Bar Mower for 3 pt. hitch. Must be in good condition. Phone 428-7168. p

DATA-ENTRY CLERKS - Automatic Data Processing, one of the world's largest and most progressive computing services company has immediate openings available for both full and part-time shifts.

No previous experience is required and we provide a full training program to the selected individuals who are able to type 50 wpm and have the ability to accurately read small print on an on-going basis. You will be responsible for the data entry of automotive information on our data base.

We offer a competitive salary and benefits package. Apply in person at: ADP Automotive Services Group, 180 Jackson Plaza, Ann Arbor, MI 48103. An equal opportunity employer.

FREE - building for removal. Call 313-428-7866. p

ALUMINUM RECYCLING TOP PRICES PAID FOR ALUMINUM SCRAP & ALL NON FERROUS METALS Jackson Fibers Co. (517) 784-9191 1417 So. Elm St. 1 blk. North of High St. Jackson, Michigan

36" ENTRANCE DOOR with storm door and hardware, \$50. 428-9257. p

FOR SALE - 18 ft. Thompson canoe. Needs new canvas cover and few repairs. Sturdy. \$50.00 takes it. Call 428-8340 or see it at 429 So. Macomb St. p

PLATE PREP LAYOUT workers Openings on the midnight shift. Requires attention to detail, manual dexterity, and high school level math abilities. Excellent fringe benefits including profit-sharing. Apply at Edwards Brothers, Inc., 2500 S. State, Ann Arbor, MI 48104. E.O.E. M/F p

LOST - in 500 block of E. Main on the way to the fair pet show - a yellow tiger cat with white nose, chest and paws. Had green collar on and answers to Garfield. Reward - please call 428-8404. p

ABSOLUTELY ADORABLE Kittens need a loving family to adopt them. We have one velvet black female, 1 orange and white male, and 1 curious tabby with a white paw. All have their first shots. Call now and get your first choice. 428-9497 or to leave message, 428-7001. p

NOW HIRING Mothers and mature workers welcome. Part-time help days. Starting \$4.00 to \$4.50 per hour. Apply in person to Chelsea Taco Bell Main Street Chelsea 9-24

Thanks to the Manchester IGA for buying my Grand Champion steer at the fair this year. Also a big thank you to the Optimist Club for sponsoring the Steer Club. This has been a very enjoyable project. Bryan Strahle

Garage & Yard Sales

3 FAMILY YARD SALE - lots of children and adult clothing, toys, dishes, appliances, Avon collectibles and much more. Saturday, Sunday, Monday, 12940 Tipton Hwy., 9 to 5.

JOHN H. VECCHIONI Real Estate Consultant Thornton REALTOR® 323 S. Main Street Chelsea Michigan 48118 Office: 313-475-9193 Residence: 313-428-7595

MARGIE'S UPHOLSTERY 6245 Brooklyn Road Jackson Wide Selection Of Fabrics Pick-Up / Delivery Available 517-536-4230

Part Time Typist Needed Work Requires Excellent Spelling Skills As Well As Accuracy In Typing 15-20 Hours Week Send Resume To: Manchester Enterprise PO Box 37 Manchester, Mich. 48158

GARAGE SALE - Some furniture and other things. 678 W. Main, rain or shine, Thursday, September 3rd thru September 9th.

PARTIAL CONTENTS FROM Eisele Welding Sunday, September 6, 9 to 6, Monday, September 7, 9 to 3; 20477 Scio Church Road, Chelsea, MI. 1/2 mile off M-52. Welding equipment, metal working machines, drill press, threading machines, corn knife grinder trailer, Allis Chalmers Tractor, manure spreader, handmade buckboard, workbenches, electric, air and hand tools, nuts, bolts, farm implement parts, steel, misc. shop supplies, some antique household and tools, boat. p

Card Of Thanks

Many thanks to all the people of Manchester who remembered us in various ways while we were recovering from an auto accident in Wyoming. Thank you too, for your help in keeping our place looking great all summer. We also appreciate the many thoughtful things you have done for us since our return home. Irene and Benny Kemmer

A special "thank you" to all the workers on the Food Tent dinner shift, 4:00 - 8:00. Without your help things wouldn't have been so smooth. Thank you, Thank you! Carol Schardt

Thanks to the Manchester IGA for buying my Grand Champion steer at the fair this year. Also a big thank you to the Optimist Club for sponsoring the Steer Club. This has been a very enjoyable project. Bryan Strahle

The Manchester Girl Scouts wish to thank Art Feldkamp and Joseph Kastl for the use of the wagon for the Girl Scout float; Bob, Lois, and Linda Hansen for the use of their barn, their help and pulling the float; Nita Mills for super service on the balloons; and the parents who helped with the float and the booth at the fair. It was a great success!

JOHN H. VECCHIONI Real Estate Consultant Thornton REALTOR® 323 S. Main Street Chelsea Michigan 48118 Office: 313-475-9193 Residence: 313-428-7595

Cant Find The House You Are Looking For? Let Us Build A WICK HOME For You 517-563-2930

Manchester Sportsman Club TRAP SHOOT SUNDAY September 6th 1 P.M. Public Welcome

Public Meeting September 9th

A public meeting will be held on Wednesday, September 9, 1987, at 8:00 p.m. in the Sharon Township Hall at 18010 Pleasant Lake Road to inform residents of what hazards are actually posed by "hog hotels" and what public agencies can and cannot do under existing laws.

James E. Murray, Washtenaw County Drain Commissioner, has invited representatives from the Michigan Department of Natural Resources, the Michigan Department of Agriculture, the Washtenaw County Health Department, the State Farm Bureau and the Washtenaw County Farm Bureau to attend the meeting. They will hear citizens' concerns and discuss the issues raised by the presence of "hog hotels". Murray said that during the

last couple of years, a great deal of concern has been generated by the daily operations of the "Bacon Acres" hog farm on Lehman Road in Sylvan Township. Concerns ranging from ground water pollution and well water contamination to poor air quality and strong odors have prompted residents from surrounding areas to petition their local elected officials and public agencies to investigate this potential hazard.

Early Deadline!

Due to the Labor Day holiday on Monday, September 7th, the Manchester Enterprise will have early deadlines for all news items and advertising. All pictures and display advertising must be in by 5:00 p.m. Friday, September 4th. All classified ads and news articles must be in by 10:00 a.m. Tuesday, September 8th.

SALMON CATCHES IN THE 'PINK'

Salmon family homecoming good news to anglers

Michigan's fall salmon run is expected to give anglers variety and geographic choice with pink salmon gaining prominence along with their chinook and coho cousins as part of the state's \$91.5 million-a-year sportfishing industry, reports AAA Michigan. Anglers "thinking pink" should fish northern waters as biologists at 15 state Department of Natural Resources fisheries predict that most Lake Superior and northern Lakes Michigan and Huron parent streams will welcome home naturally produced pink salmon.

The pink, smallest salmon in the Great Lakes, was unintentionally introduced into the Great Lakes in the mid-1950s and has slowly grown in numbers and distribution. This year, the pink is predicted to reach as far south as the Betsie River.

Known as the humpbacked salmon because the spawning male develops humps behind the head, the two-year spawner enters small streams in September and October in the odd years. Smaller than its chinook and coho cousins, the state record pink is about six pounds.

Anglers will find the state's heaviest coho concentrations off Lake Superior, Lake Michigan and Metro Detroit rivers with most chinook running in Lakes

Michigan and Huron streams. The average chinook and coho sizes have been decreasing since 1983. Chinook generally weigh 5 to 25 pounds and few reach 35 pounds while coho average 6 to 20 pounds. According to biologists, fish are smaller because intense angling pressure in the Great Lakes is taking large numbers of fish before they reach spawning age.

Decreased forage - alewives, smelt, chubs and perch - also has contributed to the smaller size and is a major reason why the 1985 Lake Michigan salmon planting was reduced by 10 percent.

Although this summer's hot weather may have forced salmon to remain scattered in deeper waters about 10 to 15 miles off Great Lakes shores longer than normal, biologists predict that salmon runs should start near the regular time.

Great Lakes salmon action reaches its peak in late August and September when fish begin schooling near mouths of their parent streams. From mid-September to mid-October, best stream action should be in the 48 areas listed in AAA Michigan's Salmon Fishing Guide.

Approximately 8.8 million salmon are planted annually in the Great Lakes, including 2.8 million coho and 6 million chinook. Nearly 50 percent of those plants

are in Lake Michigan, 41 percent in Lake Huron, 8 percent in Lake Superior and about 1 percent in the Huron River near Detroit. Ten to 15 percent of chinook and 20 to 25 percent of coho survive for spawning runs.

Concentrated in bankside pockets and pools, the best way to catch spawning river salmon is casting with lures such as Little Cleos, Mepps Spinners, Hot 'N Tots and other lively baits. Fly fishing in streams is very productive with streamers, nymphs and spawn bags.

Salmon snagging with artificial baits or unweighted hooks is legal from Sept. 10 to Oct. 25, on sections of the Sable, Pere Marquette, Big Manistee and Muskegon rivers. The DNR's 1987 fishing guide details the liberalized areas for each river.

The Michigan Department of Public Health says that contaminant levels in Great Lakes fish have dropped in recent years, but nursing mothers, pregnant women, women who anticipate bearing children and children age 15 and under should not eat salmon.



Jupiter, chief of the Roman deities, was also called Optimus Maximus - "The best and the greatest."

London Carpet Care RESIDENTIAL & COMMERCIAL • Carpet & Upholstery Steam Cleaning • Insured • Free Estimates Phone Day or Evenings The Latest In Equipment From 428-9618 7 DAYS Dave London

PLEASANT LAKE FLEA MARKET Saturday, September 5th 9 AM TO 6 PM AURA INN PARKING LOT Public Invited To Buy and Sell Treasured Items For More Information Call 428-7993

PARR'S AUTO BODY BODY WORK - PAINTING FREE ESTIMATES INSURANCE WORK GLASS INSTALLATION 18481 W. Austin Road Manchester, Michigan Phone 313-428-9538

An Invitation To: YOUTHS OF ALL AGES YOUTH APPRECIATION DAY NOON TO 6 P.M. Saturday, September 12, 1987 At CHELSEA LANES 1180 M-52, Chelsea, Michigan FUN FUN FUN With Many Valuable Safety Programs Scheduled Throughout The Afternoon. FUN FUN FUN FREE Bowling, Videos, Pinball, Hotdogs Soft Drinks and Popcorn REMEMBER TO PUT SEPTEMBER 12, 1987 ON YOUR CALENDAR THIS WILL BE A DAY YOU WON'T WANT TO MISS!! From: Chelsea Lanes, Chelsea Police Department, Chelsea Fire & Rescue Chelsea Lions, Chelsea VFW, Chelsea Boy Scouts, Washtenaw County Sheriff, Chelsea Office Supply

Map of Michigan showing salmon fishing areas with numbered locations. Includes a table with columns for 'Coho Chinook Pink' and 'Coho Chinook Pink' for various rivers and lakes.

Money Management

To Buy Or Not Buy?

(Prepared by the Michigan Association of Certified Public Accountants)

To buy or not to buy? That is the question facing many individuals who are in the market for a new car or residence. According to the Michigan Association of Certified Public Accountants, it is generally a person's individual needs and circumstances that determines whether it would be best to buy or lease. Each option has its own set of advantages and disadvantages, all of which should be carefully examined.

Not long ago, the questions facing new car buyers was whether to pay cash or to finance. Now leasing presents a third choice. When you lease a car, you (the lessee) are using a vehicle that belongs to someone else (the lessor) under certain conditions (the lease agreement). Better yet just think of it as a long-term rental car.

There are several good reasons to lease a car, although saving money is usually not one of them.

It almost always costs more in the long run to lease a car than to buy one. However, some people find it more convenient to lease a car. Many leasing companies would like you to believe that leasing costs less because there's no down payment. And, yes, the monthly payments are often lower, but that's because they are based on the new car price less its resale value at the expiration of the lease. When you finance a car, your monthly payment is based on the car's entire cost less your down payment. But when the car is paid off, it's yours. When your

lease expires, you usually own nothing. But if you long to drive a Cadillac and can't afford the down payment, leasing may make your dream come true.

As for tax considerations, CPAs report that under tax reform you no longer have an itemized deduction for the sales tax on your new car and this year you may only deduct 65 percent of the car loan interest. (That amount will gradually be phased out until it reaches zero after 1990.)

If the added convenience of no cash down features of leasing appeal to you, shop around. The best deals and lowest monthly payments generally are available on cars that have the highest resale value. So beware - that loaded pink Cadillac you love may have limited appeal, lowering its resale value and raising your costs. There are two basic types of leasing agreements - open-end and closed-end - of which closed-end has become the most prevalent. With a closed-end lease, the company takes the car back at the end of the lease period. The company sells it and takes the profit or loss. Sounds easy enough, but you'll want to read the fine print to be sure of your responsibilities.

Most lease agreements require that you return the car in good condition, less ordinary wear and tear. Just what constitutes ordinary wear and tear is something you'll want to investigate before signing. Also, if you exceed the agreed upon mileage, you will be responsible for the excess mileage - usually to the tune of eight to ten cents a mile for each additional mile.

With an open-end lease, an estimated resale price is specified

when the lease is signed. When the lease expires, if the car sells for more you pocket the gain. If it sells for less, you pay the difference. Your monthly payment may be lower with an open-end lease but you do run the risk of losing money in the end.

Although the fact of the matter is that leasing a car will cost more, it may very well be the right decision for some drivers. The choice to buy or lease one's residence has been around longer than the corresponding choice on cars. Although the facts and figures differ, once again, in the long run, it is generally cheaper to buy than rent. However, there are many instances where renting may make more sense - even when it's not cost-effective. A house provides you with a stable and generally high-yielding investment. You build up equity and your home can serve as an asset you can borrow against. For most people, there is also a definite tax advantage to home ownership. Because mortgage interest costs and real estate taxes are deductible, your ownership costs are directly related to your income tax

bracket. The higher your income and your tax bracket, the more you stand to save by owning your home. Those taxpayers who do not itemize, do not realize any tax benefit of ownership.

On the other hand, home ownership does require a hefty down payment (which could otherwise be invested) and a commitment to many years of monthly payments. And as a homeowner, your responsibility doesn't end there. You will have to devote a great deal of time and money to the upkeep of your home. Now, what about renting? Yes, like leasing, it does cost more in the long run, particularly in the sense that you do not realize the build-up of equity, nor do you receive the tax benefits. In addition, unless you are protected by rent control, you can never be quite sure of future rent increases. If they come, you either pay the increase or you move.

Renting does, however, provide you with more financial flexibility. If you lose your job, get transferred or otherwise decide to relocate, it is generally easier to accomplish this in a relatively short period of time if you are renting. When you rent, your commitment is limited to the term

of your lease - not a 30-year mortgage. Your day-to-day living expenses will probably be lower than if you were an owner.

Taxes, major repairs, mowing grass and shoveling snow may all be the responsibility of your landlord. Another plus - if you're not sure you like an area or neighborhood, renting can give you a chance to test your surroundings without making a large financial commitment.

Which is better for you? It depends on your circumstances. CPAs suggest that renting or leasing may very well be more appropriate at one state of your life; ownership at another.

Meeting Notices

Rogers Corners Farm Bureau

The Rogers Corners Farm Bureau group will meet Friday, September 11th at 8 p.m. at the home of Ken and Kathy Siler.

American Legion Auxiliary

The American Legion Auxiliary will meet at the Legion Home on September 9, 1987, at 7:30 p.m. This will be the first meeting of the new season, and all members are urged to attend.

THE MANCHESTER ENTERPRISE

25¢ COPY

120TH YEAR VOLUME NUMBER 47

USPS NO. 327-460

THURSDAY, SEPTEMBER 10, 1987

Area Agencies Battle AIDS

Acquired Immune Deficiency Syndrome, or AIDS, is still an incurable, deadly disease that affects thousands of Americans. Several Washtenaw United Way agencies supply support and aid to victims of this fatal illness.

The American Red Cross (971-5300) tests all donated blood for the HIV antibody. If the donor tests positive for the HIV antibody, the blood is destroyed. A Red Cross nurse meets with the donor and recommends that he or she see a physician for further tests. For people who have had transfusions prior to March 1985 and are worried about possible contamination, the Red Cross will test them for the presence of the HIV antibody. To fight the further spread of the disease, the Red Cross will soon offer an AIDS education program aimed at junior high and high school students, a work place awareness program for adults, and a general public education program for clubs and organizations.

Child and Family Service provides counseling and a Home Health Care program for AIDS patients and their families. Through their chemical dependency program - C.L.E.A.R. House (663-2500) - Child and Family reaches out to another high-risk group: intravenous drug abusers. Phil Mosby, Director of C.L.E.A.R. House, says the program tries to "help the individual substance abuser identify whether he or she is in a risk-behavior situation. Do they use other people's needles? Have they had sex with other IV drug abusers? People in these situations have a greater risk of contracting the disease. We suggest they take the AIDS test." C.L.E.A.R. House also works with pregnant substance abusers, not only to rid them of their addiction, but to increase their awareness of the disease and to decrease the chance of the mother or child becoming infected.

The Hemophilia Foundation of Michigan (761-2535) has support groups for hemophiliacs who have been exposed to or infected with the AIDS virus; an additional support group is offered for families of hemophiliacs with the disease. The foundation provides counseling to patients and AIDS-related information to high-risk clients. The Hemophilia Foundation of Michigan is a member of the AIDS-Related Communications Network and the AIDS Education Network. Whitmore Lake Community Health Clinic (449-2033) provides free AIDS testing on request during checkups. Blood samples are sent to a state lab for analysis; the results are then returned to the clinic where physicians act on that information. Executive Director

Hilda Weiser notes that "The AIDS test is an important part of the Clinic's premarital exams. Couples who are about to marry and start families need to know if they could possibly pass the disease on to their children."

If you have any questions about AIDS or would like more information, call one of the above agencies or the AIDS Hotline at 1-800-342-AIDS.

Customers To Receive Refund

Consumers Power Company's 1.4 million electric customers will receive a one-time refund totaling \$74 million in September bills.

A typical residential customer, using 500 kilowatt-hours per month, will receive a refund of \$18.25, which will appear as a bill credit. The refund stems from a recent Michigan Public Service Commission decision which reduced a \$137 million annual rate increase granted Consumers Power in 1984 to \$115 million. The rate reduction is effective in September bills and saves a typical residential customer \$1.18 per month.

Consumers Power Company, the principal subsidiary of CMS Energy Corporation, is Michigan's largest utility serving almost six million of the state's nine million residents in 67 of the 68 Lower Peninsula counties.

Chamber Of Commerce To Meet

Chamber of Commerce members and guests will have an opportunity to inspect the new Chateau Grand Traverse at the first meeting of the 1987-88 year.

Officers and a Director for the new year will be elected and a reception featuring wine and cheese will be held in the tasting room. Non-alcoholic beverages will also be available.

The meeting will be Wednesday, September 16, 1987, from 6:00 to 8:00 p.m. at Chateau Grand Traverse, 5701 Sharon Hollow Road (old Sharon Mill).

Businesses and industries as well as local residents interested in the Chamber of Commerce are invited to attend. Members are urged to bring spouses and prospective members. There will be a \$4 charge per person for refreshments.

R.S.V.P. by Monday, September 14, to Mary Kallewaard (428-7194) or Mark VanBogelen (428-8389).

SUPPORT YOUR LOCAL CHAMBER OF COMMERCE!

Fishing

Manchester Enterprise August 12, 1989

Seated at our table a few days since, looking over exchanges, we were accosted by a friend, thus: "By jove, Mat, this is the dullest day of the season, and I for one, do hereby propose that this institution 'go fishing.'" Well, what could I say in reply, but agree; so furnishing ourselves with hooks, lines and other "Necessities," we proceeded up the river in hopes of a jolly old time. Finding a suitable location we proceeded to "drop a line" to the denizens of the Raisin, in full confidence of success. After fishing for about an hour we succeeded in hauling out one little insignificant sun-fish. It dropped off the hook among the flood-wood, and throwing down our fishing tackle we made a lunge for the creature, but he was too slippery for us to handle in our eagerness to capture the little one. We lost our balance and fell down among the logs, tearing our trousers in a way uncomfortable to sit down and think about. However, we was not to be put off with this, for "there's as good fish in the sea as has ever been caught." We seated ourselves on the bank and awaited a nibble, when

Hark! I hear a skeeter sing, Skeeters are now on the wing And their voices piping clear, Tell us 'tis time to be out of here.

We don't like mosquitoes; we never did; they are always sticking their nose into other folks' business. We accordingly lit our pipe and proceeded to smoke them out, but we got smoked out first. We never had the name of being very brave, but we did fight like a hero; 'twas of no use; they flocked in as tho' there was to be a free lunch just for their special benefit. We tried to cut off communications, but they would "settle their little bills," (just like our patrons) for all we could do.

We fought like brave men, long and well, We piled the ground with skeeters slain, We conquered and the skeeters fell Bleeding at every vein. The few surviving comrades saw Our smile, then rang their loud huzza, And the red field won.

About this time our companion came to the conclusion that "all bites" and no fish was about played out, so gathering up our scattered "equipments" we left in disgust. Arriving at home our friends failed to recognize us, and we glad, for the rent in our pantaloons was disgraceful to the dignity of the "quillist." Upon squinting into our mirror we were unable to tell whether it was I or some other Dutchman.

65th Wedding Anniversary Celebrated



Mr. and Mrs. Lowell E. Parr

The 65th Wedding Anniversary of Mr. and Mrs. Lowell E. Parr, of Manchester, will be observed Sunday, September 13, 1987, with a family dinner. The dinner will be held at the home of their granddaughter Mrs. Ellen Stoolmaker of Grand Lodge. Alta Lydia Grossman and Lowell E. Parr were married September 12, 1922, at the home of the bride's parents.

Mr. and Mrs. Parr have two

daughters, Lucille A. Bevier and Doris Lamb, both residing in Brooklyn. They also have five grandchildren and nine great-grandchildren.

Mr. Parr is a retired farmer. They are members of the Emanuel United Church of Christ in Manchester, the Golden Wedding Club, (Citizen Patriot), and Mrs. Parr has been a life-long member of the Shakespeare Club of Manchester.

Twelve Together

Washtenaw County Juvenile Court is proud to introduce Twelve Together, a drop-out and delinquency prevention program. The Court has awarded a grant to the Metropolitan Detroit Youth Foundation to provide peer counseling and tutorial services to ten groups of twelve youth at a variety of locations throughout Washtenaw County.

Starting in October, 1982, Twelve-Together forms support groups of twelve youth who attend a weekend retreat, a parent reception, 6 monthly Academic Forums, and 22 peer counseling/tutorial meetings held weekly in after school sessions. Each year from 1982 to 1985, 20 new groups have successfully been formed. In 1986-87, 42 new groups were formed. Each group is led by two trained volunteer advisors.

The premise of the program is that high school years are the pivotal years for transition to adulthood. By being a part of a positive peer group, high school students can get the support and direction they need to overcome

problems which lead to dropping out such as poor study habits, absenteeism, substance abuse, violence and vandalism in the schools, teen pregnancy, and other personal and family problems. United, the students can survive. Alone, too many simply drop out of everything. They do not become graduation statistics. Rather, they join the statistics of unemployment and crime.

Judith James Wood, Juvenile Court Judge, notes that "This program has a national reputation and we are extremely fortunate to have Twelve Together in Washtenaw County. They will be filing a large void in prevention services for high risk youth and the program hopefully will keep those youth from becoming criminal statistics in the future."

Eligible youth will be those 14 to 17 years of age who are residents of Washtenaw County and who meet at least one of the following criteria:

- (1) are involved with the Court

Continued on page 2

R. D. KLEINSCHMIDT INC

- SHINGLES
- RUBBER SYSTEMS
- BARN ROOFING
- SEAMLESS ALUMINUM GUTTERS
- CARPENTRY WORK
- SIDING
- REPLACEMENT WINDOWS
- INSULATION



• LICENSE #041738

428-8836

★ FREE ESTIMATES
19860 SHARON VALLEY RD • MANCHESTER

Todd Withrow Company

- REMODELING
- CABINETMAKING
- ADDITIONS—WINDOWS
- KITCHENS—BATHROOMS
- ROOFING—SIDING
- CUSTOM BUILT CABINETS
- UNIT UNITS—FURNITURE

TOP QUALITY MATERIAL AND WORKMANSHIP

LICENSED AND INSURED

CALL ANY TIME
428-9420 or 428-7797

BACK DOOR PARTY STORE

500 Ann Arbor Street Phone 313-428-9287 Manchester, Michigan

Now At Back Door Party Store

Instant and Daily Lottery Tickets

UNION 76 GAS Full Service and Self Serve

- | | |
|---|---|
| <p>Miller & Miller Lite Bud & Bud Light 24 Loose Cans Plus Deposit \$10.49</p> | <p>Coke & Diet Coke Pepsi & Diet Pepsi 6 PACK CANS PLUS DEPOSIT \$1.99</p> |
|---|---|

September Special

Winterize Now Cooling System Power Flush

Includes Power Flush of Entire System New Anti-Freeze

\$39⁹⁵

Loss of Anti-Freeze and Replaced Parts Warranted for One Year

Regular Cost: \$69.95

TUNE-UP Special

31⁸⁸

*4 Cyl.

*6 and 8 Cylinder Engines Slightly Higher

Loaner Cars Available By Appointment Only

MIDWEST FORD INC.

510 W. Main St. Manchester, Mich.
Phone 428-8343