

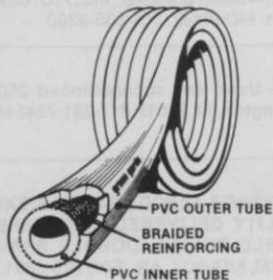

You Can Depend on the green garde® High Performance Spray Team

NEW! 4-SPIRAL WHITE HOSE . . . a unique 600 PSI hose designed to withstand the rigors of the spray industry. **Solid PVC Tube with two layers of criss-cross spiral reinforcement . . . nothing like it anywhere!** Available in 3/8" and 1/2" ID, 300 and 400 foot continuous lengths.



BRAIDED NEON HOSE . . . the best quality hose money can buy. **Avoid downtime and chemical spills . . . use the hose preferred by top operators all over North America.** 800 PSI working pressure; available in 1/4", 3/8", 1/2", 5/8" and 3/4" ID; 300, 400 and 600 foot continuous lengths. Some odd lengths, in various ID's, also available at special prices.

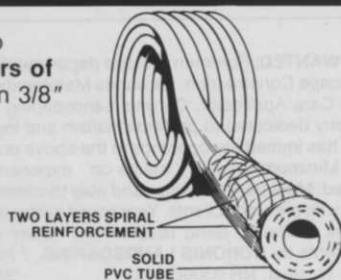

JD9-C Hi-Performance SPRAY GUN . . . used by just about everybody. A rugged, dependable, versatile performer in any spray application. Fully adjustable from fog to long distance stream. **Five tips** available to fit your needs . . . **adapter** to attach the many fine Spraying Systems wands and spray tips. **Also available . . . JD9-CT with gauge port and plug,** allows you to easily calibrate your sprayer.

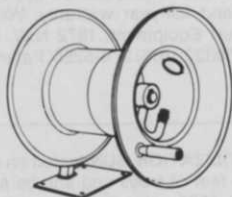
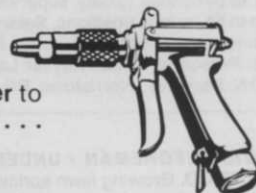

Heavy-Duty ALUMINUM HOSE REELS . . . unique single pedestal design makes mounting anywhere a breeze. Constructed of marine alloy aluminum -- eliminates corrosion problems. **Attractive . . . and popularly priced!** Available in four sizes, with capacity from one to four hundred feet of 1/2" hose. **MARK IV** model accepts 250 feet of 3/4" hose.

REPLACEMENT HOSE REEL SWIVELS . . . tested at over 3000 PSI dynamic service pressure! The same heavy-duty units supplied on our hose reel, now available separately. Fits Hannay and other reels with no modification. Extended service **VITON** o-rings means longer wear; and, when replacement *does* become necessary, it can be done, in the field, with an inexpensive kit, in less than a minute. Three sizes: 1/2", 3/4", 1".

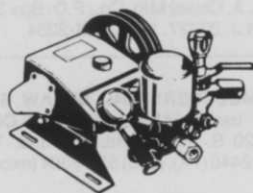
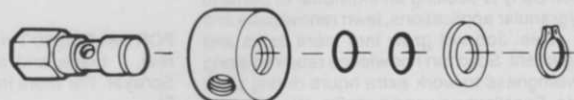

Hi-Performance TRIPLEX PLUNGER PUMPS . . . the choice of successful operators. Rugged! Reliable! Outperforms and outlasts diaphragm pumps! Pumps almost any fluid. Available in six models, from 3 to 35 GPM, up to 500 PSI service pressure. **Nothing else to buy . . .** pumps come with pressure regulator, pulley, glycerine-filled gauge, bypass valve, surge chamber, mounting rails, NPT adapters . . . **ready to use!**

Heavy-duty ROOTFEEDER . . . for tree and bed rootfeeding. Built to last . . . replaceable hardened tips. Up to 12 GPM capacity. Two stainless steel feeding needle extensions also available. **Fits on JD9-C Spray Gun.**

ACCESSORIES AND PARTS . . . we have exclusive design flooding nozzles (five patterns); hosecutters with stainless steel blades for fast, *safe* clean cuts on PVC hose; plated steel long-shank GHT hose fittings in 1/2", 5/8" and 3/4" sizes; aluminum alloy short shank GHT hose fittings in 3/8", 1/2" and 3/4" sizes; mini-hand duster *and* chest-carried combination duster/granule applicator; Band-It® banding products and tools, etc. All replacement parts in stock, **always.**

SERVICE . . . our most important product! It is the standard of the industry . . . and it's included in the price of every Green Garde product you buy. Normally, orders are shipped same day as received.

Green Garde® WARRANTY . . . the best in the business . . . and, it's EASY! If our product fails to perform satisfactorily you get a replacement, credit or refund. Quality products make our life simple . . . **try some Green Garde® quality today!**

See these and many other fine Green Garde products at your distributor or contact us at (312) 593-6464

© Copyright 1986 Encap Products Company — All Rights Reserved

ENCAP PRODUCTS COMPANY P.O. Box 278 Mt. Prospect, IL 60056

FIELD SUPERINTENDENT: Degree in Ornamental Horticulture or related field, knowledge of woody plants or equivalent training, experience. Skills in application of current horticultural technology. Salary commensurate with experience, comprehensive benefits. W. K. Martin, The Holden Arboretum, 9500 Sperry Road, Mentor, Ohio 44060. 2/87

HELP WANTED: Foremen in these departments: - Landscape Construction, -Grounds Maintenance, -Lawn Care Applicator. Coronis Landscaping - a company dedicated to professionalism and ingenuity - has immediate openings in the above positions. Minimum 3 years "hands-on" experience required. Must be a motivator and able to communicate with crew and clients. Year round salary and benefits available. Send resume and salary requirements to: **CORONIS LANDSCAPING**, 7 Pike Street, Nashua, NH 03060-5031. 3/87

GROUNDS MAINTENANCE AND PLANTING SUPERVISOR/FOREMAN: Well established landscape contractor in the Philadelphia area is seeking experienced quality supervisors and/or foremen to fill various positions. Salary and benefits commensurate with experience. Forward resume to: Personnel Office, Heyser Landscaping, Inc., 400 N. Park Ave., Norristown, PA 19403. 4/87

SUPERVISOR/FOREMAN - UNDERGROUND SPRINKLER CO. Growing lawn sprinkler installation company. We are opening our fourth office in the mid-west. We need top notch foremen with supervisory ability. Responsibilities would include installation, recruiting, training, scheduling, job cost evaluation and equipment. Desire to be part of management is a must. Send a letter describing your talent to: The Lawn Pros Sprinkler Co., 3508 B Roger B. Chaffee Blvd., Grand Rapids, MI 49508. 2/87

The lawn care division of complete landscape service company is seeking an individual to perform liquid/granular applications, lawn renovations and some sales. Job will grow into more sales and management. Solid turf knowledge required along with willingness to work extra hours during peak periods. Excellent pay and benefits. West Suburban Boston. Call 617-444-0994 anytime. 2/87

OUTSTANDING OPPORTUNITIES FOR ARBORISTS with sales experience to join rapidly growing, full-service tree care company. All benefits and incentives. Call or send resume to **SAV-A-TREE OF WESTCHESTER**, c/o Daniel Van Starrenburg, P.O. Box 527, Armonk, NY 10504. 914-666-8202. 2/87

Landscape Architects/Supervisors (project foremen) to join a nationally acclaimed firm looking to expand into its second generation Long Island area supports a high budget landscape industry. Year round employment, company benefits and continuing education available. Experienced and aggressive people send resume to: **GOLDBERG & RODLER, INC.**, 216 East Main Street, Huntington, New York 11743. 4/87

Branch Manager - Landscape Management: Excellent opportunity with expanding professional landscape management organization located in Houston, Texas. Must possess management and marketing skills and knowledgeable in equipment and maintenance operations. Salary/Bonuses commensurate with education, experience, and results. Send resume to WTT Box 409. 2/87

Large landscape contracting firm seeking a Nursery Manager who is aggressive, responsible with excellent plant knowledge. Education and/or experience preferred. Salary and benefits negotiable. Please send resume to P.O. Box 725, Utica, MI 48087. 2/87

GROWTH OPPORTUNITIES WITH ONE OF NEW ENGLAND'S LARGEST LANDSCAPE CONTRACTORS

FIELD OPERATIONS MANAGER: Responsible for the coordination of 9 to 12 construction crews. Must be a well organized, a self-starter with good communication skills. Salary, profit sharing plus other benefits.

CREW LANDSCAPE FOREMAN: Experience in all phases of large landscape operations a must. Salary, profit sharing, benefits.

OTHER ENTRY LEVEL POSITIONS available as well as management positions.

Send resume to:
J. Farmer & Company, Inc.
219R South Main Street
Middleton, MA 01949
(617) 774-2933

FOR SALE

For Sale: 1981 Howard Price Model 180 hydraulic drive rotary mower; 15% cutting width; not operable, needs factory axle kit installed. 1,027 hours. \$12,000.00. Phone (609) 896-3300. 3/87

REEL GRINDER USED EXPRESS DUAL: Reel Grinder and Angle Master bed knife grinder. Both in excellent condition. Asking \$9,500 for the pair. Call Mowing Machine Grinders and Reels, Inc. 205-222-2591. 3/87

FOR SALE: 1980 Toro Parkmaster HTN, 7 gang, 7 reel, 7 blade and a 1980 FMC D020 300 Gal. Sprayer. For more information call 305-225-1200, FL. 3/87

For Sale: 914A. Sod Corn Alfalfa Land 403A in C.R.P. \$26,097, Income Per Year. Will Split. 18" Ryan Sod Cutter w/Roll Ryder, \$1,500. 5 gang Roseman \$1,200. 414-326-5267. 2/87

1976 FINN 2600 GALLON HYDROSEEDER with John Deere Diesel Engine Mounted on a 1966 Ford 850 Tandem Axle Truck. Best Offer - Call 301-924-4445. 2/87

77 GMC 2 ton spray truck, 1000 gallon tank recessed on flatbed. 1984 Hannay Reel, Meyers 2C95 pump, PTO, 100 gallon steel auxiliary tank. 76 Ford 1 ton spray truck, 750 gallon tank Hannay Reel, Meyers 2C95 pump, PTO, 50 gallon poly auxiliary tank. Call 317-284-1429 or 317-294-0265. 2/87

Spray Trucks: 1980 GMC - series 6,000 350 V8 4 speed and 2 speed axle. Units are equipped with 1,200 gallon Tufflex fiberglass tanks, mechanical agitation, 10 GPM Bean pump, 50 gallon side tank, 8HP Kohler engine drive, Haneley electric hose reel and detachable 1,200 lb. capacity granular fertilizer box. \$10,500. Call Jerry Mykietka, 1-312-932-8668. 2/87

Jacobsen Silt Seeder 9 horsepower Briggs and Stratton engine. Good condition. \$1,700. Call (312) 773-0661. 4/87

LANDSCAPERS SUPPLY CORP.'S FREE CATALOG. Buy direct and save up to 75% on a full line of commercial lawn maintenance equipment, engines, parts and accessories. Call Toll Free 1-800-222-4304. 5/87

FINN HYDROSEEDERS & MULCH SPREADERS. New & Used. Wolbert & Master, Inc., P.O. Box 292, White Marsh, MD 21162, 301-335-9300. 6/87

SPYDERS - Used and reconditioned 2500 S. Cooper, Arlington, TX 76015. 817-261-7346 Mark. 2/87

ZOYSIA MEYERS Z-52 SOD OR SPRIGS. EXCELLENT QUALITY DELIVERED ANYWHERE AT REASONABLE PRICES. DOUBLE SPRINGS GRASS FARM, SEARCY, AR. (501) 729-5691. 5/87

BROUWER HARVESTER OWNERS! ELECTRIC DEPTH CONTROL. Save time and money with improved quality control. Make depth-of-cut adjustments, on the move, with one button finger tip control. Allows you to cut longer rows through varying soil conditions. \$895. 30-day satisfaction guarantee and full-year warranty. Write or call: Shattuck Turf Equipment, 1872 N.W. 82nd, Des Moines, IA 50322, (515) 278-5255. Patent pending. 3/87

TREE FERTILIZATION GUN tested on over a million square feet of trees and shrubs all over the U.S. Good to 500 psi, repairable, non-corrosive. Buy direct from manufacturer, \$106.00 (shipping included). Arbor-Nomics, Inc., 585 Langford Lane, Norcross, GA 30071. (404) 447-6037. TF

BALL BARRIER NETTING: Made of olefin fibers. 6 1/2 feet and 25 feet high. Strong and tough. Will not rust. Easy to handle. For Driving Ranges and Golf Courses. Keep golf balls from straying off-course. J. A. Cissel Mfg. Co., P.O. Box 339, Farmingdale, N.J. 07727. 1-800-631-2234. TF

HYDRO-MULCHERS AND STRAW BLOWERS New and used. **JAMES LINCOLN CORPORATION**, 3220 S. Jupiter Rd., Garland, TX 75041. (214) 840-2440 (TX), (800) 527-2304 (except TX). TF

LAWN SEED. Wholesale. Full line of top quality grasses. Improved bluegrass varieties, fine fescues and fine bladed ryegrasses. We specialize in custom mixing. Olinger Seed Company, 89 Hanna Parkway Akron, OH 44319. Call collect (216) 724-1266. TF

SPYDERS — used and rebuilt. Also a complete line of replacement parts for your Spyder. Call or Write: Mobile Lift Parts, Inc., 5402 Edgewood Rd., Crystal Lake, IL 60014. 815-455-7363. 3/87

COMPLETE LAWN CARE SPRAYING SYSTEM. 1984 Ford F250 custom skid mount. 400 gallon polypropylene tank. Electric Hannay hose reel, 300' of hose, D-60 diaphragm pump, 10 H.P. Briggs & Stratton. The system is in excellent condition and ready for use. \$13,000. Call 319-359-6549. 2/87



Landscape Exposition

THE SECOND ANNUAL LANDSCAPE EXPOSITION

MARCH 3-5, 1987

O'HARE EXPOSITION CENTER, ROSEMONT, ILLINOIS

THE RIGHT STUFF FOR LANDSCAPE PROFESSIONALS

If you're a landscape professional looking for the 'right stuff' to operate more effectively and efficiently in the future, look no further. Landscape Expo has it. **In fact, we are the established national forum for landscape professionals.**

Over 225 national manufacturers of power equipment, chemicals, fertilizers, seeds and irrigation systems will be on display. See new equipment, products, supplies, and services that will enhance your operation, make you more efficient and increase your bottom line. Choose from over 30 conference sessions and workshops that explore the critical business challenges facing green industry professionals. Learn practical, hands-on management, marketing and technical skills and strategies you can put to use immediately.



Landscape Expo has the active support of the industry's leading associations: * **THE PROFESSIONAL GROUNDS MANAGEMENT SOCIETY** * **THE ASSOCIATED LANDSCAPE CONTRACTORS ASSOCIATION** * **THE PROFESSIONAL LAWN CARE ASSOCIATION OF AMERICA** * **ILLINOIS LANDSCAPE CONTRACTORS ASSOCIATION.**

Landscape Expo is in the right place too. O'Hare Exposition Center in Rosemont, Illinois is convenient to airports, major highways and is close to the sights and attractions of Chicago. O'Hare is at the heart of an area with over 16,000 landscape professionals within 300 miles.

Join your colleagues at the Second Annual Landscape Expo, March 3-5, 1987, O'Hare Exposition Center, Rosemont, Illinois. You'll come away with the right stuff.

Take advantage of the best offer you'll have in 1987: to be part of the year's most exciting marketplace. Call or write now for more information.

Produced and Managed By: **(HBJ)** HBJ EXPOSITIONS & CONFERENCES

Sponsored By: *Weeds Trees & Turf* and *Lawn Care Industry Magazines*

Mail this now and plan to attend or exhibit:



Landscape Exposition

P.O. Box 5555, 50 Washington Street,
Norwalk, CT 06854
Phone: **(203) 653-0400 (800) 243-2815**

YES! I'M INTERESTED!

Please send me, at no cost or obligation, an
 Exhibitor's prospectus and application
 Attendee's information package

Name	_____		
Title	_____		
Company	_____		
Address	_____		
City	State	Zip	
()			
Telephone	_____		
Business Function	_____		

For Sale: 320 acres sod, tree, fish farm. 240 acres standing crop, St. Aug., Raleigh, Centipede, Bermuda. 60 acres standing crawfish/catfish. 20 acres young landscape trees. Full line modern equipment. Possible owner finance. 713-451-1515, Houston, TX. 3/87

FOR SALE: 1- 1980 IH with 1200 high volume spray, 2 78 GMC, 1 ton for low volume spray. Reasonable priced for quick sale. 315-637-8660, Dave. 2/87

1982 BROUWER FORK LIFT: Diesel Model # HH3500PD. Good condition, \$9,995. HAMILTON SOD CO. LTD. RR # 1, Mount Hope, Ontario, CANADA, 1-416-389-9050. 3/87

Olathe 48HL sweeper 400 hours, 1984 model, like new, \$5,500. Two hustler model 295 mowers with 72 deck, asking \$5,500 for 1984 model or \$3,500 for 1983 model. 803-879-3265. 2/87

Landscape maintenance business for sale. Large commercial accounts and equipment. Asking 175K - no brokers. 914-353-1286. 2/87

550 gallon fibergalss Smithco skid mount unit, 10 gallon per minute Bean pump, Kohler engine mechanical agitation, Hannay hose reel 300+ of FMC hose and Chemlawn gun. Contact Angelo or Paul at 609-567-1642 or 567-3029. 2/87

ROSEMAN Hydra-Gang 7 hydraulically driven reels, 2 grindings left. 7 motors, main pump all working. Rollers need bearings. \$500. Write: N. Ray, 2831 University Ave., Green Bay, WI 54301. 2/87

Vermeer 630 A Stump Grinder, Excellent condition \$6,000.00. Edwards Tree Service, 49090 Cooper Foster Park Road, Amherst, Ohio 44001, (216)988-4477. 3/87

New Locke Professional tri-plex, \$6500. New Locke 30", \$2500. Two new Ingram Model 582, 72" rotary, 23 h.p., \$6000 each. Phone (305) 592-2206. 3/87



Landscape Design
RUBBER STAMPS

Landscape Design Kits
Interior Plant Sets
Tree Stamps Books

AMERICAN STAMP CO.
12290 Rising Rd., suite 200-w
Wilton, CA 95693 (916) 687-7102

Vermeer 630 Stump Grinder. Excellent condition and well maintained. Area Code (717) 898-8591 or 898-7443. 2/87

NEW LAWN CARE SPRAY UNITS. Tankers, trailers or skid units. **BUILT TO YOUR SPECS.** Placed on new or reconditioned trucks or trailers. Call today with your specifications for a price quotation. No obligation. (515) 829-3211. 2/87

Dowdeswell model 650 (The Gem) walk behind commercial tillers are available—20", 24", 30"—gas or diesel. Save 10% now - from \$5193.00; other makes, types, sizes from \$289.95. Let us bid your equipment and service needs! G. Gandy Equipment Services, 2031 4th Ave., Joliet, IL 60433. 815-726-7921. 3/87

Brouwer Sod Harvester for sale. Excellent condition. Used Spyder Forklift, nice shape. 414-434-9496. 2/87

(200+) acre Sod & Tree Farm—very good house & bldgs. with or without Eq. Irrigation well, Pond, 9 miles North of Howell, Mich. 517-546-3569 or 517-546-6709. 2/87

**PLAN NOW FOR NEXT SPRING
START A NEW LIFE IN LAWCARE
SUPPORT YOUR INDEPENDENCE**

ServiceMaster, the world leader in home and office cleaning now offers LawnCare franchises. Become an independent business owner with a new and different future. Financing is available on your cash investment. Approved buyers need as little as \$6,000 to start. Call or write today to:

Mr. Roger Nondorf
ServiceMaster Residential & Commercial Corp.
LawnCare Division
2300 Warrenville Road
Downers Grove, IL 60515
312/964-1300 Extension 290

USED EQUIPMENT

Reconditioned **BIG JOHN TRANSPLANTERS**, Models 60, 78, 88 - several to choose from. Call or write for detail sheet. **BIG JOHN**, South Central Region, 323 Crowley Road, Arlington, TX 76012. 817-277-6745. 2/87

BUCKET TRUCK: Hi Ranger 65', 57', 50'. Skyworkers with chip boxes. Asplundh bucket trucks with chip boxes. Asplundh brush chippers. Bean 55 gal. sprayers. Parkway Equipment Company, 633 Cecilia Drive, Pewaukee, WI 53072. 414-691-4306. TF

BUCKET TRUCKS, Straight Stick, Corner Mount and Knuckle Boom Cranes. Brush Chippers - New Morbark Disc Type, New Woodchuck Drum Type. Best prices anywhere. Used Chippers - Asplundh, Woodchuck, etc. 2 to 8 usually in stock. Sprayers, Dumps, stakes, Log Loaders, Crew Cab Chip Box Dumps, Railroad Trucks, 50 in stock. Sold as is or reconditioned. Opydye's Hatfield (Philadelphia Area) 215-721-4444. TF

NEW AND USED EQUIPMENT—Asplundh, Hi Ranger and Lift-all forestry bucket trucks, Chipmore wood chippers. Mirk, Inc., (216) 669-3567, (216) 669-3562, 7629 Chippewa Road, Orrville, Ohio 44667. TF

TS/45 TREE SPADE W/TEN CONE TRAILER—Excellent condition—\$43,000. Mounted on 1980 Ford L/N 8000-3208 Cat. Call 518-725-4224. 2/87

YANMAR (John Deere) 165D, four wheel drive, 16 hp diesel tractor with front end loader and rototiller. Like new condition, only used for 150 hours. \$6,000. (313) 737-0328. 3/87

WANTED

Wanted to buy **HYDRO SEEDER**. Please send photo. Johnson Hydro Seeding Corp., 13751 Travilah Road, Rockville, Md. 20850 301/340-0805. TF

Evergreen Lawns, a division of the Hawley Group Ltd., an international service company doing in excess of a billion dollars in sales, wants to acquire lawn care companies of all sizes. All inquiries strictly confidential. Please contact Steve Hirshmufl, Director of Finance and Acquisitions, Evergreen Lawns Corp., 1390 Charlestown Industrial Drive, St. Charles, MO 63303. 314-946-9700. 2/87

WANTED: Large Lindig and Royer Shredders. Lewis Equipment. 320 Third Street S.W., Winter Haven, FL 33880. (813) 294-5893. 4/87

Equipment Wanted: Used Hesston Model # 180/230 TORO GMT 200, any condition. Please call Dick Trevarthan, 815-469-5238 - 469-5903. 3/87

ORKIN LAWN CARE

Wants to acquire lawn care/pest control companies doing \$1,000,000 or more annual revenue. Sell your business. Stay and grow with us if you wish. Reply to Gordon Crenshaw (404) 888-2770.

MISCELLANEOUS

EQUIPMENT DEALERS: National manufacturer seeking aggressive nationwide coverage in high growth areas. For full catalogue and marketing information please respond to WTT Box 413. 2/87

FREE PARTS CATALOG—If you own a 36"—48"—52" walk-behind mower and you feel you're paying too much for parts, call Preco Distributors toll-free and request our parts catalog. **BELTS, BLADES, GRASS CATCHERS, WHEELS AND LOTS MORE!** Replacement parts that fit: **BOB-CAT, BUNTON, KEES, EXMARK & OTHERS.** 1 day shipping coast to coast available. All parts carry a 90-day warranty. Don't wait, call 24 hours a day. **TOLL-FREE 1-800-428-8004, in Mass. 413-596-5505. PRECO DISTRIBUTORS, 2400 BOSTON ROAD, WILBRAHAM, MA 01095. TF**

SERVICES

RELINERS, TIRE REPAIR
Free Tire Supply Catalog



Hard-to-find ag tires, tubes, reliners, tire repair tools, hot-cold patches, boots, tire changers, low tire prices and more listed in **GEMPLER'S free catalog. 24 hr. UPS shipping.** Write: **Gempler's**, P.O. Box 270-70, Mt. Horeb, WI 53572 or call 1-800-382-8473.

CONSULTING SERVICES: Grow your business with someone else's experiences. **PROGRAM DEVELOPMENT, TRAINING NEEDS, OPERATION START UP OR EXPANSION AND LEGISLATIVE PROBLEMS.** Over 10 years experience with the industries' leaders. Please contact: Philip E. Catron, M.S., 26548 Haney Ave., Damascus, MD 20872, 301-253-5652. 2/87

NO. ADVERTISER	PAGE NO.	NO. ADVERTISER	PAGE NO.	NO. ADVERTISER	PAGE NO.
101 American Cyanamid/ Pendimethalin	102-103	161 Howard Price Turf Equipment	93	120 Plastics Division/Eberhart Steel Products Corporation	109
102 American Cyanamid/Arsenal	38-39	117 John Deere & Co.	56-57	160 Precision Laboratories, Inc.	14
103 Andersons, The	16-17	133 Jacobsen Division of Textron Inc.	89	162 Rain Bird Sales, Inc./Turf Division	29
104 Barebo, Inc.	85	135 Kem Enterprises, Inc.	44	163 Ransomes, Inc.	67
105 BlueBird Int'l.	28	136 Lebanon Chemical Corp.	105	164 Reinco	116
106 Brouwer Turf Equipment Lt'd.	Cv-3	137 Lebanon Chemical Corp.	24	165 Rhone-Poulenc, Inc./Chipco Ronstar	33
107 Brouwer Turf Equipment Lt'd.	43	138 Lesco, Inc.	26	166 Rhone-Poulenc, Inc./ Chipco 26019	79
109 Chevron Chemical Co.	99	139 Lofts Inc./Jacklin Seed Co.	CV-4	167 Rhone-Poulenc, Inc./Chipco	91
110 Ciba-Geigy	111	140 Lofts Inc./Turf Guide	120	168 Ringer Corp.	112
111 Classen Mfg. Co.	126	141 Mallinckrodt, Inc.	27	169 Sandoz Crop Protection Corp.	5
112 Club Car	84	142 Mobay Chemical/Bayleton	68-69	170 Scag Power Equipment	115
113 Cushman/Ryan	72-73	143 Mobay Chemical/Dyrene	19	171 Scotts Proturf, O.M.	41
114 Cushman/Ryan	97	144 Mobay Chemical/Oftanol	82-83	172 Shindaiwa	20-21
115 Daihatsu America, Inc.	2-3	145 Mobay Chemical/Oftanol	82-83	173 Spraying Devices, Inc.	114
116 Danville Ind.	126	146 Mobay Chemical/Nemacur (Regional)	117	174 Tee-2-Green Corp.	CV-2
118 Deutz-Allis	25	147 Mobay Chemical/Sencor (Regional)	113	175 Teledyne Total Power	78
119 Dow Chemical/Dursban	22-23	148 Monsanto Agricultural Co./Limit (Regional)	94-95	176 Toro Co./Reelmaster	12-13
122 Elanco Products Co./Balan	75	149 Monsanto Agricultural Co./ Roundup	62-63	177 Turf Vac Corp.	135
123 Elanco Products Co./Team	45	150 National Mower Co.	124	178 Turfco Mfg., Inc.	124
124 Elanco Products Co./Surflan	107	151 Nissan	15	179 Union Carbide/Sevin	52-53
125 Elanco Products Co./Rubigan (Regional)	86-87	152 Nor-Am Chemical Co.	59	180 Weather-matic/Sprinkler Division	101
126 Encap Products Co.	131	153 North American Green	37	181 Wells Cargo, Inc.	120
127 Environmental Ind. Inc.	118	154 Olathe Mfg., Inc.	122		
134 F.D. Kees Mfg. Co.	36	155 Oregon Fine Fescue Comm.	123		
128 Fermenta Plant Protection	121	156 Oregon Tall Fescue Comm.	32		
129 Ford New Holland	48-49	157 PBI Gordon Corp./Dyclomec	125		
130 Garfield Williamson/Jaguar	119	158 PBI Gordon Corp./Ferromec	34-35		
182 Goossen Ind.	122	159 Pickseed West Inc.	77		
131 Gravely Int'l, Inc.	30-31				
108 H.V. Carter Co. Inc. (Regional)	129				
132 Hoechst Roussel	6-7				

This index is provided as an additional service. The publisher does not assume any liability for error or omission.

TURF VAC®

sweeps both turf and pavement

The only sweepers with unique all-vacuum design that operate on both turf or pavement, wet or dry. Safe, powerful air picks up bottles, cans, as well as fine clippings to reduce thatch build-up.

- Sweeping widths from 4' to 30'.
- 6" x 10' hand intake hose available.
- Hard surface filtration.
- No fingers or brushes to wear out—picks up by air only.
- Ground dump & power lift dump.
- Tow type or self-propelled.
- PTO models available.



MODEL FM-3. With 4 ft. sweeping width and 11 HP B&S engine. Ideal for landscaping maintenance and other general purpose sweeping.



MODEL 80
Sweeps 48" wide



MODEL 70 LD
Sweeps 54" wide



MODEL FM-5
Lifts to Dump 96"

Write for brochures/distributor in your area.



TURF VAC CORPORATION

P.O. Box 90129, Long Beach, CA 90809
Telephone: (213) 426-9376

Changing times

As I type this into my trusty computer terminal, the office is devoid of people. It's December 28th, 1986, the Sunday between Christmas and New Year's. The new year is fast approaching. Even though 1987 will be a toddler by the time you read this, this might still be a good time to reflect on 1986 and make some projections about 1987.



One lesson we all might learn from 1986 is that, sometimes, you have to change with the times.

The staff of WEEDS TREES & TURF plans to celebrate the magazine's 25th anniversary year with some exciting new changes, the biggest of which we'll be officially announcing in April. In a dynamic industry like what we call the "green industry," we've learned that you can't stagnate and continue to be successful.

We expect that attitude to serve the magazine's staff well over the next few years as we change with the industry. It might serve your business, as well.

You see, by the end of 1987, we'll probably know exactly where we stand with respect to our use of pesticides.

Lt. George Prior's death on a golf course will be ancient history. Golf course superintendents will have a season of controlling insects without diazinon under their belt.

The results, if any, of ChemLawn's posting policy will be resolved.

The dust will have settled from the sale of major chemical and equipment companies.

I sort of feel that the readers of WEEDS TREES & TURF let 1986 sneak up on them. They really weren't prepared—especially for the bad publicity they received.

Here's hoping that our readers change with the times, that they learn from 1986, that they adjust.

And that they prosper in 1987.

Jerry Roche

Jerry Roche, editor

WT&T Editorial Advisory Board



Doug Chapman
Horticulturist
Dow Gardens
Midland, MI



J.R. Hall
Extension Agronomist
VPI & SU
Blacksburg, VA



Kent Kurtz
Professor
Horticulture
Cal Poly-Pomona



Harry Niemczyk
Professor
Ohio State University
Wooster, OH



A. Marty Petrovic
Asst. Professor
Cornell University
Ithaca, NY



Robert Shearman
Assoc. Professor
University of Nebraska
Lincoln, NE

the Brouwer seeder does it all...



The new self propelled Lawnmaker that "does it all". Whenever there is a need for seeding, overseeding and fertilizing it has the combination you need to do the job. Its unique design lets it follow the ground contours and plant seeds evenly...for better results. The powered blades and guides place the seed into adjustable depth slits that are 2½ in. apart, offset wheels then cover the seed, for the best possible germination conditions. It overseeds and seeds a 22 in. wide strip, with calibrated seed flow, and the 5 hp engine and heavy duty drive give excellent traction in a variety of conditions. The adjustable operator handle folds away for easy storage and transport. Available as; an overseeder; seeder with fertilizer hopper; or overseeder and fertilizer; the new Brouwer seeder, is ideal for Parks, Golf Courses, School boards, Municipalities, Landscapers, Rental outlets, and Lawncare people.



SEEDING

The exact placement of seed, in the right quantity, gives you the perfect seed bed for better germination and finer quality lawns.



OVERSEED

Better results because the seed flow is carefully calibrated, the grooves cut and the seed covered.



OPTIONS

The choice is yours. The seeder can be bought with or without the overseeder unit or the fertilizer box. These can be added afterwards when needed.

and for those larger areas...

The Lawnmaker 67 seeder, is a larger capacity seeder/fertilizer ruggedly built...to last. It has adjustable teeth for loosening up hard soil and a levelling bar for uneven areas. There are stainless steel hopper bottoms and control slides, free floating suspension on two open mesh rollers, easy to reach controls, and it can seed up to 2 acres (0.8 ha.) per hour. Designed to give outstanding performance.



BROUWER
TURF EQUIPMENT LIMITED

An Outboard Marine Corporation Company

7320 Haggerty Rd./Canton, MI. 48187 Telephone (313) 459-3700

Woodbine Avenue/Keswick, Ontario, Canada L4P 3E9 Telex 065-24161 Telephone: (416) 476-4311